

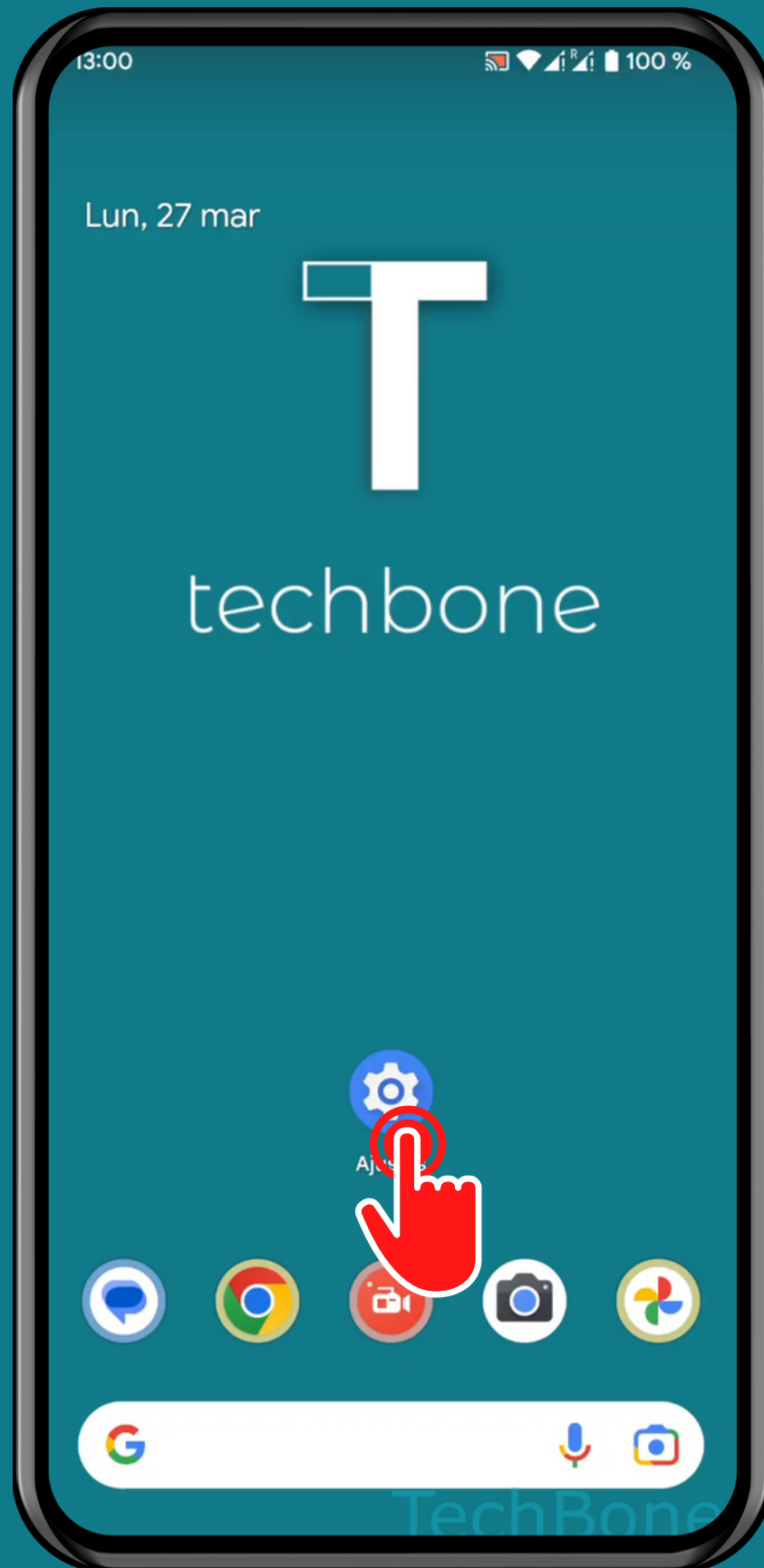

ANDROID 13

Tutorial Paso a Paso

PERSONALIZAR EL SALVAPANTALLAS



Abre los Ajustes

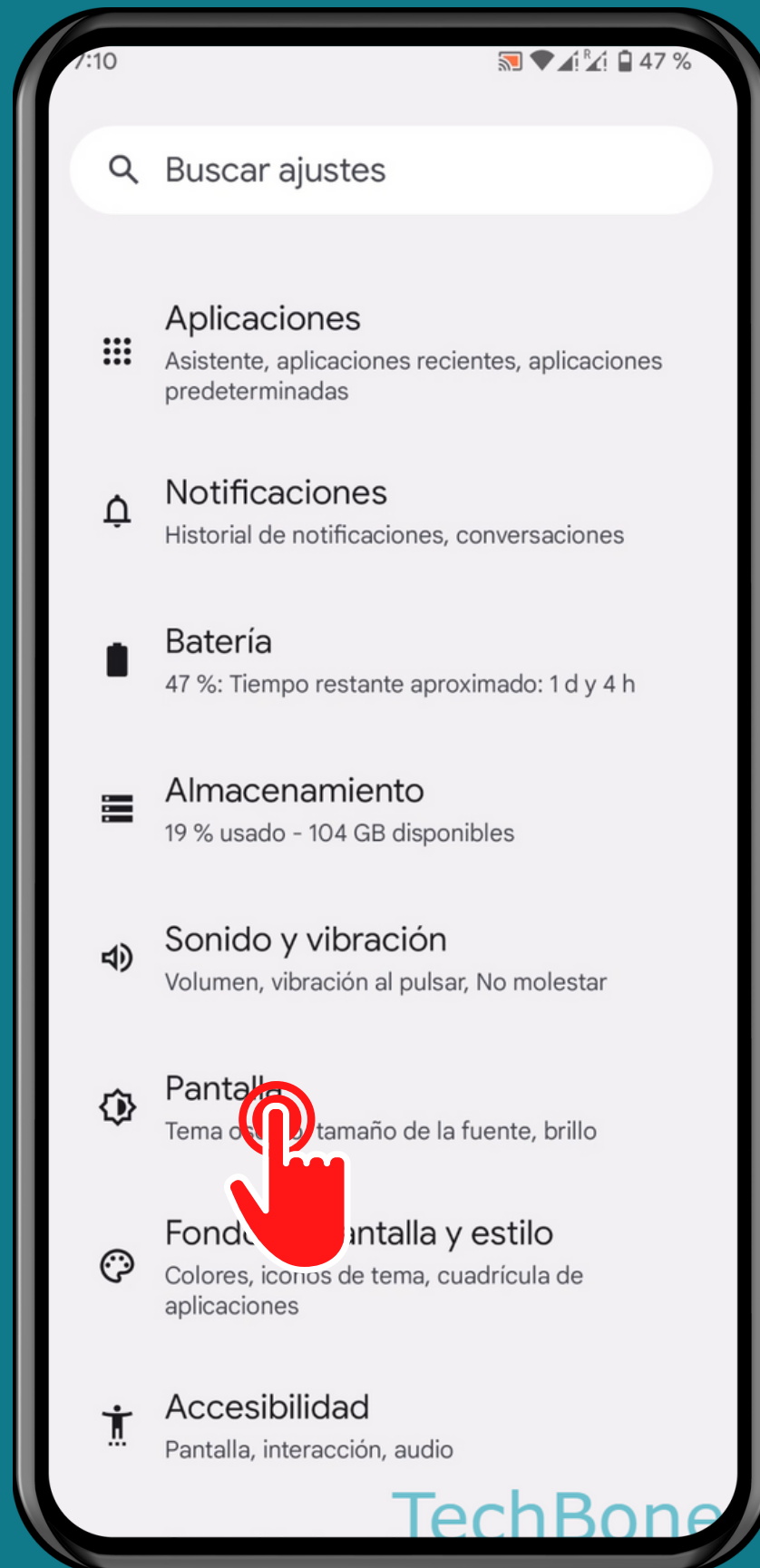

Presiona Pantalla

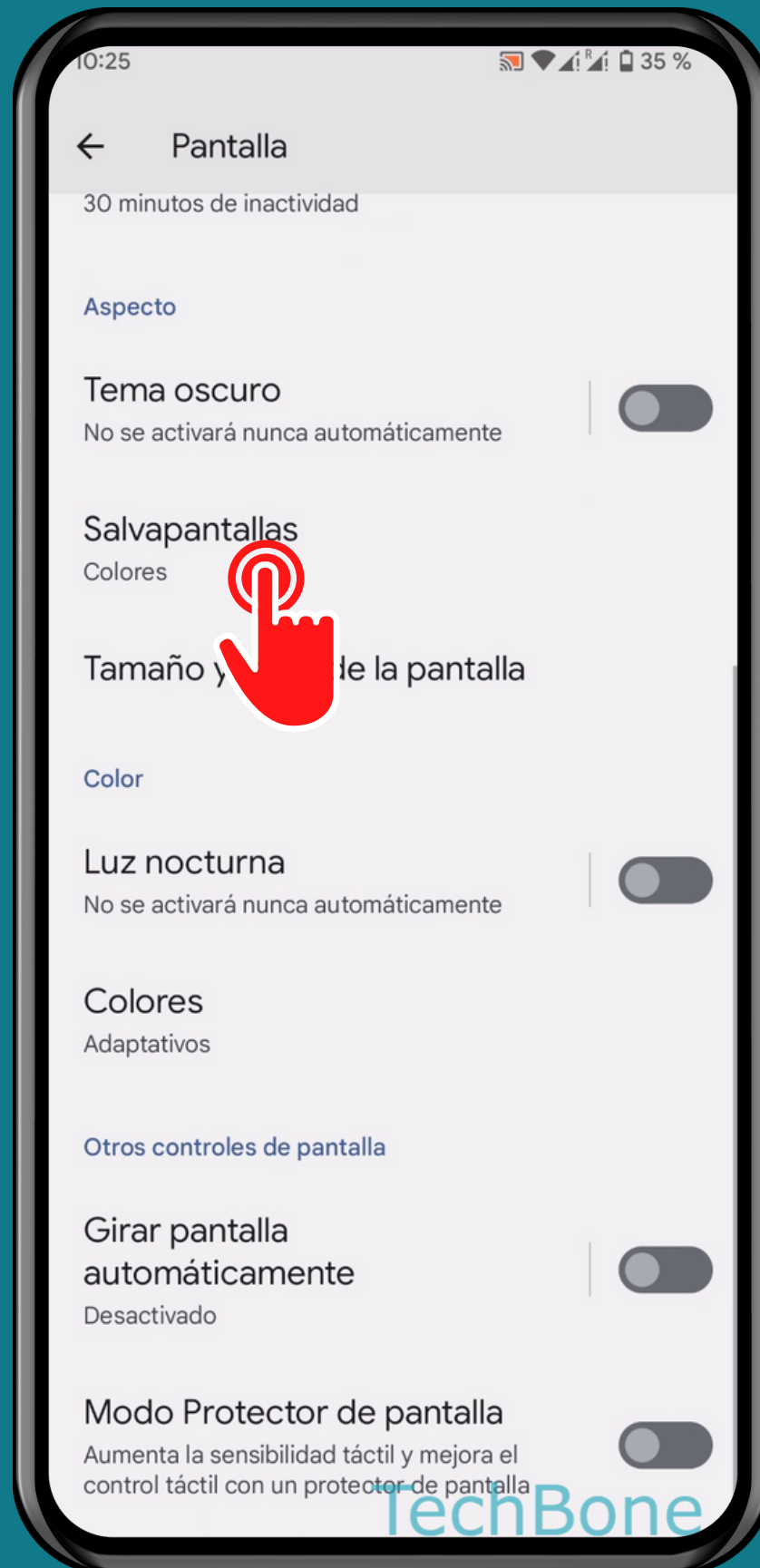

Presiona Salvapantallas



Elige una
Opción

TechBone



Presiona
Personalizar

TechBone

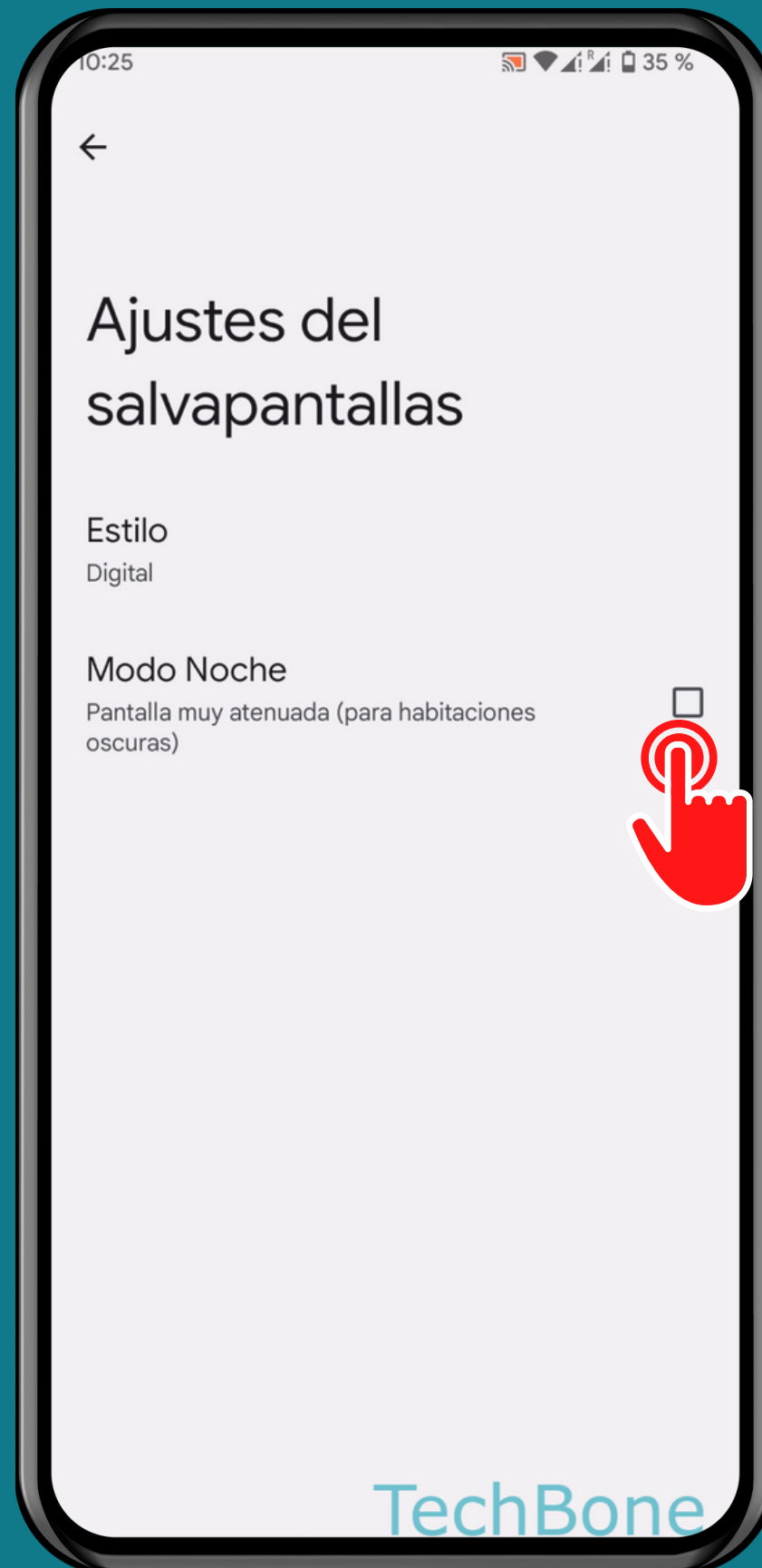

Establece los **Ajustes** deseados

¡Listo!