

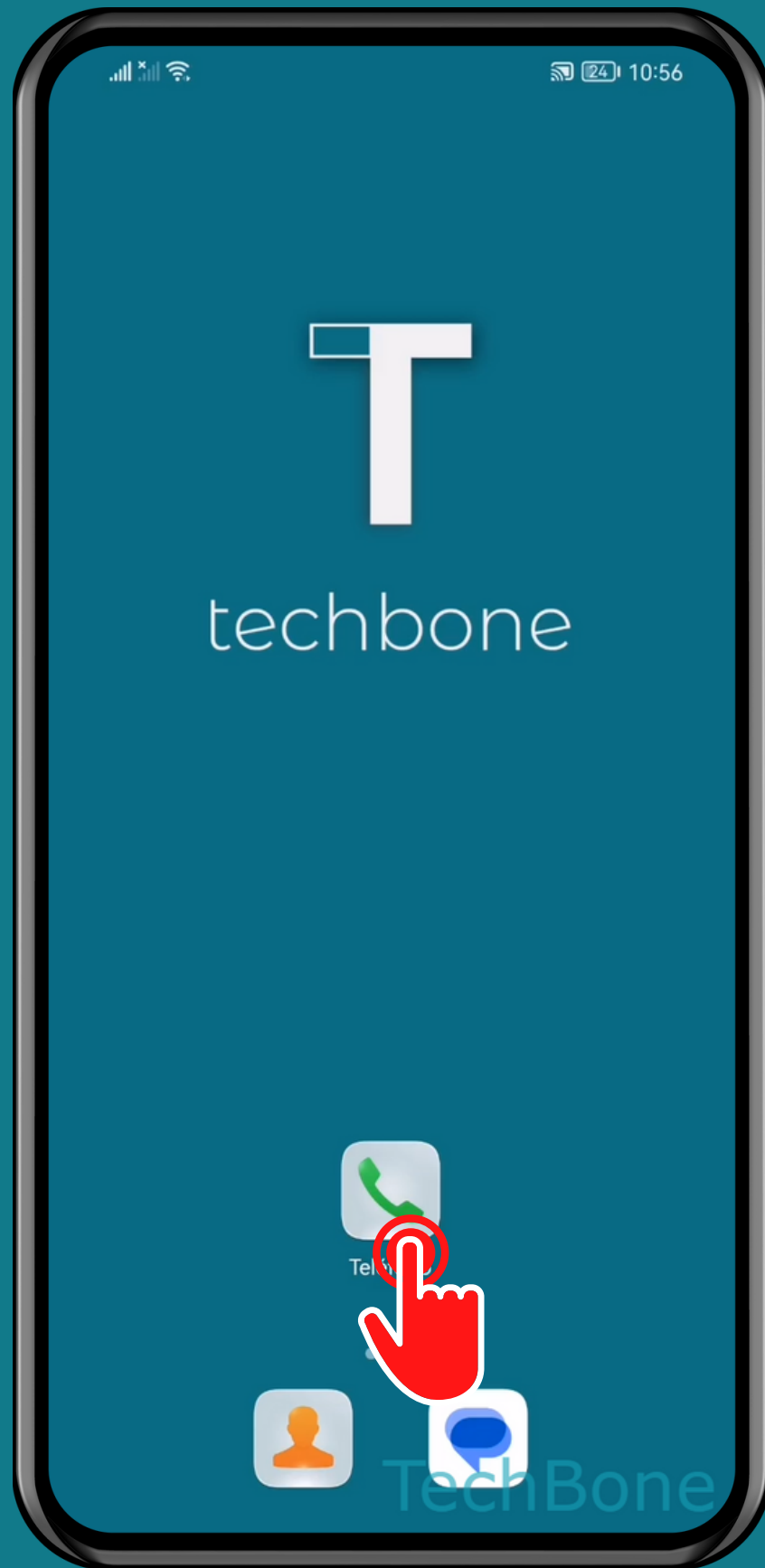

HUAWEI

Teléfono - Android 10 - EMUI 12

# QUITAR NÚMERO DE MARCACIÓN RÁPIDA



# Abre Teléfono

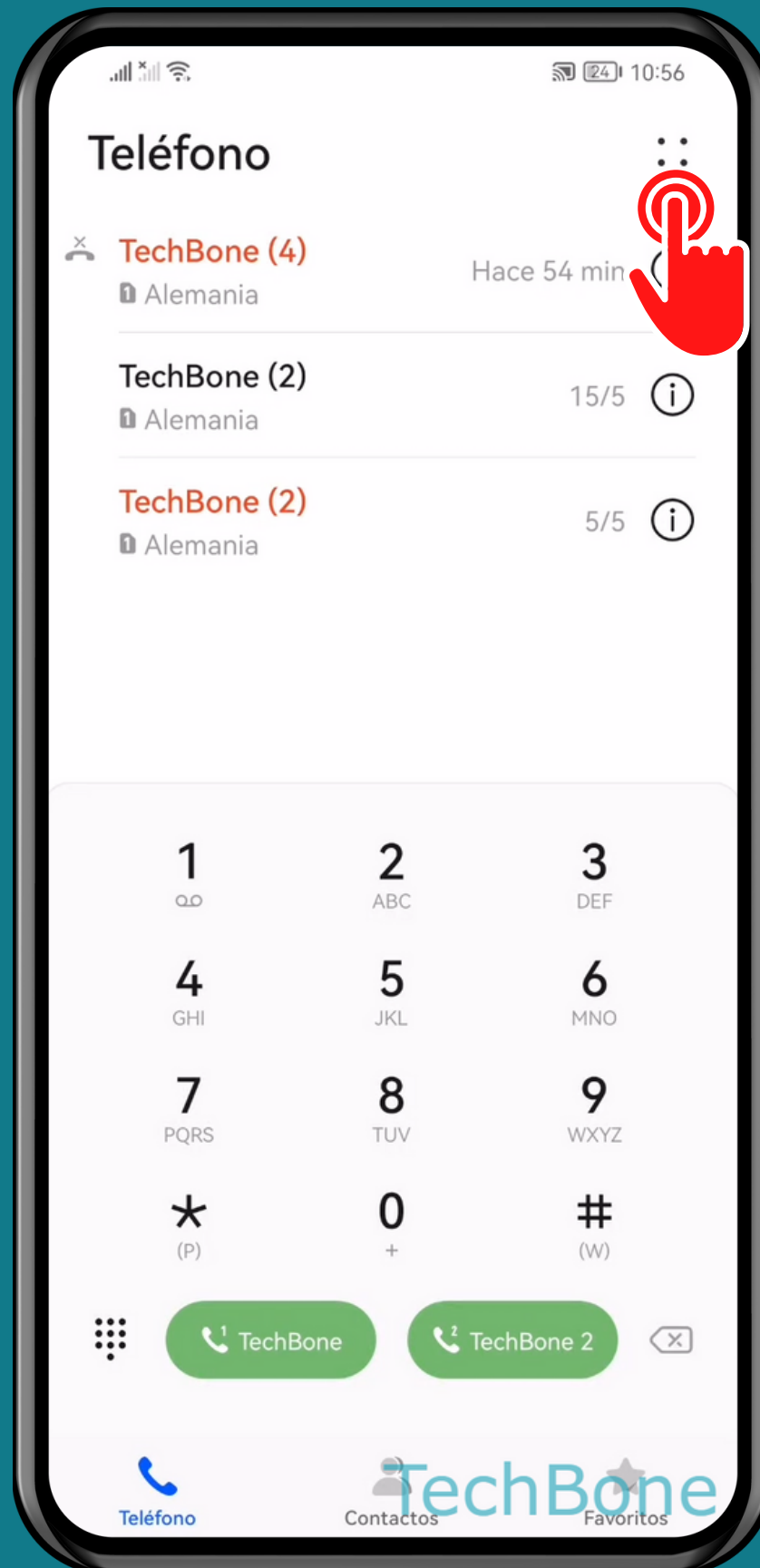

# Abre el Menú

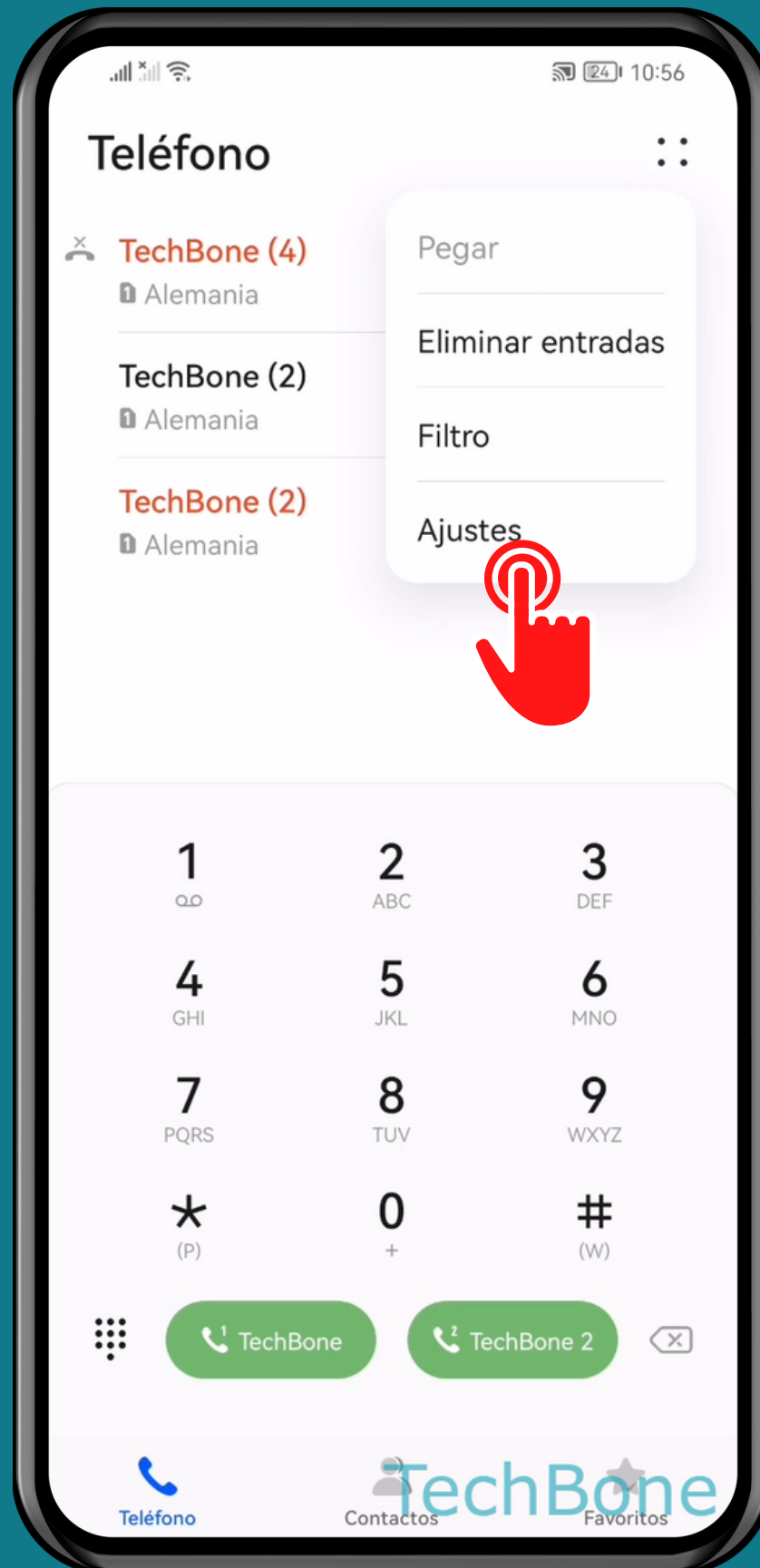

# Presiona Ajustes

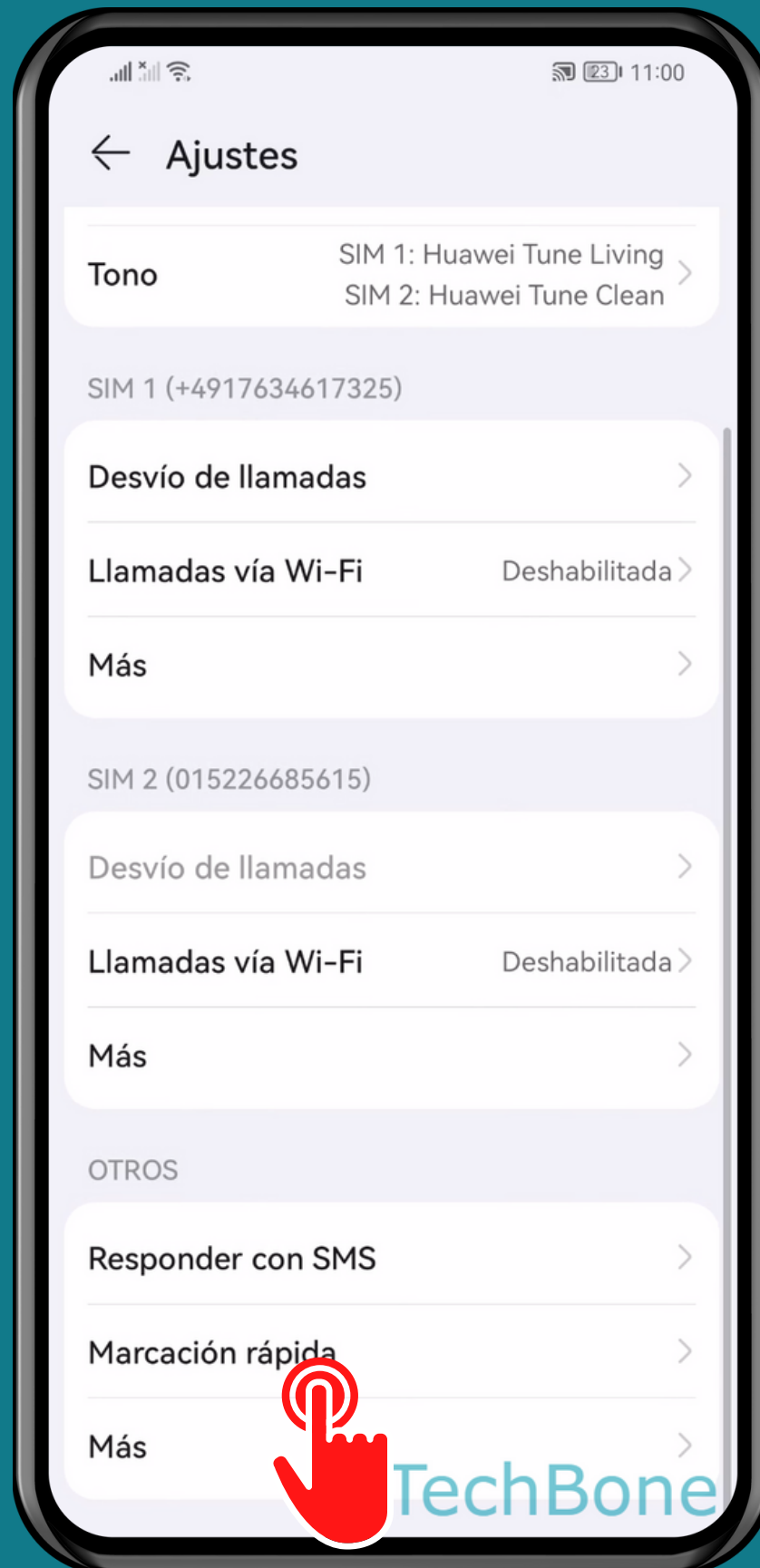

# Presiona Marcación rápida

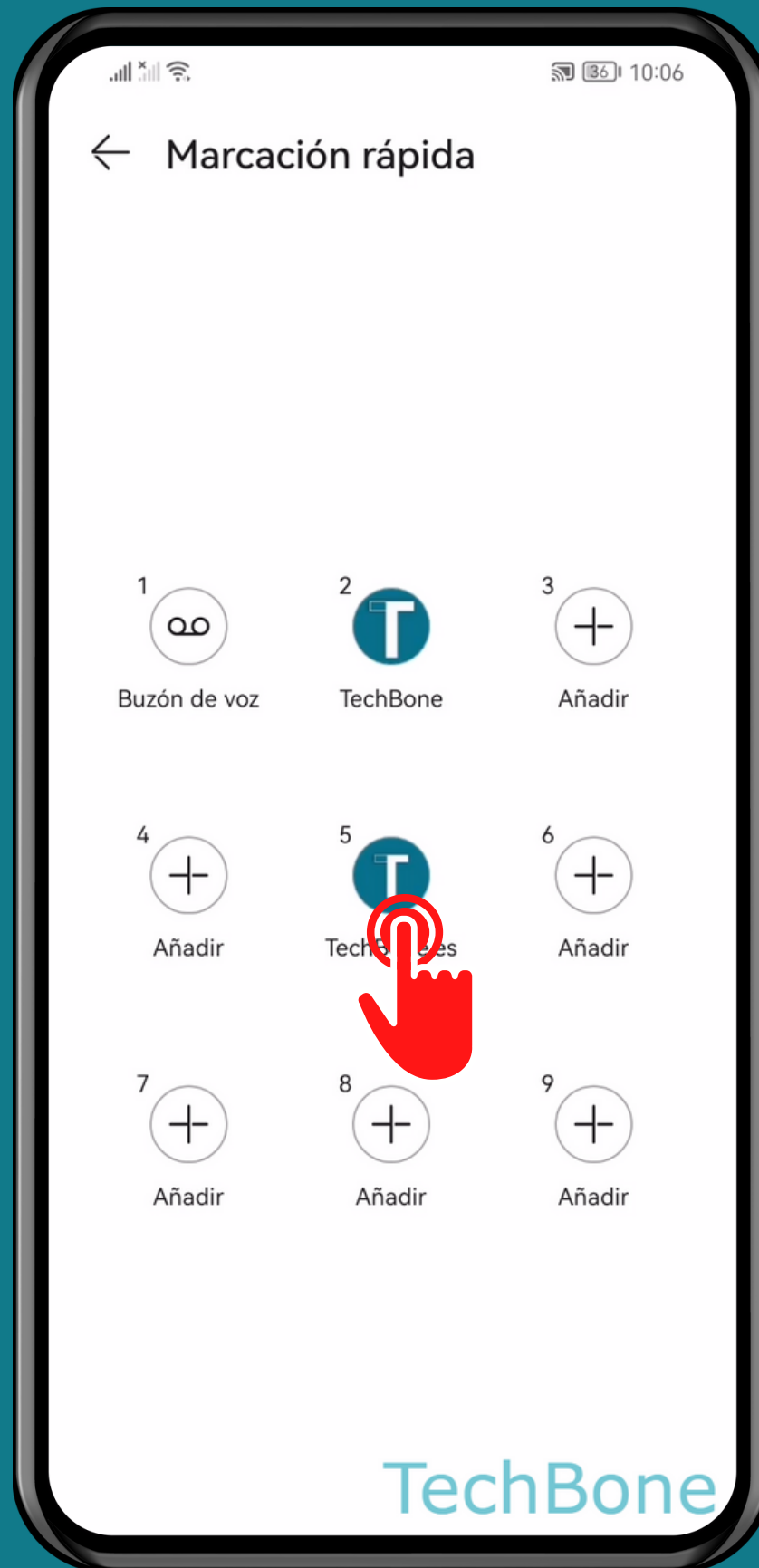

# Selecciona un Número



Selecciona  
Eliminar/Cambiar  
número asignado

¡Listo!