

ONEPLUS

Android 12 - OxygenOS 12

CAMBIAR LA CONFIGURACIÓN USB PREDETERMINADA

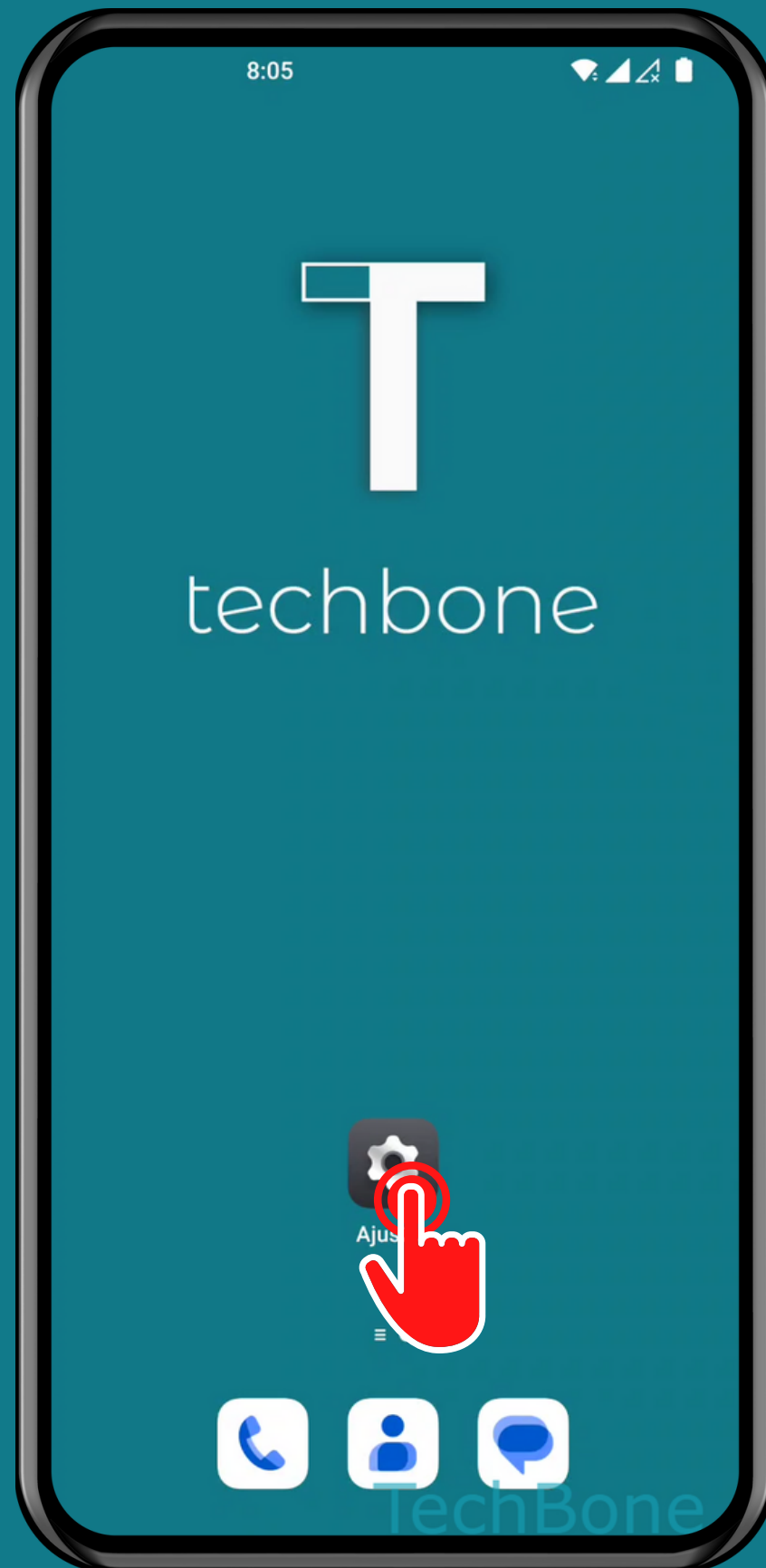

Abre los Ajustes

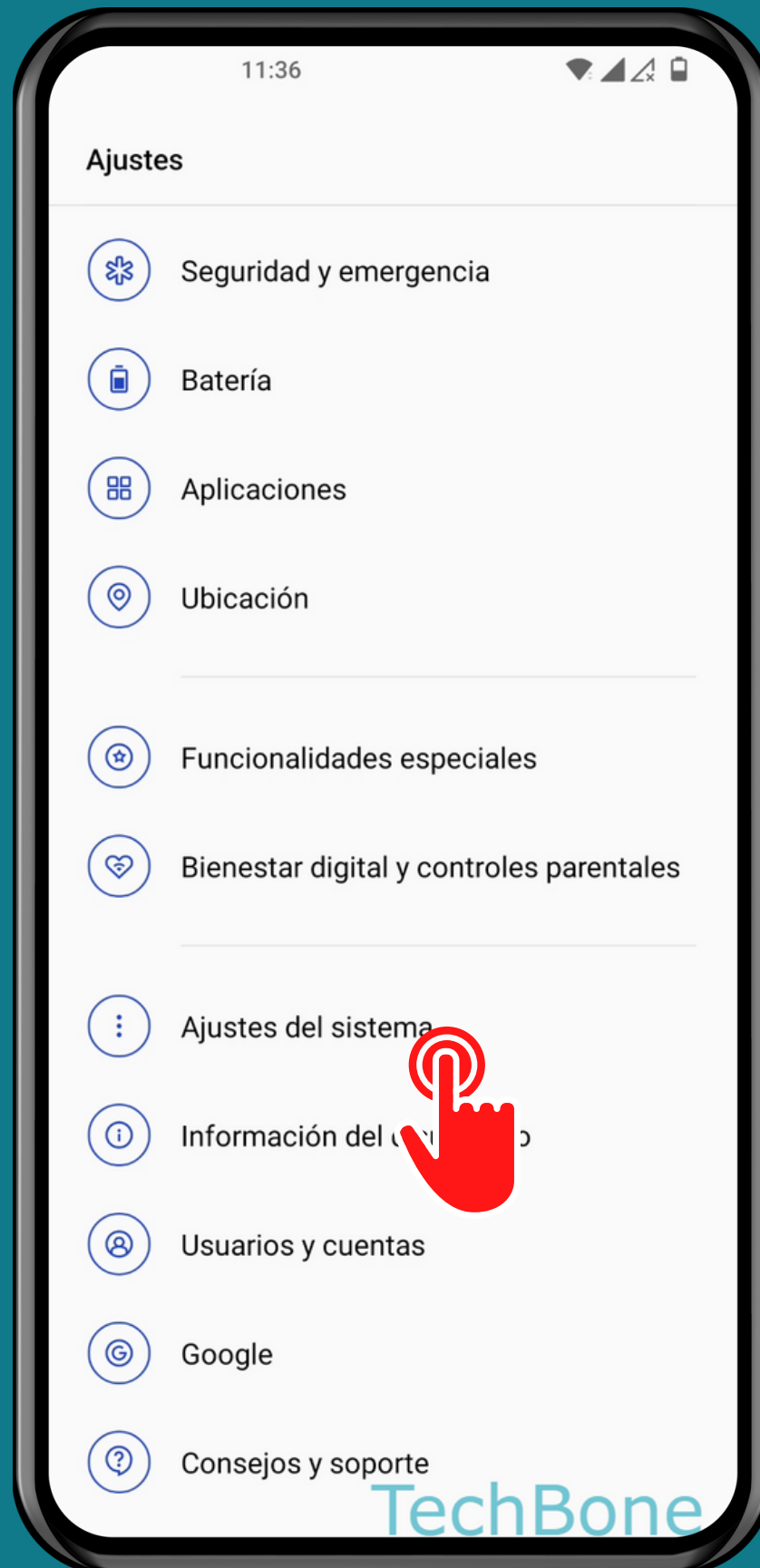

Presiona Ajustes del sistema

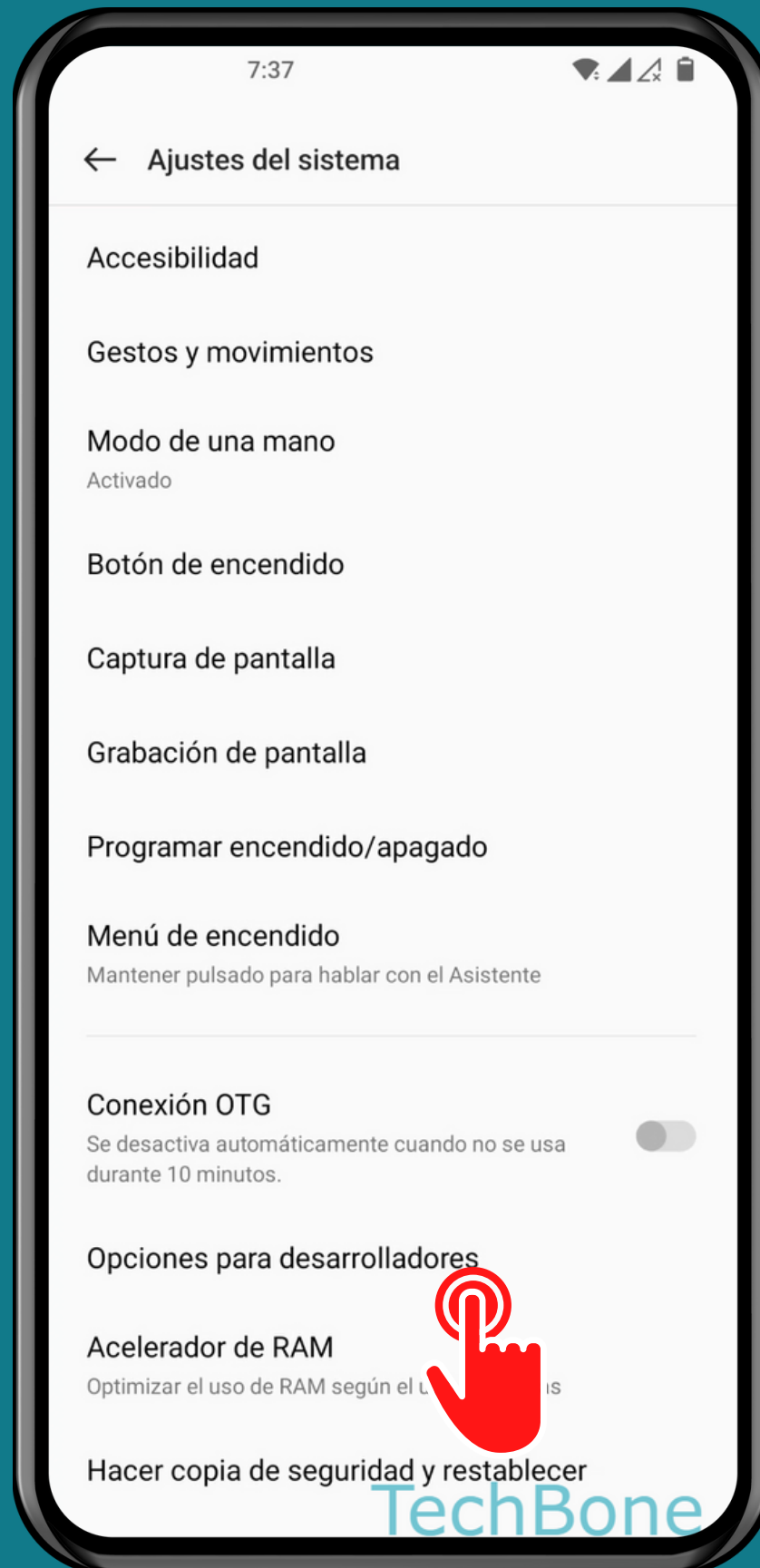

Presiona Opciones para desarrolladores

TechBone

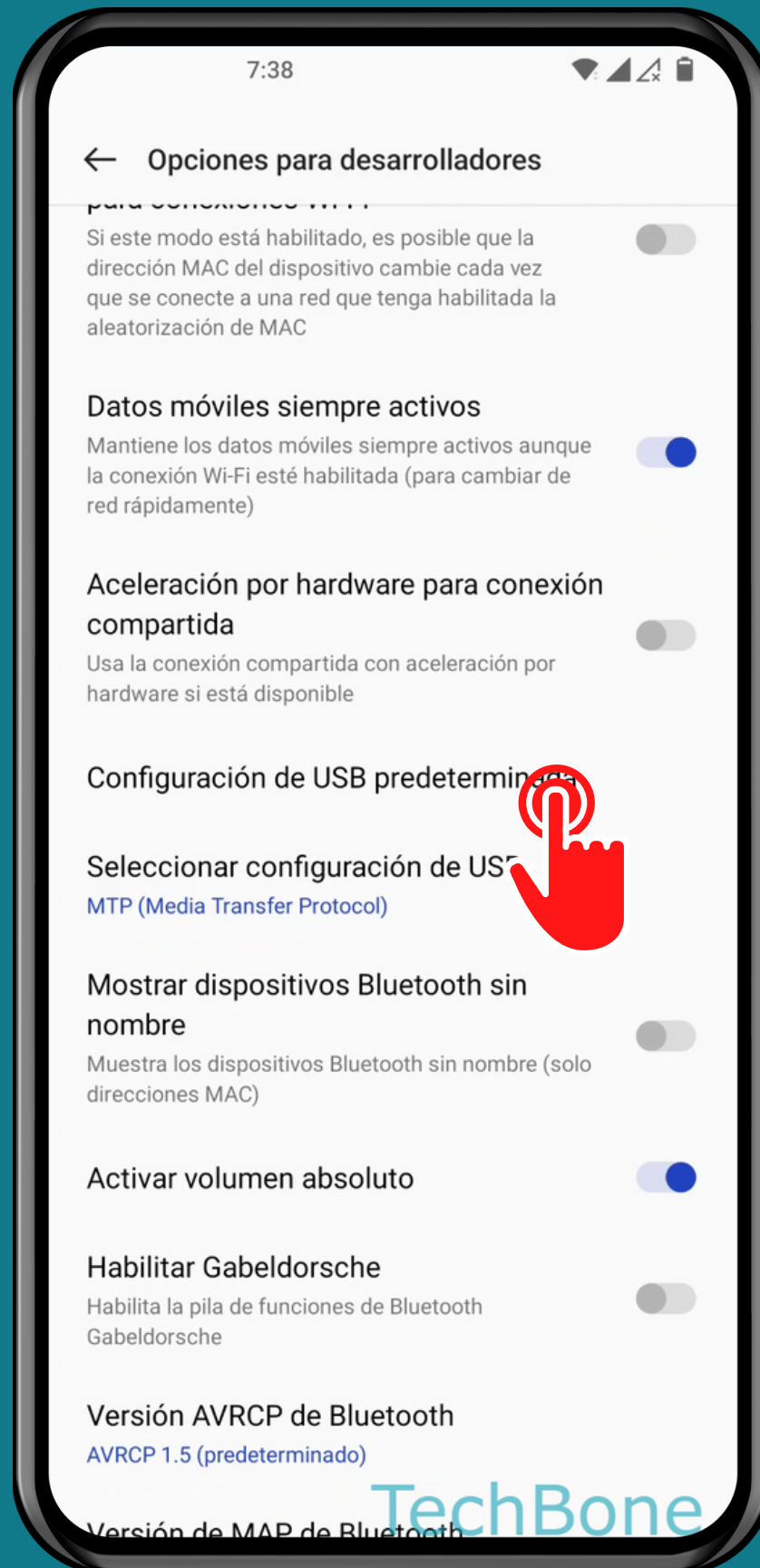

Presiona Configuración de USB predeterminada

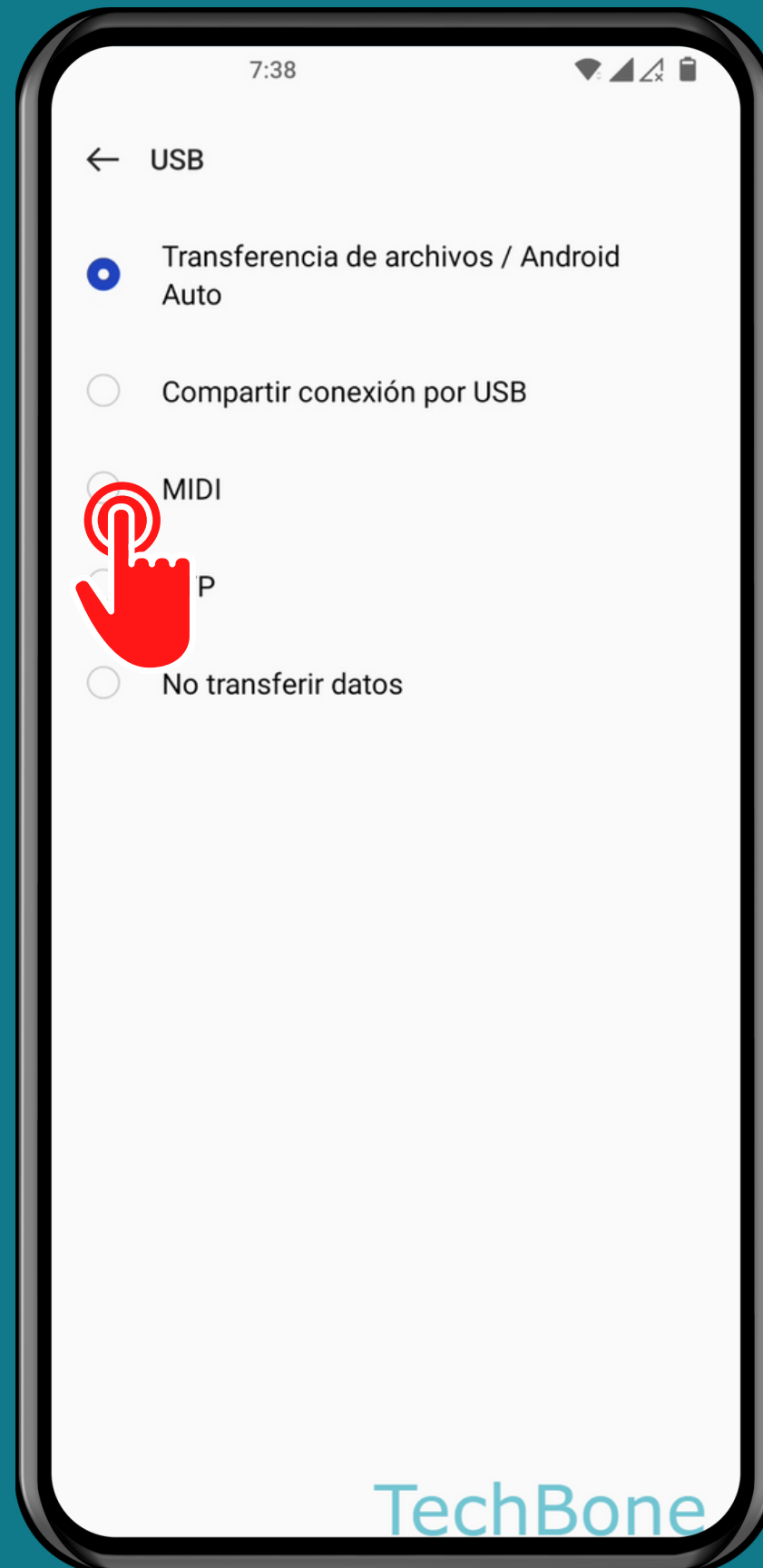

Establece la Configuración de USB predeterminada

¡Listo!