

REALME

Android 11 - realme UI 2

HOW TO ADD A PRINTER BY IP ADDRESS



Tap on
Settings

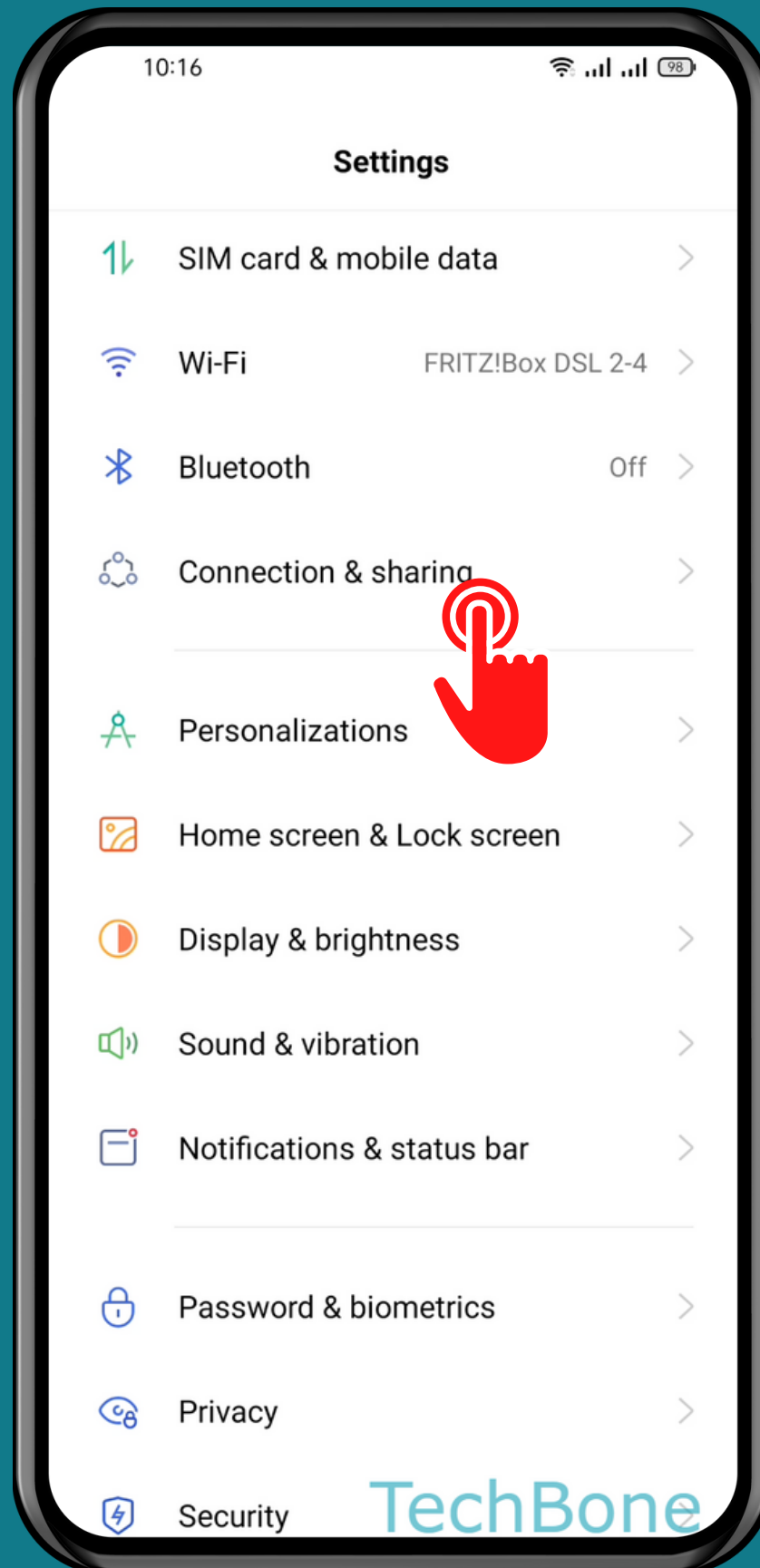

Tap on Connection & sharing

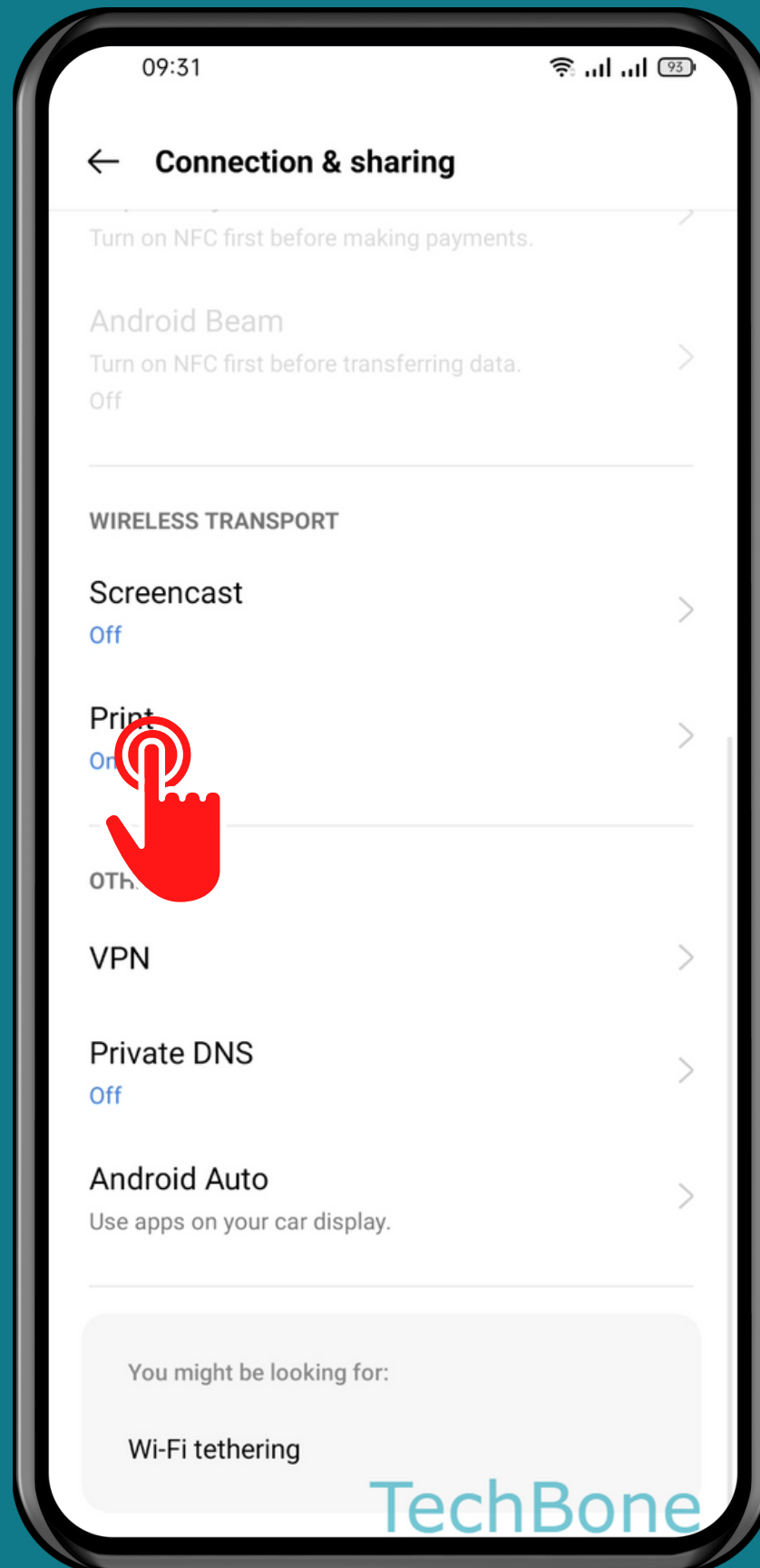

Tap on
Print

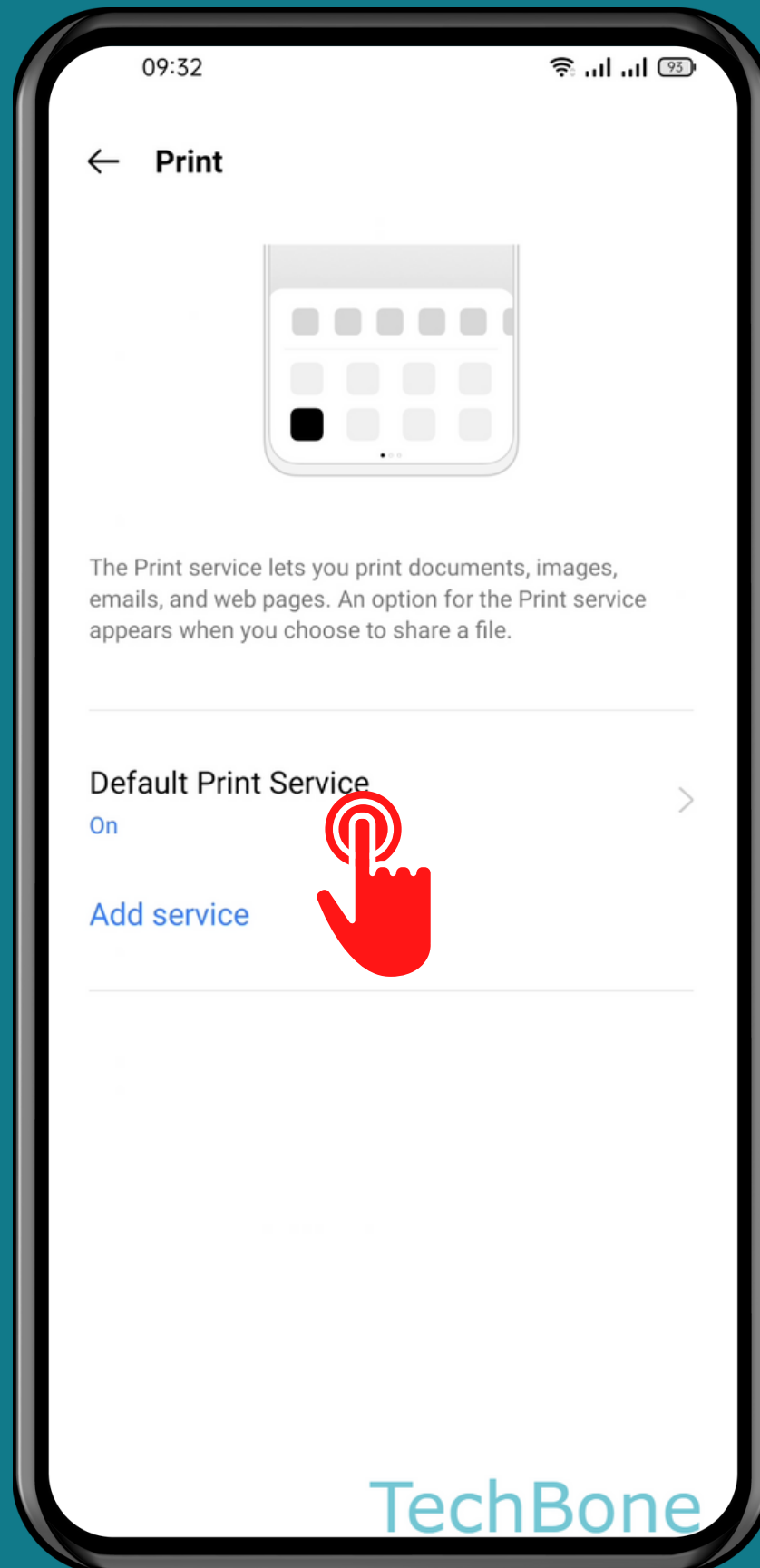

Tap on Default Print Service

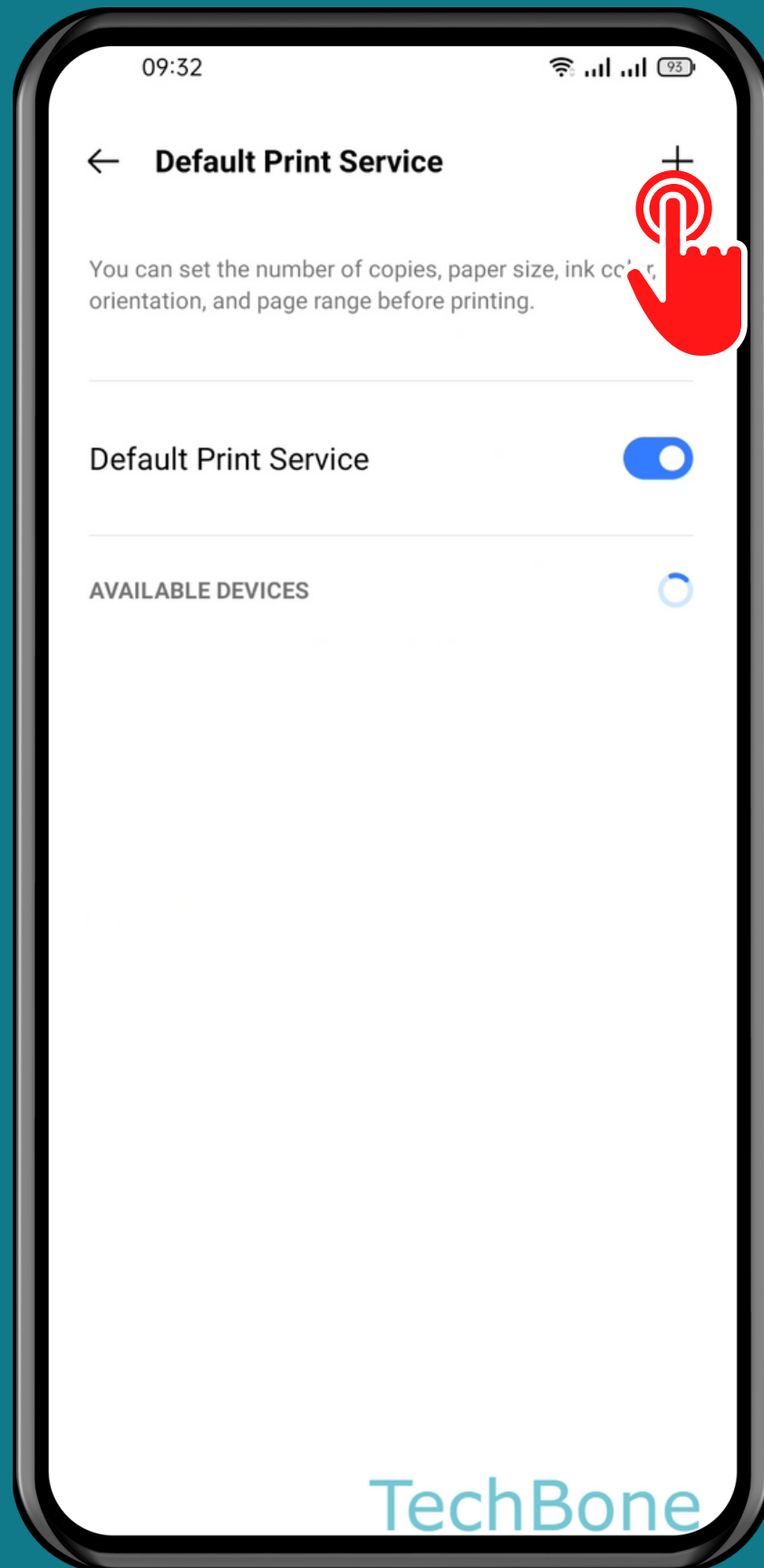

Tap on
Add

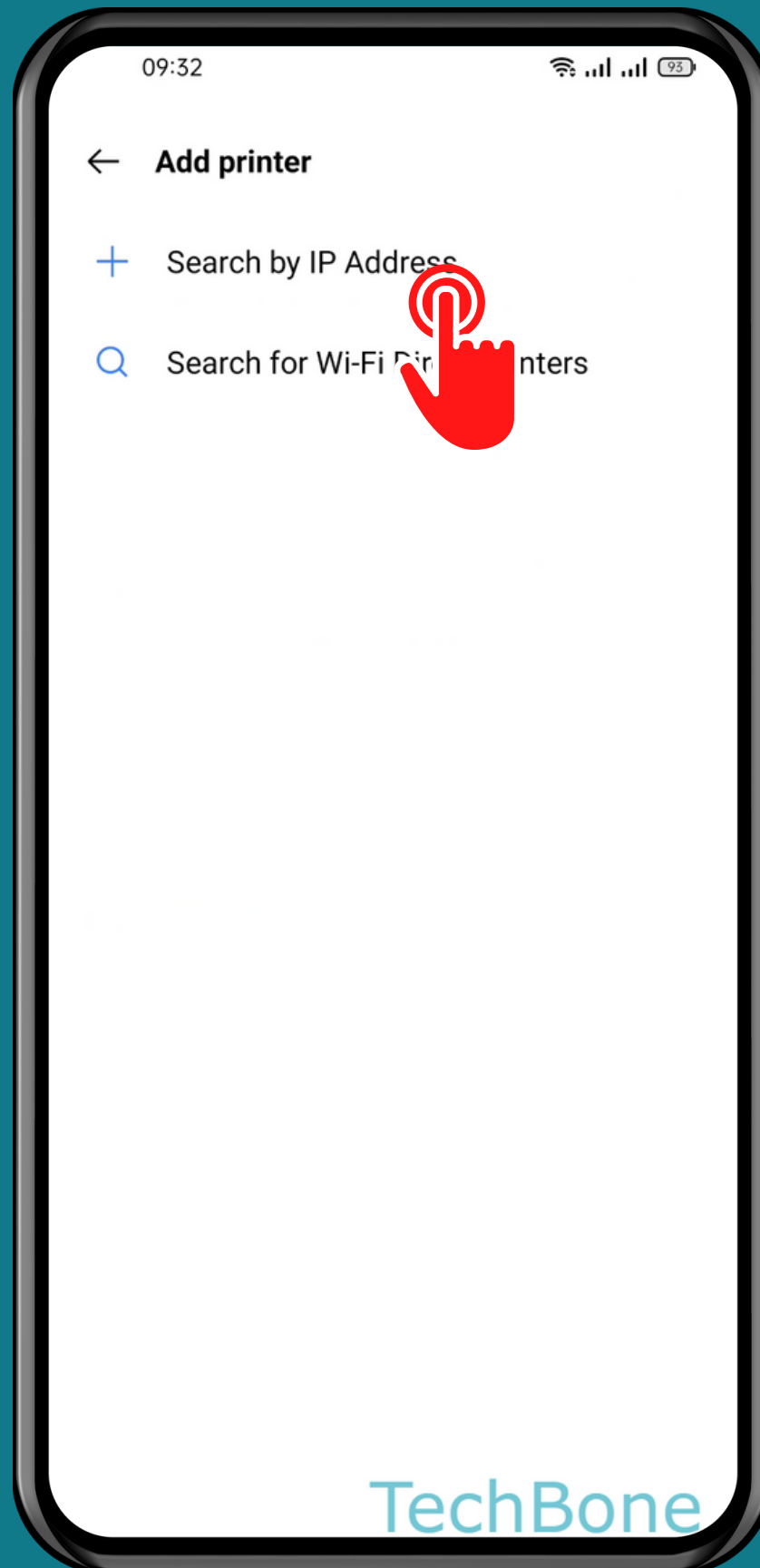

Tap on
Search by IP Address

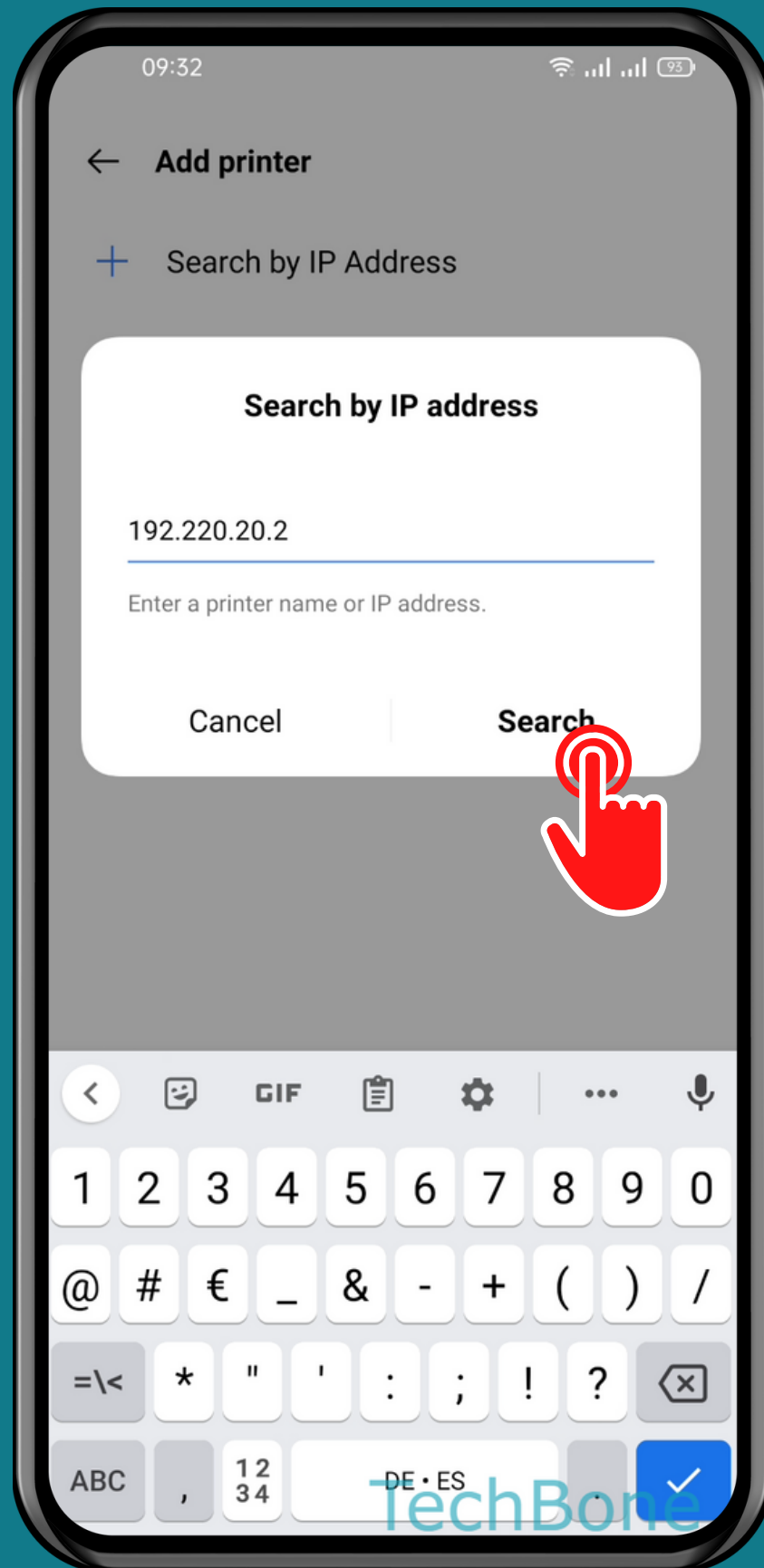

Enter a
Printer name/IP Address
and tap on Search

Done!