

REALME

Phone - Android 11 - realme UI 2

# HOW TO TURN ON/OFF CALL FORWARDING

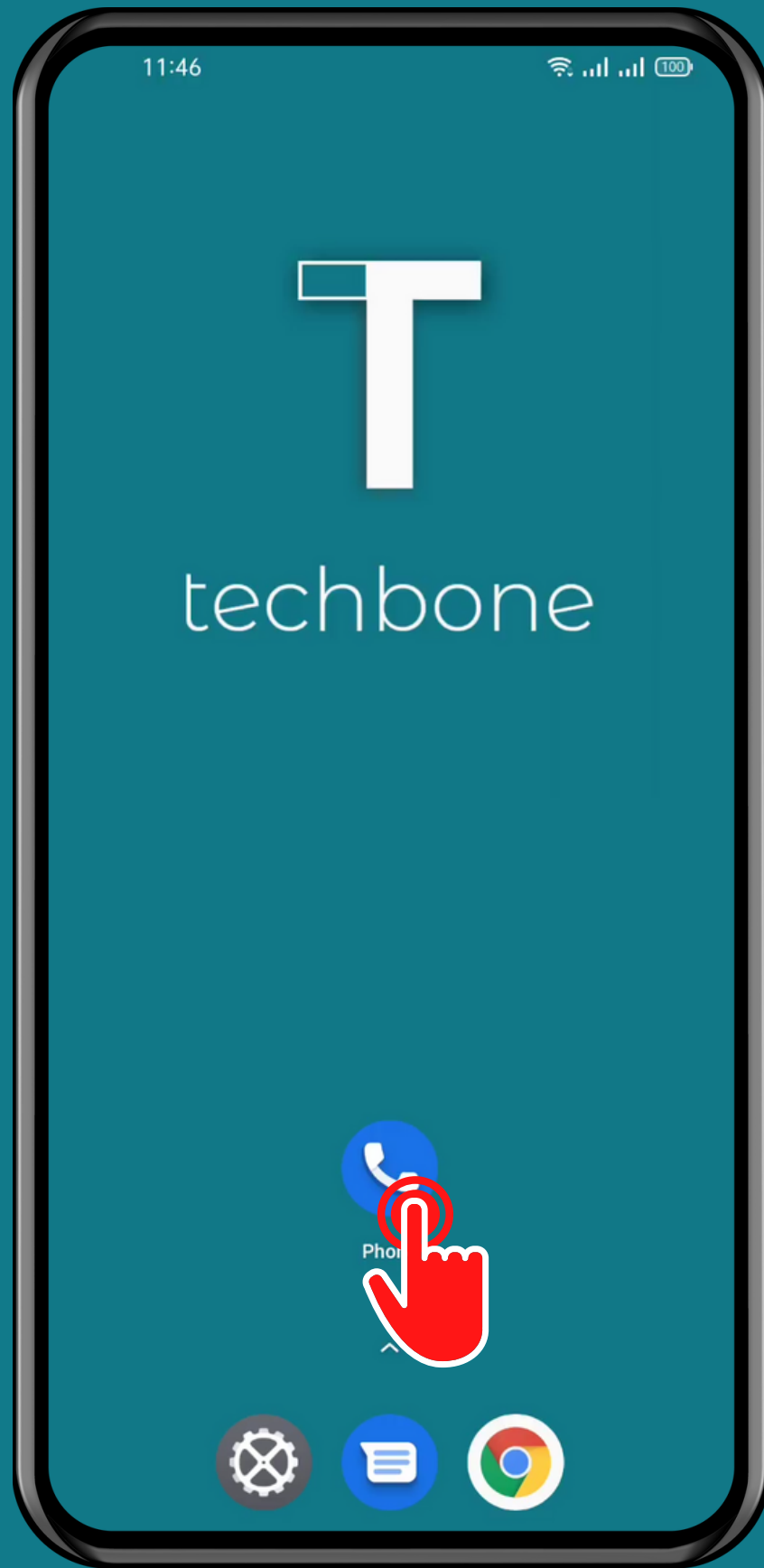

# Tap on Phone

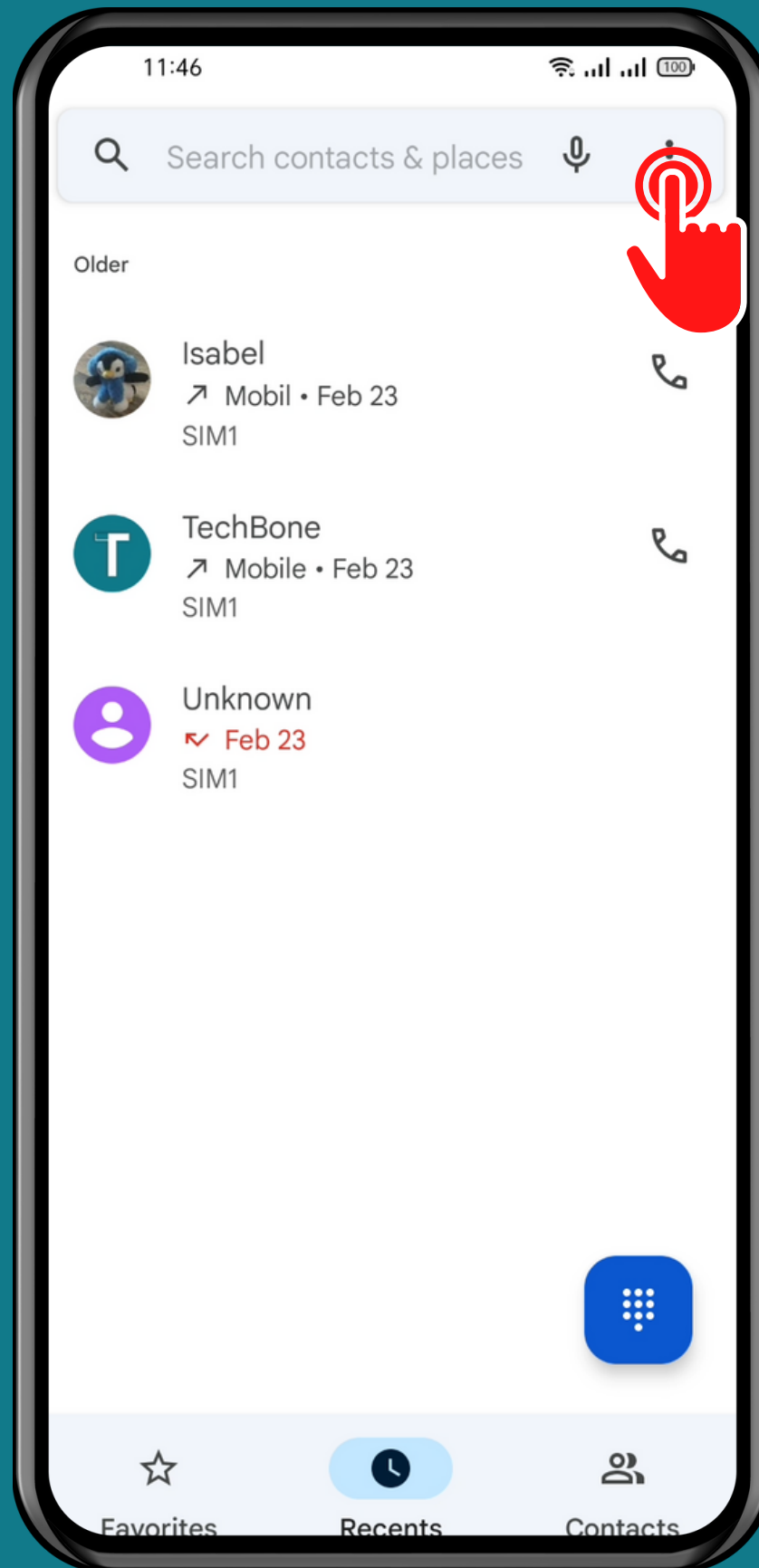

# Open the Menu

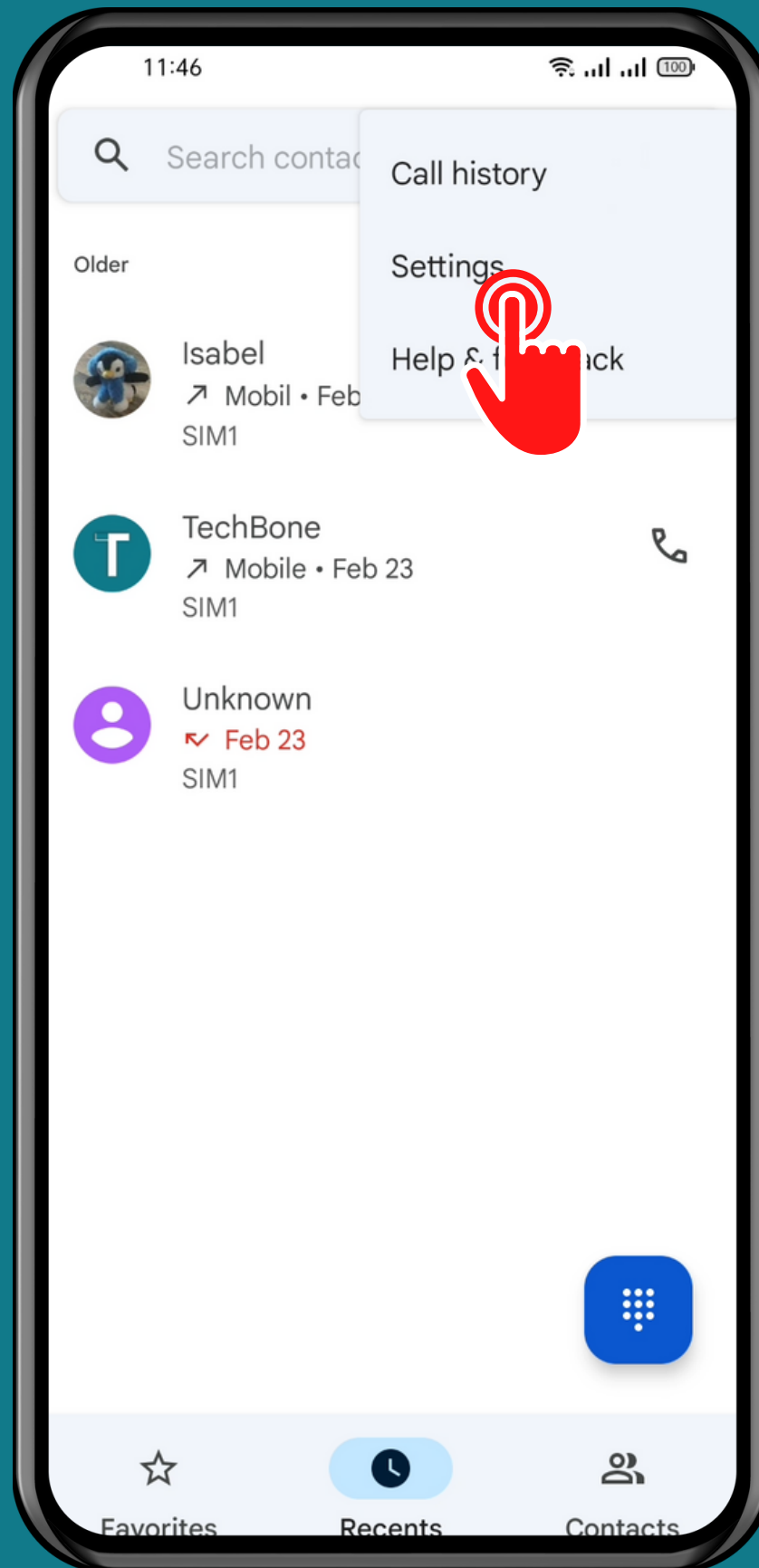

# Tap on Settings

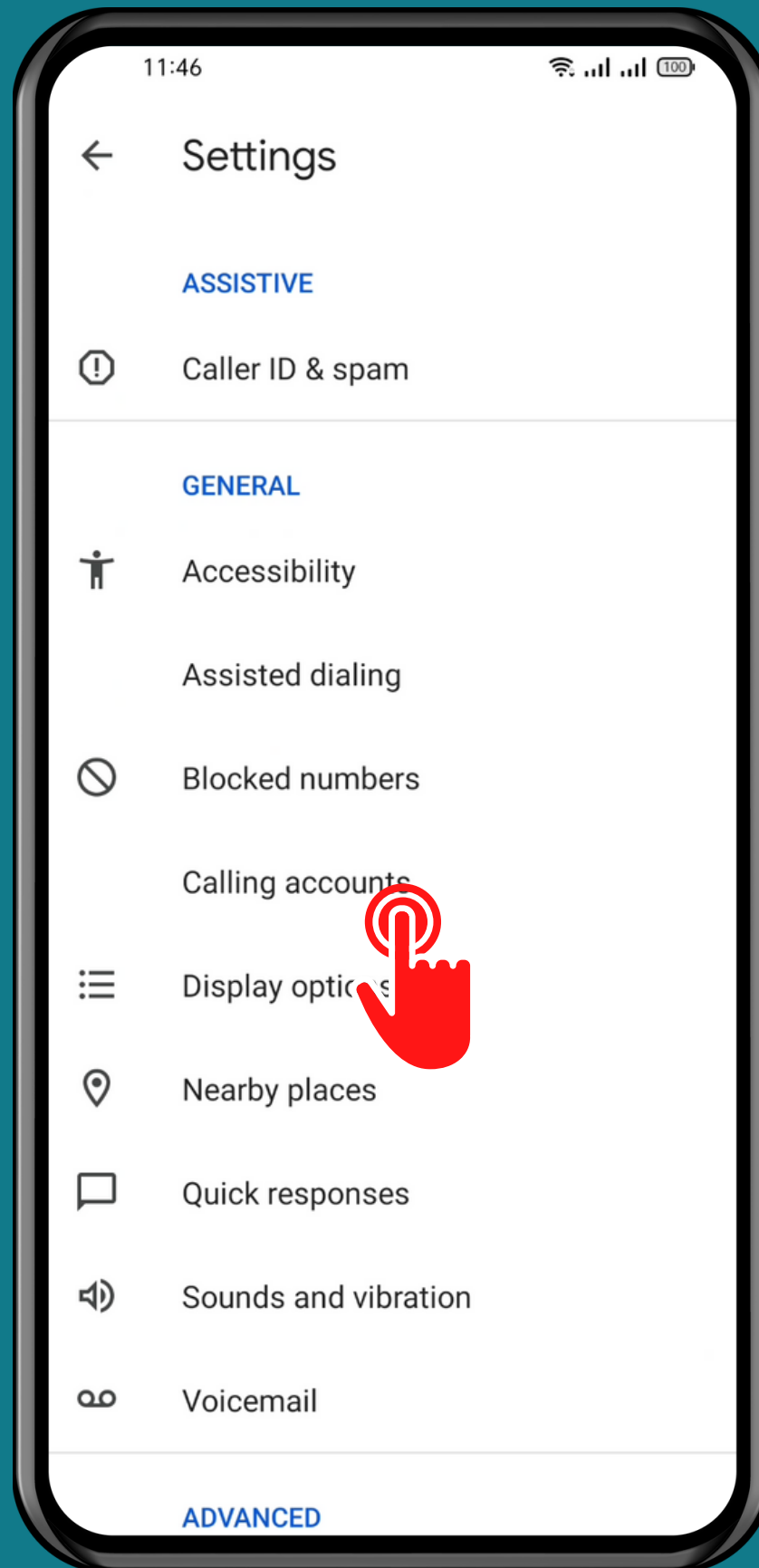

# Tap on Calling accounts

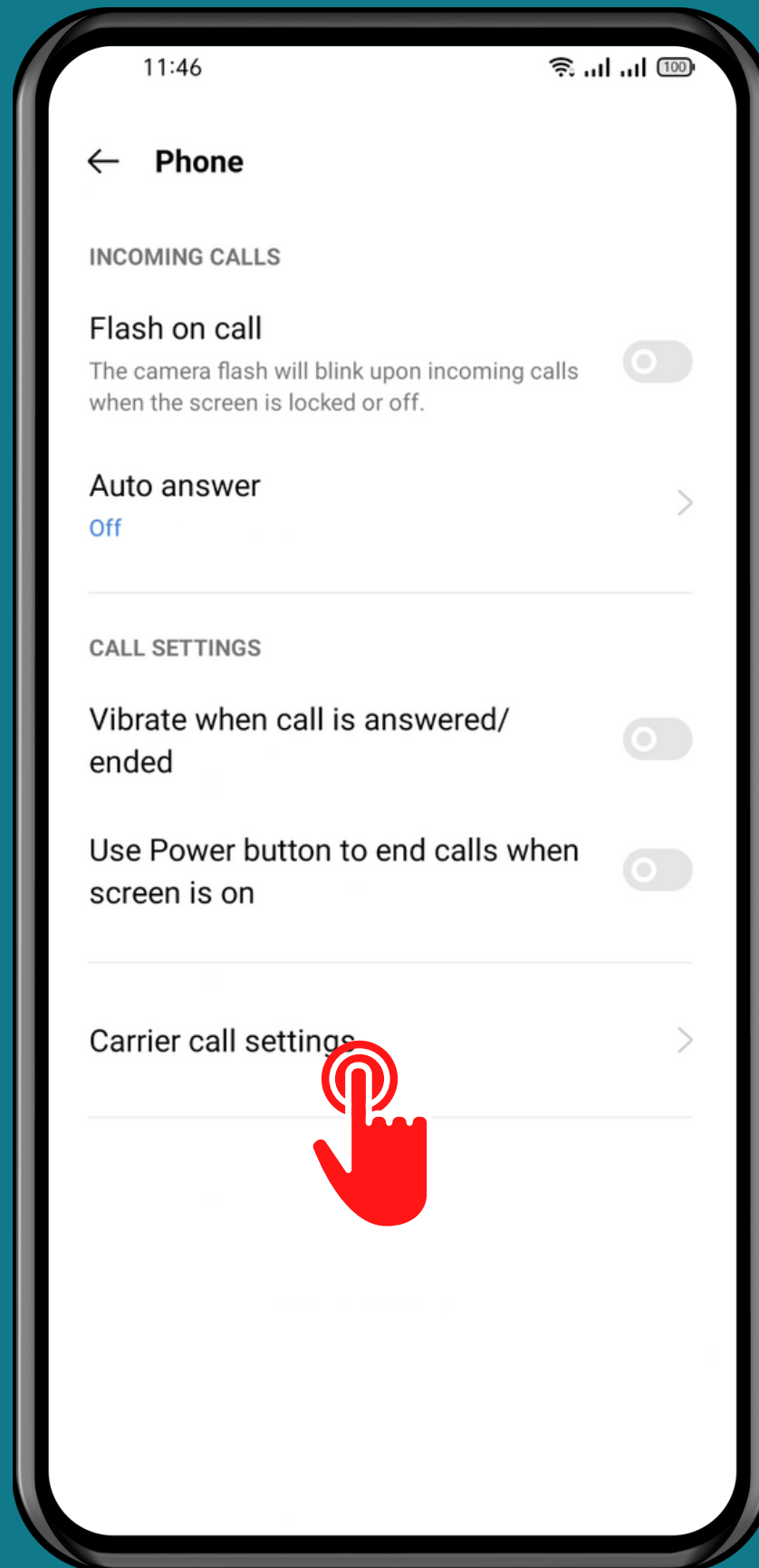

# Tap on Carrier call settings

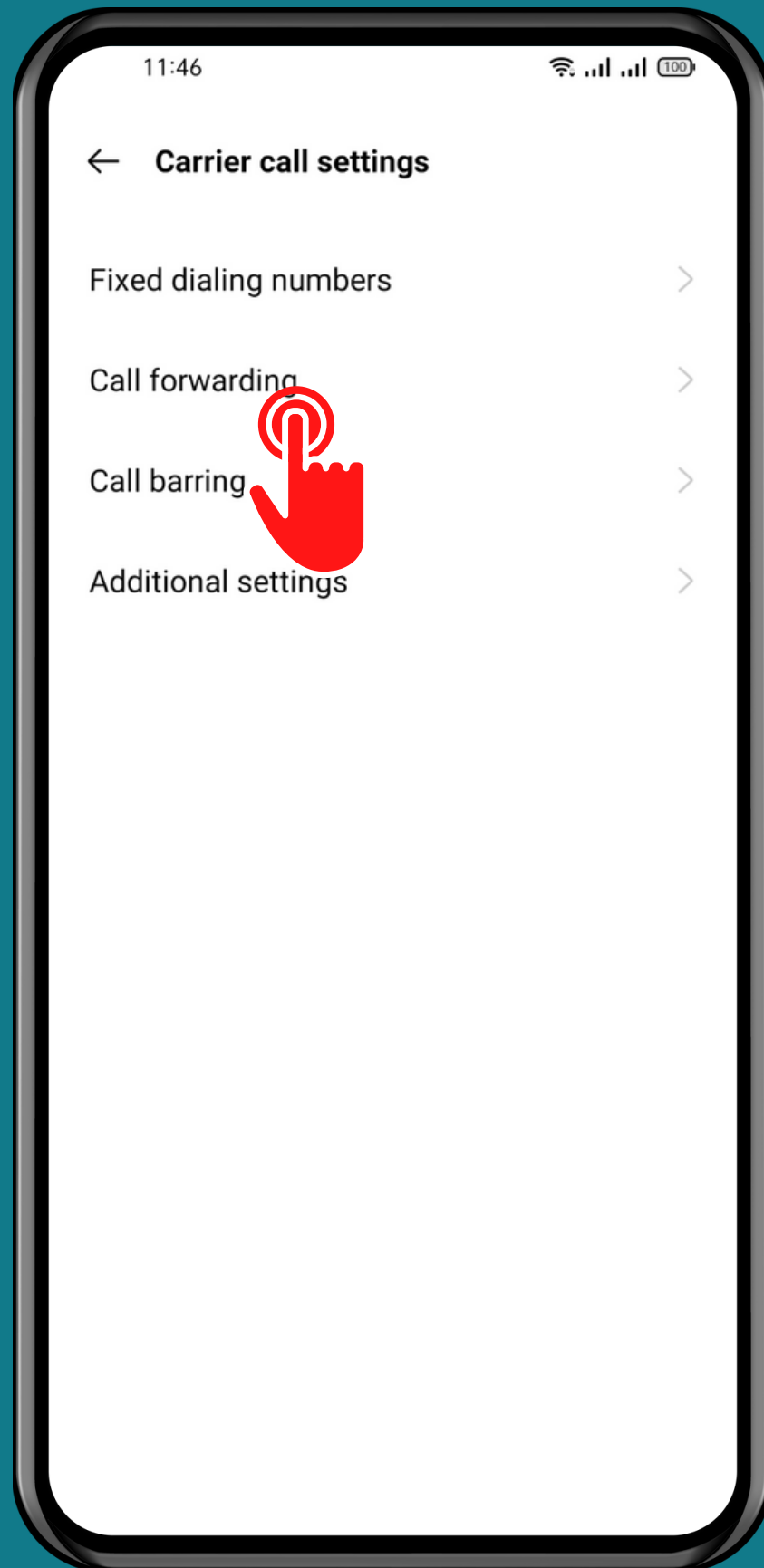

Tap on  
Call forwarding

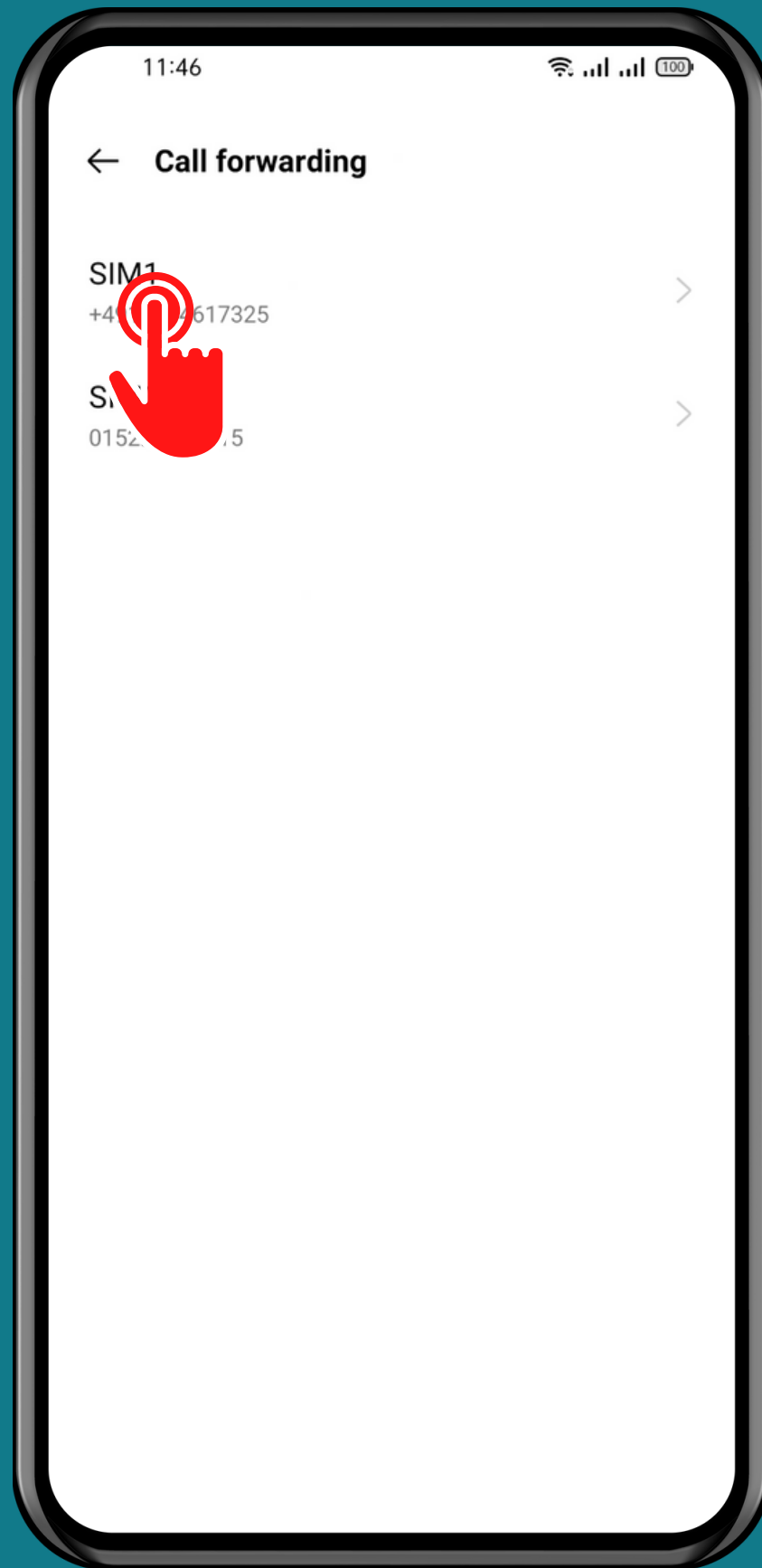

Choose a  
**SIM card** (Dual SIM)



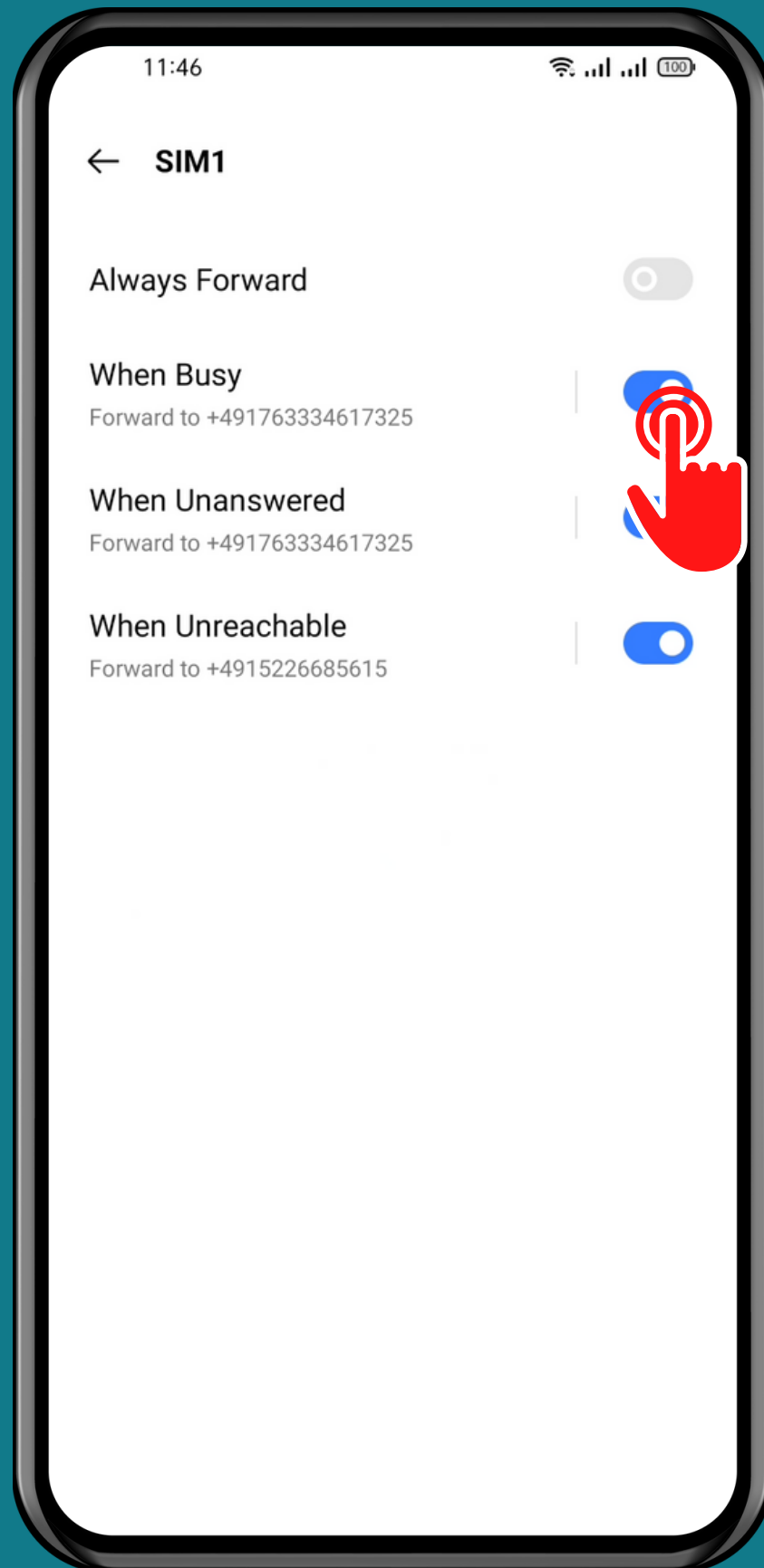

# Turn On/Off an Option

Done!