

REALME

Android 11 - realme UI 2

# HOW TO SHOW/HIDE NEXT-WORD SUGGESTIONS



Tap on  
Settings

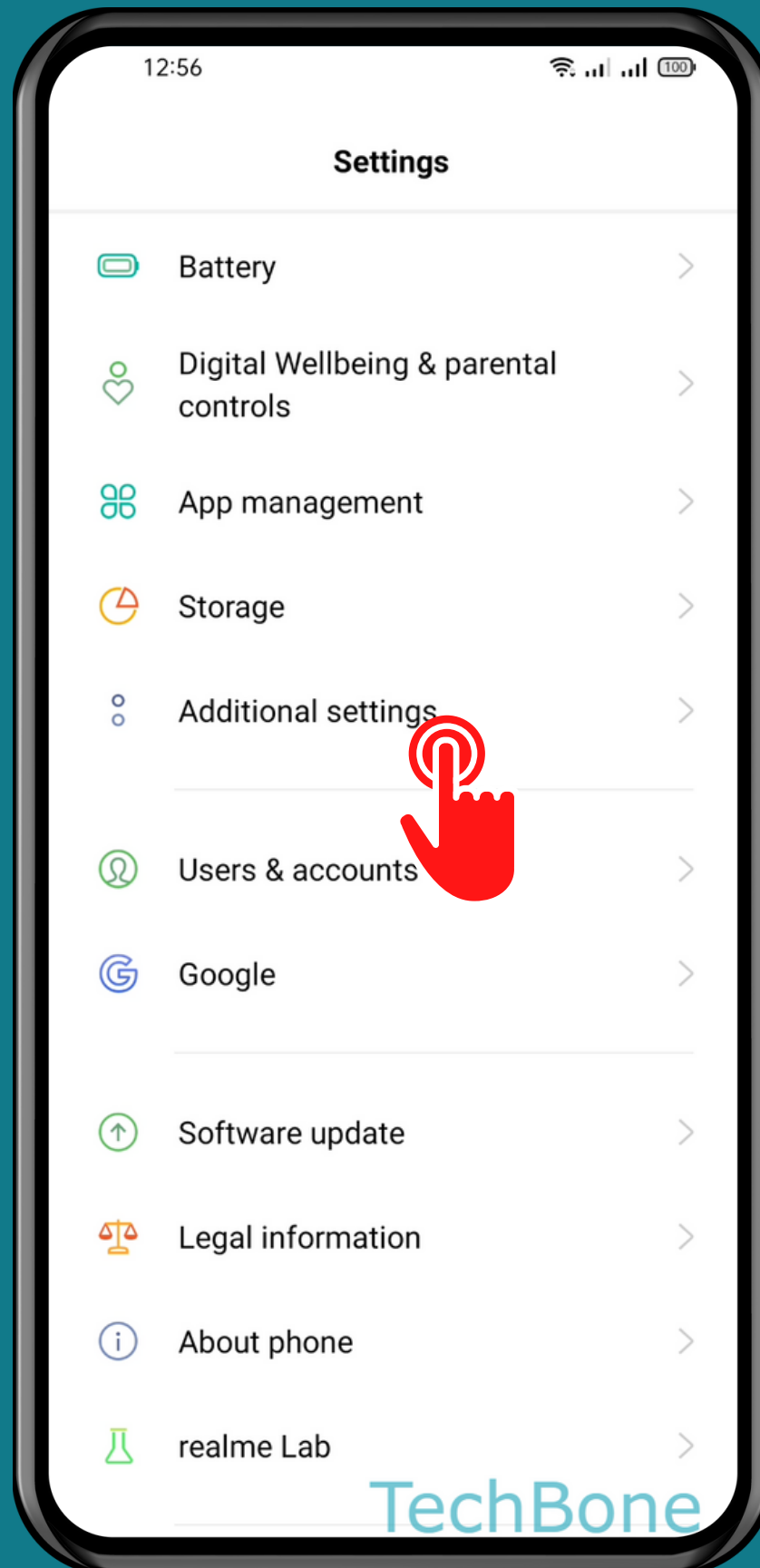

Tap on  
Additional settings

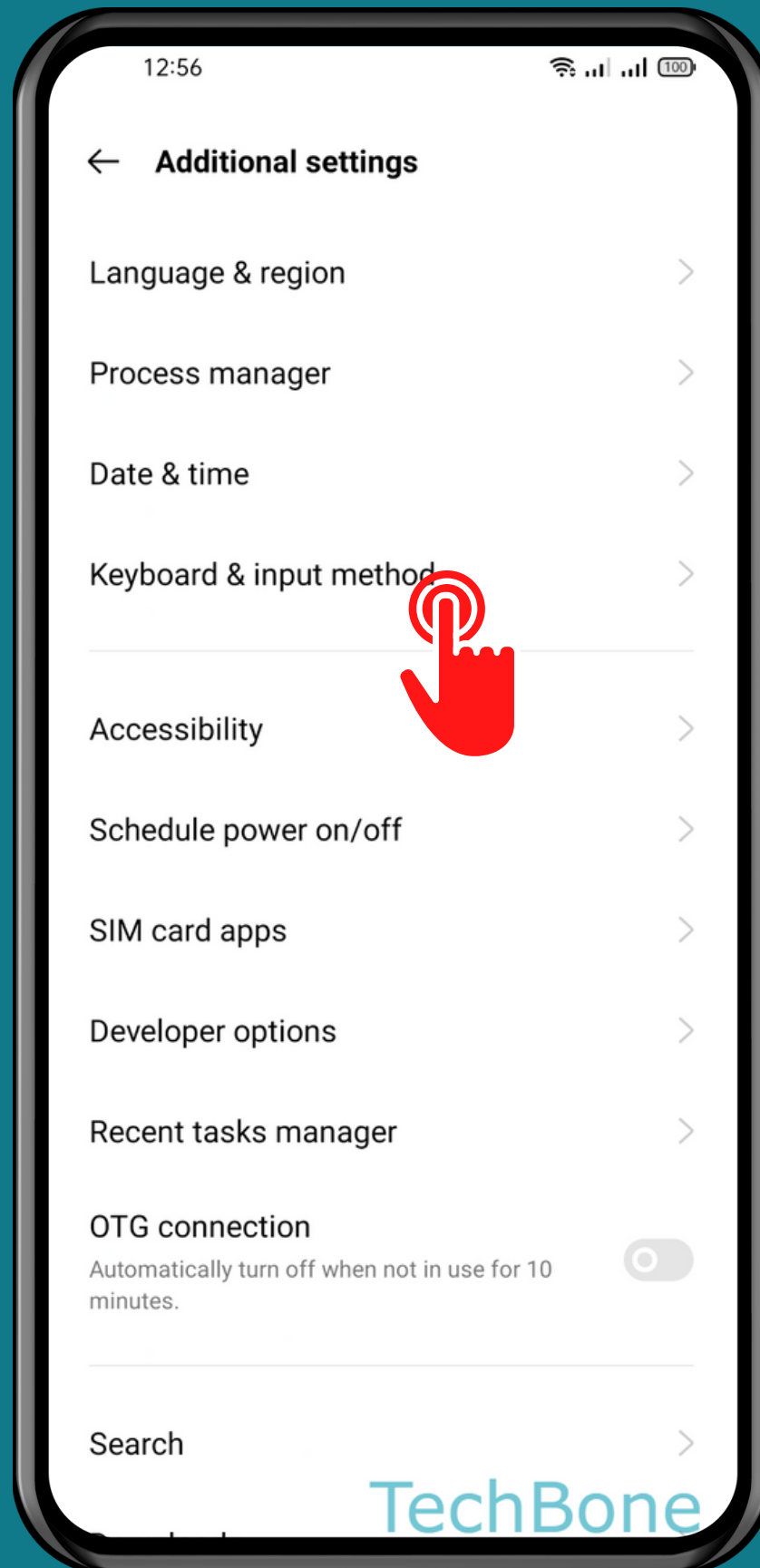

# Tap on Keyboard & input method

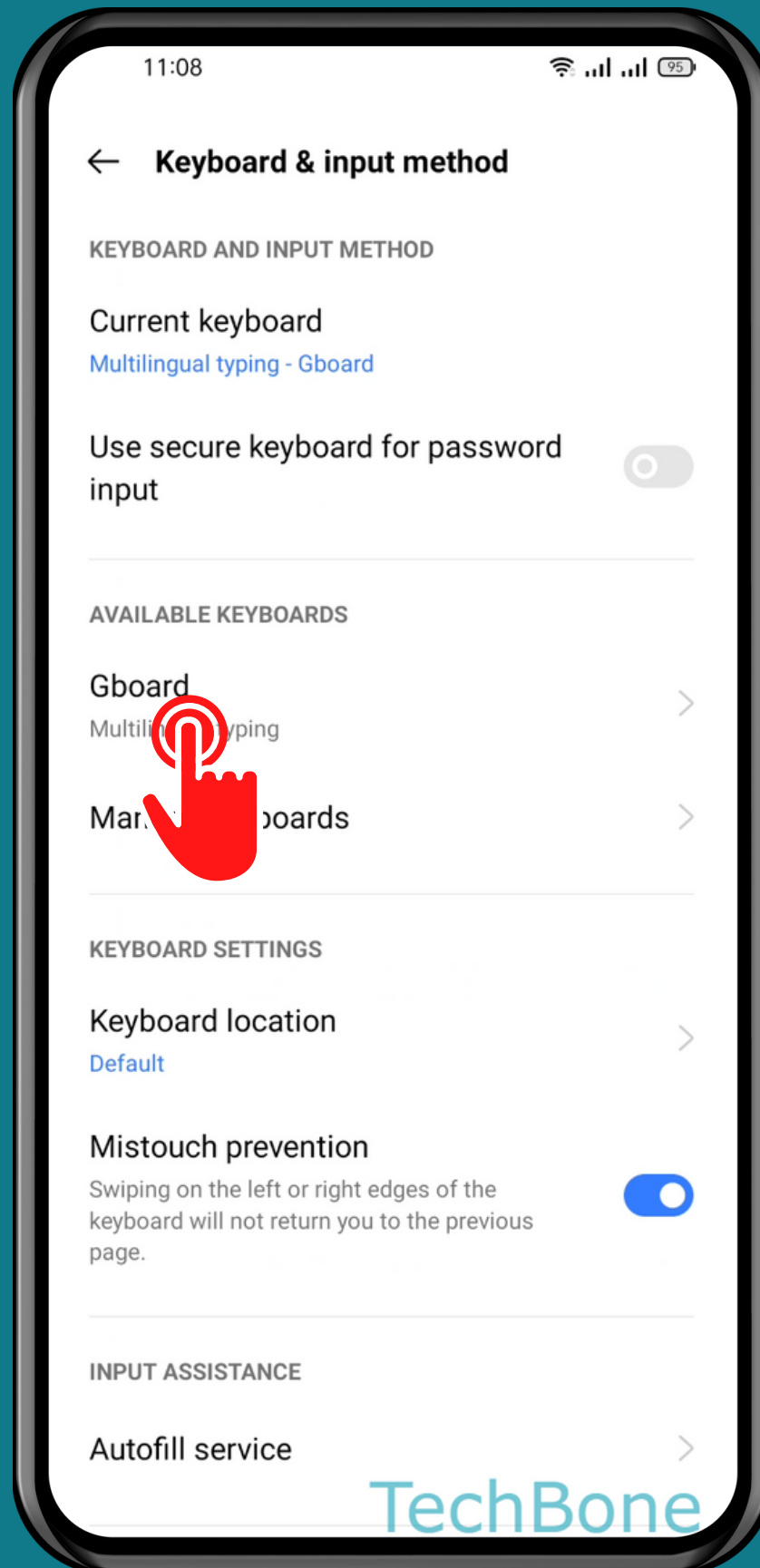

Tap on  
Gboard

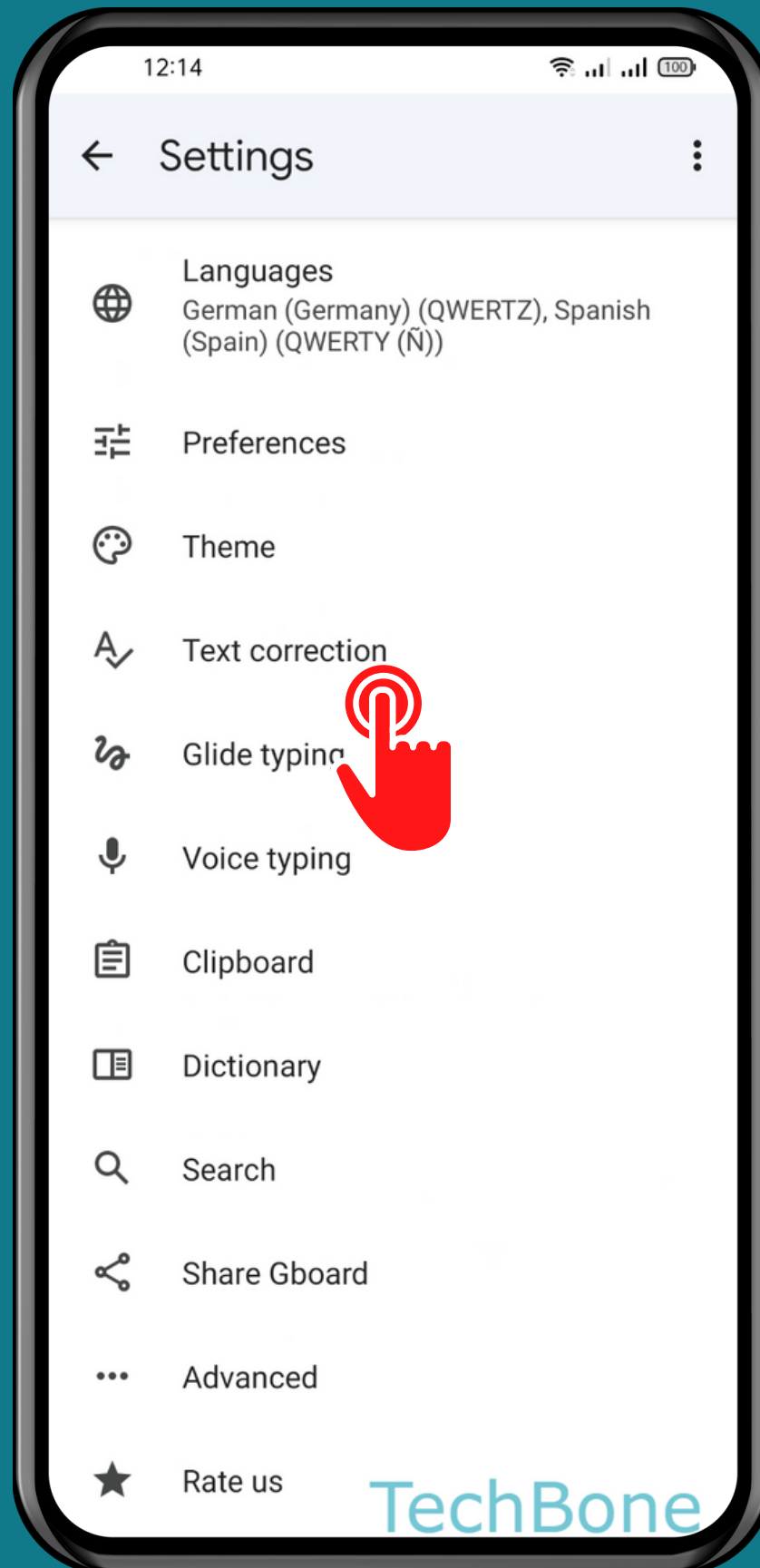

Tap on  
Text correction



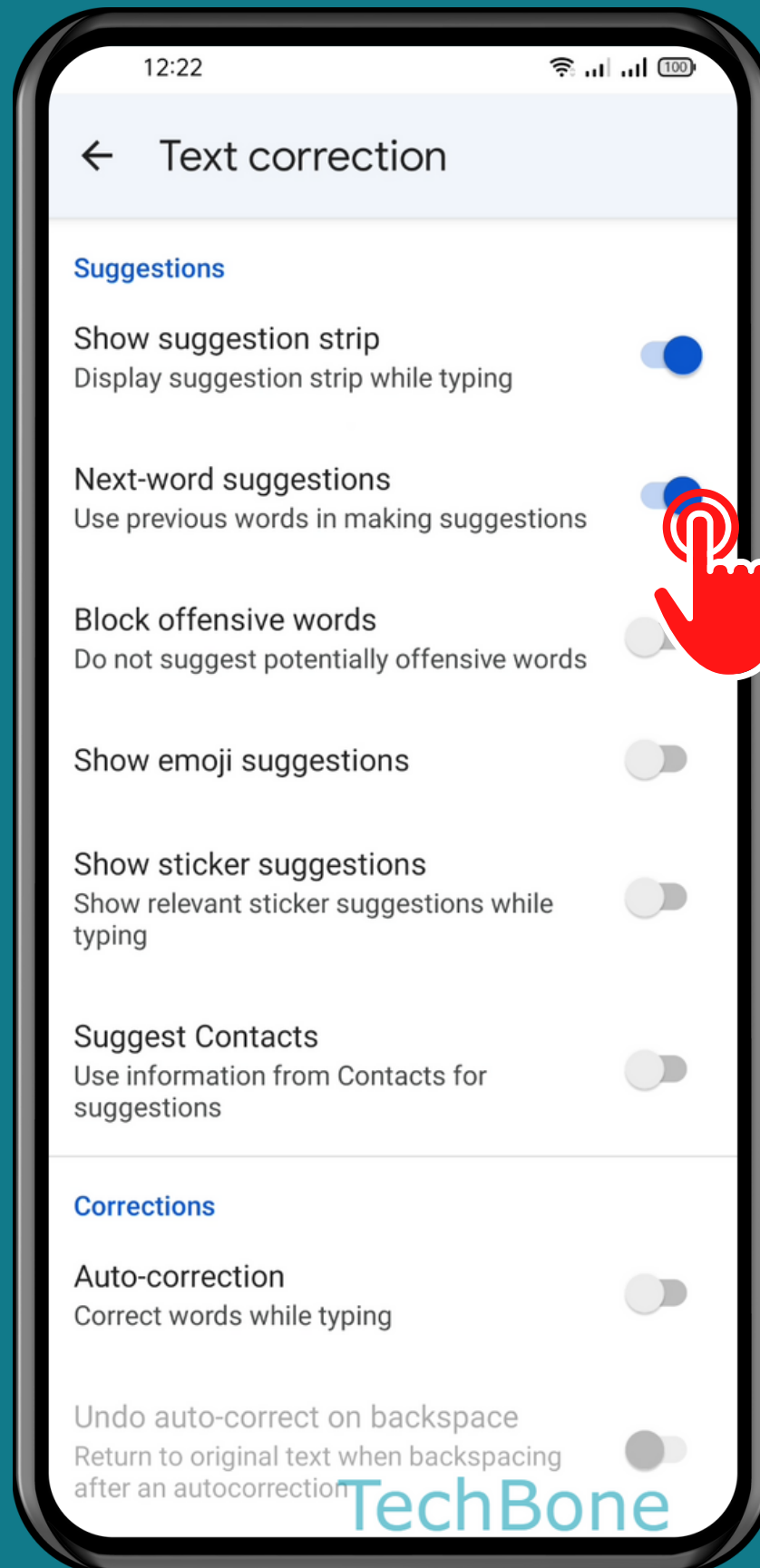

# Turn On/Off Next-word suggestions

Done!