

SAMSUNG

Android 11 - One UI 3

HOW TO ADD AN ALTERNATIVE LOOK



Tap on
Settings

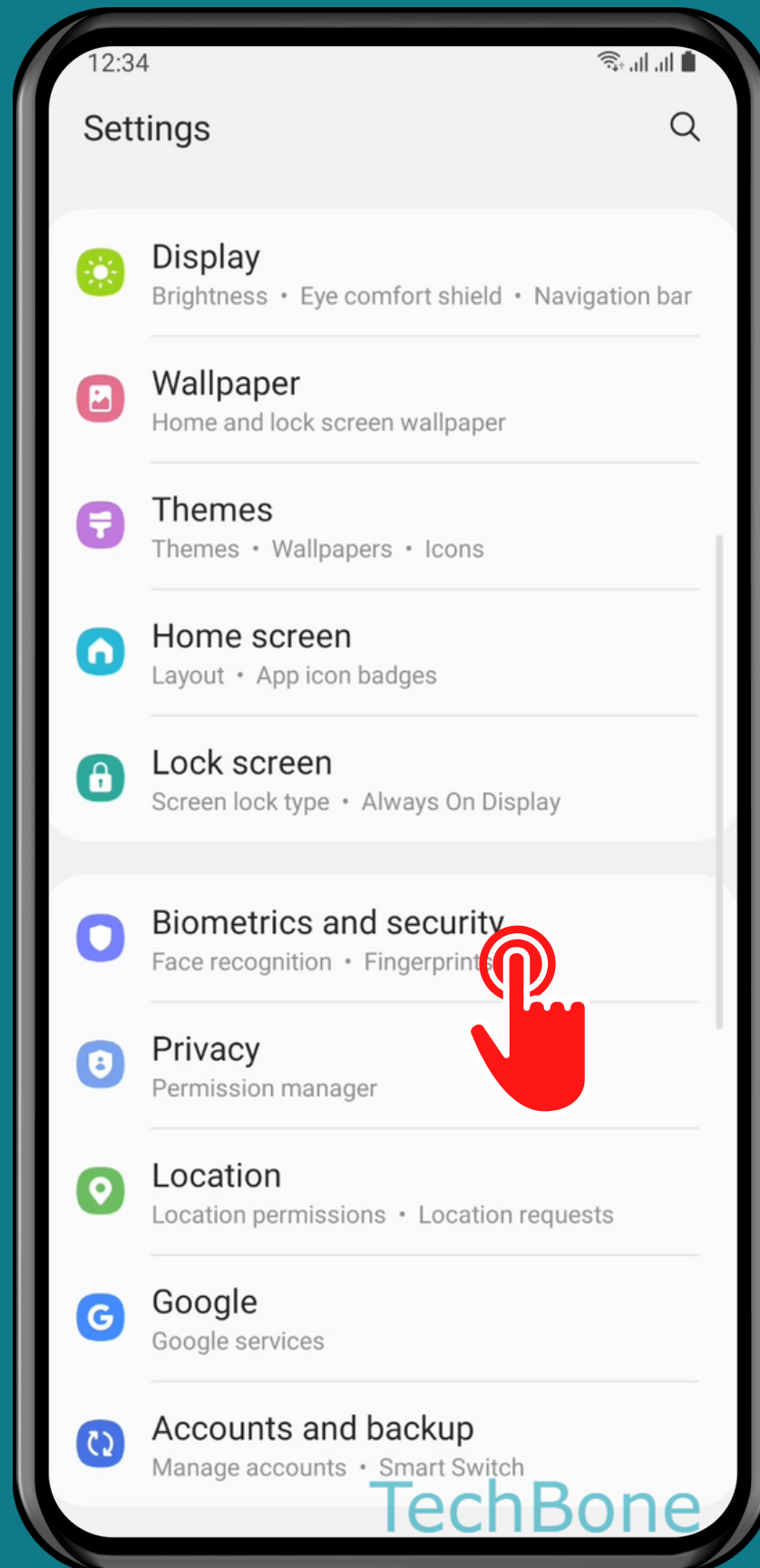

Tap on Biometrics and security

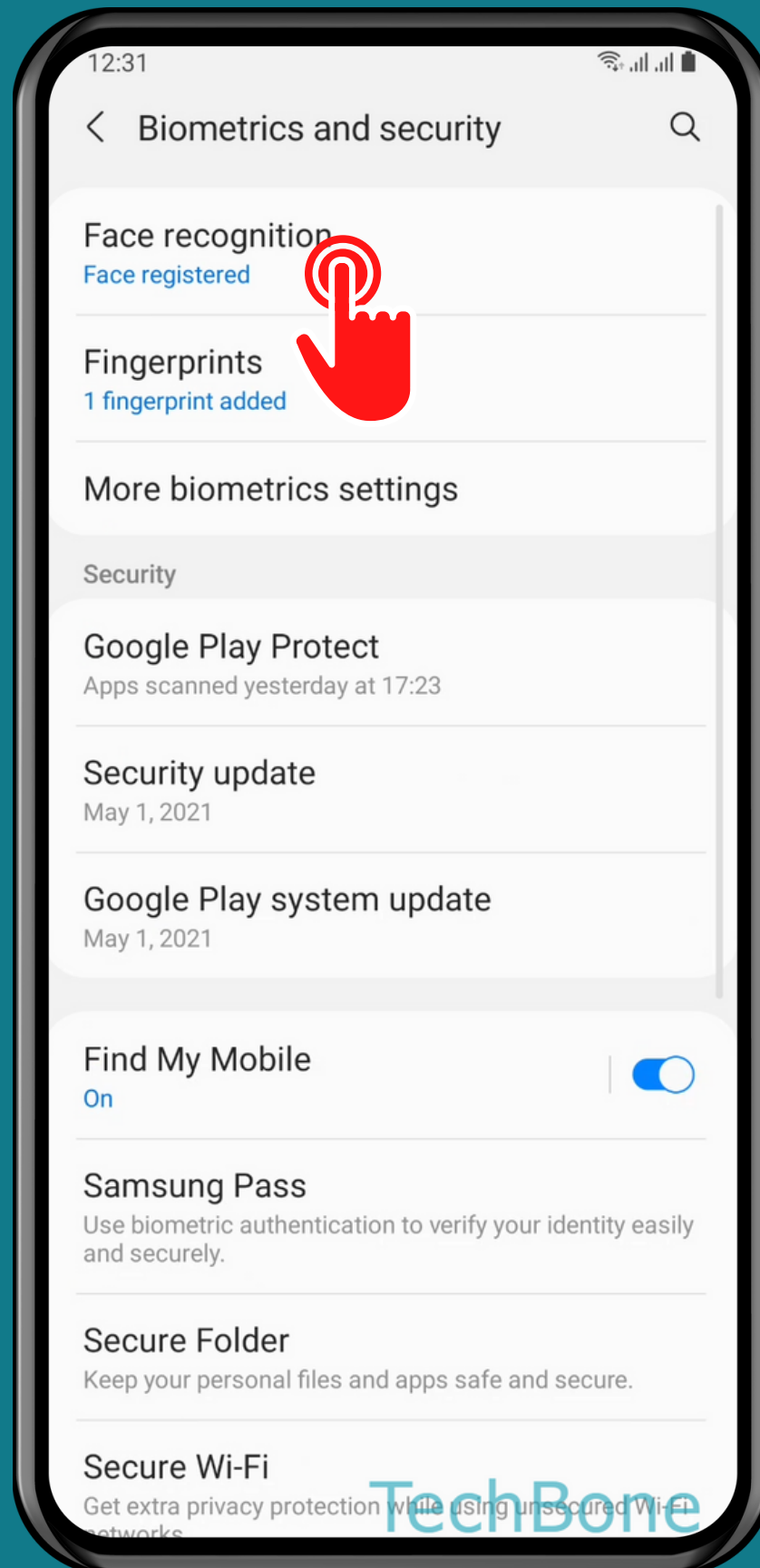

Tap on Face recognition

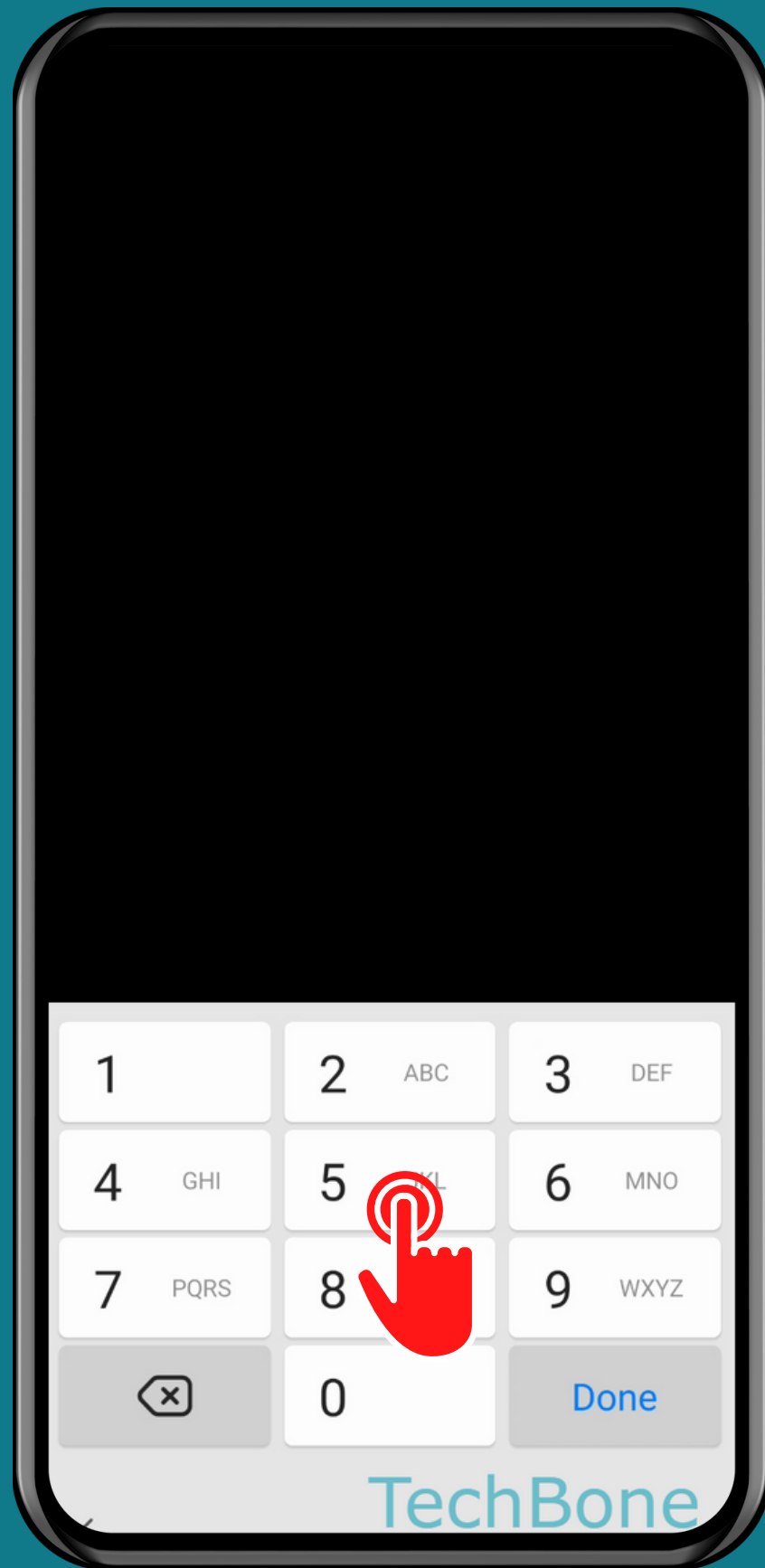

Enter the current
Pattern, PIN or
Password

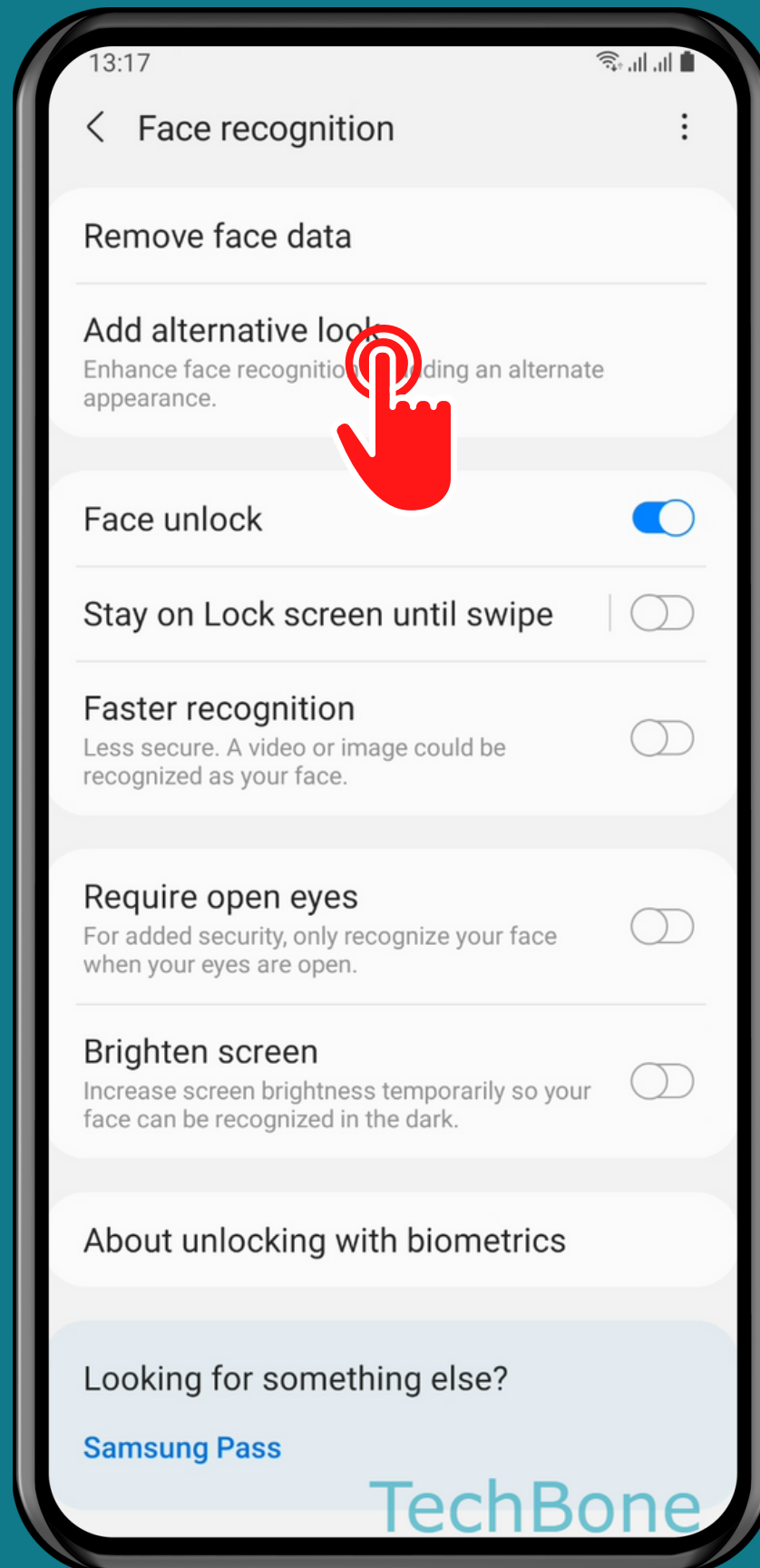

Tap on

Add alternative look

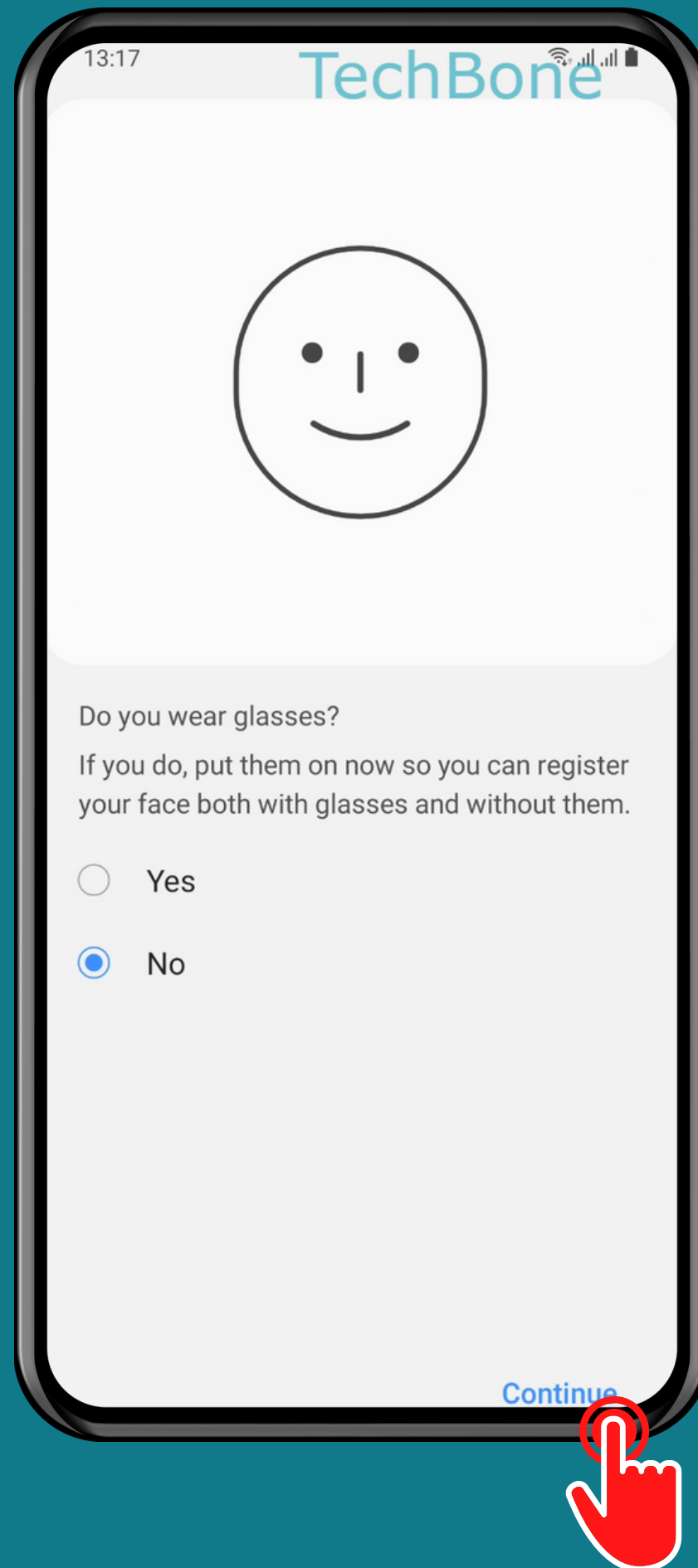

Tap on **Continue** and follow the instructions on screen

Done!