

SAMSUNG

Android 13 - One UI 5

ACTIVAR O DESACTIVAR AMPLIACIÓN AL PULSAR TECLA



Abre los Ajustes

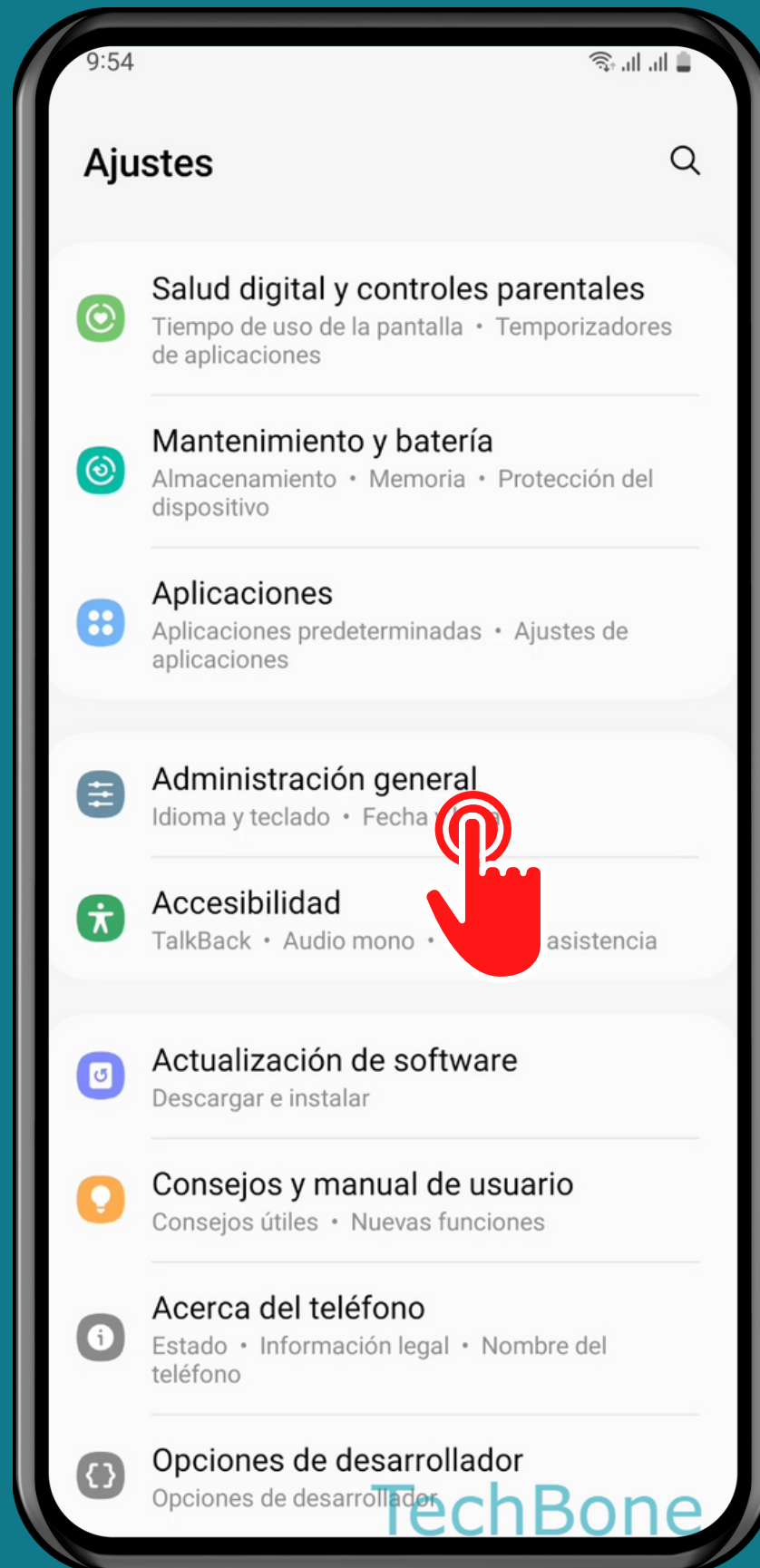

Presiona Administración general

TechBone

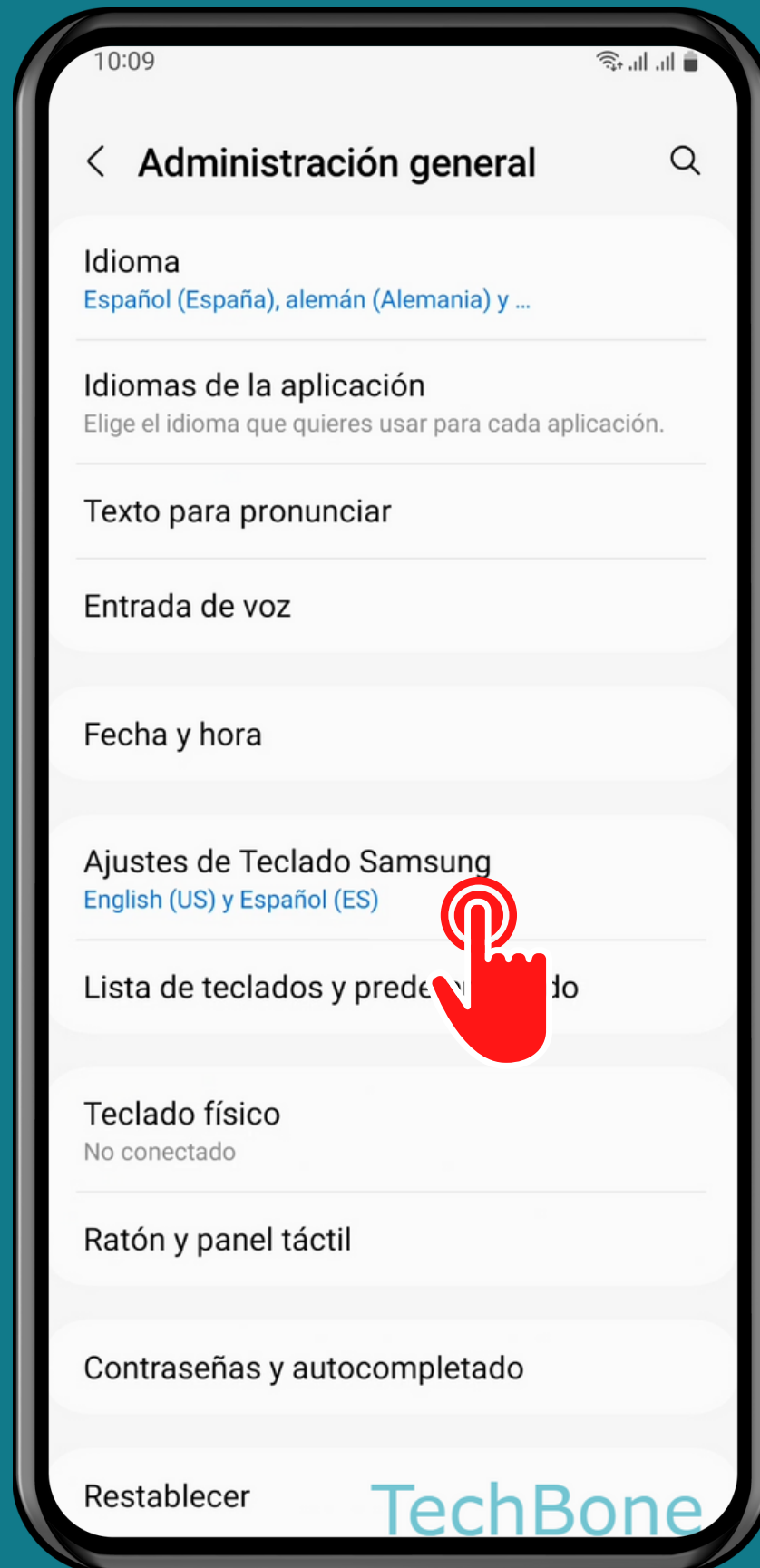

Presiona Ajustes de Teclado Samsung

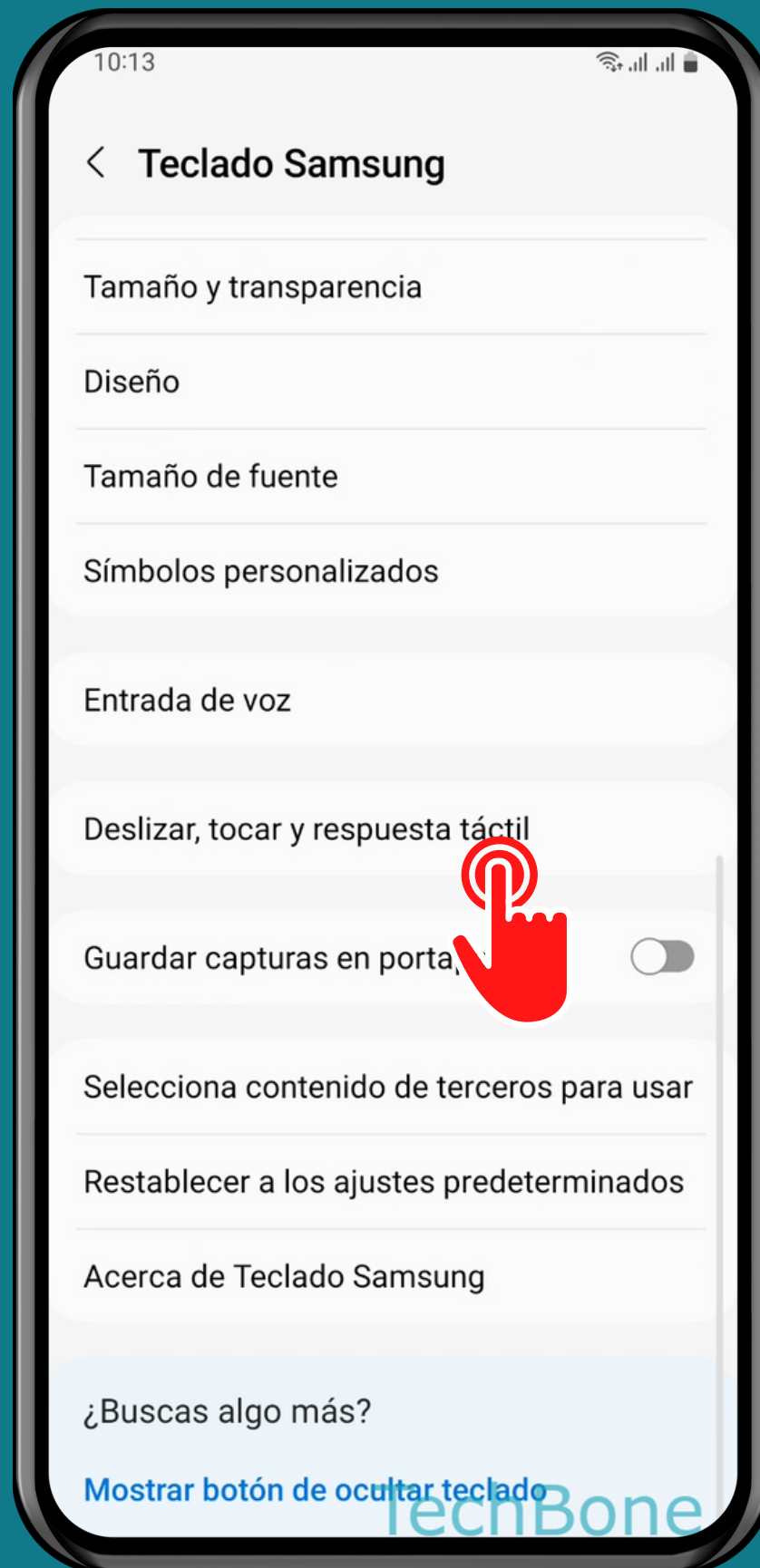

Presiona Delizar, tocar y respuesta táctil

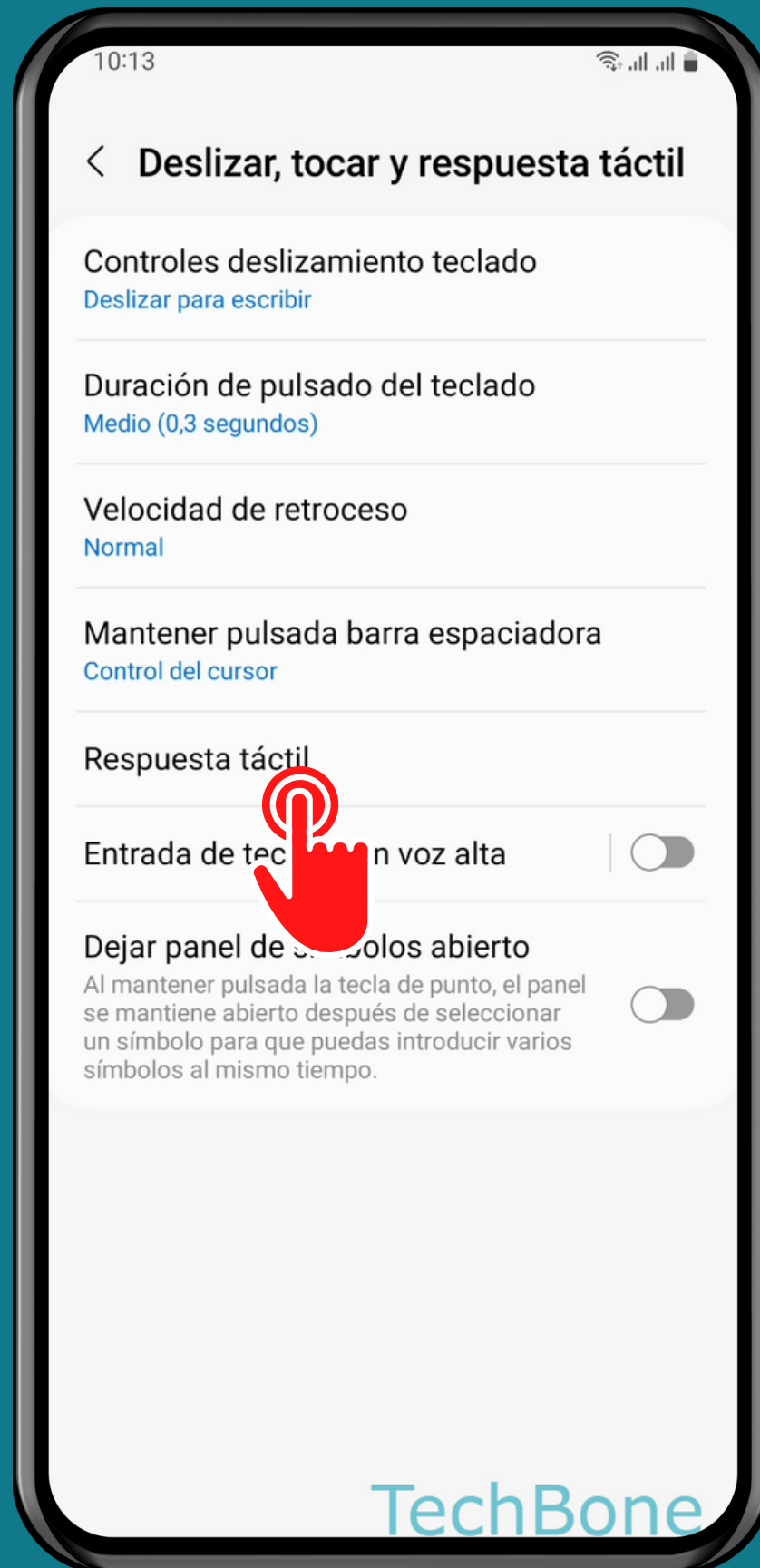

Presiona

Respuesta táctil

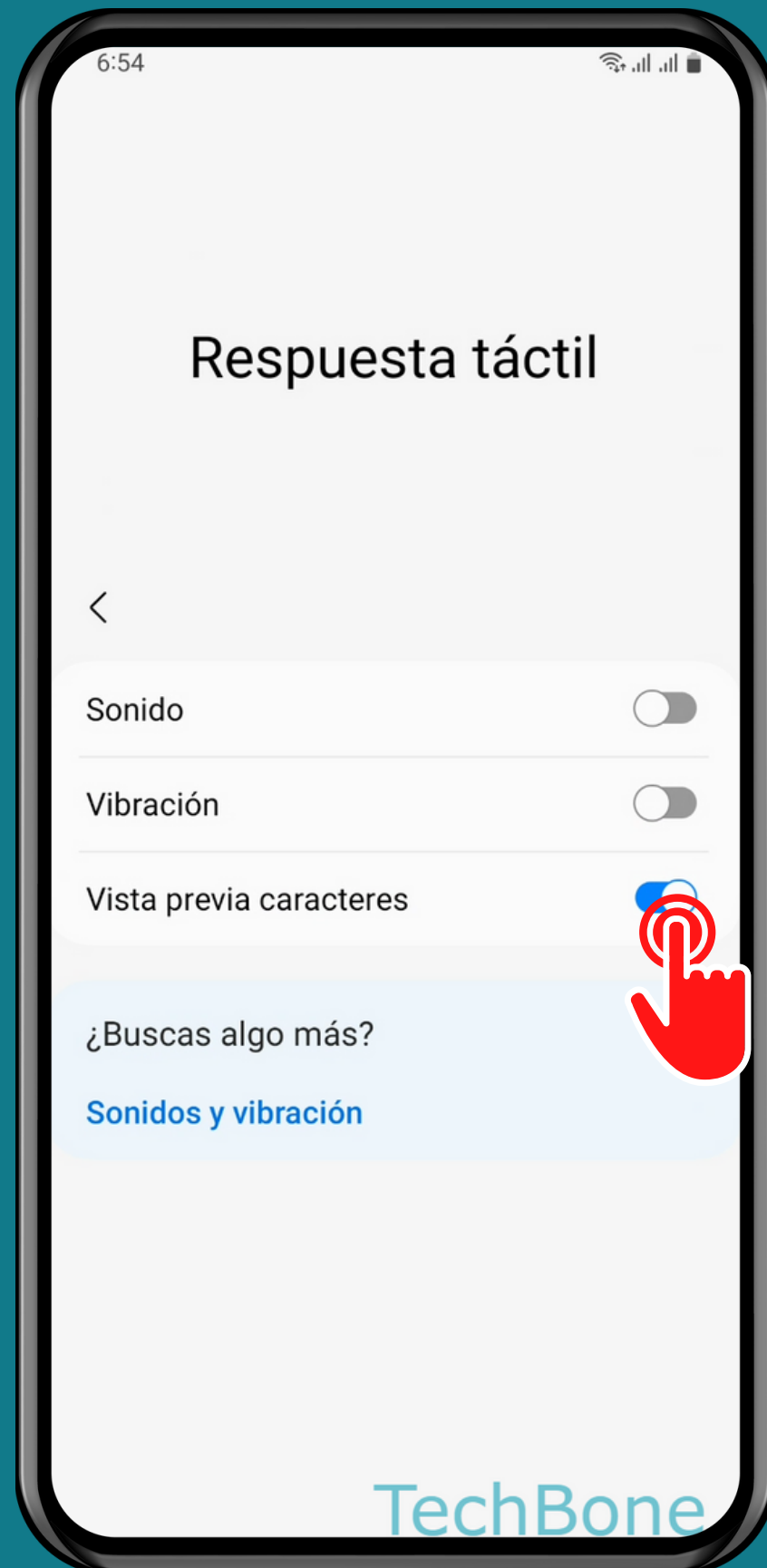

Activa o desactiva

Vista previa caracteres

¡Listo!