

SAMSUNG

Android 11 - One UI 3

# HOW TO CHANGE AUTO-LOCK TIME



Tap on  
Settings

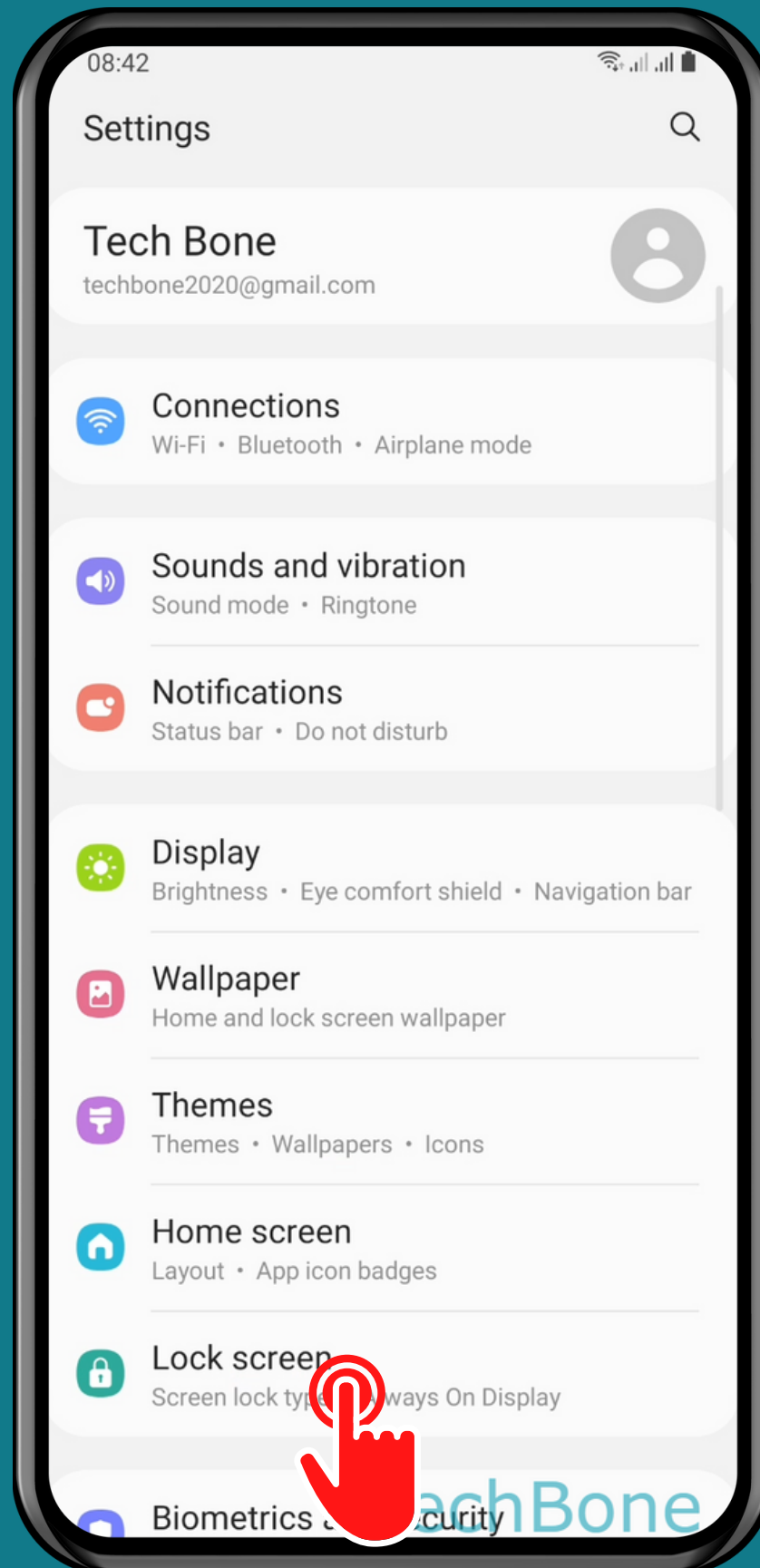

Tap on  
Lock screen

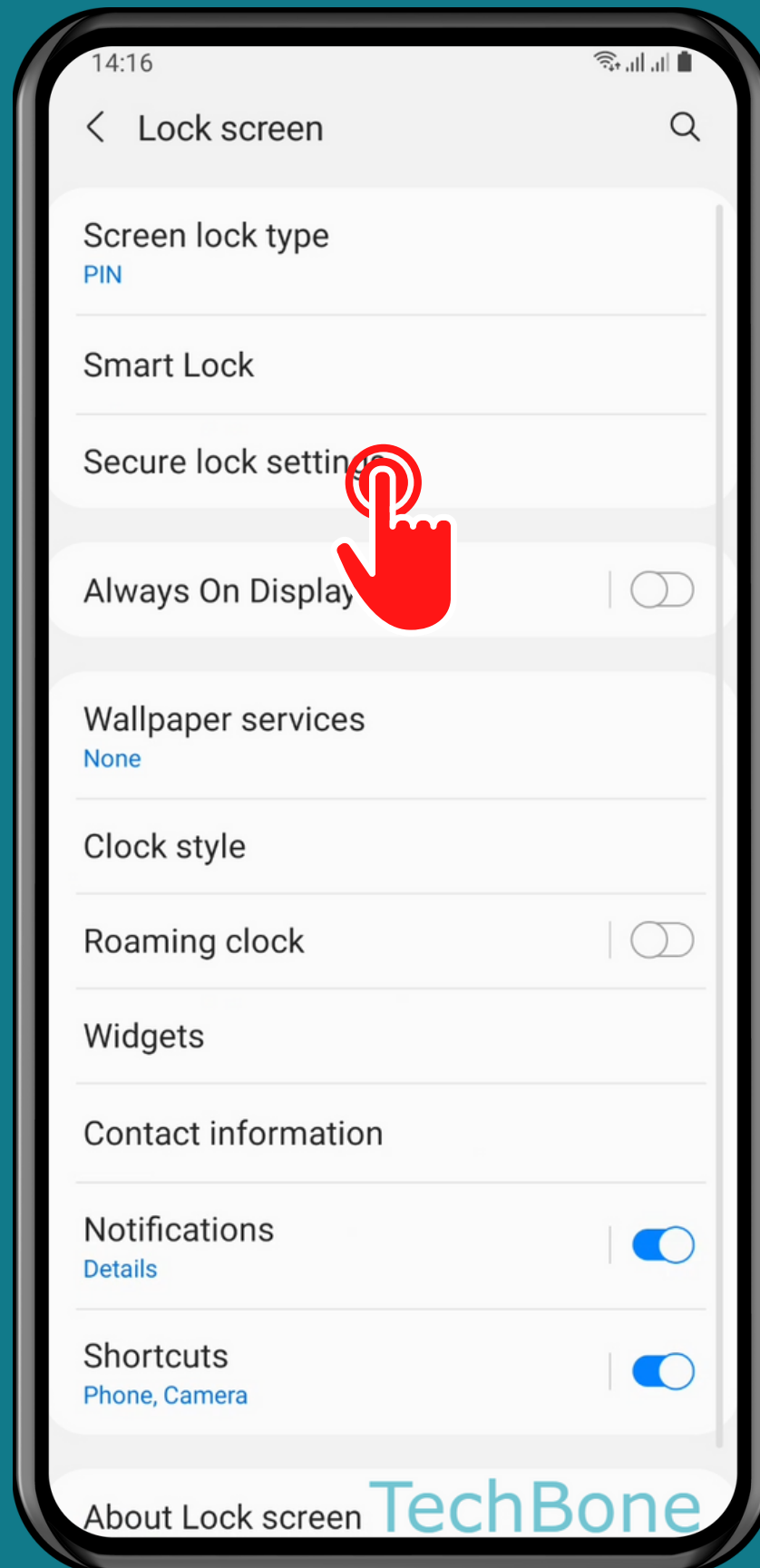

# Tap on Secure lock settings

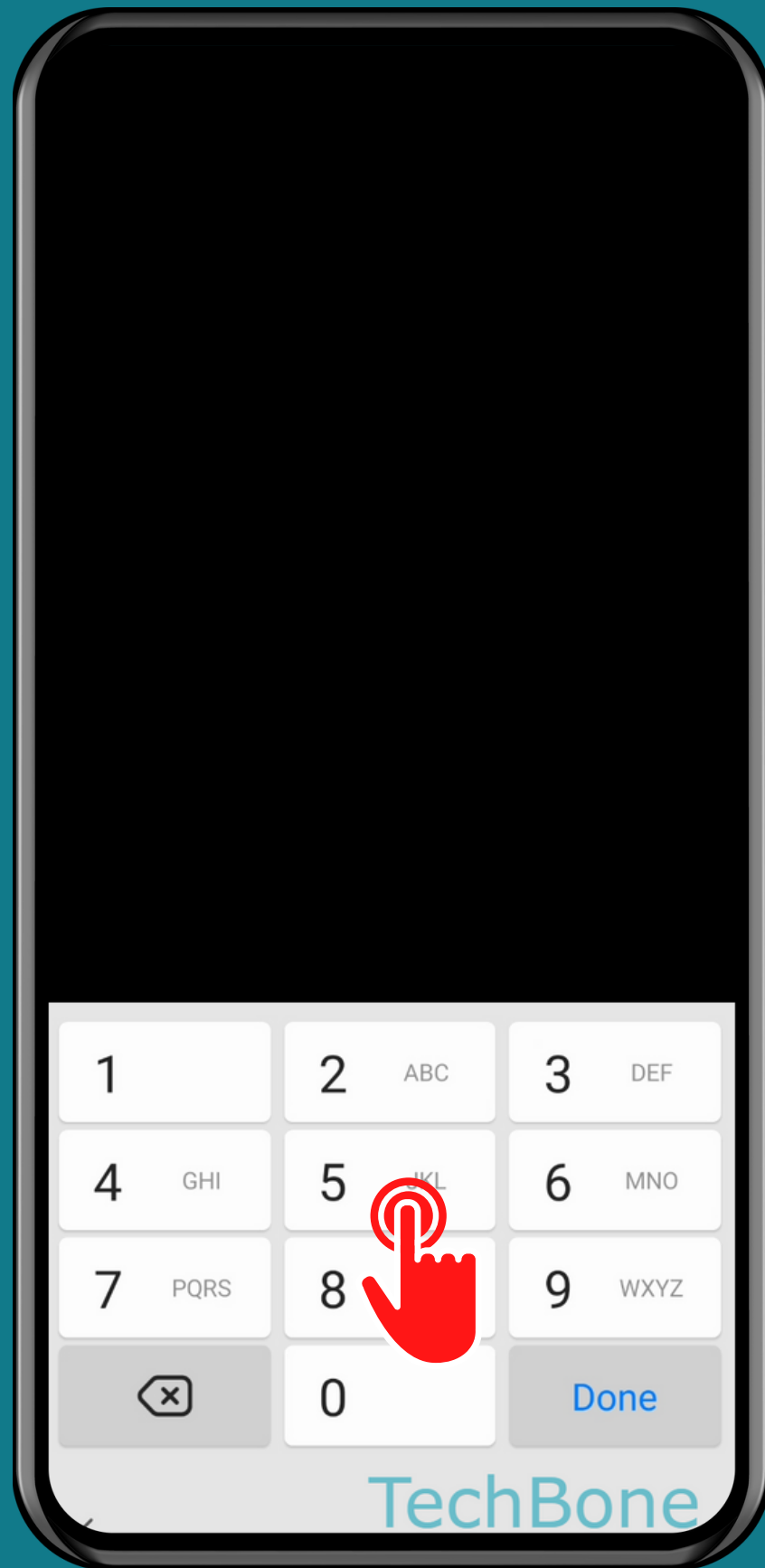

Enter the current  
**Pattern, PIN or  
Password**

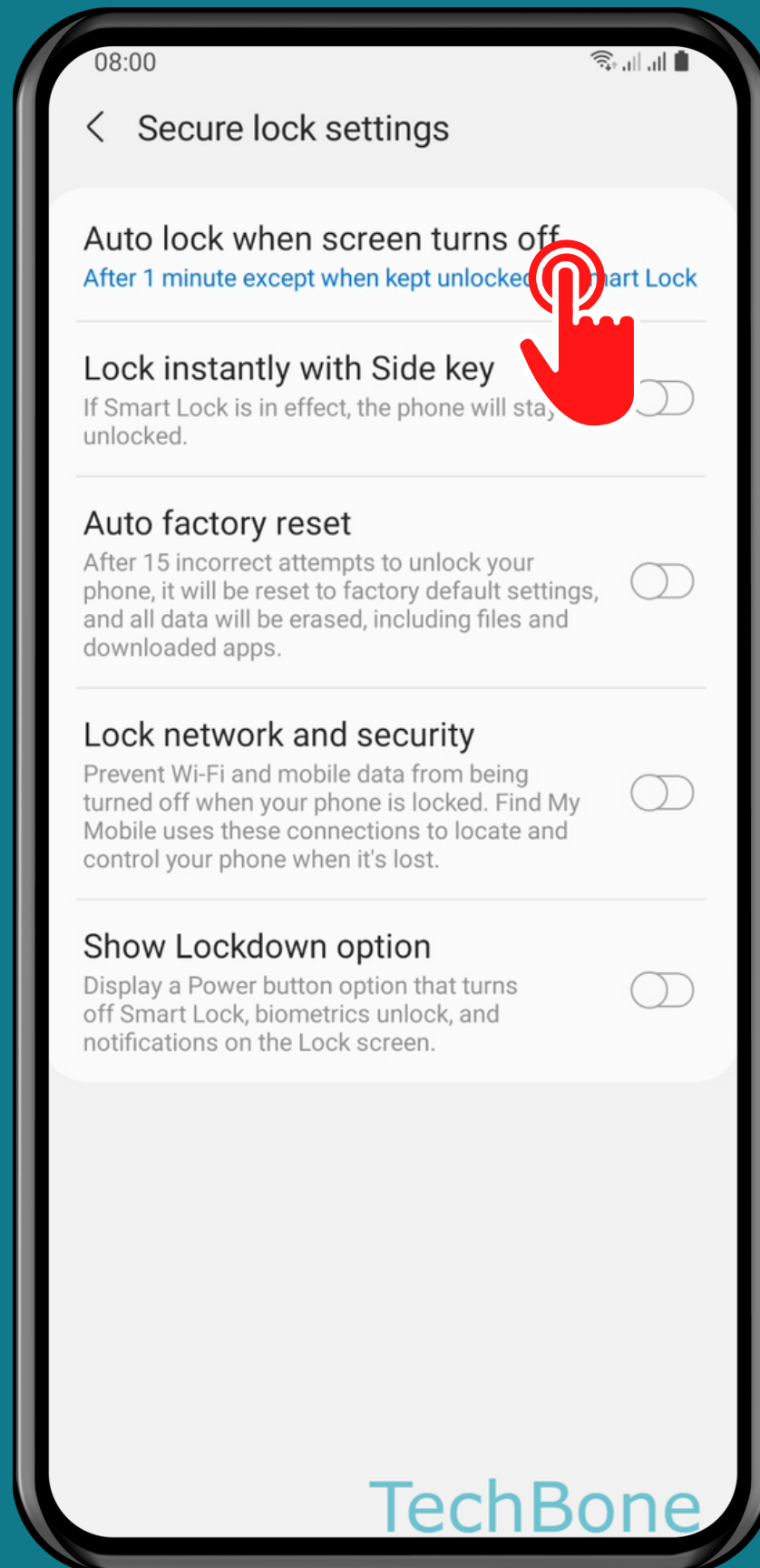

Tap on  
Auto lock when  
screen turns off



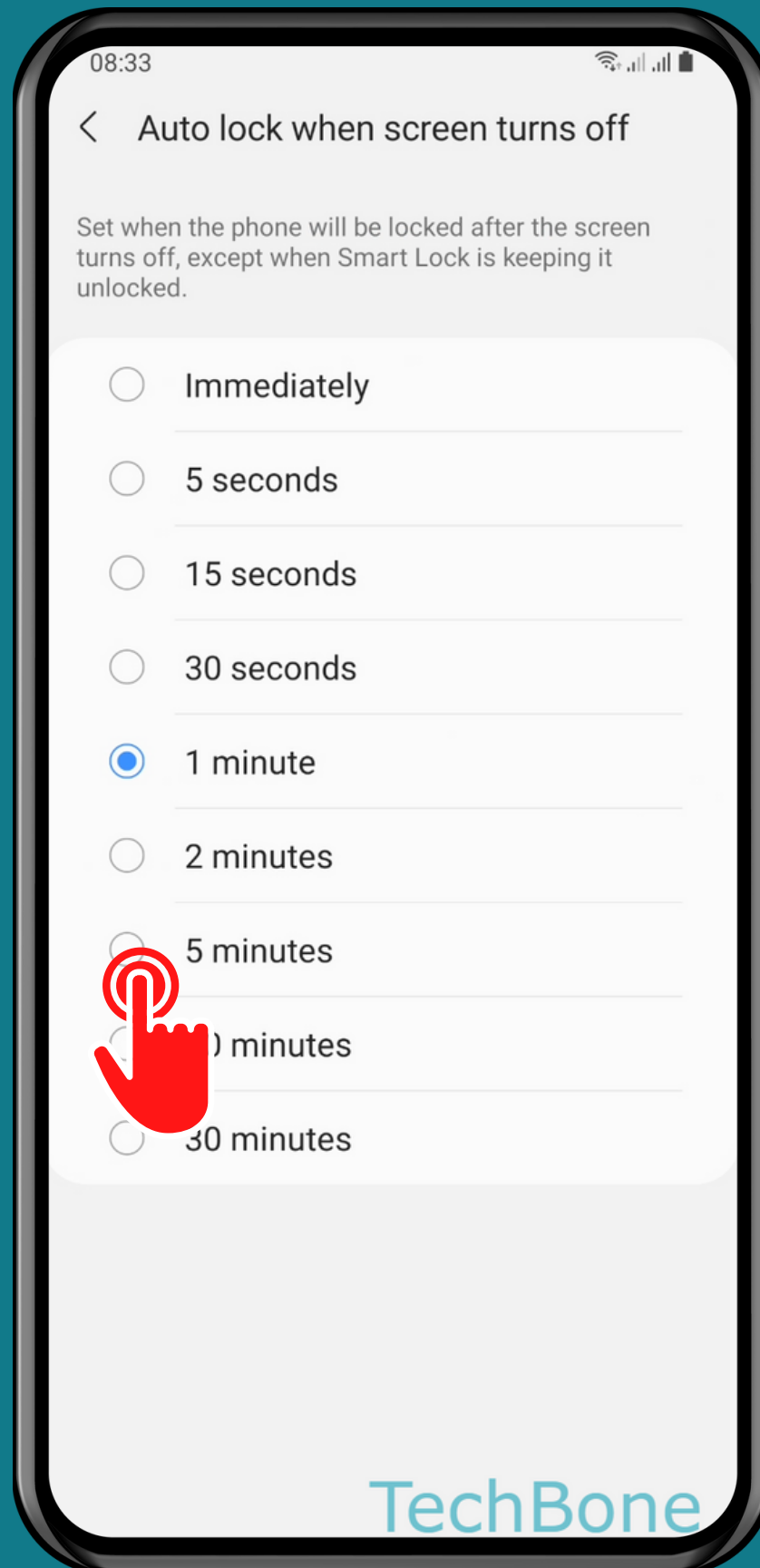

# Choose an Option

Done!