

# SAMSUNG

Android 11 - One UI 3

## HOW TO CHANGE THE BILLING CYCLE DATE

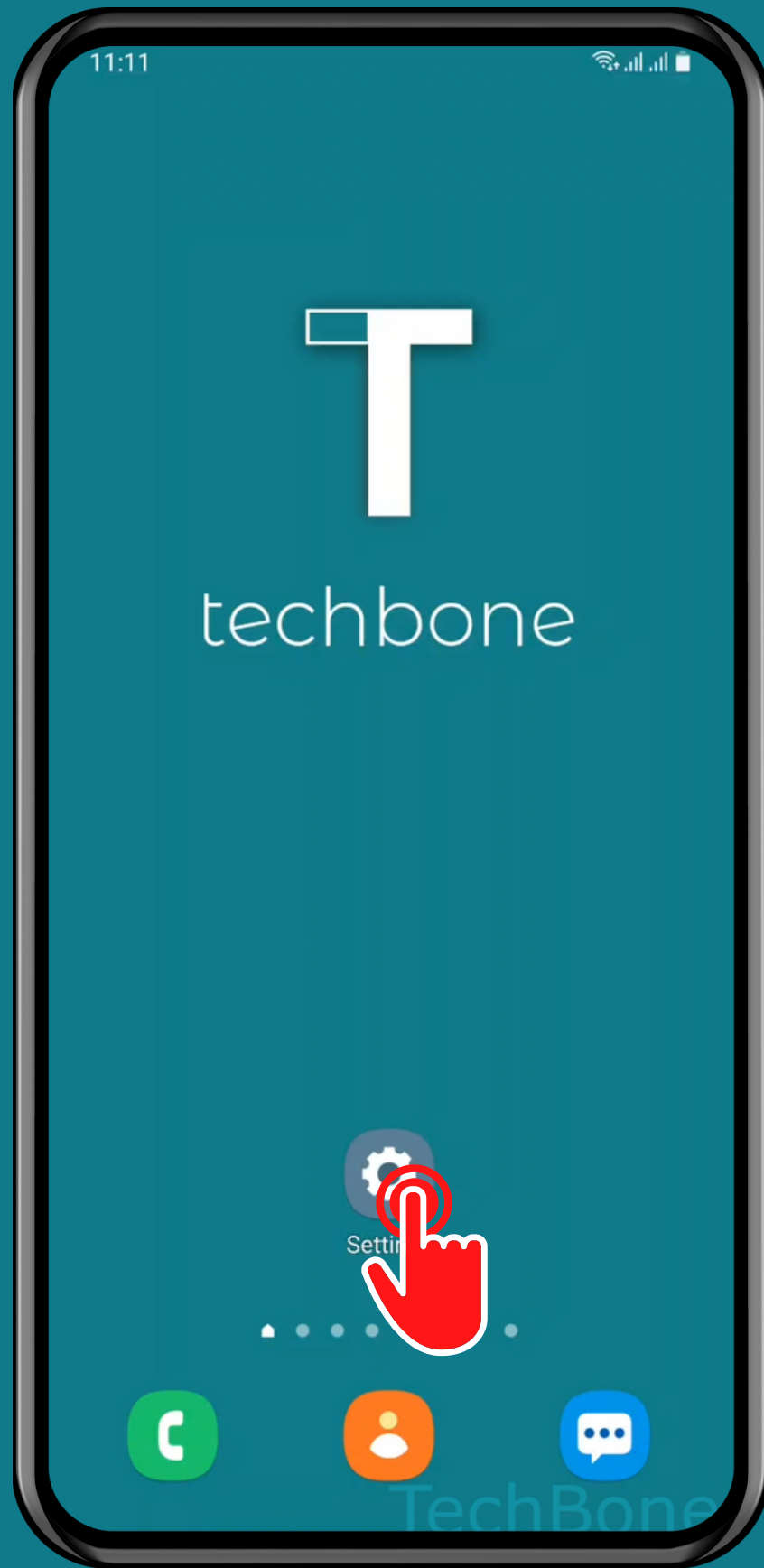

Tap on  
Settings

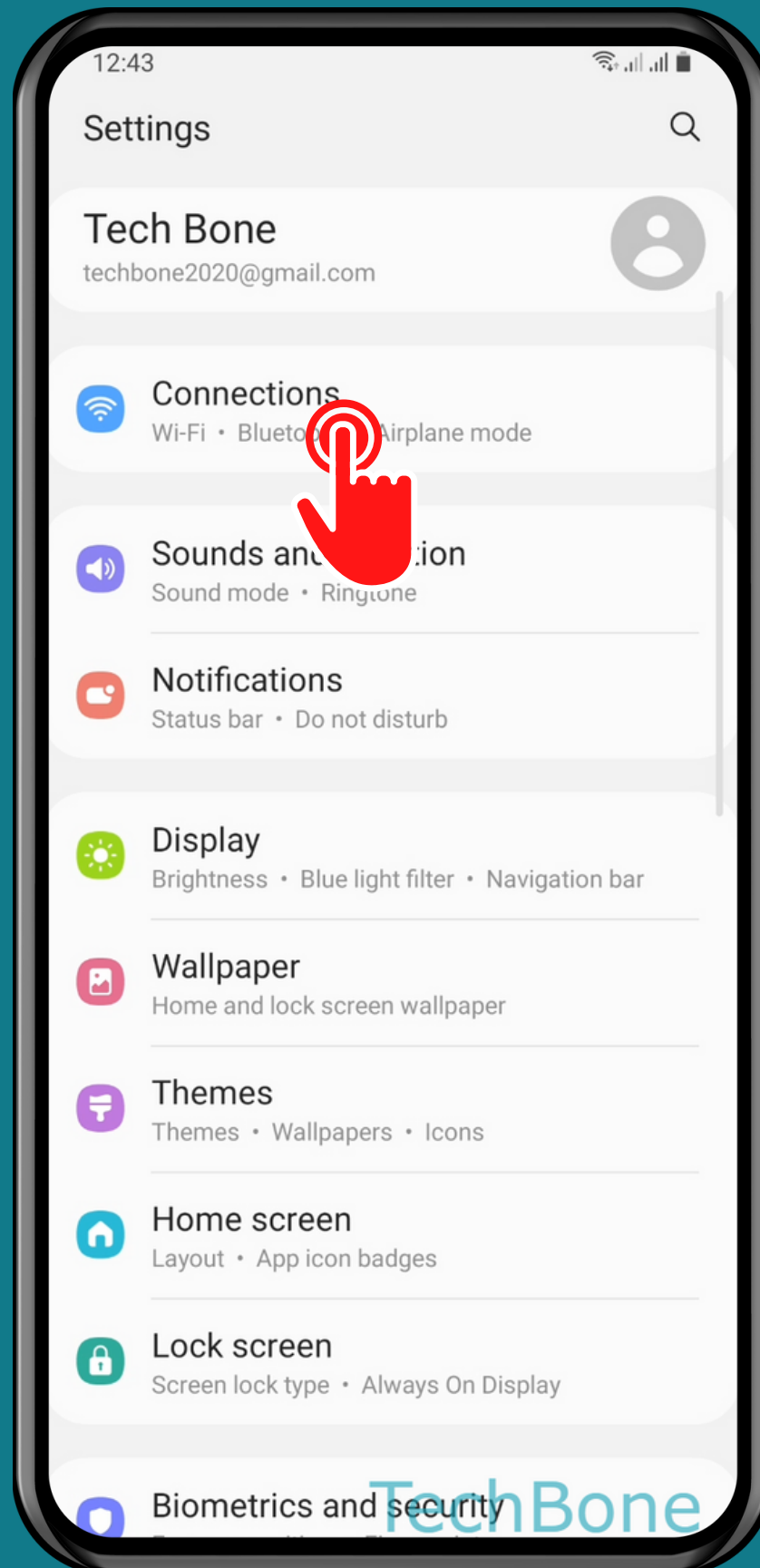

# Tap on Connections

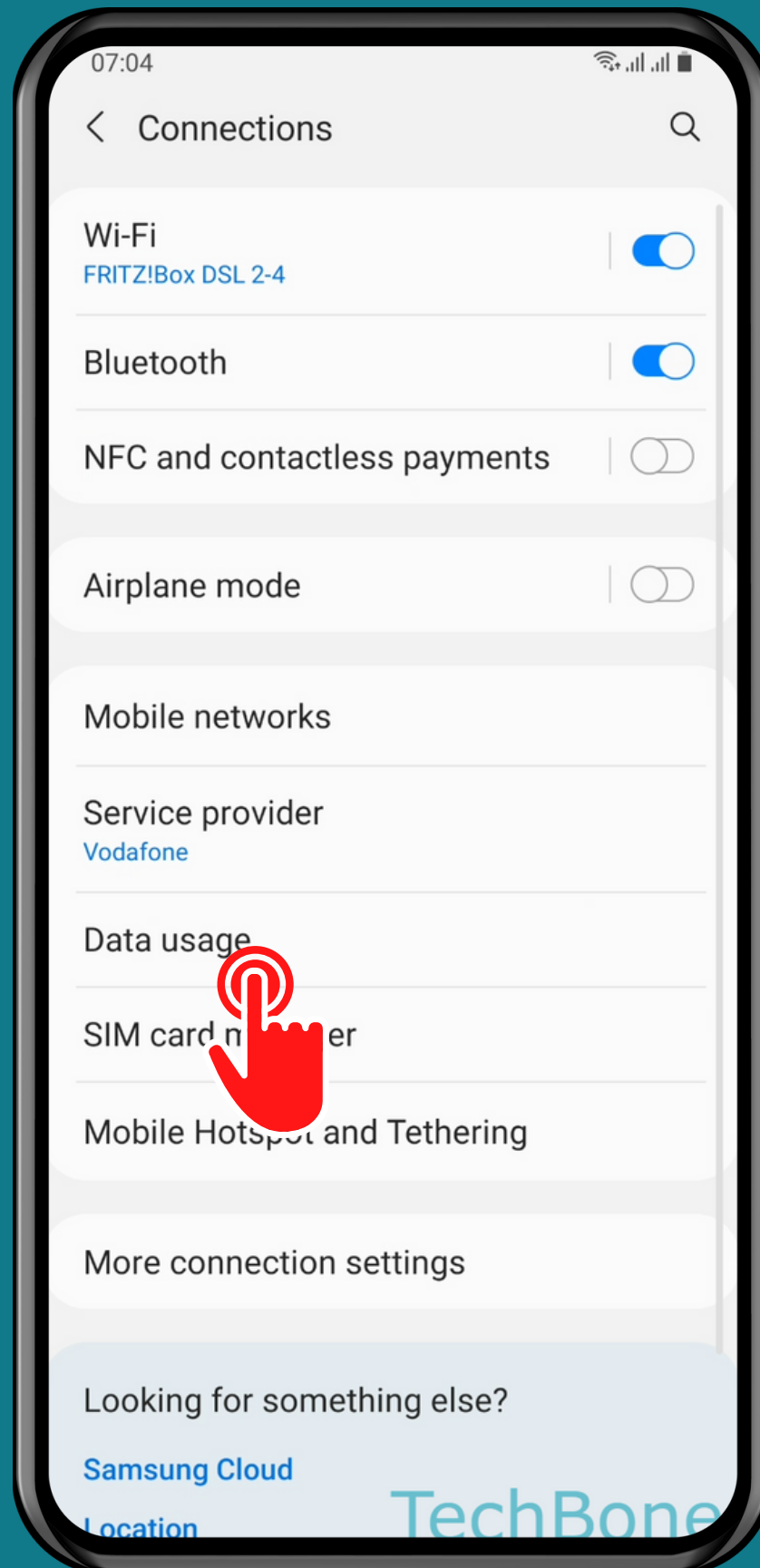

# Tap on Data usage

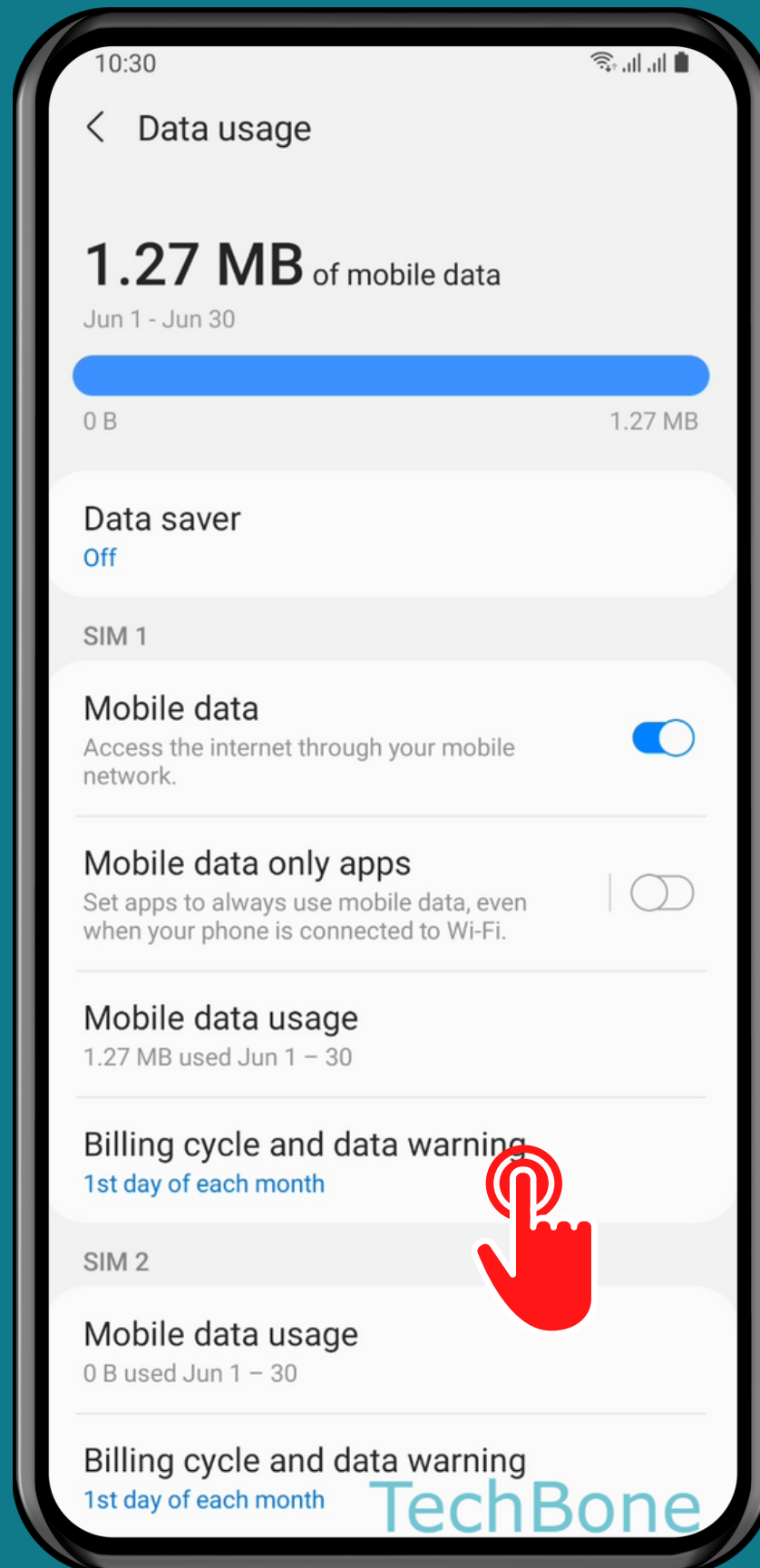

# Tap on Billing cycle and data warning

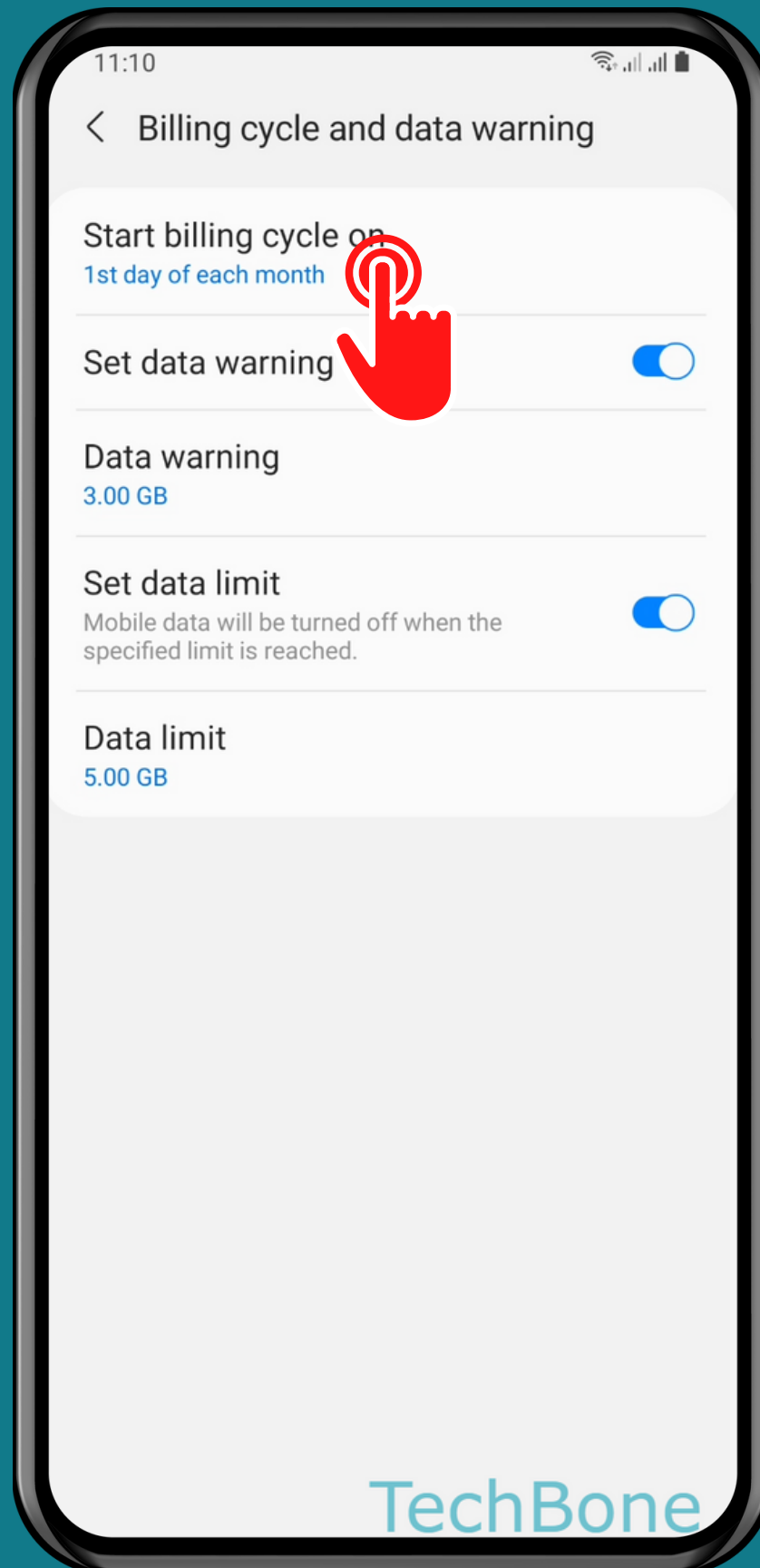

Tap on  
Start billing cycle on

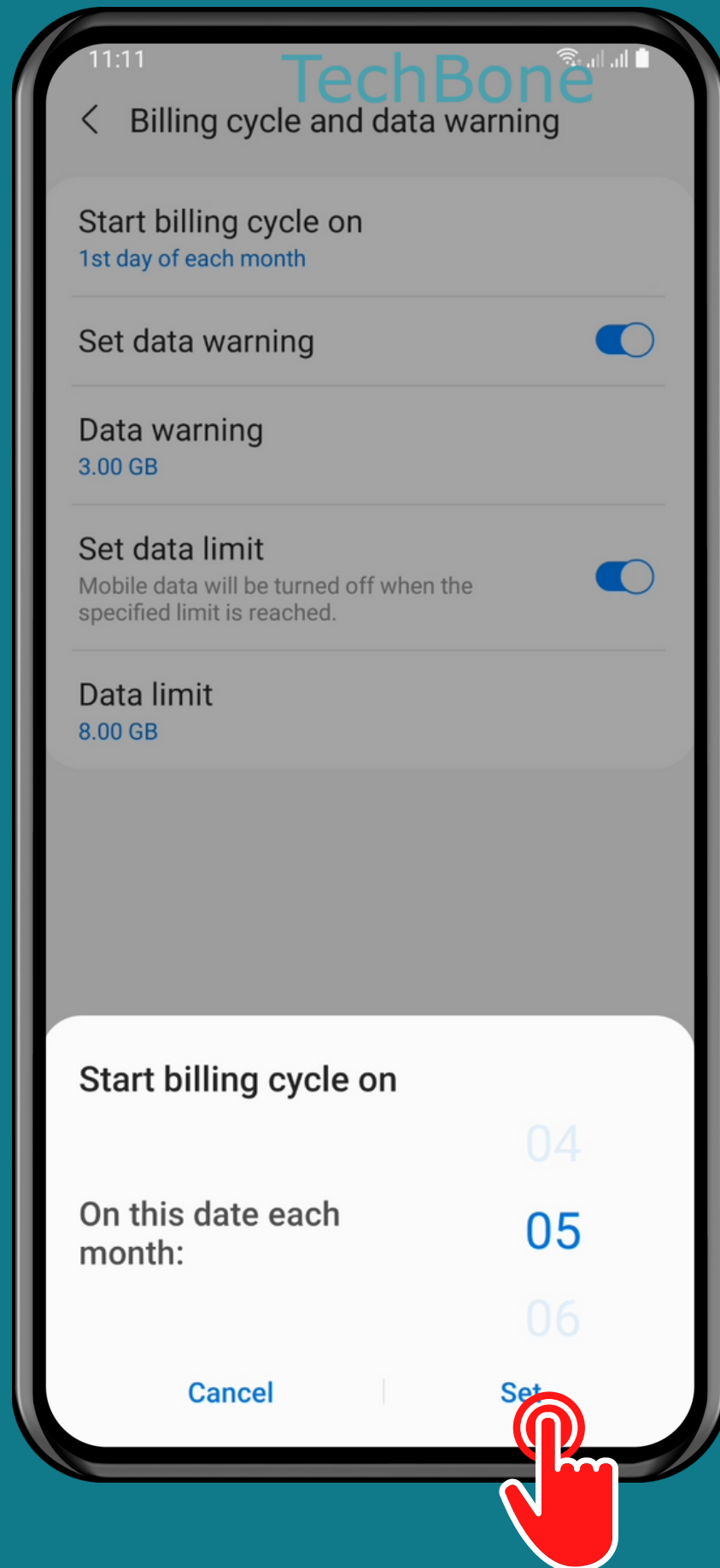

Set the **Date** and tap  
**Set**

Done!