

SAMSUNG

Android 11 - One UI 3

HOW TO CUSTOMIZE CLOCK STYLE OF ALWAYS ON DISPLAY



Tap on
Settings

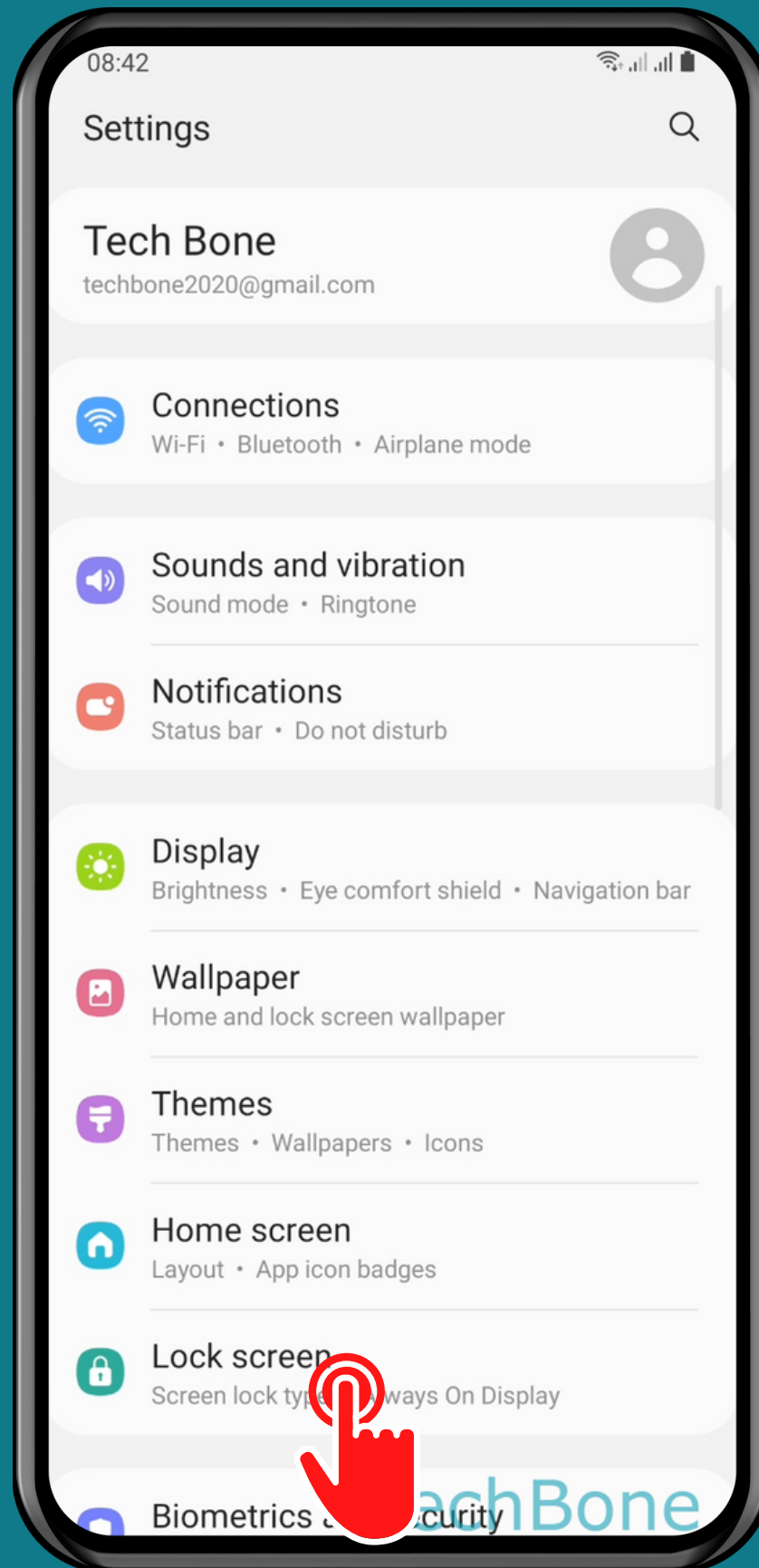

Tap on
Lock screen

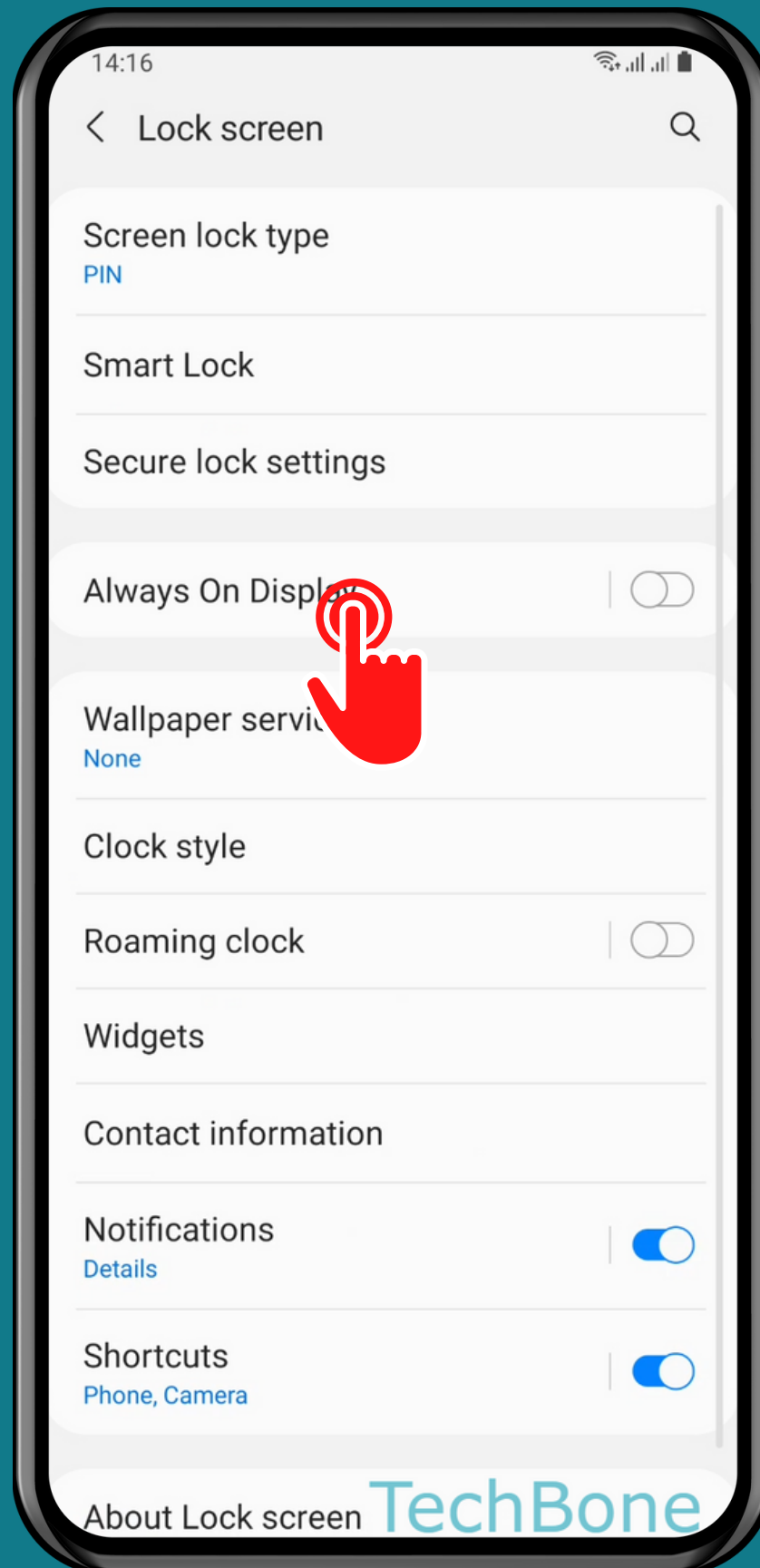

Tap on
Always On Display

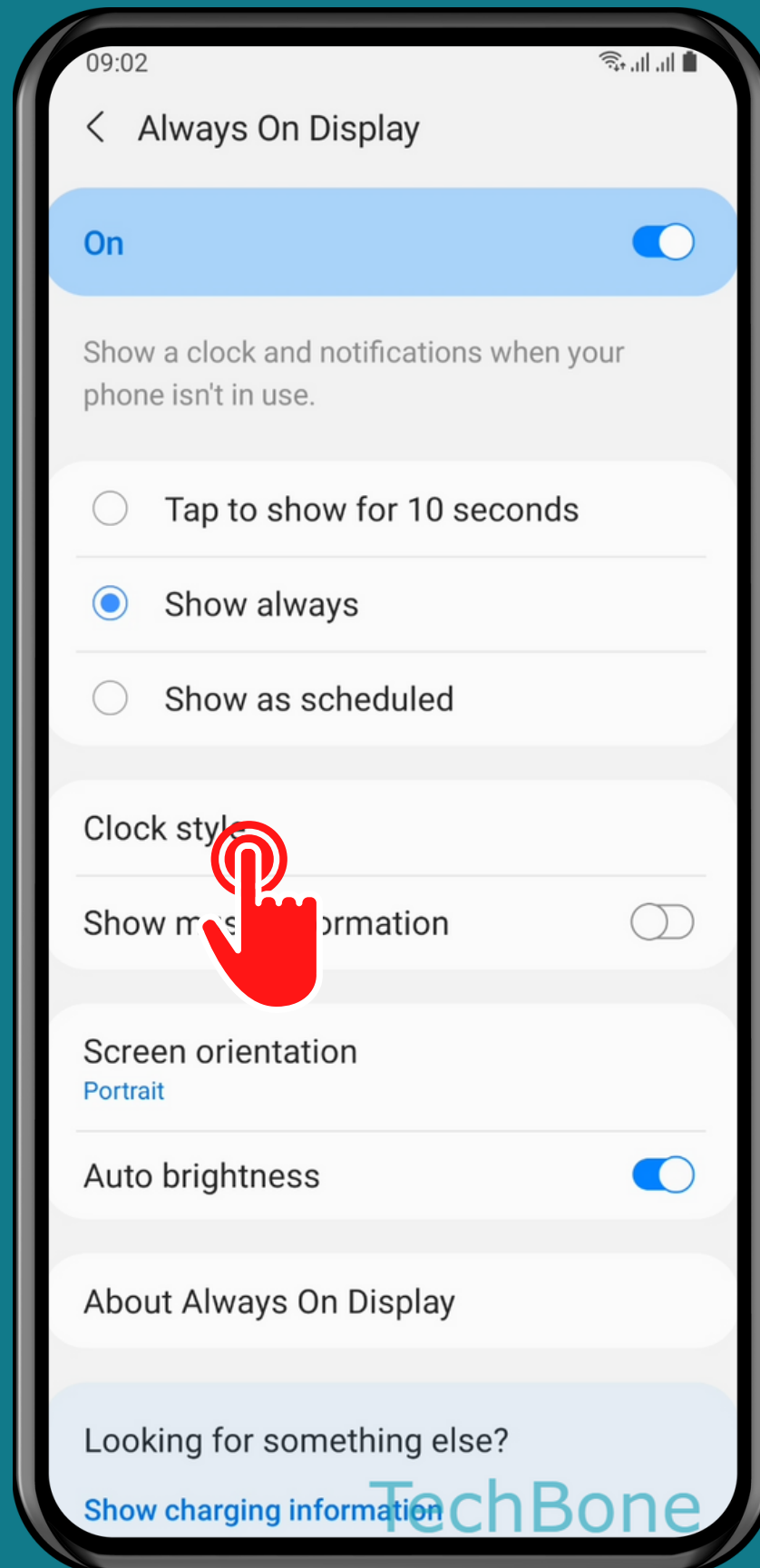

Tap on Clock style

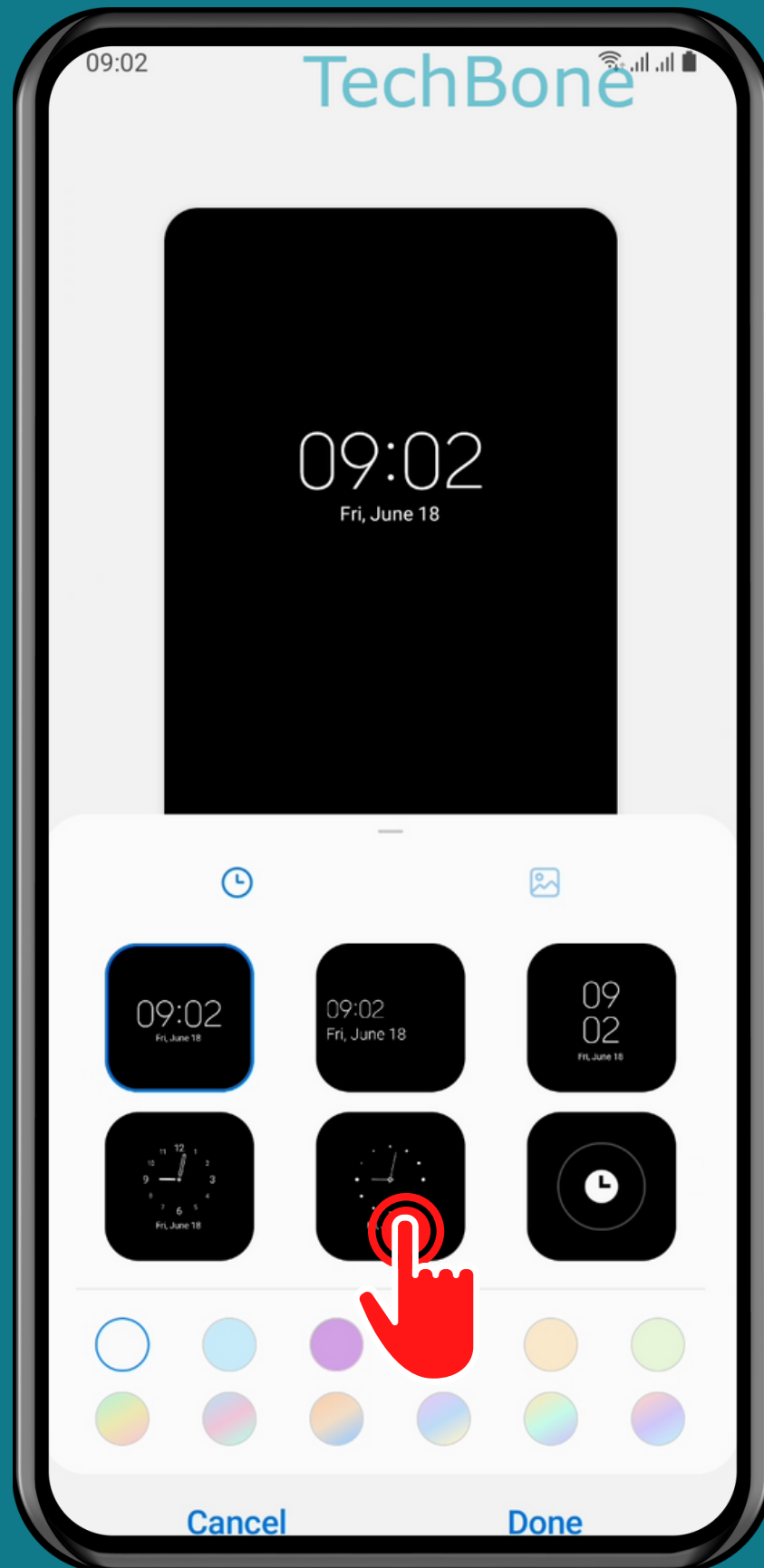

Set the **Clock style**
and change the **Color**

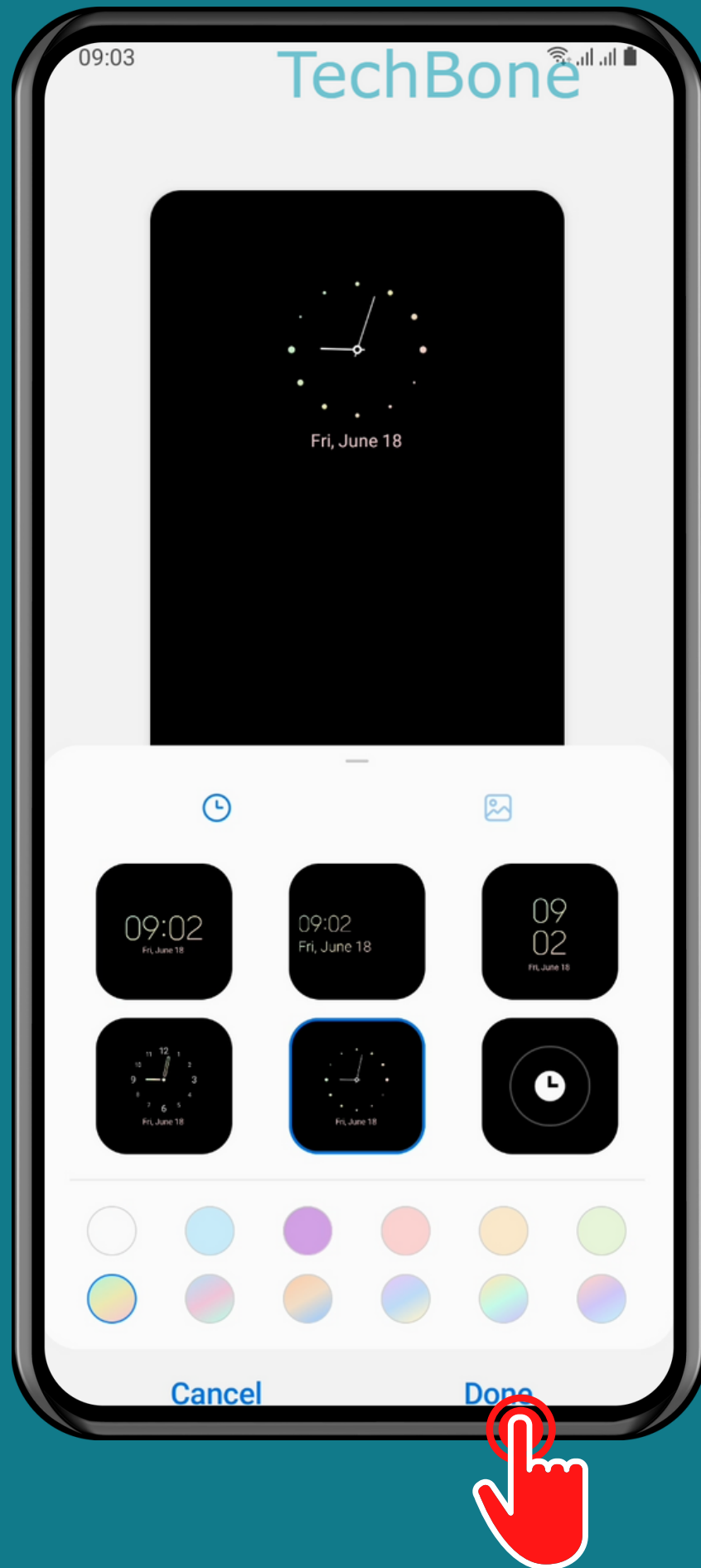

Tap on
Done

Done!