

# SAMSUNG

Contacts - Android 11 - One UI 3

# HOW TO IMPORT CONTACTS

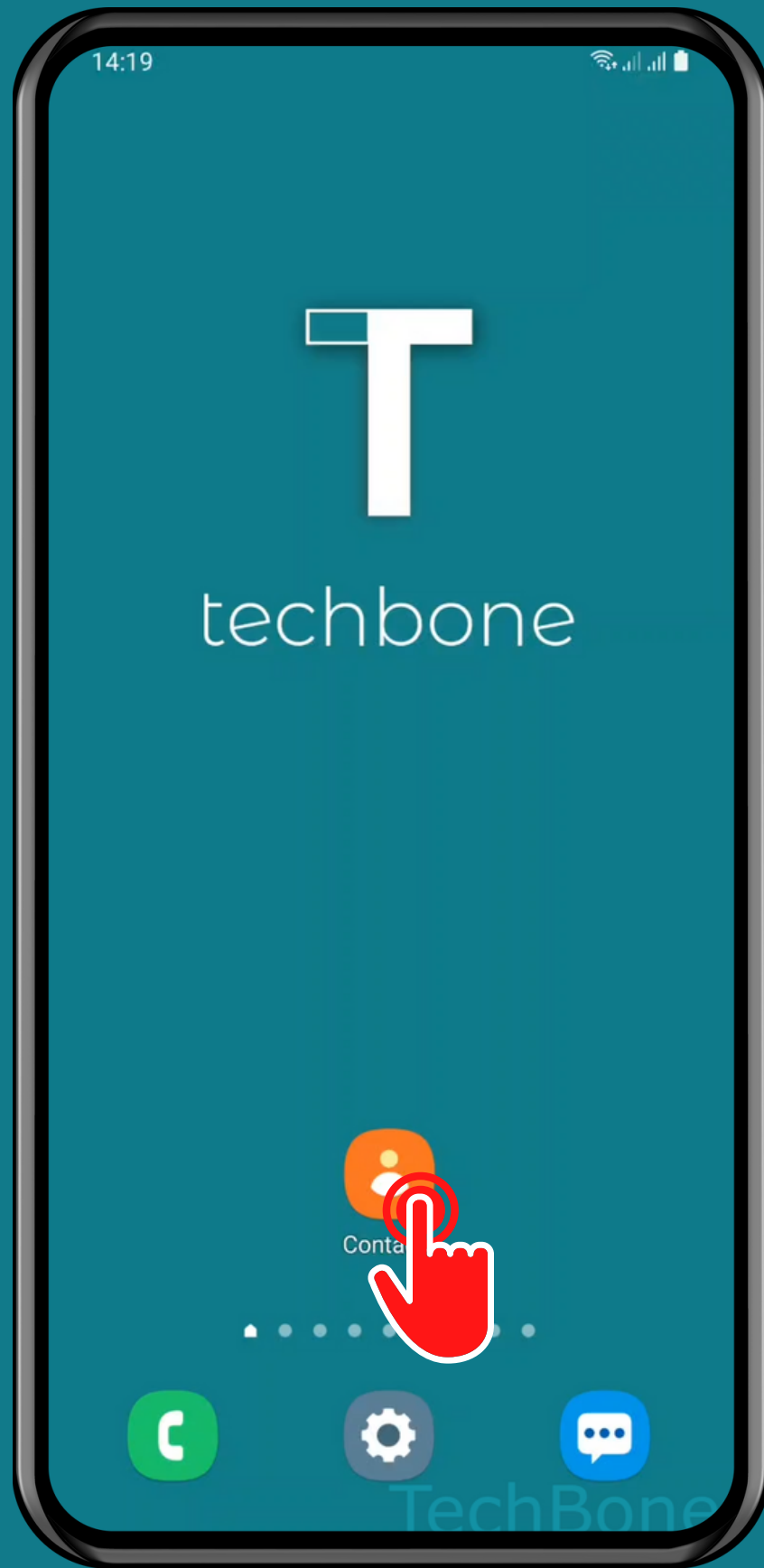

# Tap on Contacts

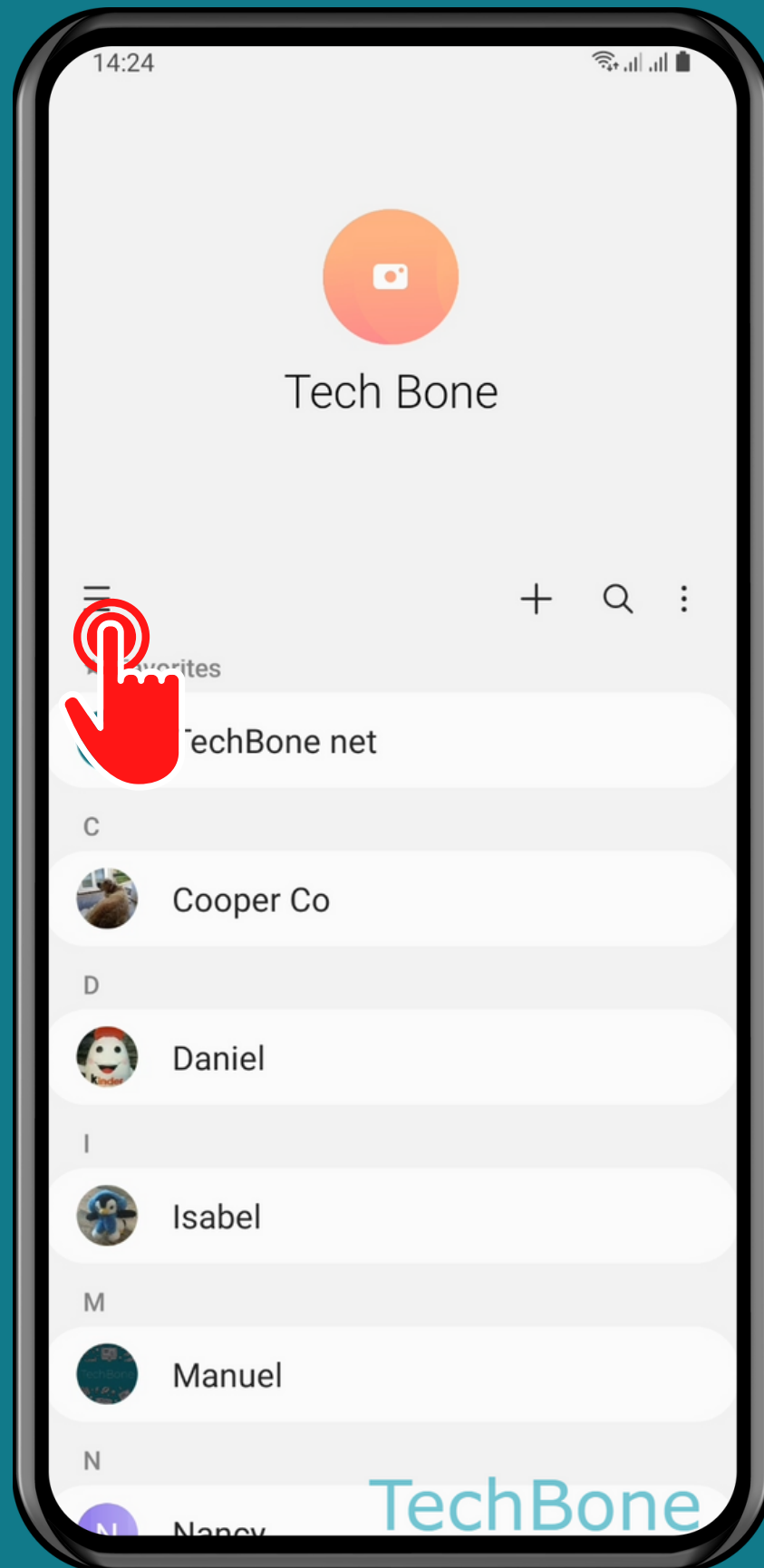

# Open the Menu

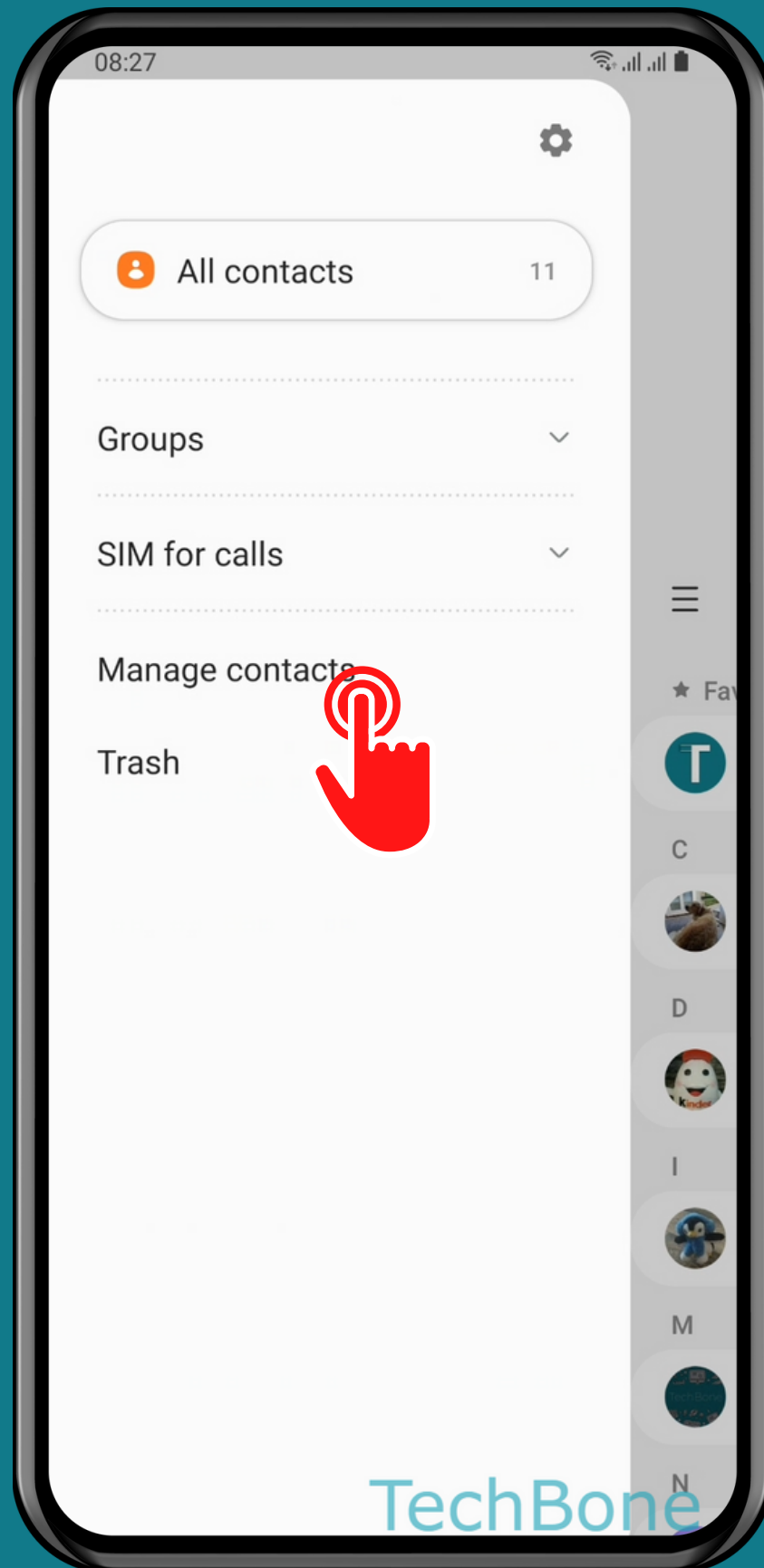

Tap on  
Manage contacts

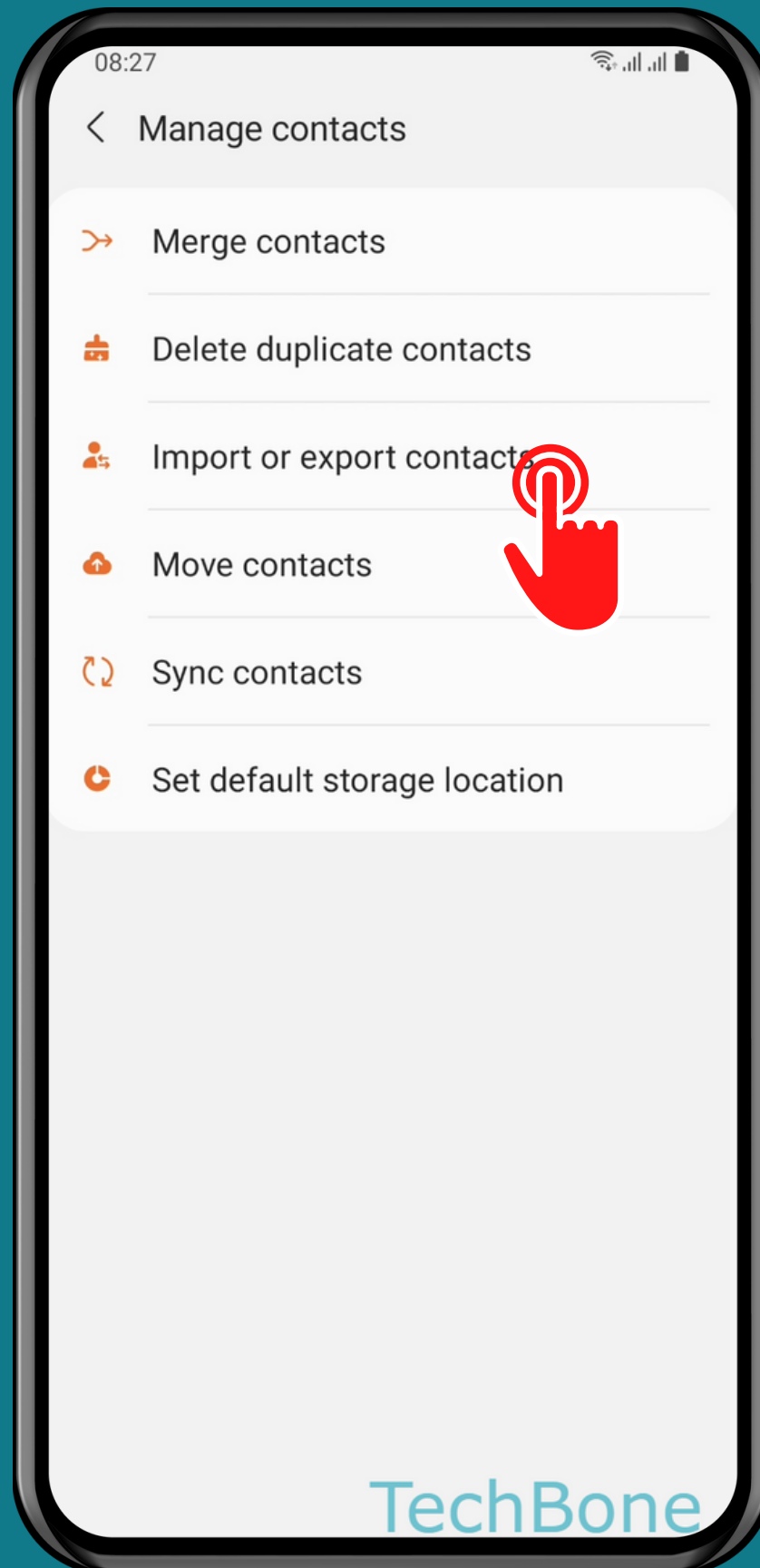

Tap on  
Import or export  
contacts

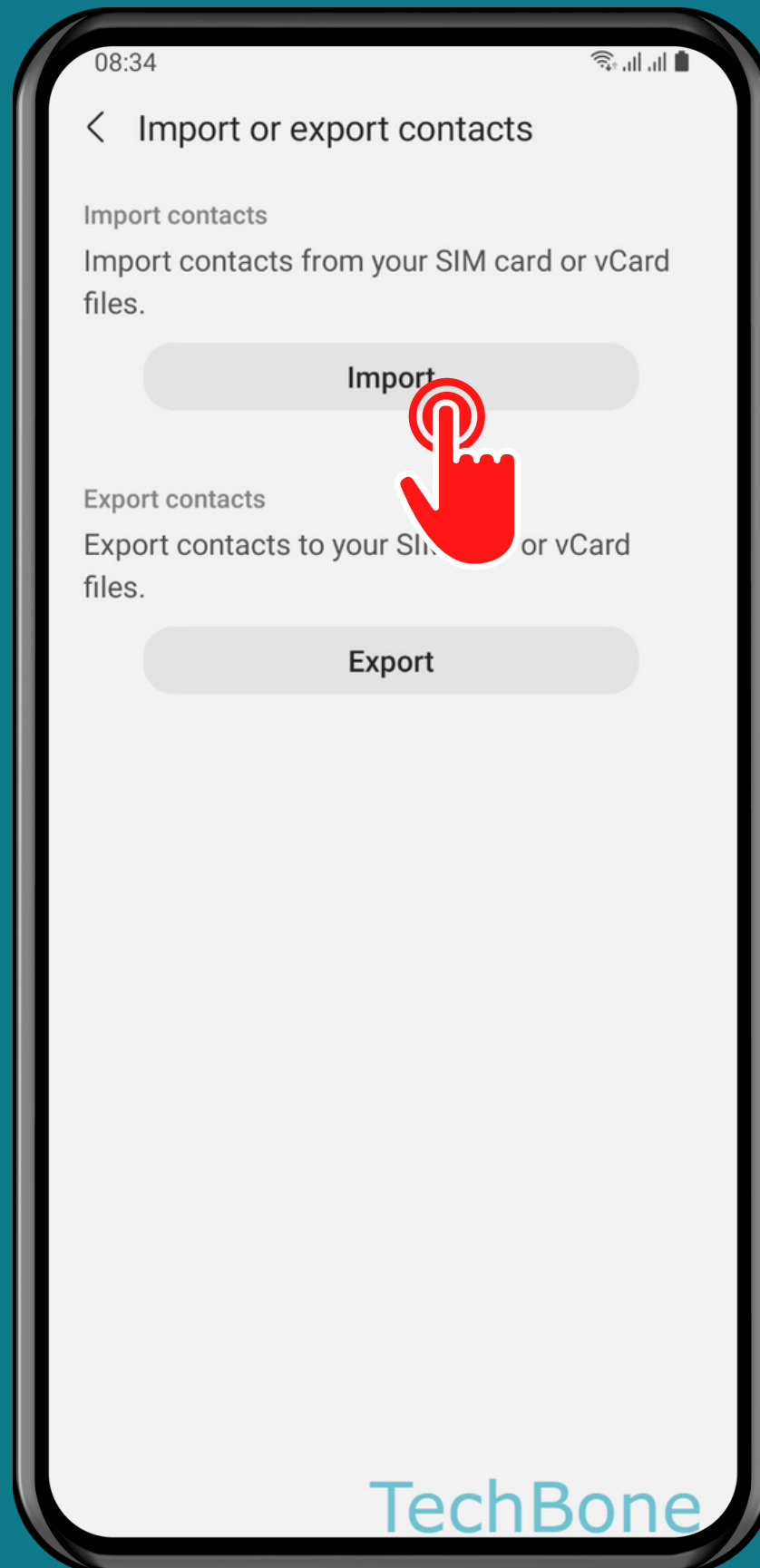

Tap on  
Import

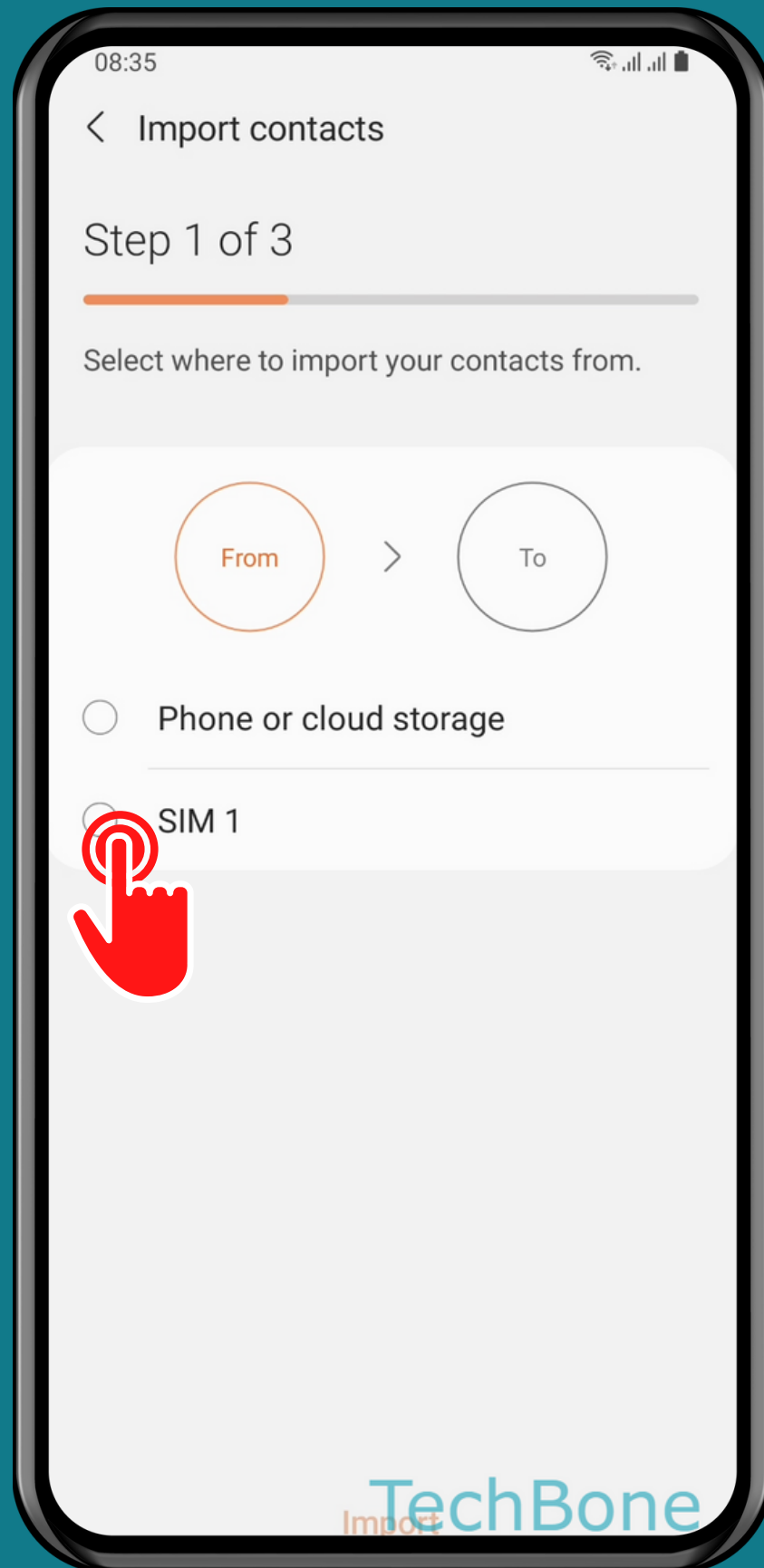

# Select From where to import

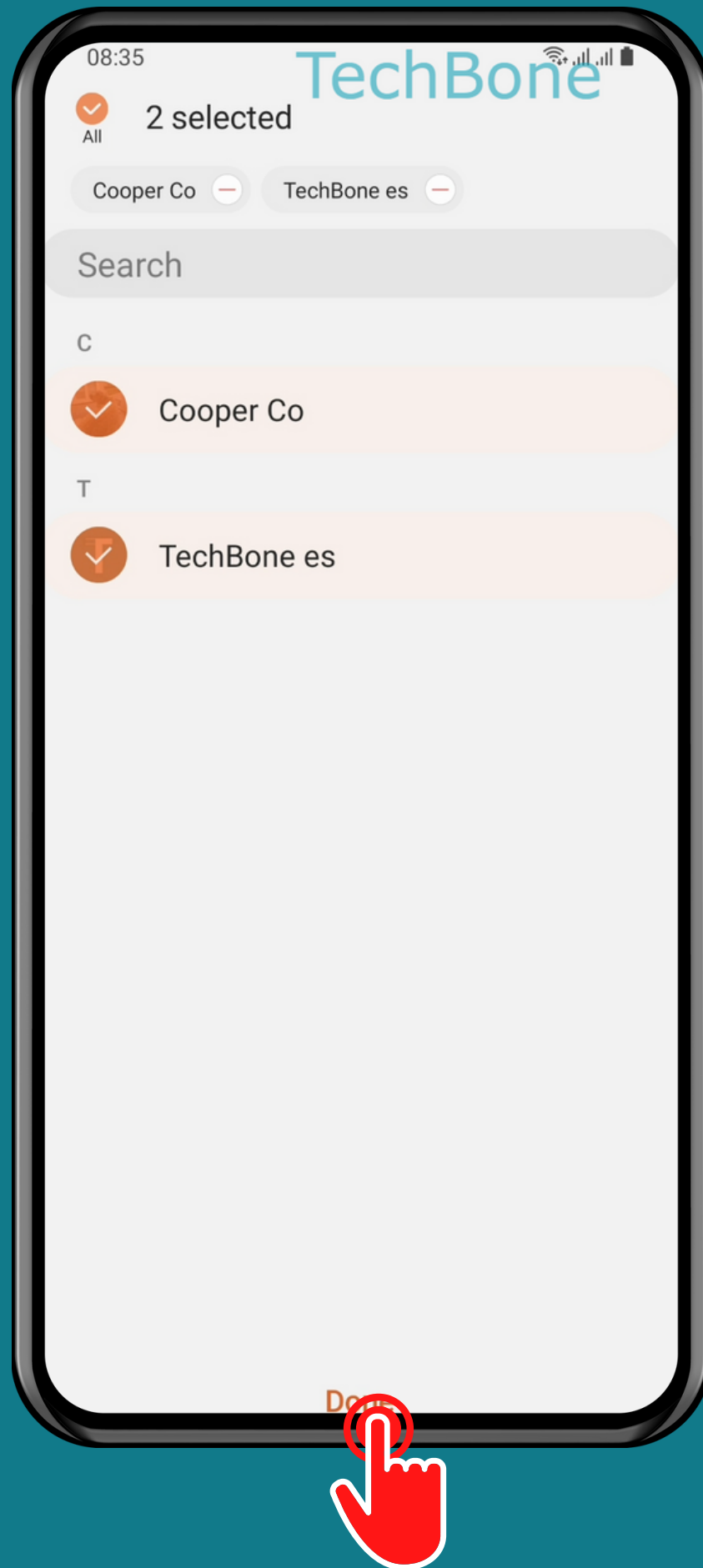

Select the  
Desired contacts and  
tap Done



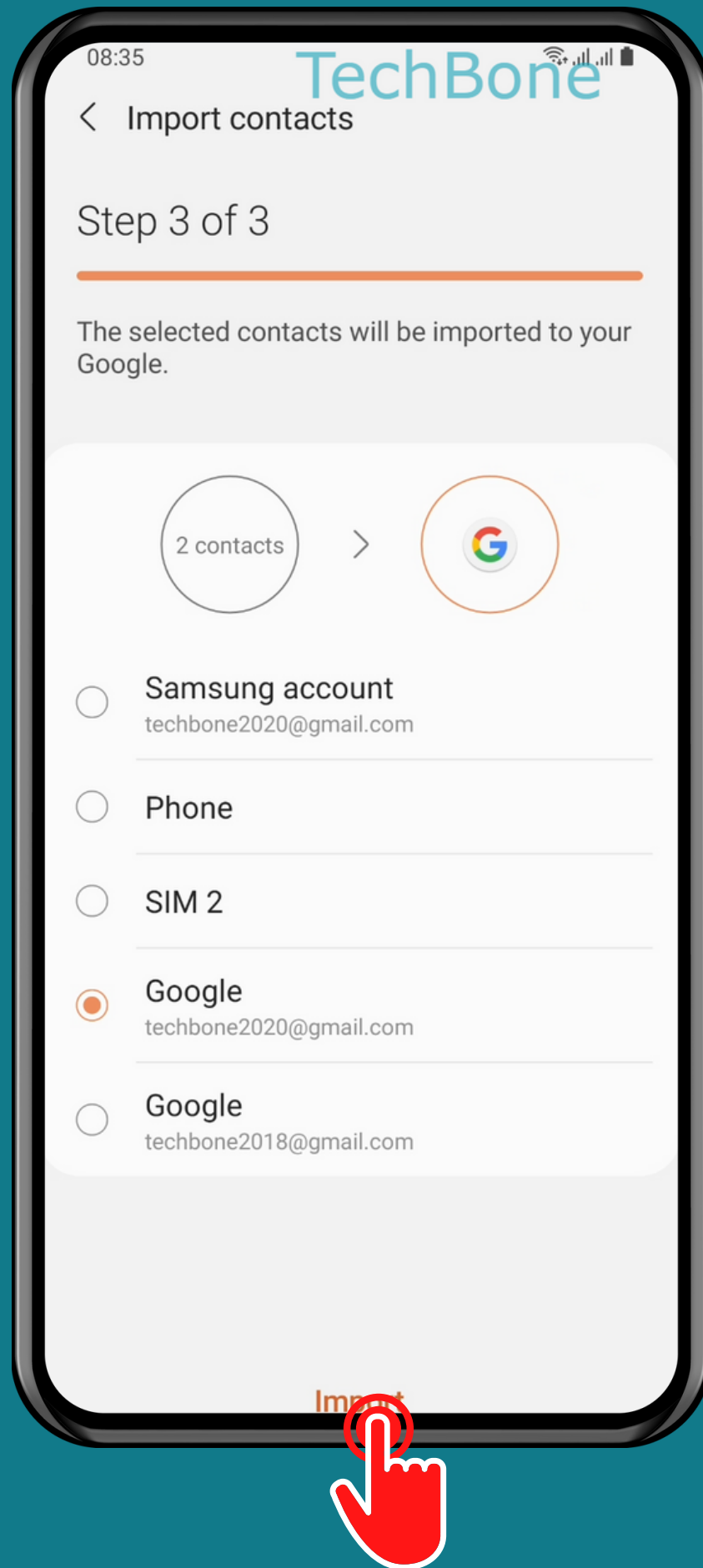

Select  
Where to import and  
tap on Import

Done!