

SAMSUNG

Android 11 - One UI 3

# HOW TO CHANGE MOBILE HOTSPOT BAND

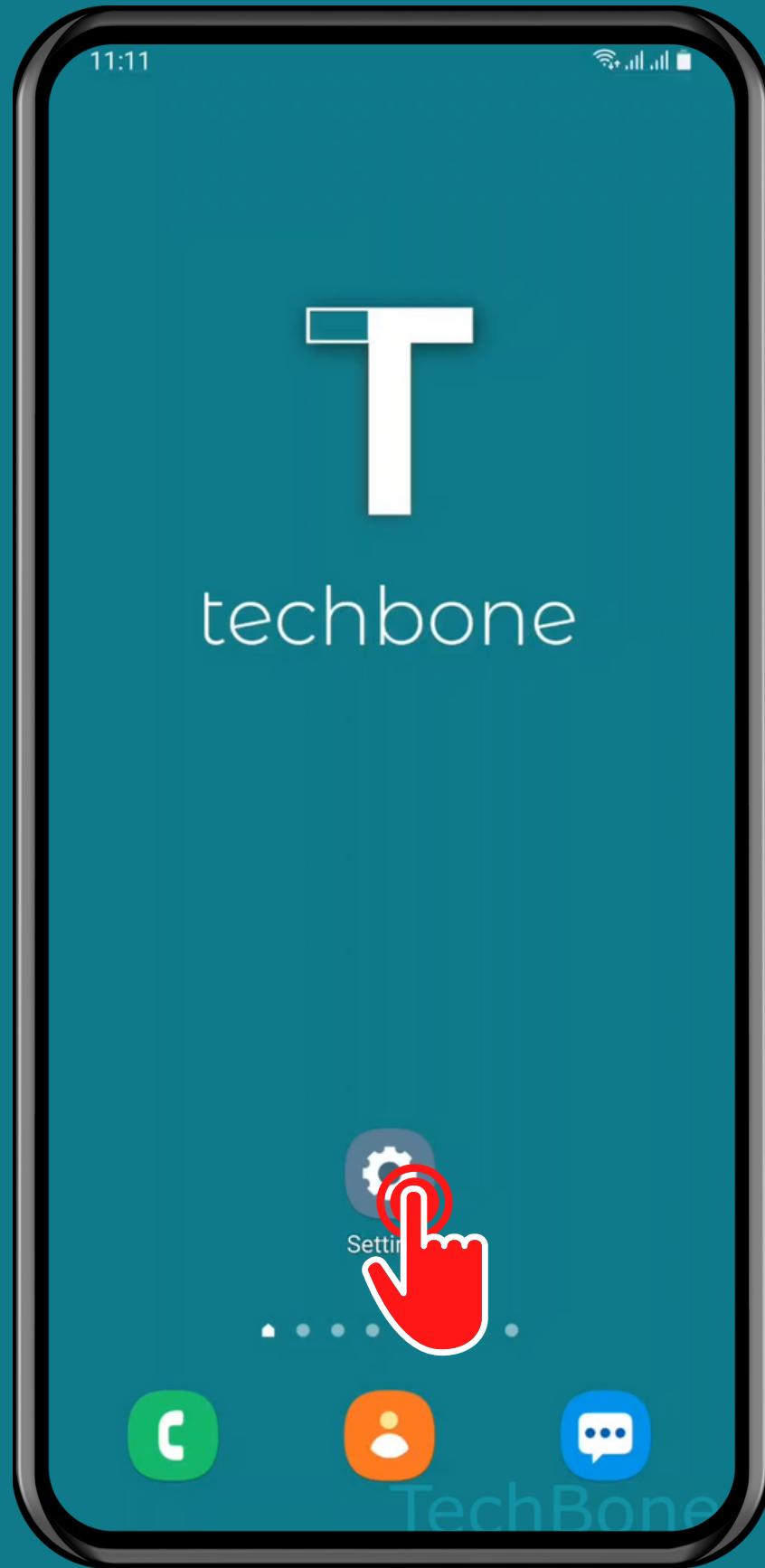

# Tap on Settings



# Tap on Connections

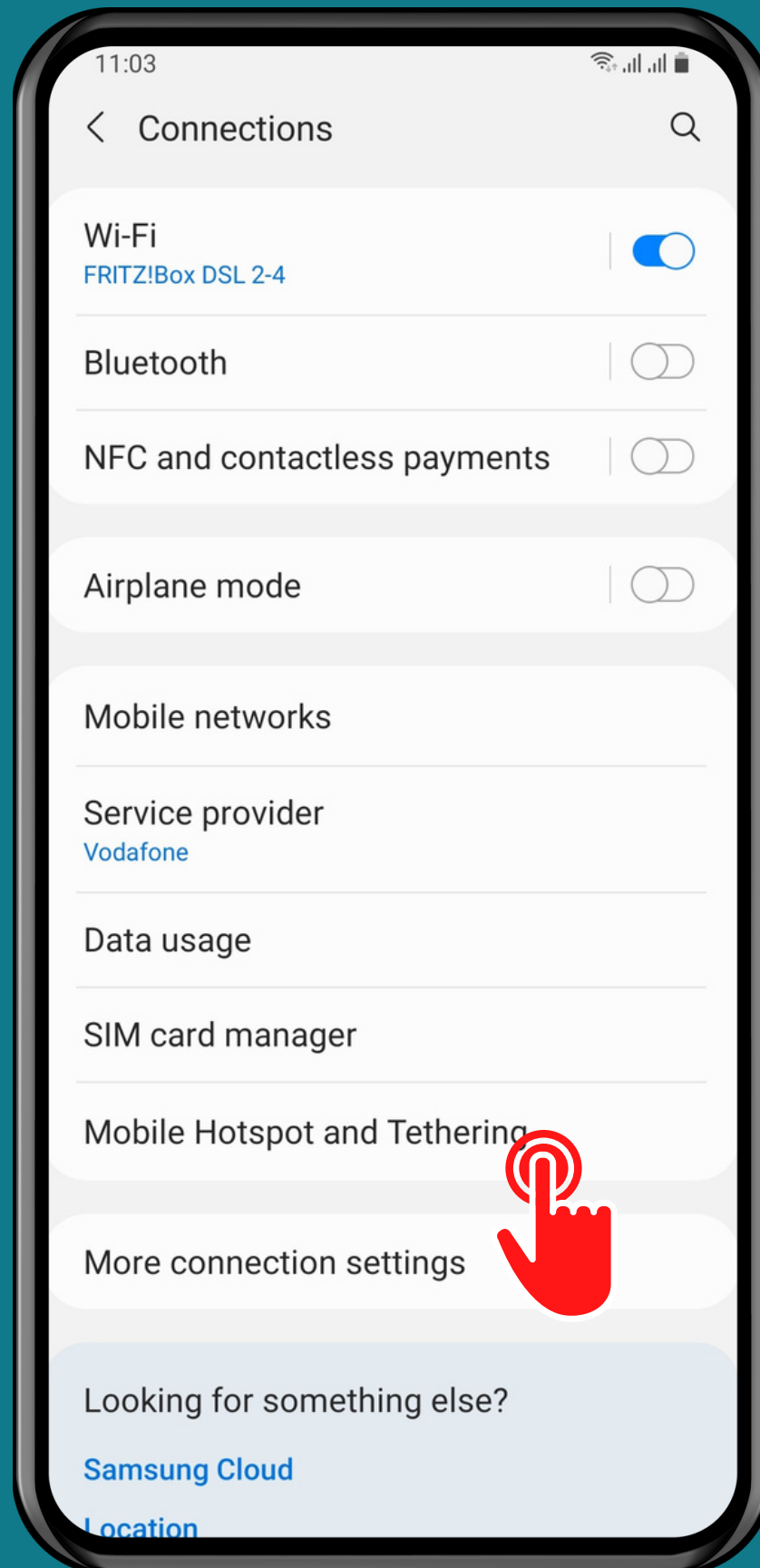

# Tap on Mobile Hotspot and Tethering

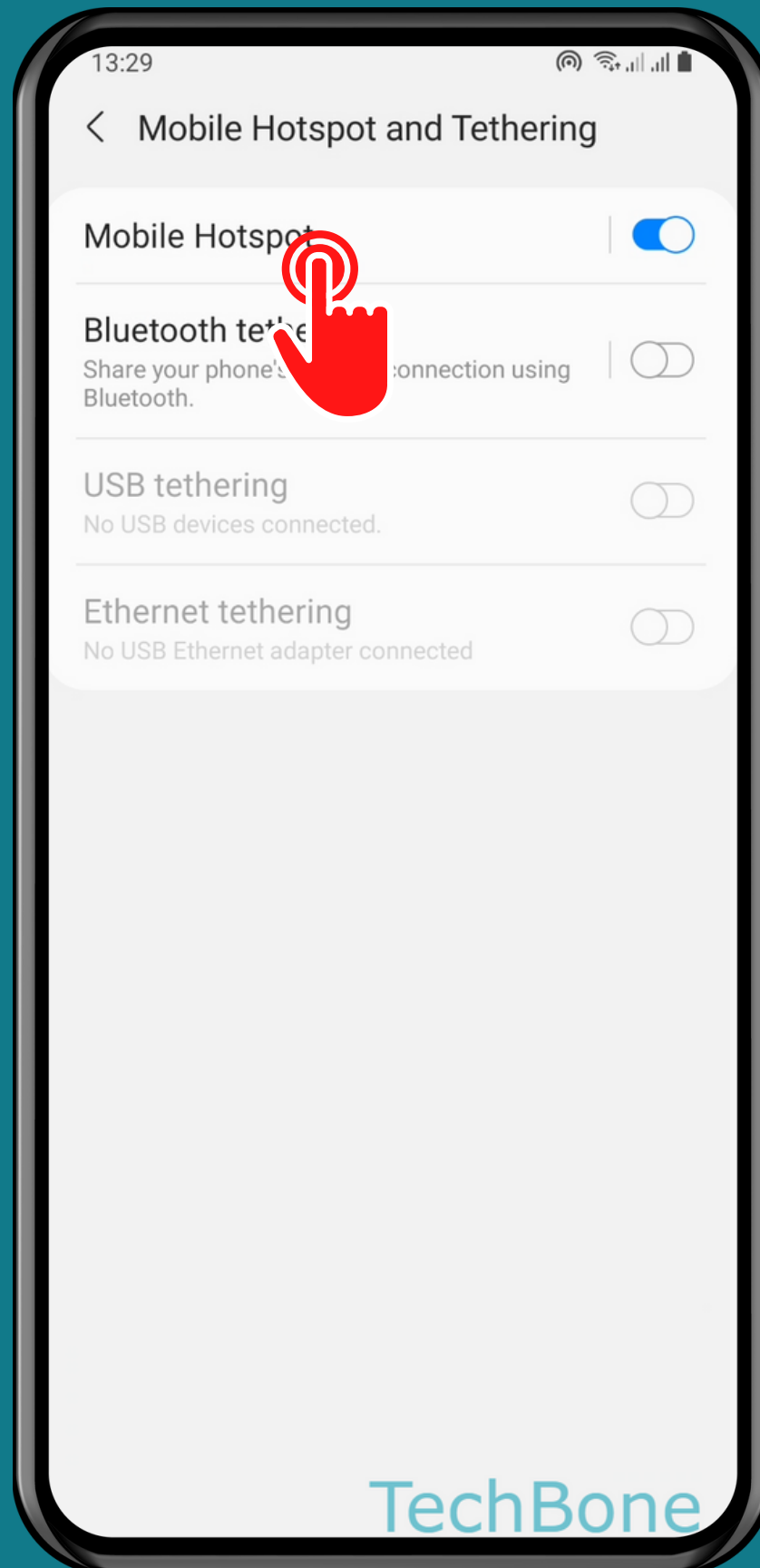

Tap on  
Mobile Hotspot

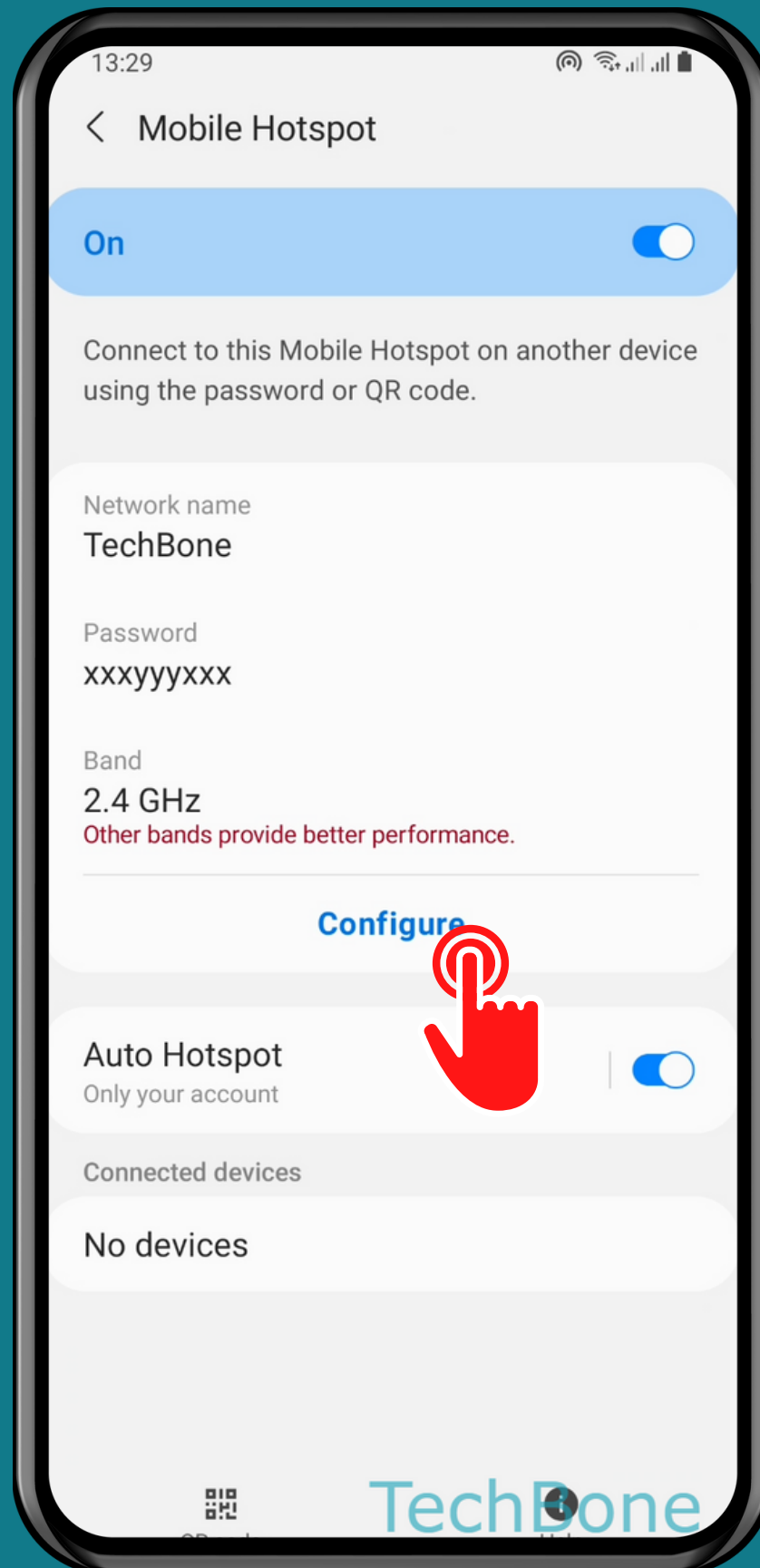

Tap on  
Configure

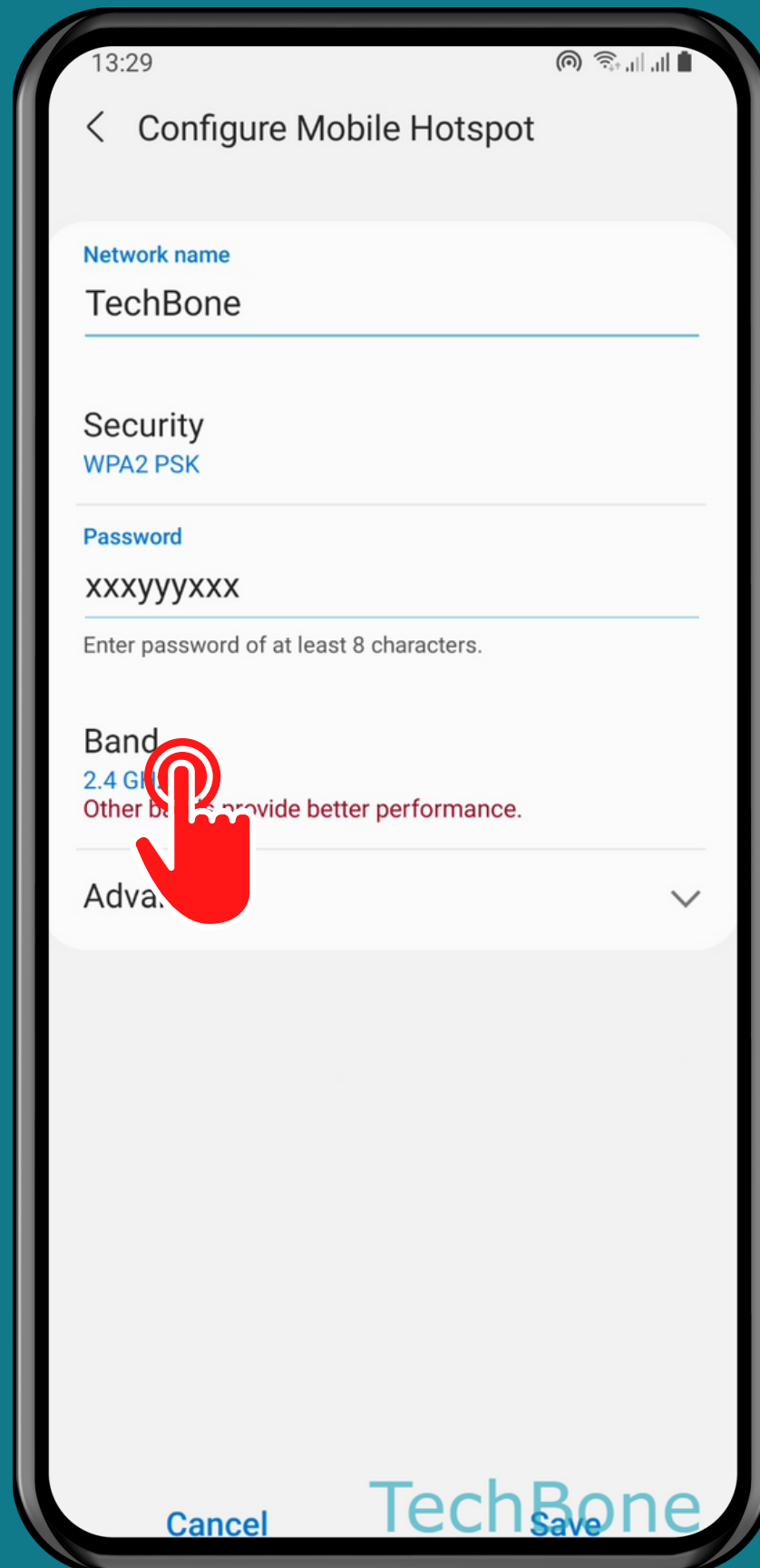

Tap on  
Band



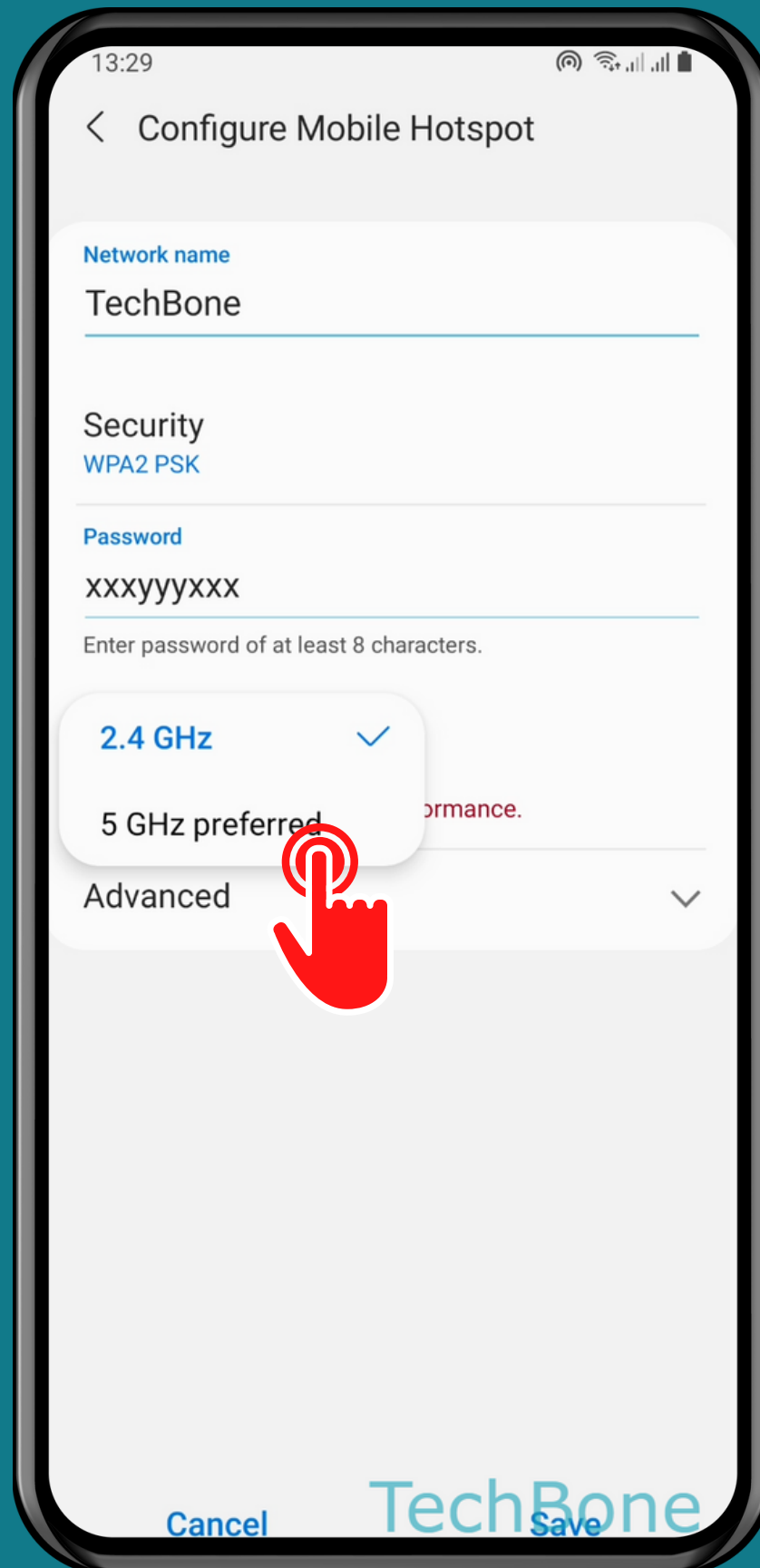

Choose an  
Option



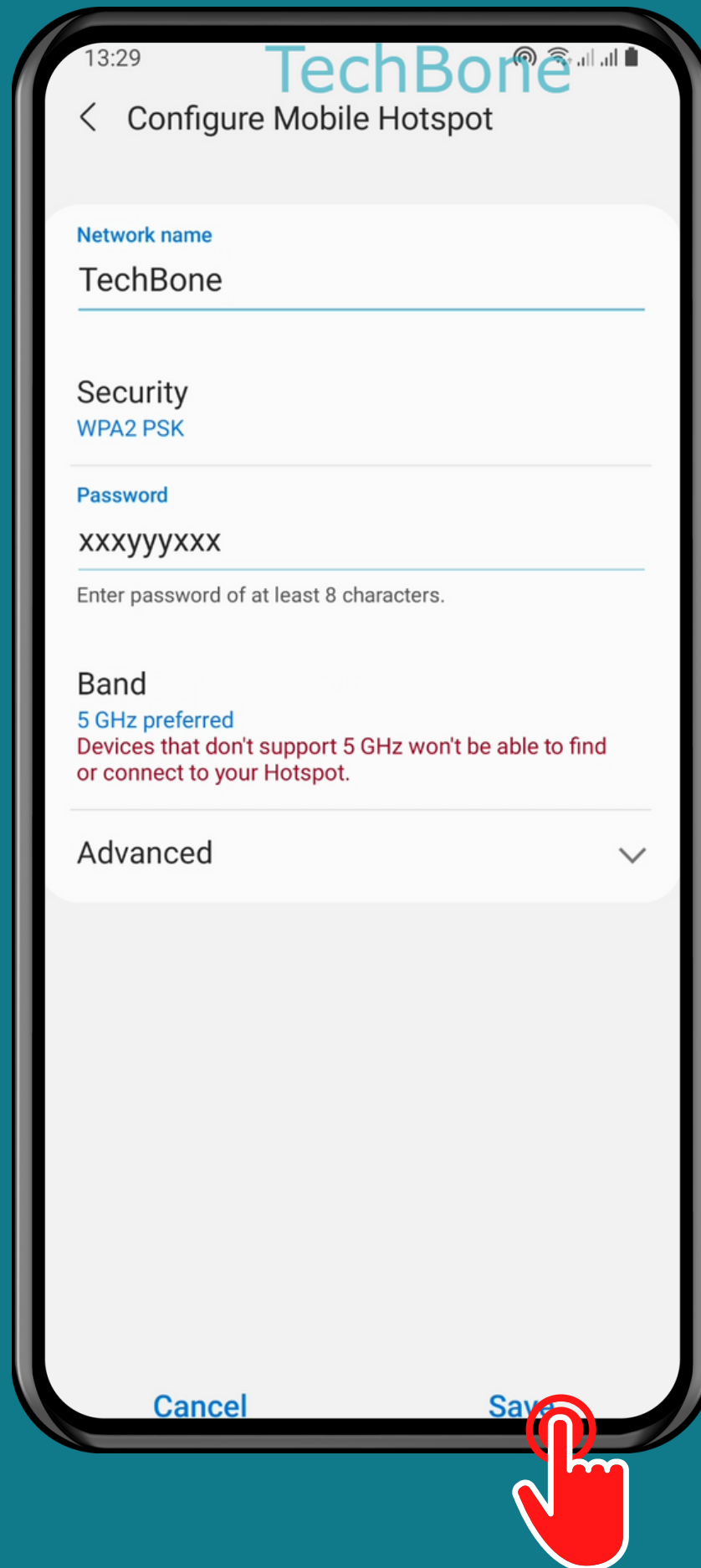

Tap on  
Save

Done!