

# SAMSUNG

Contacts - Android 11 - One UI 3

# HOW TO MOVE CONTACTS TO OTHER STORAGE LOCATION

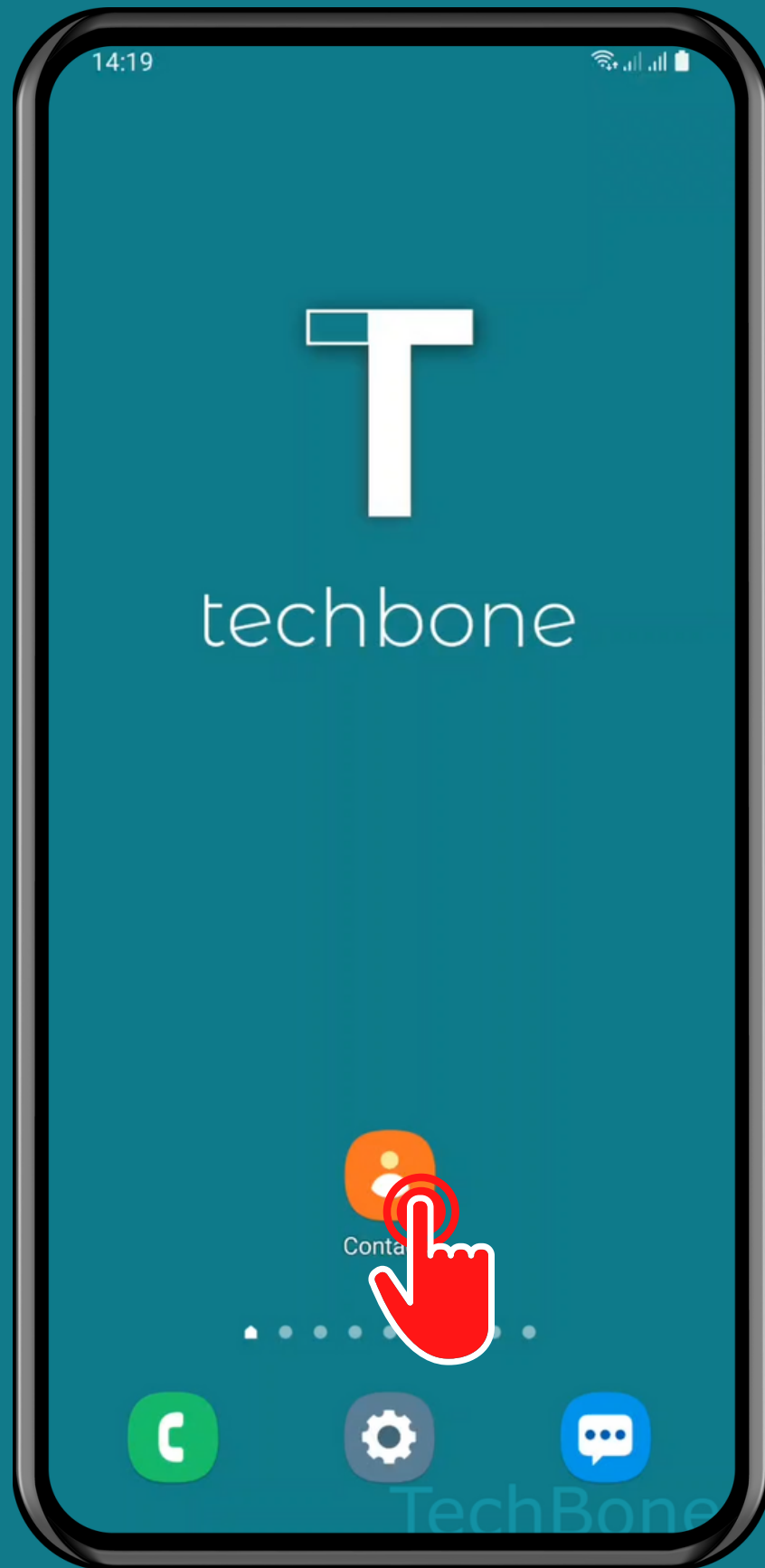

# Tap on Contacts

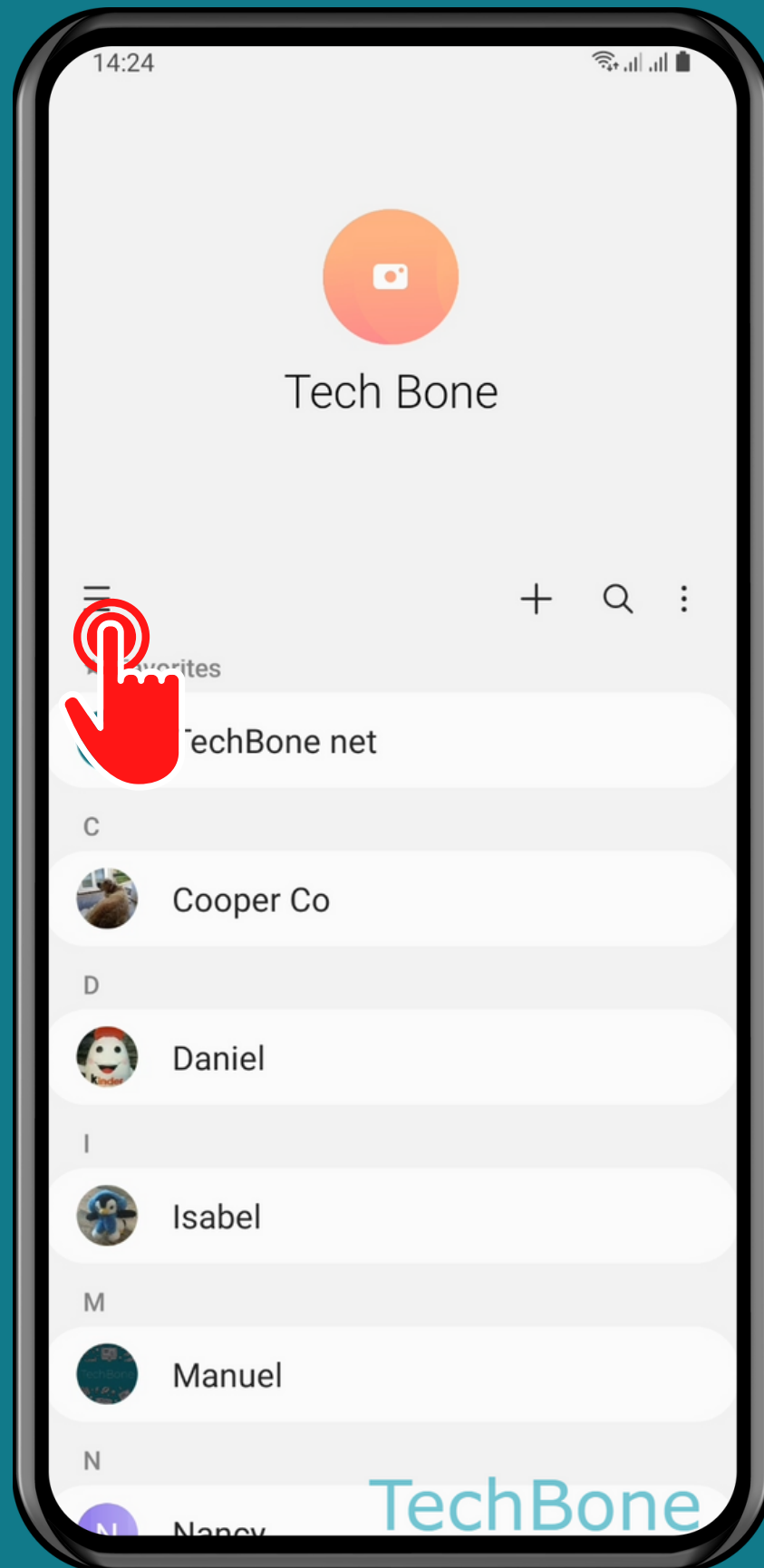

# Open the Menu

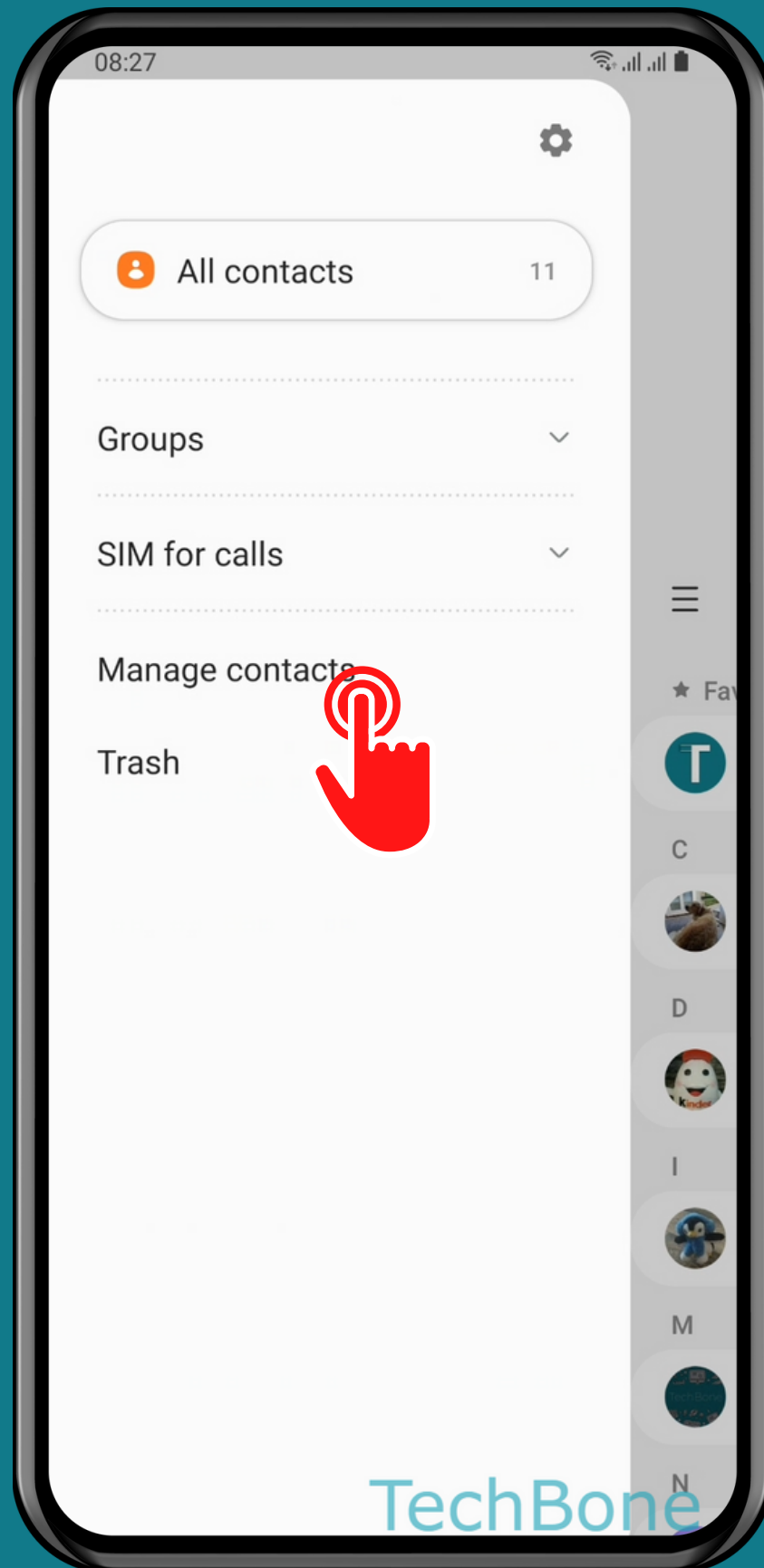

Tap on  
Manage contacts

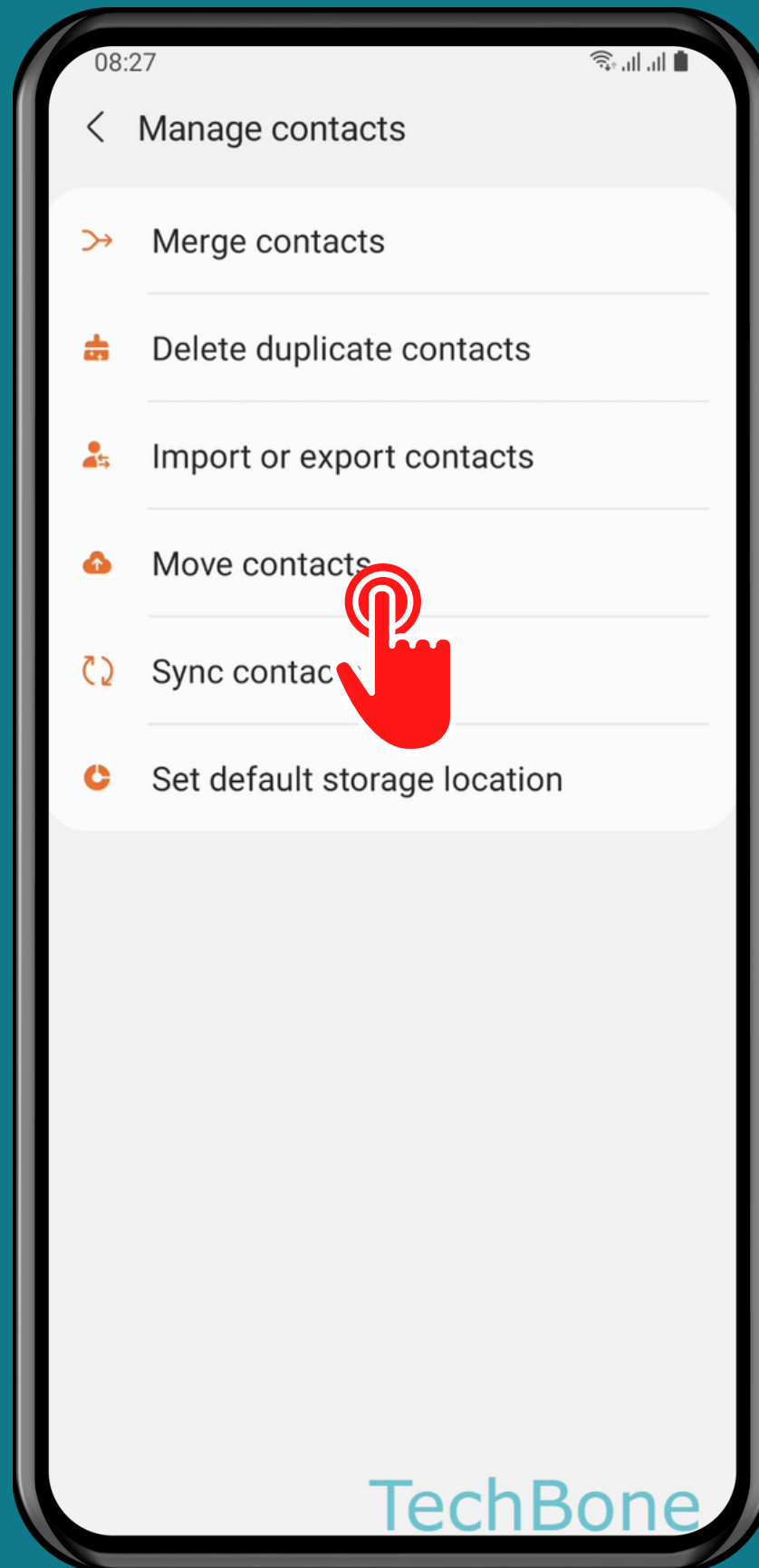

Tap on  
Move contacts

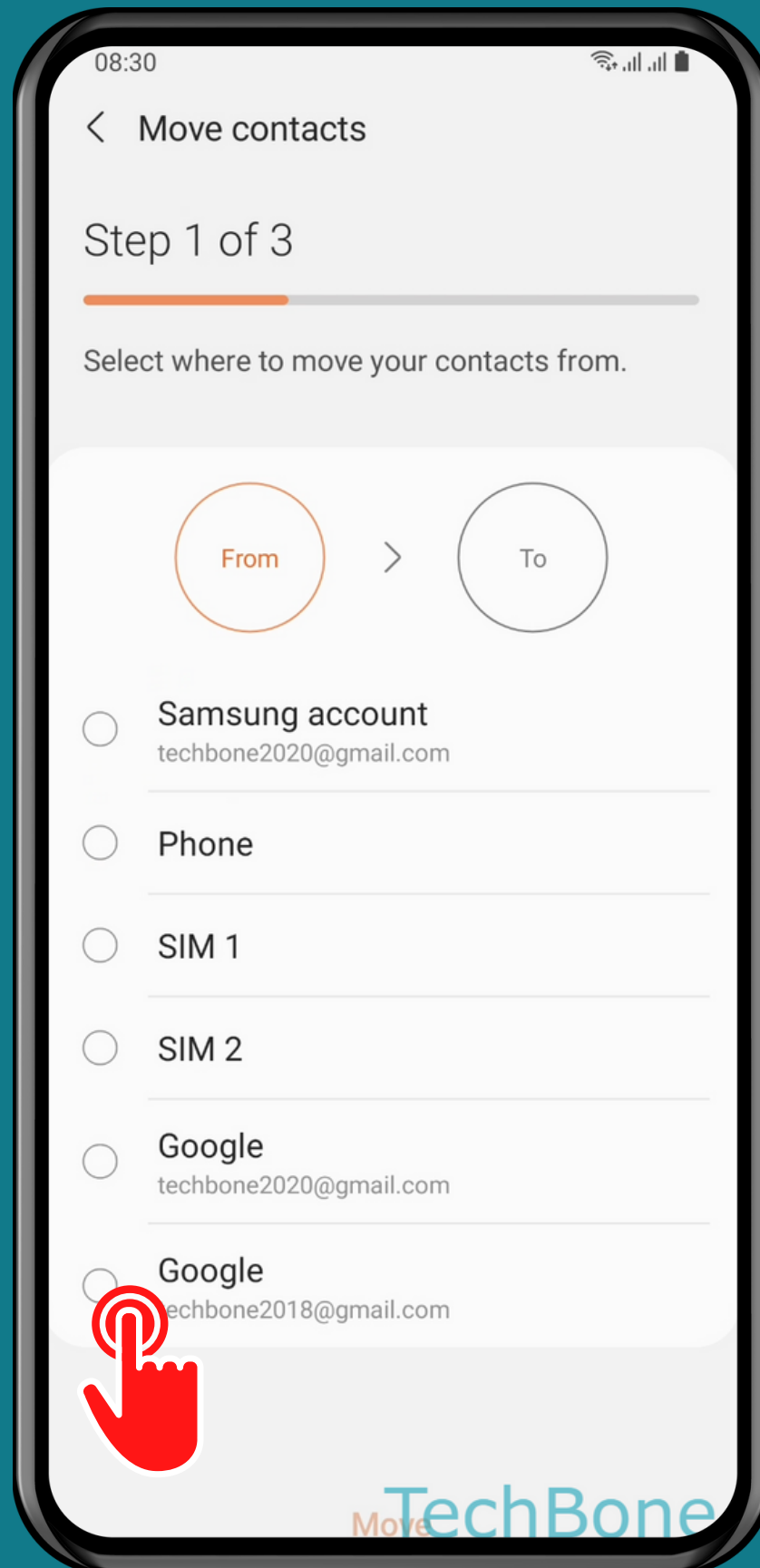

# Choose

# From where to move

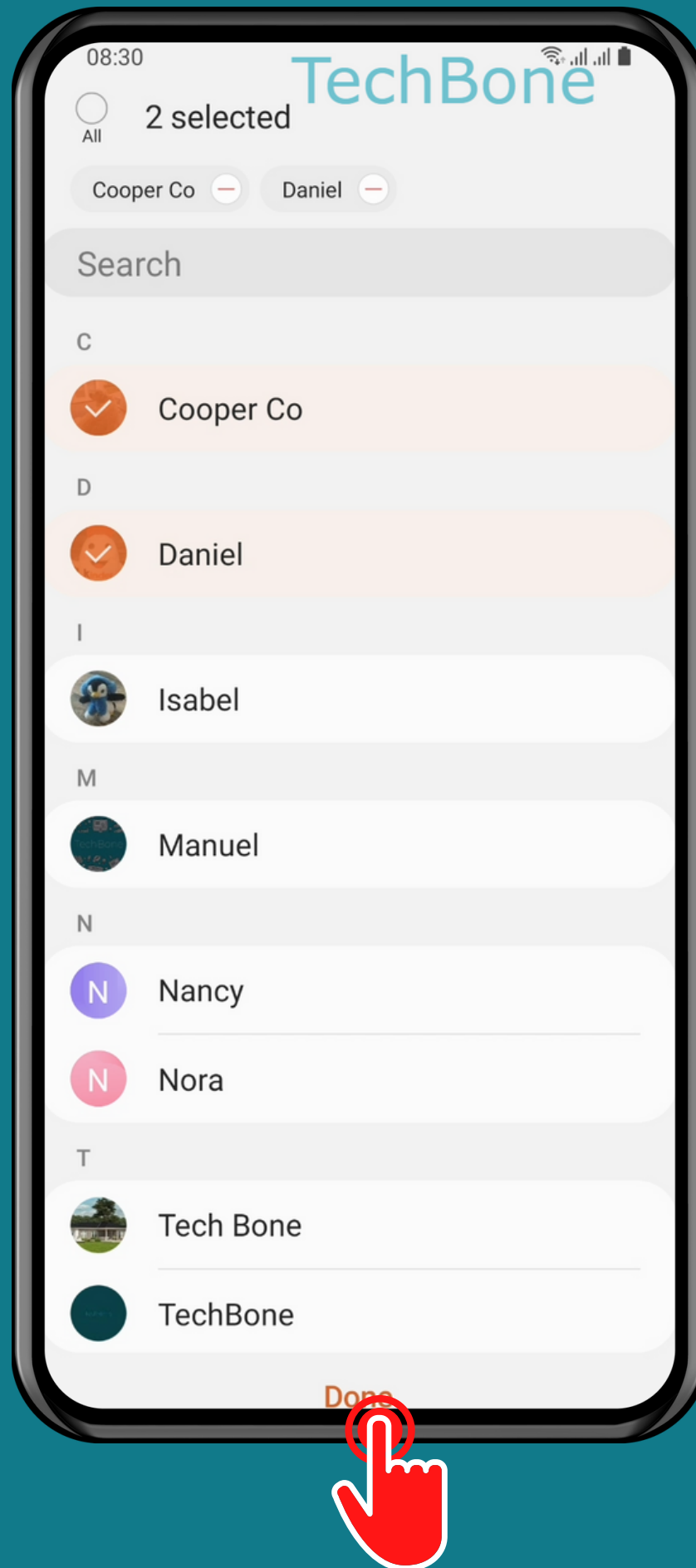

Select the  
Desired contacts and  
tap Done

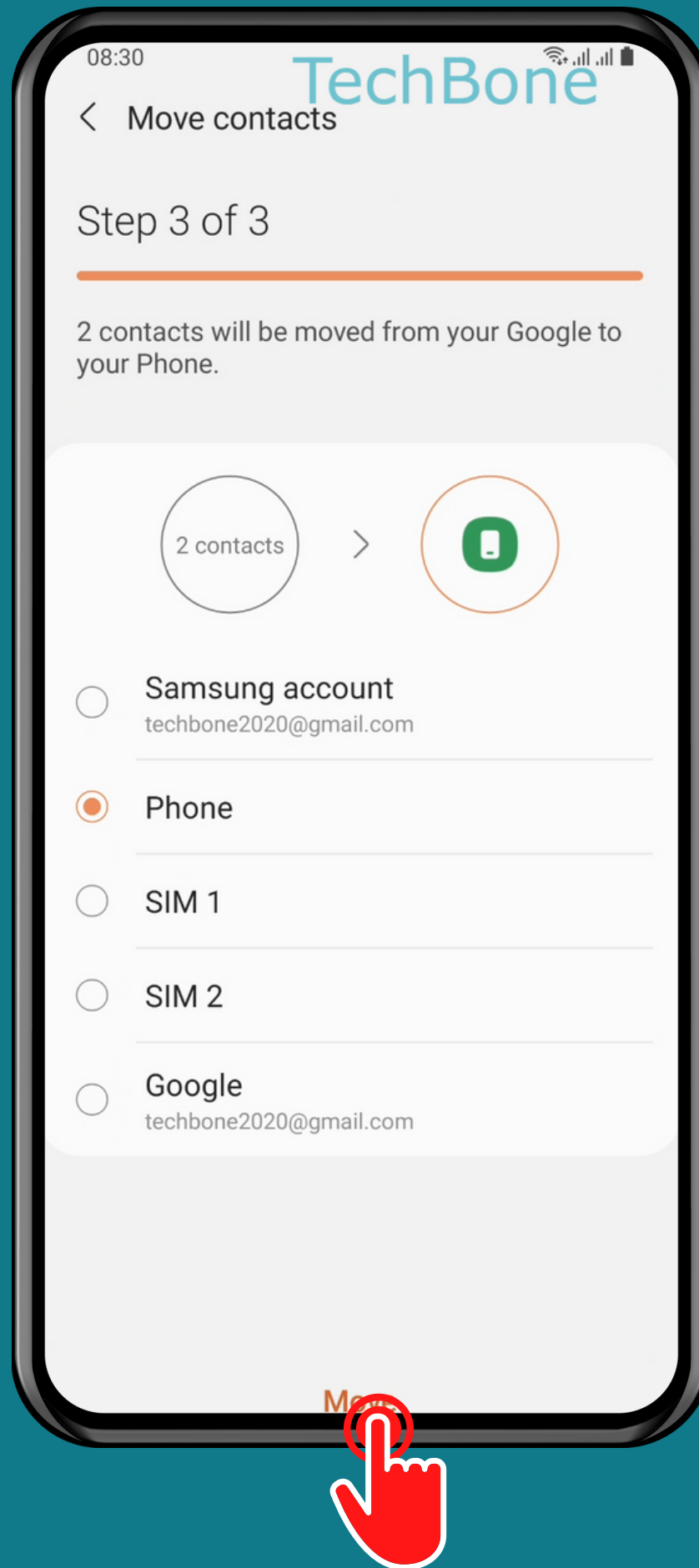

Select  
Where to move and  
tap Move



Done!