

SAMSUNG

Android 11 - One UI 3

HOW TO TURN ON/OFF OPEN-EYES REQUIREMENT (FACE RECOGNITION)

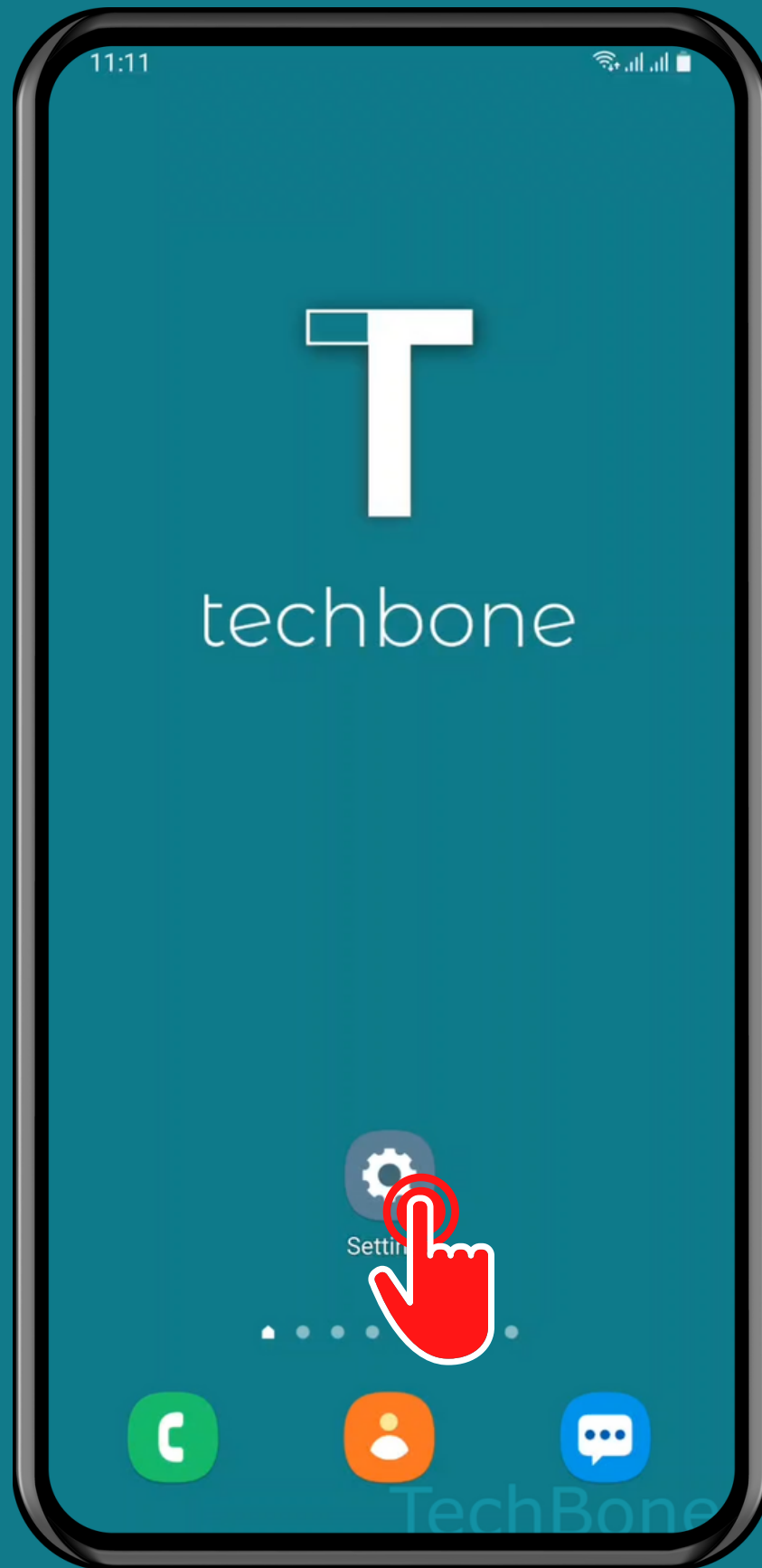

Tap on
Settings

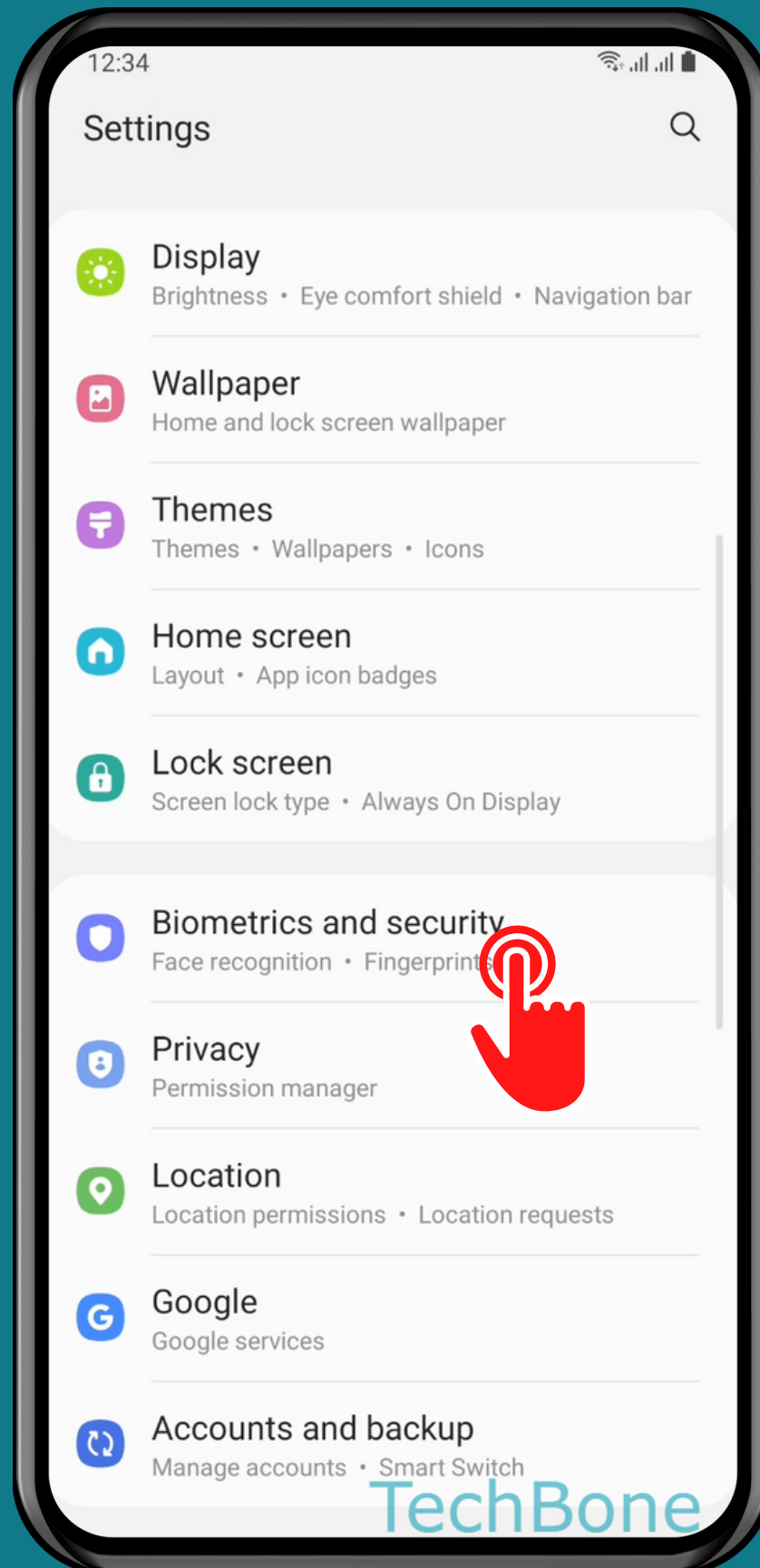

Tap on Biometrics and security

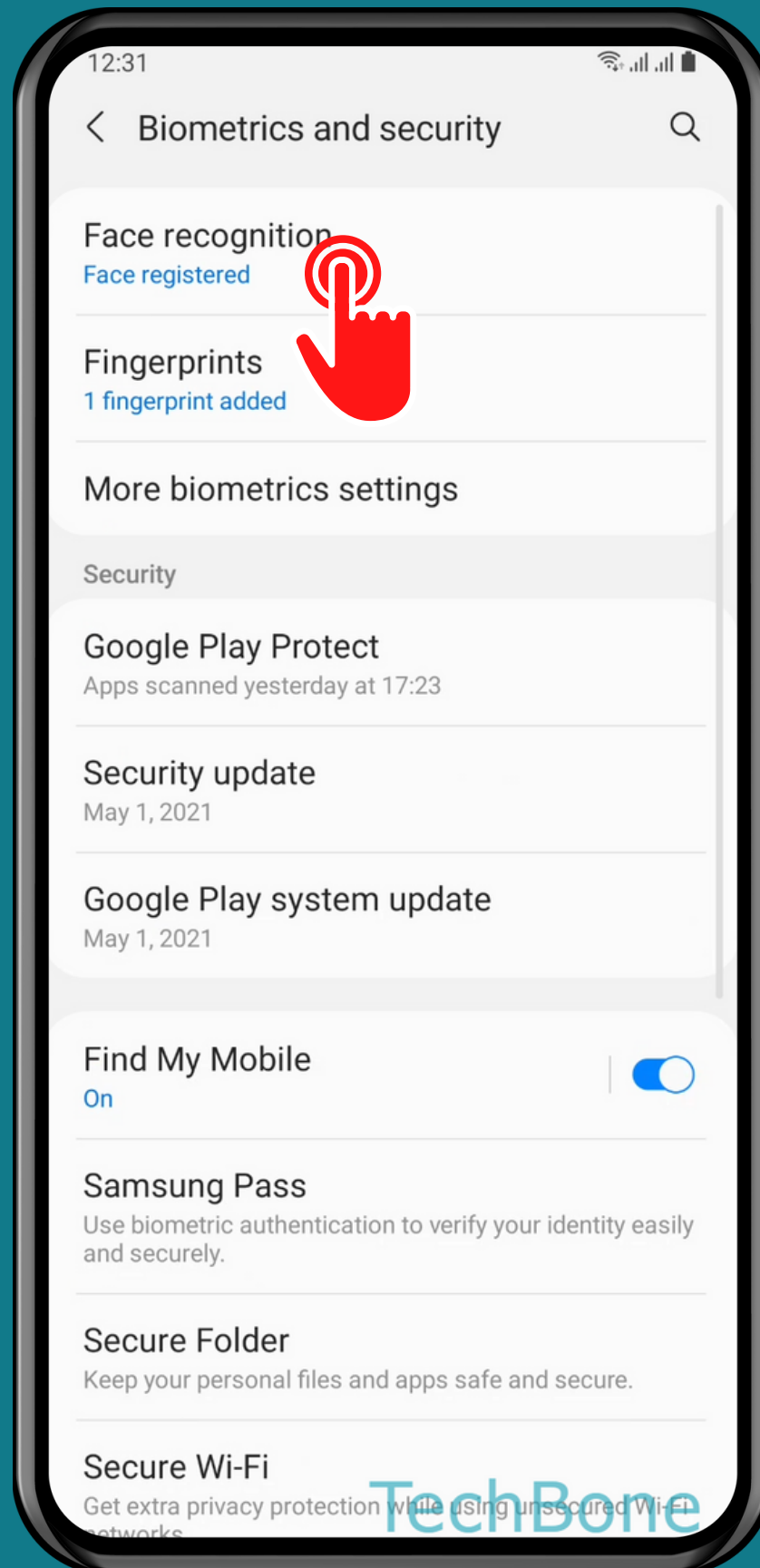

Tap on Face recognition

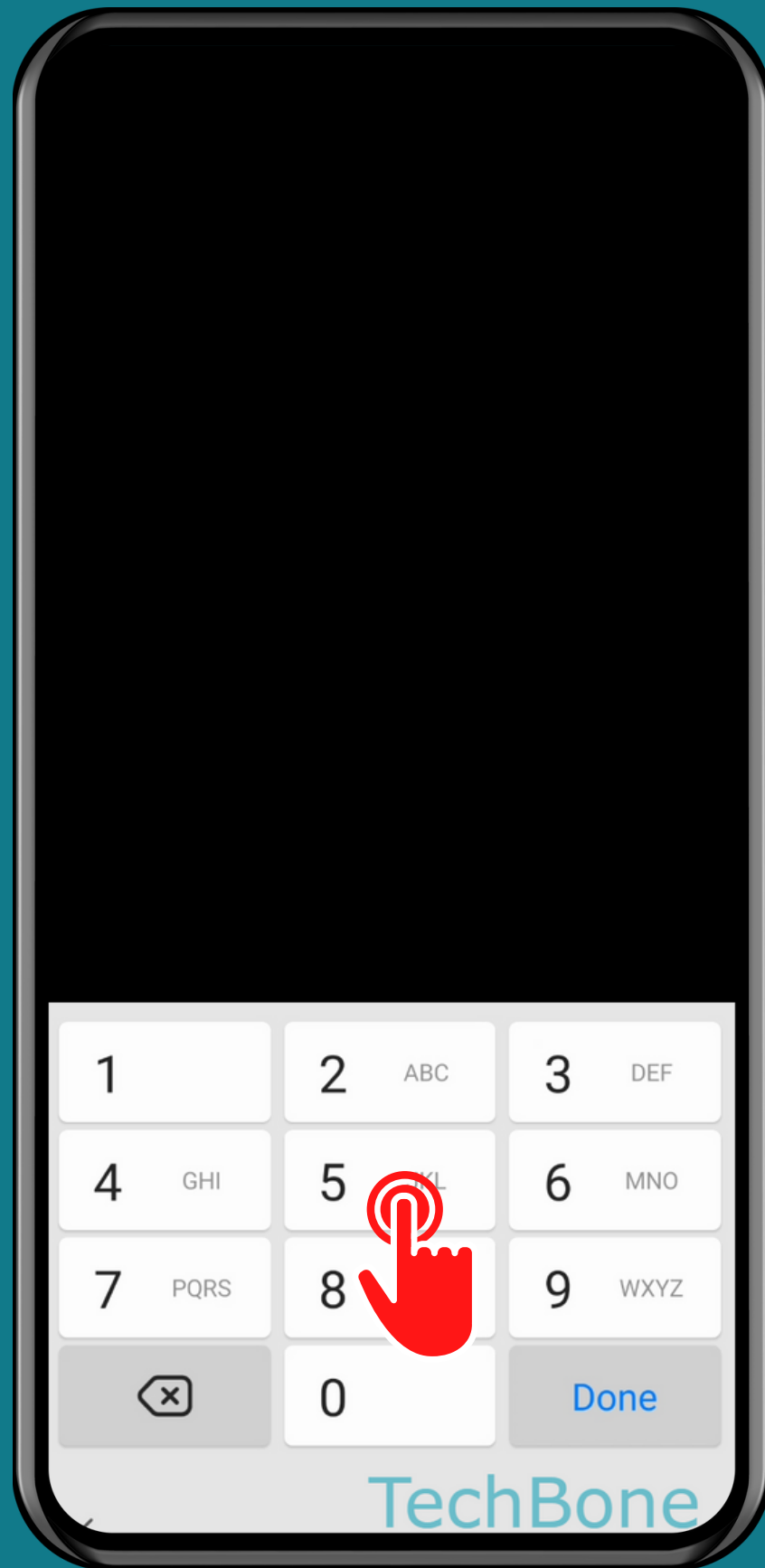

Enter the current
Pattern, PIN or
Password

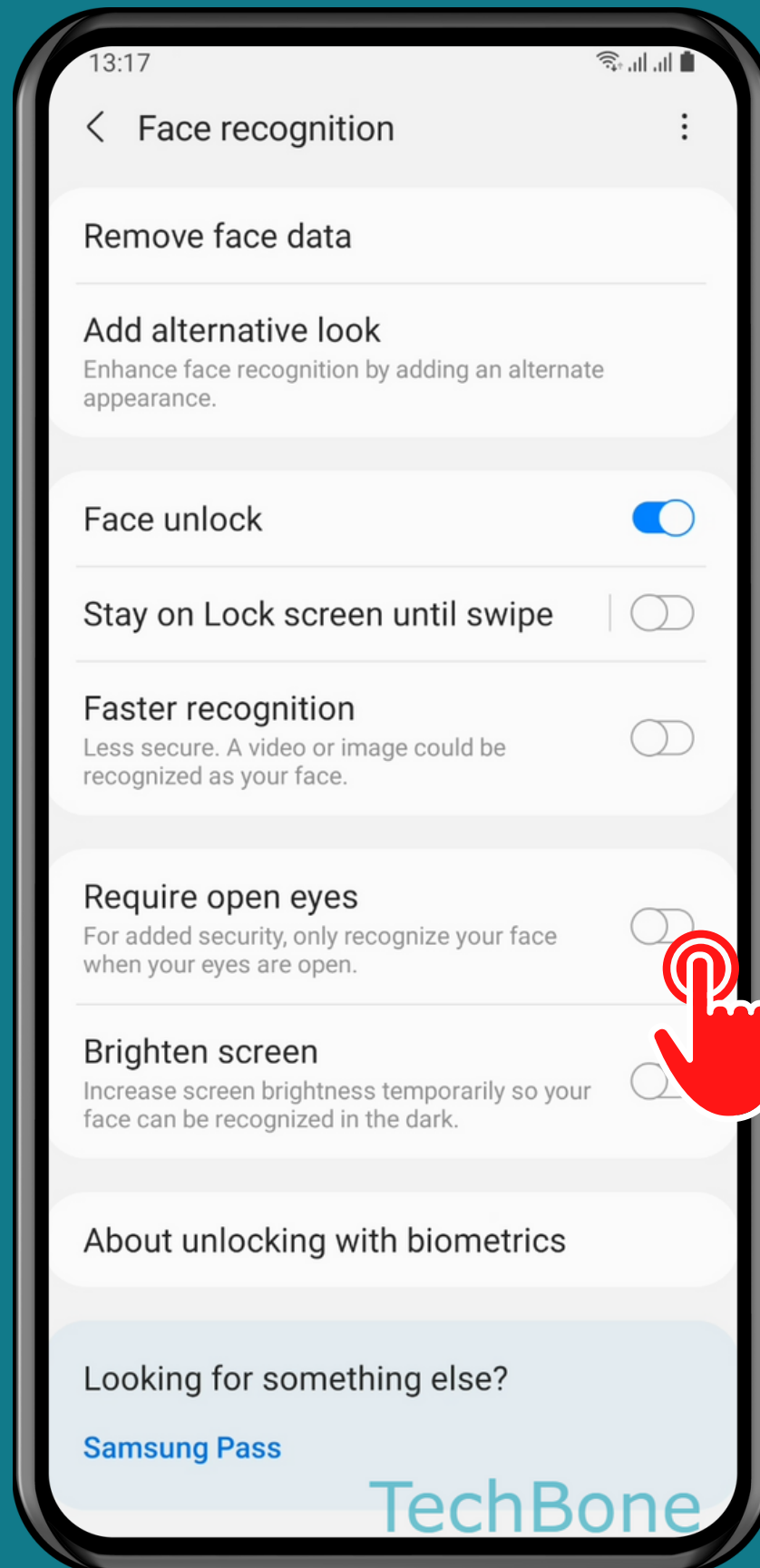

Turn On/Off Require open eyes

Done!