

SAMSUNG

Android 11 - One UI 3

HOW TO SHOW ALWAYS OR SCHEDULE ALWAYS ON DISPLAY



Tap on Settings

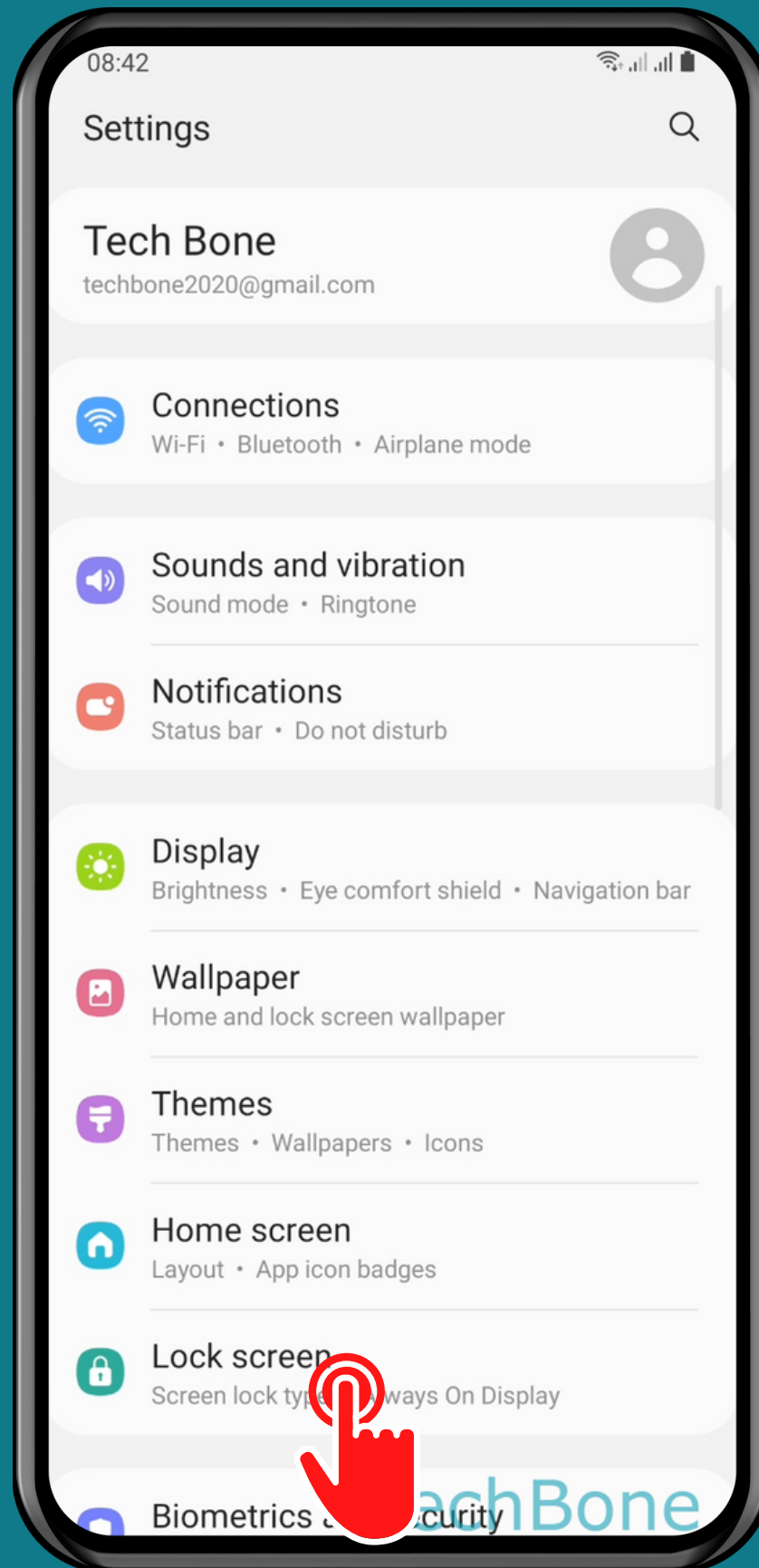

Tap on
Lock screen

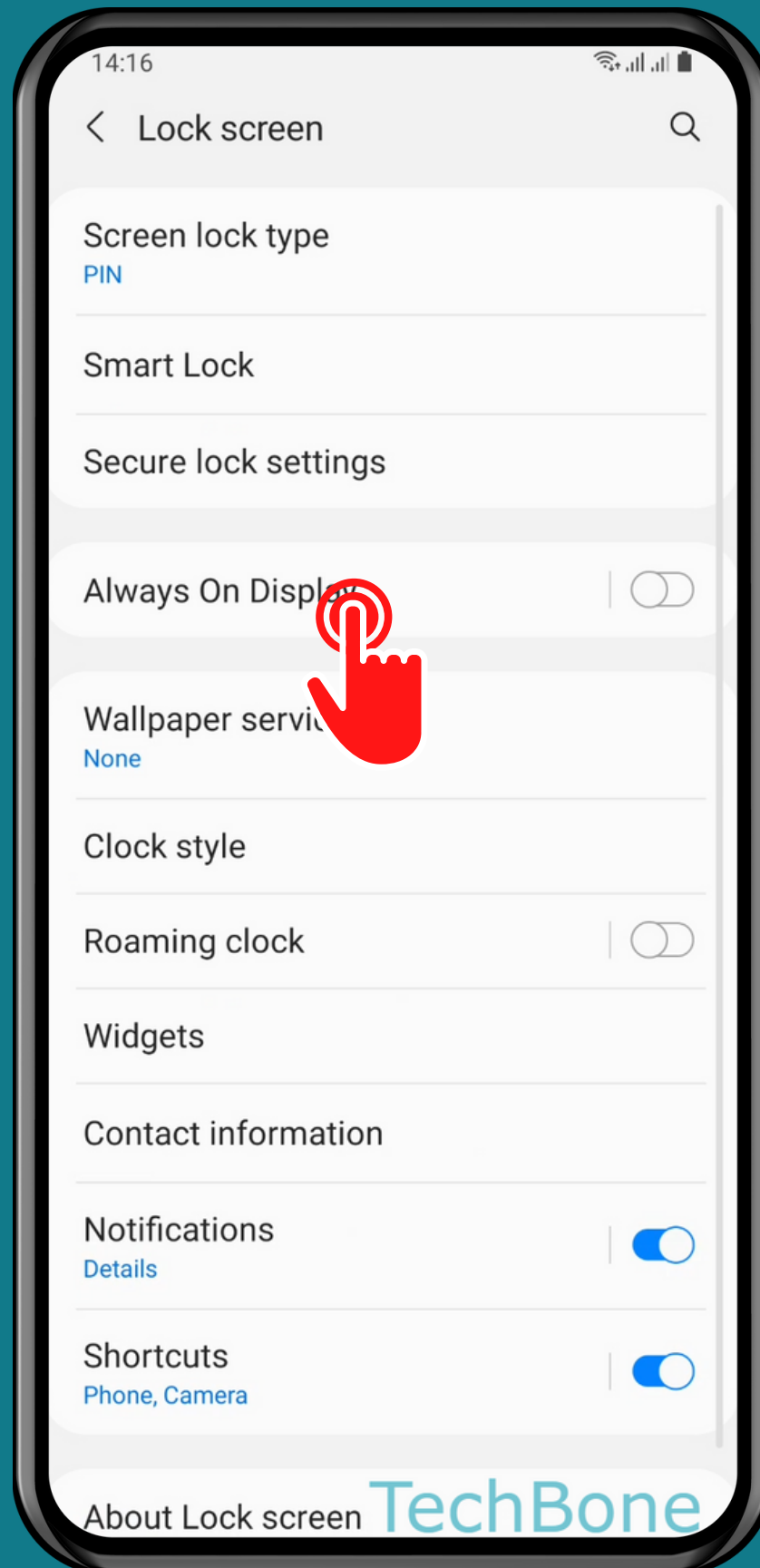

Tap on
Always On Display

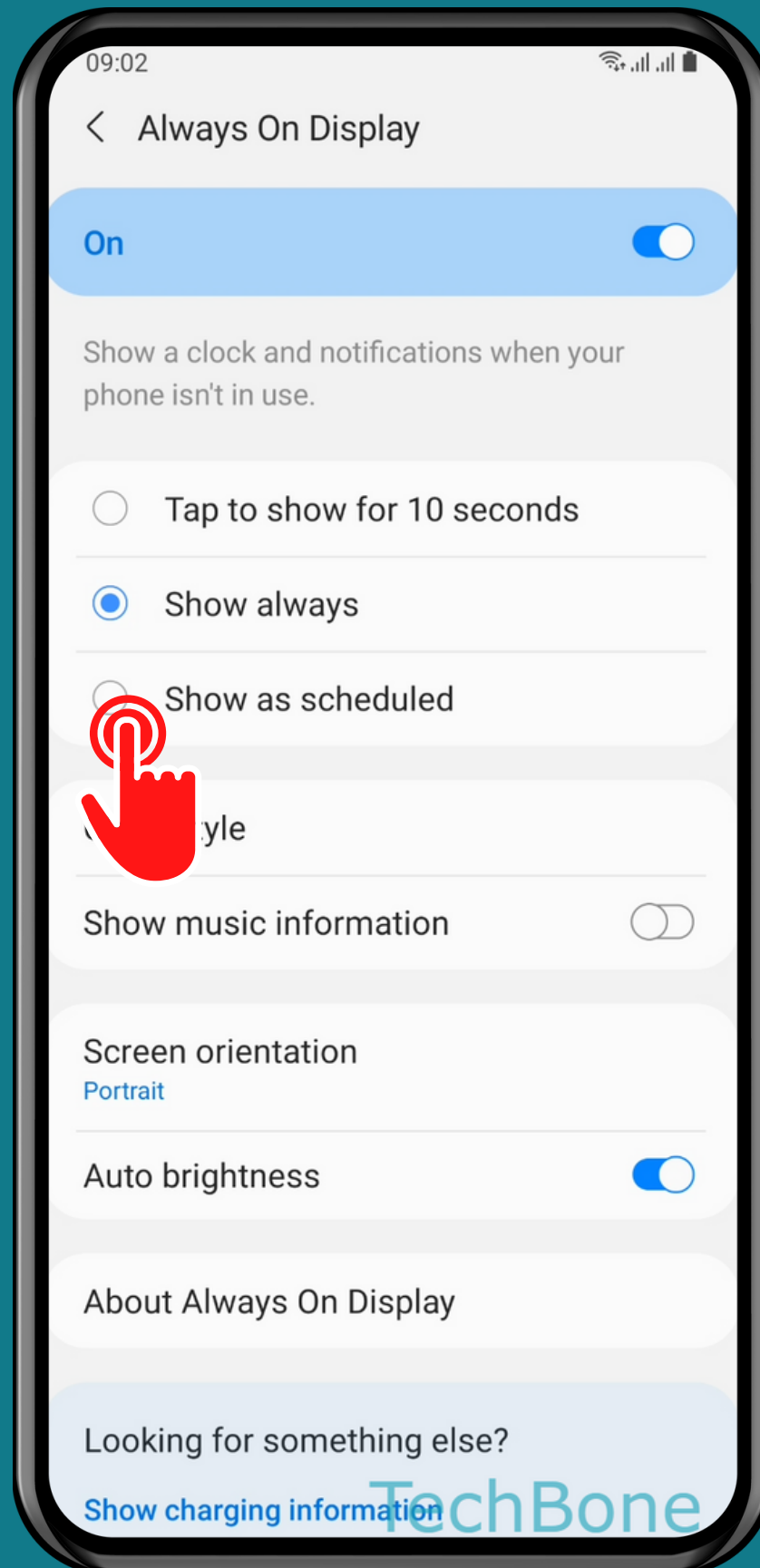

Choose **Show always**
or **Show as scheduled**

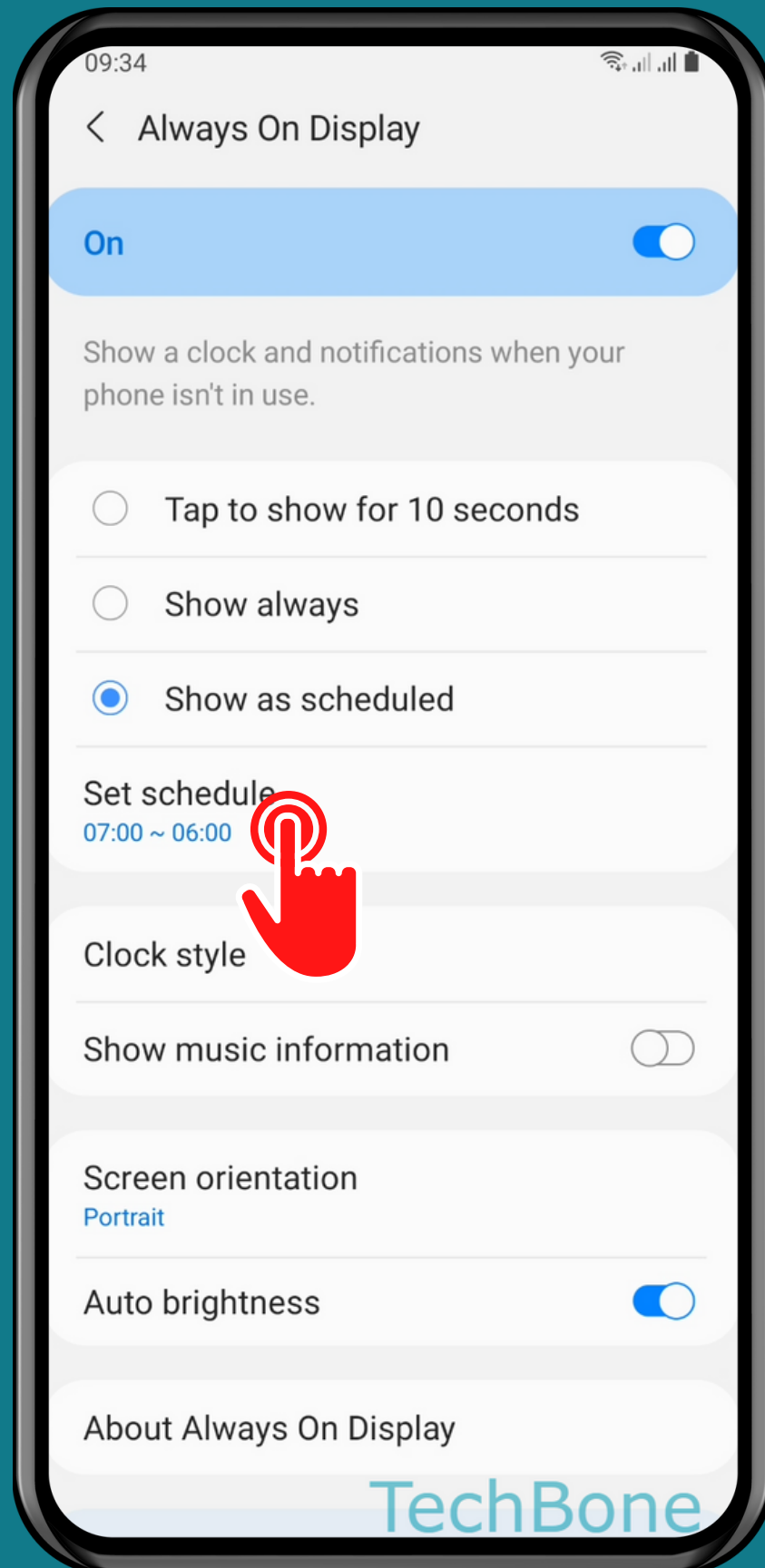

Tap on Set schedule

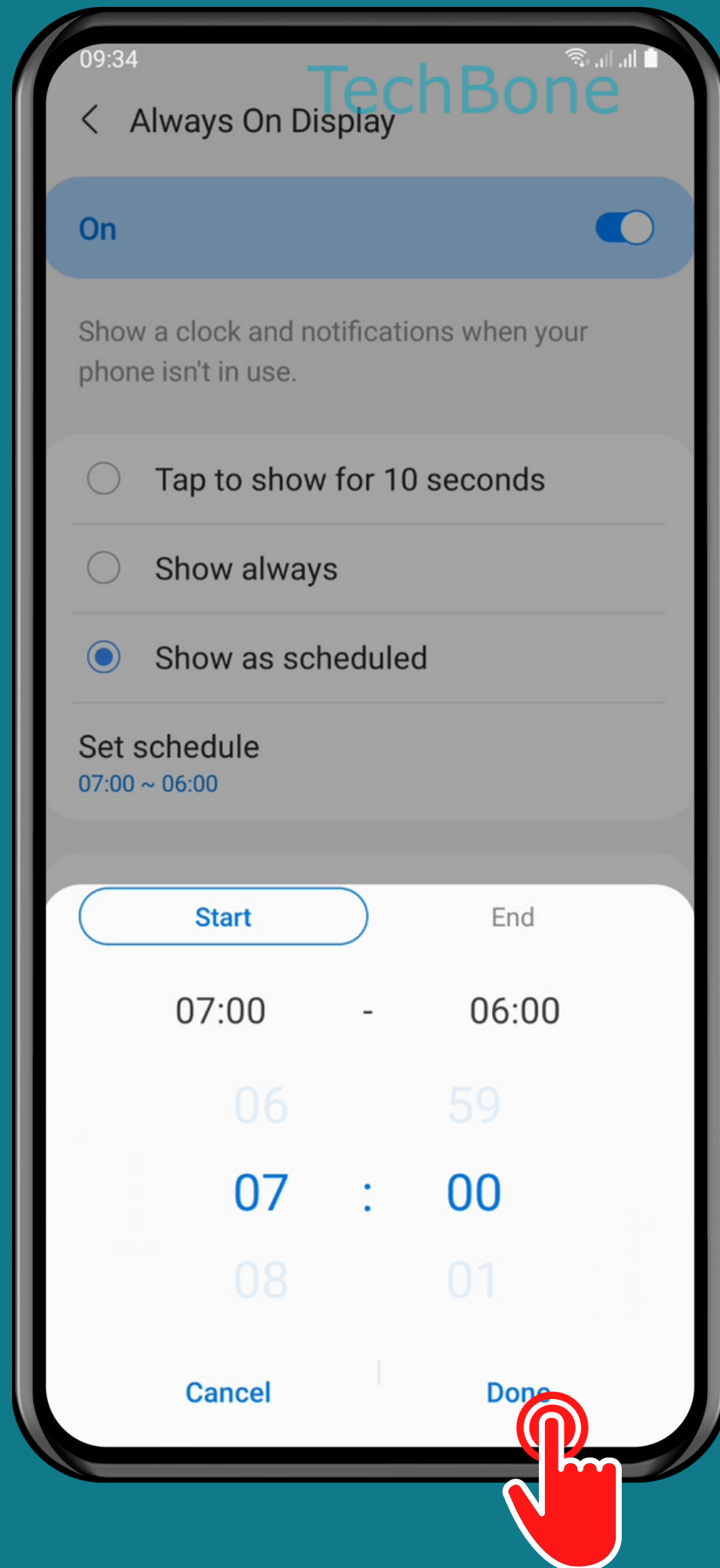

Set the **Start/End**
time and tap **Done**

Done!