

SAMSUNG

Android 11 - One UI 3

STAY ON LOCK SCREEN UNTIL SWIPE (FACE RECOGNITION)



Tap on
Settings

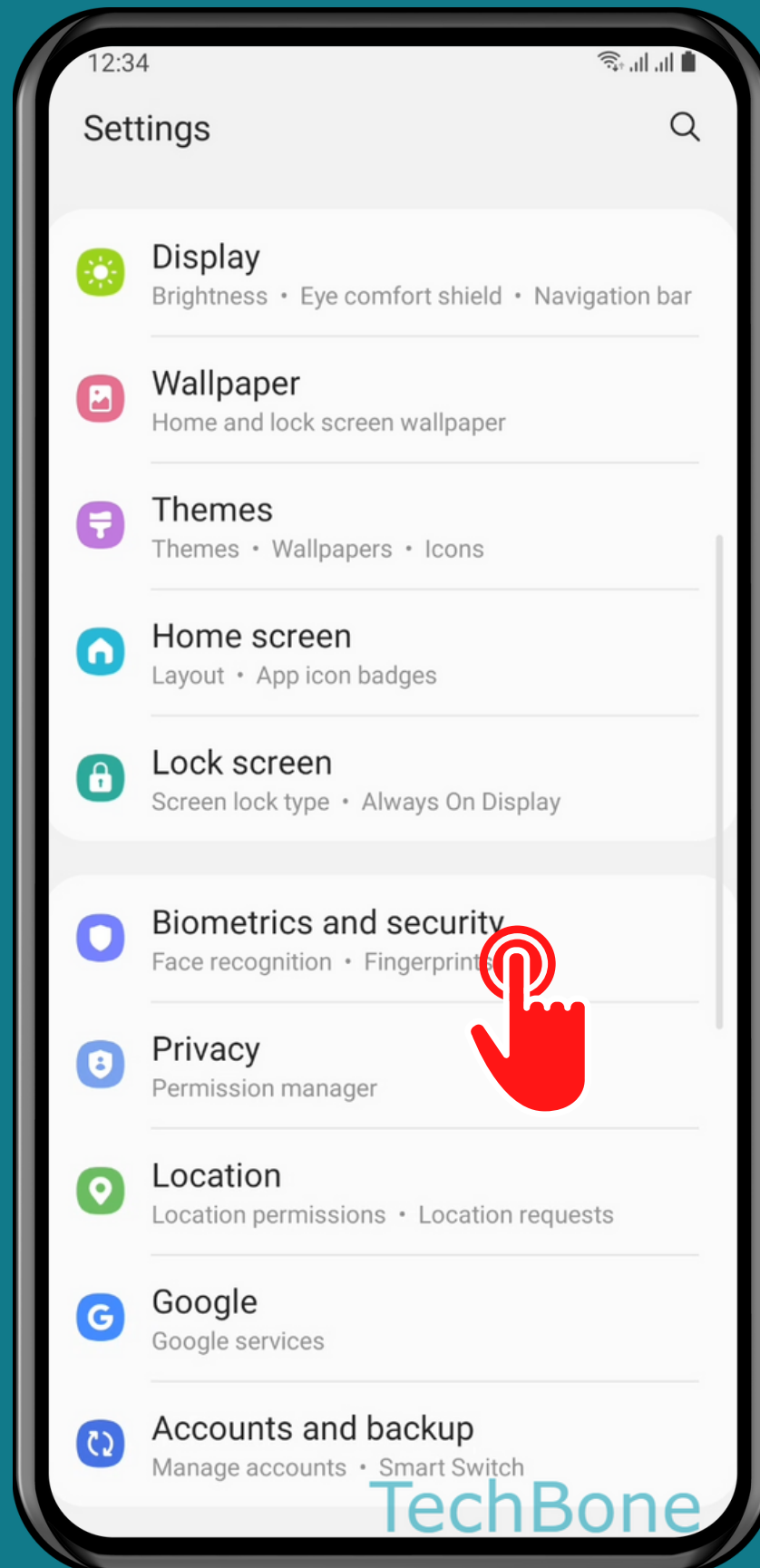

Tap on Biometrics and security

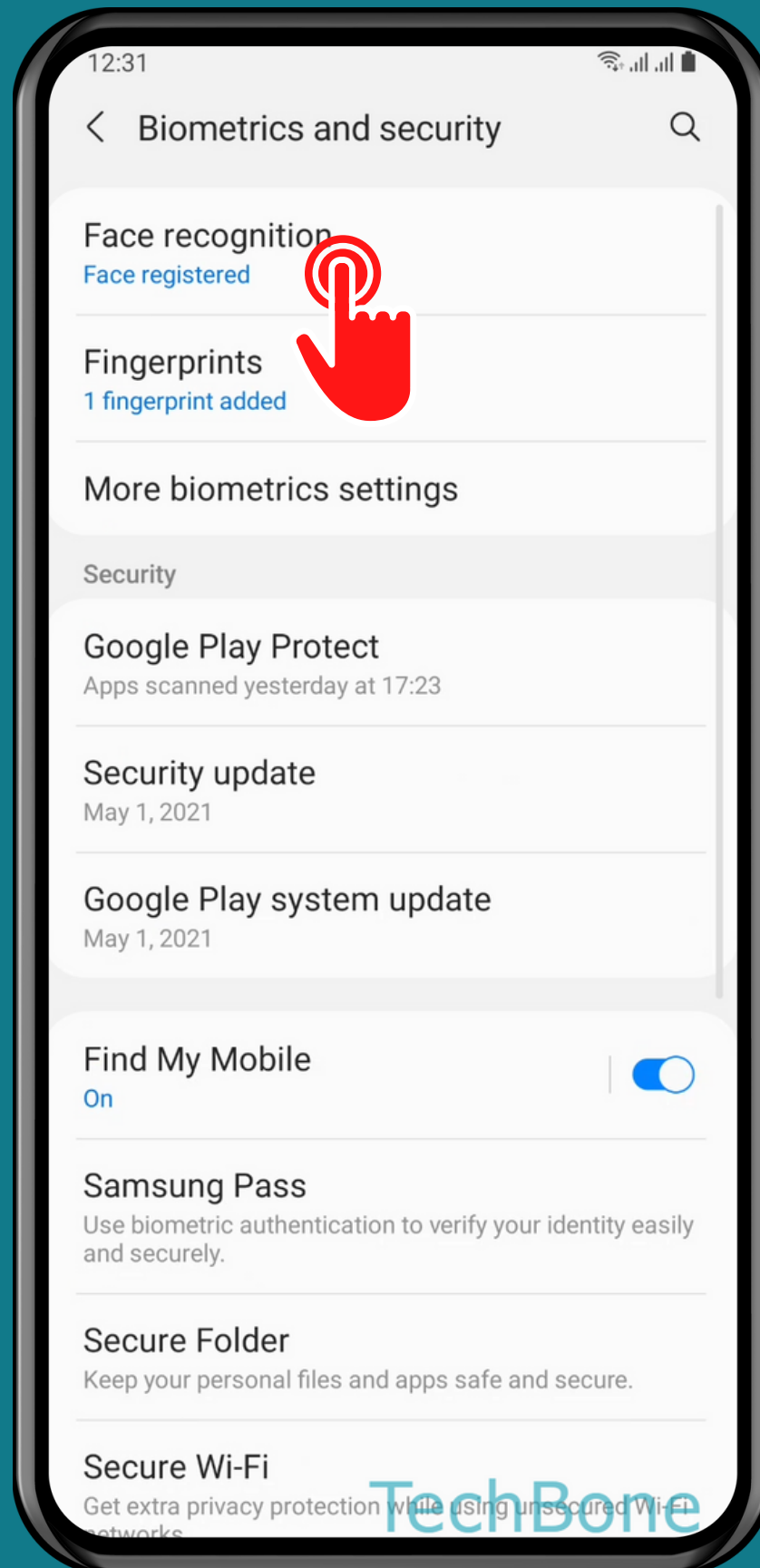

Tap on Face recognition

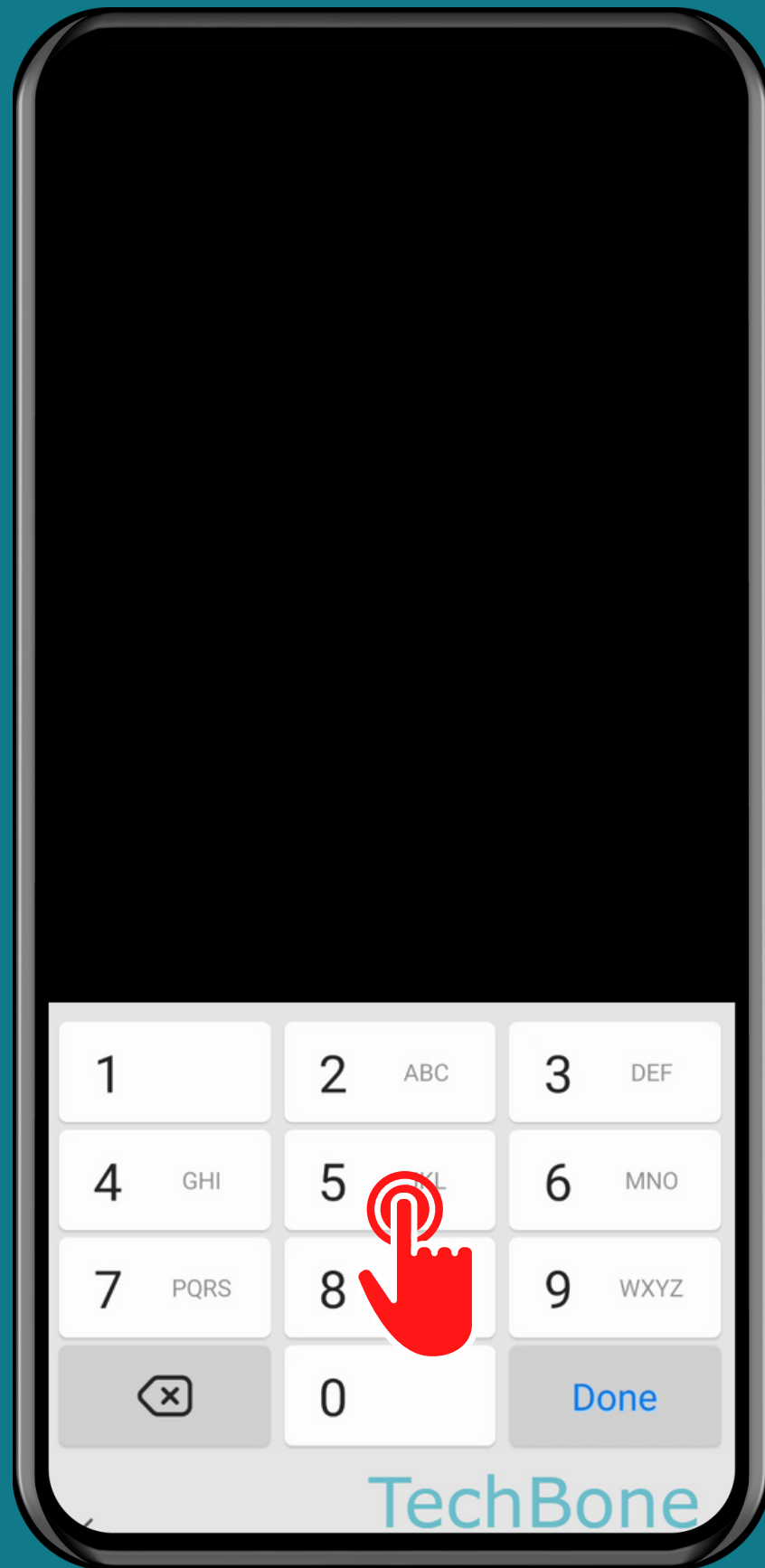

Enter the current
Pattern, PIN or
Password

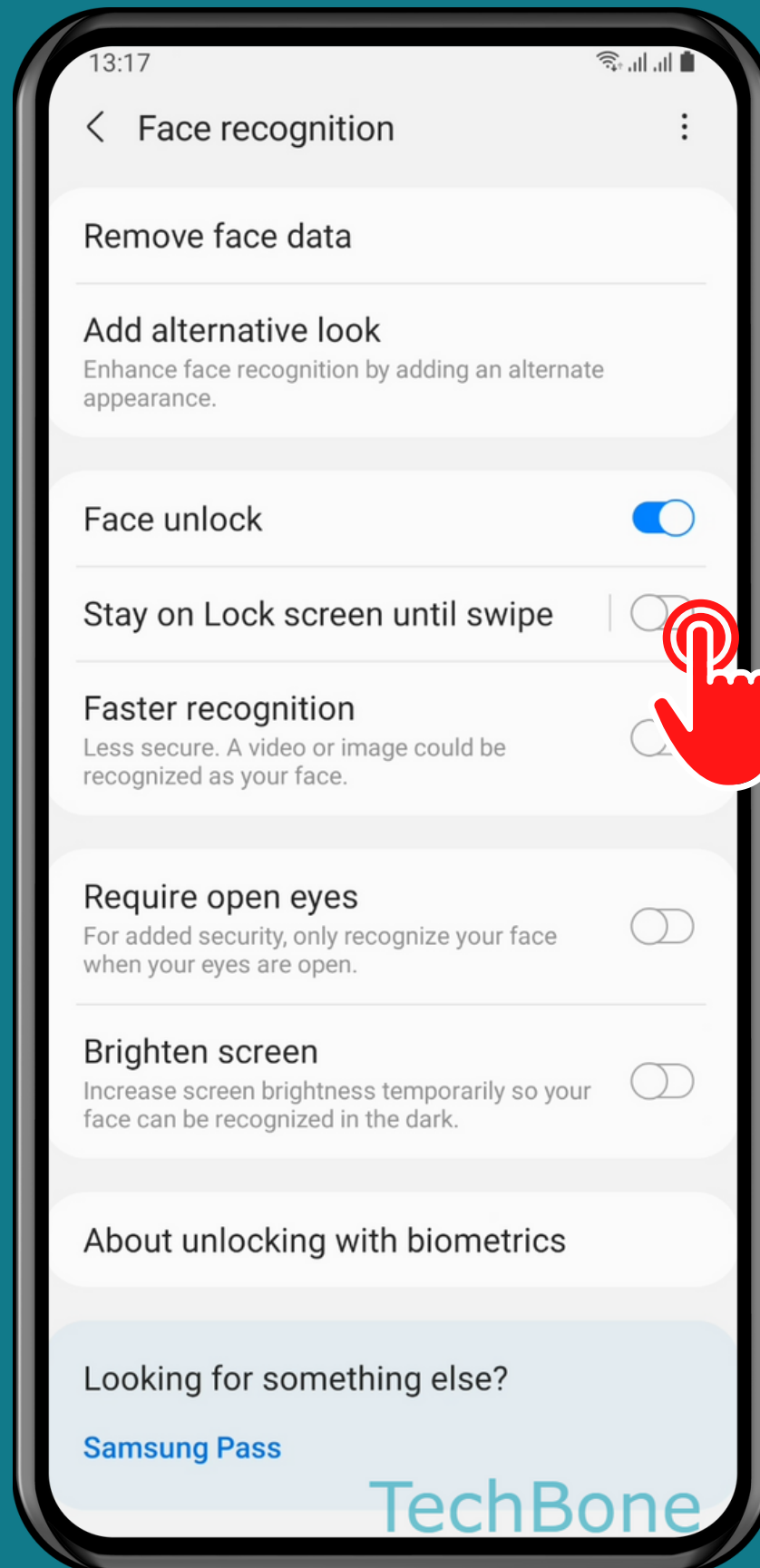

Turn On/Off Stay on Lock screen until swipe

Done!