

XIAOMI

Android 11 - MIUI 12

HOW TO ADD A FINGERPRINT

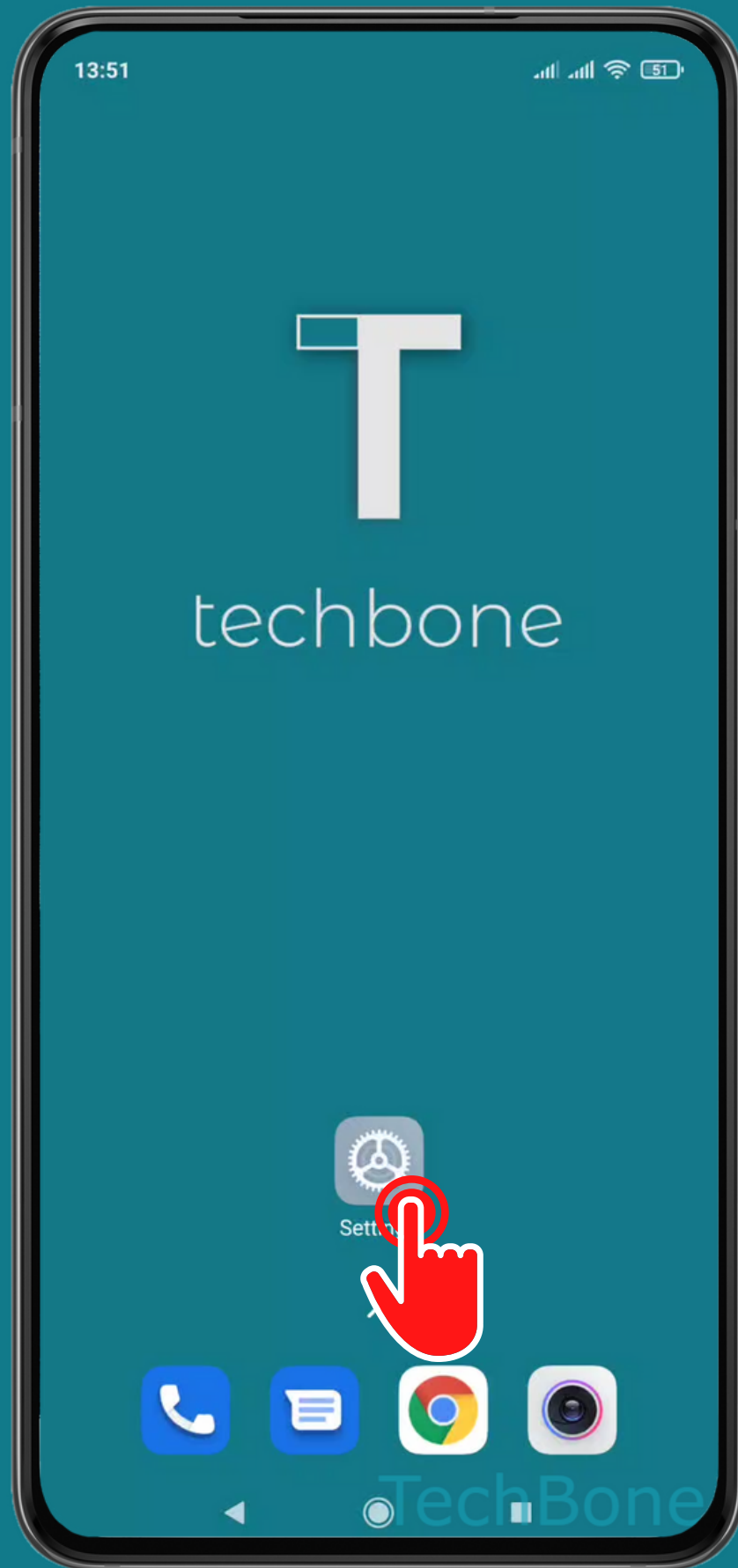

Tap on **Settings**

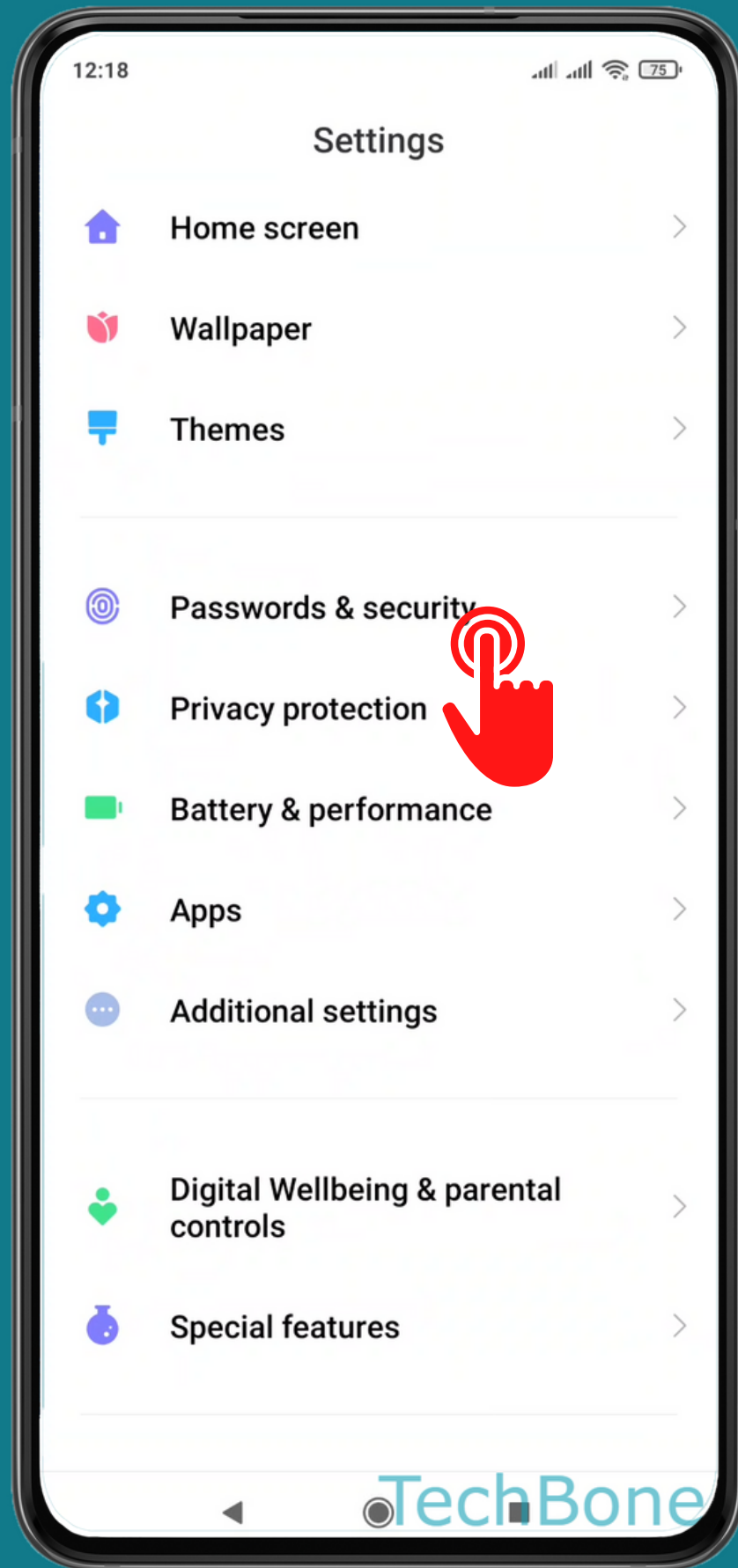

Tap on Passwords & security

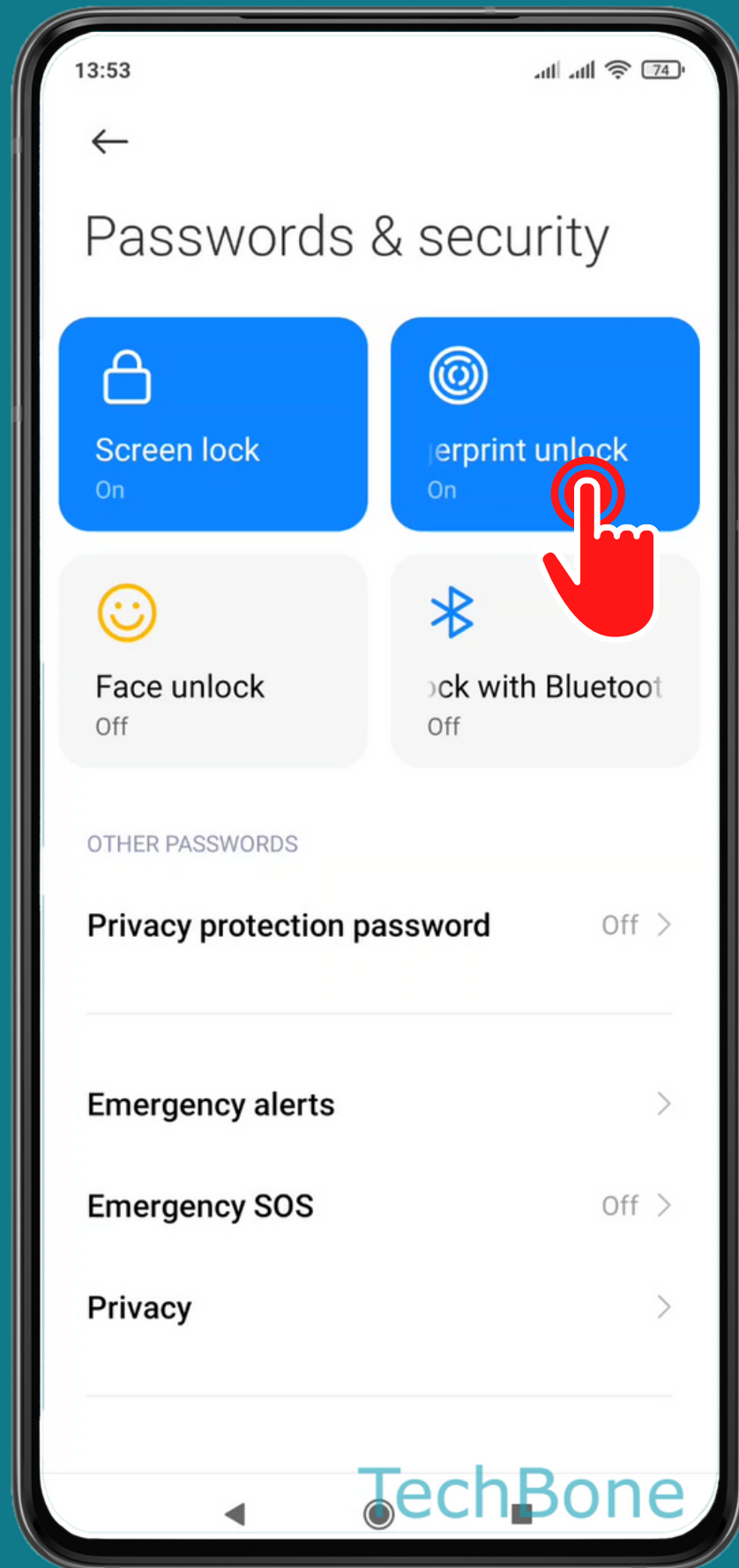

Tap on
Fingerprint unlock

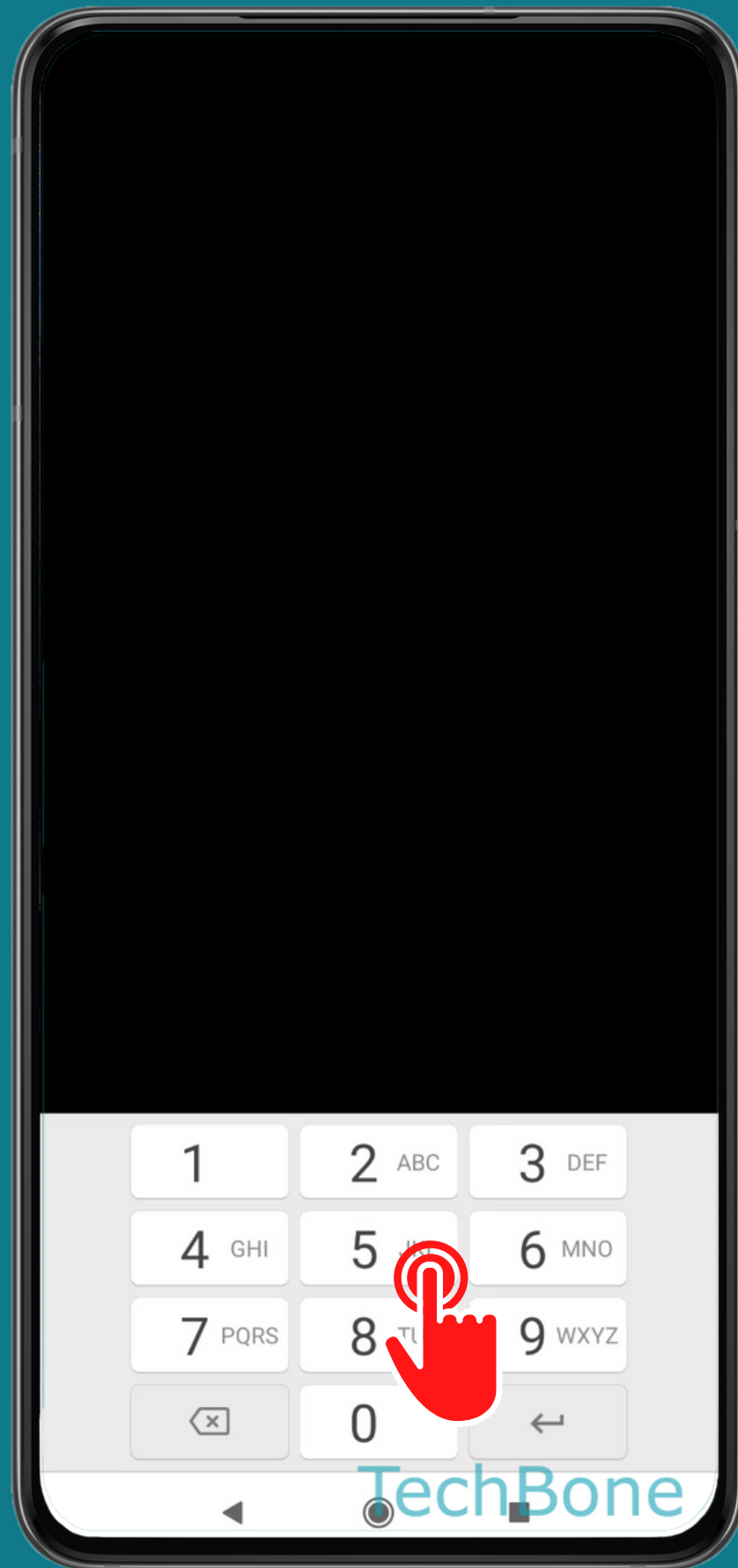

Enter the current
Pattern, PIN or
Password

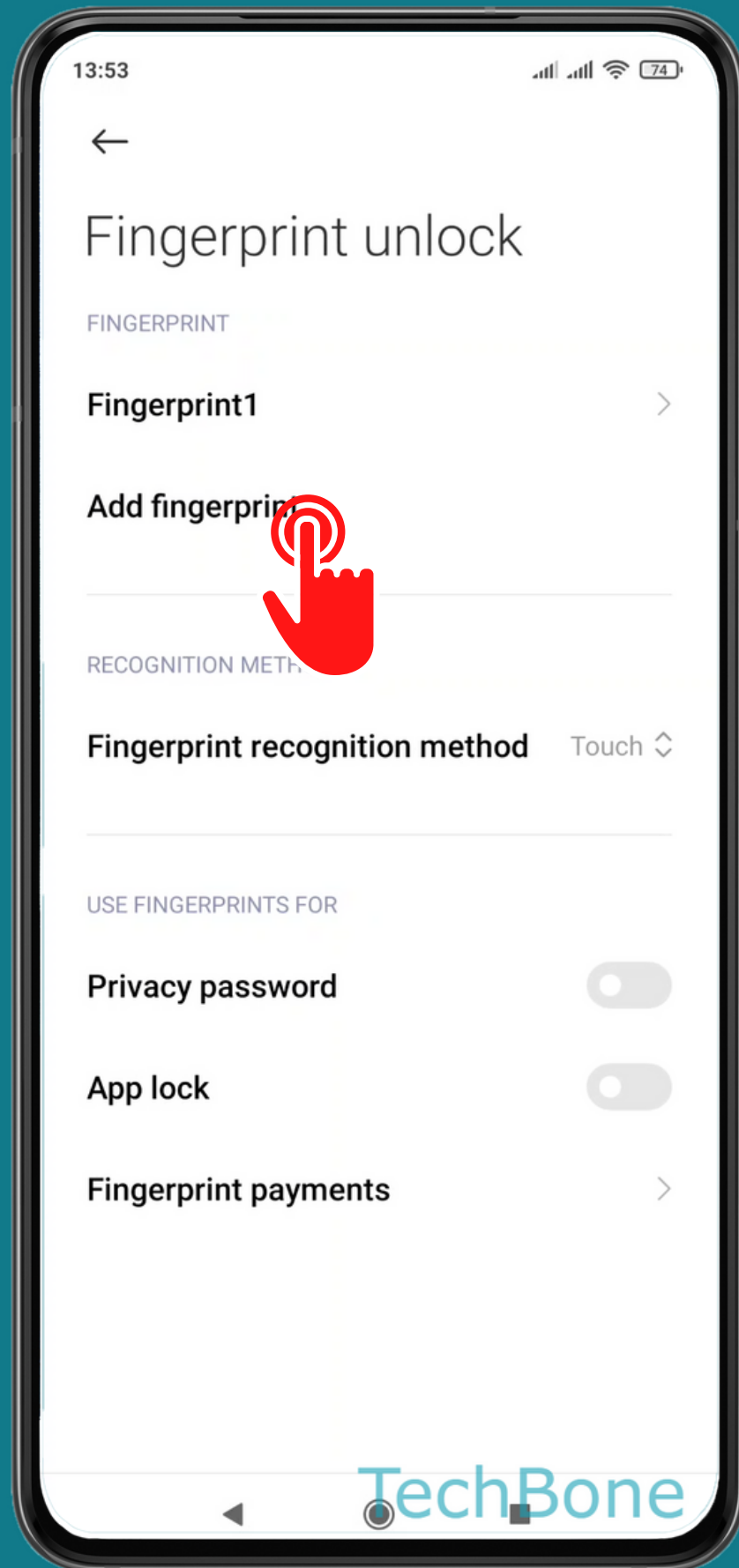

Tap on
Add fingerprint

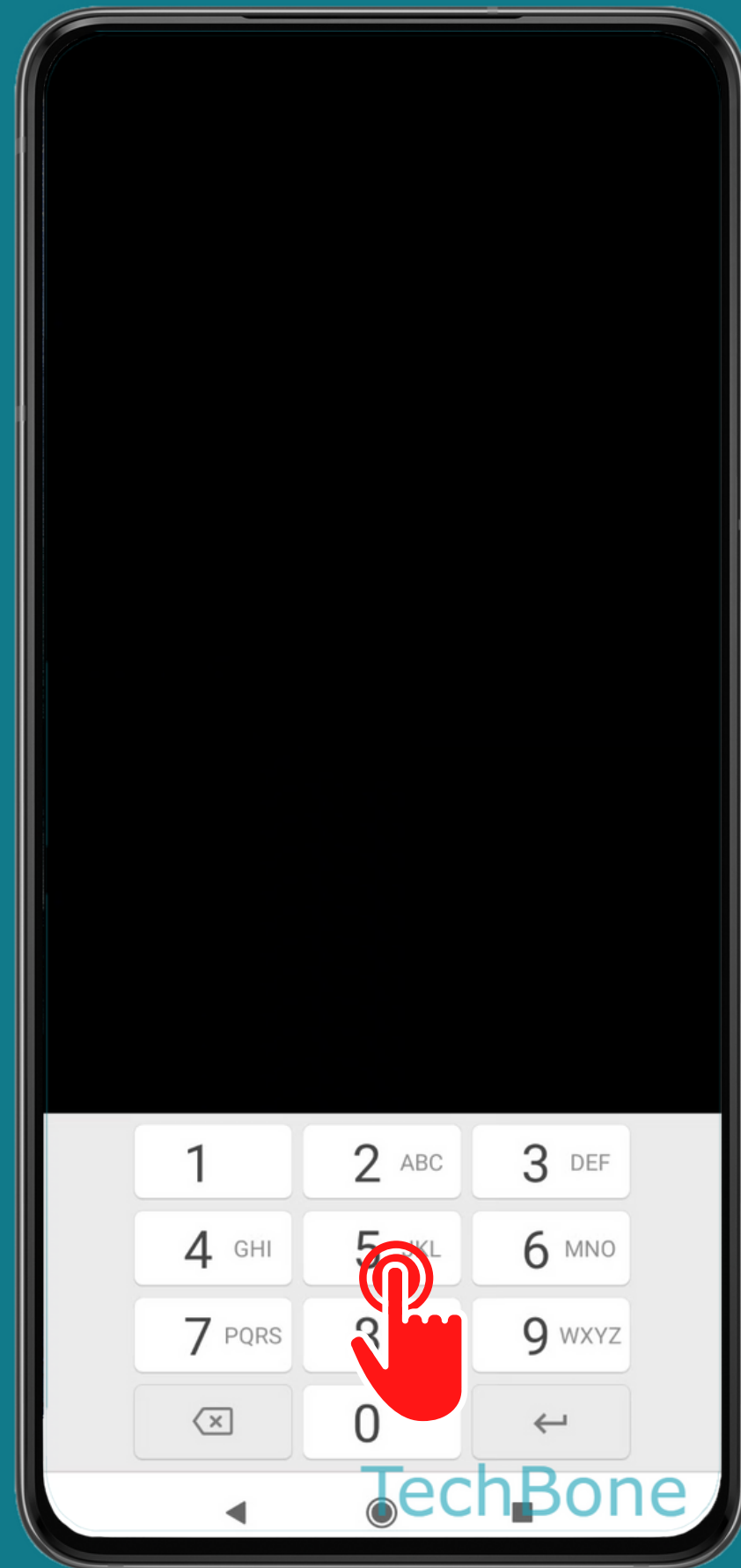

Enter the **Pattern,**
PIN or **Password**
again

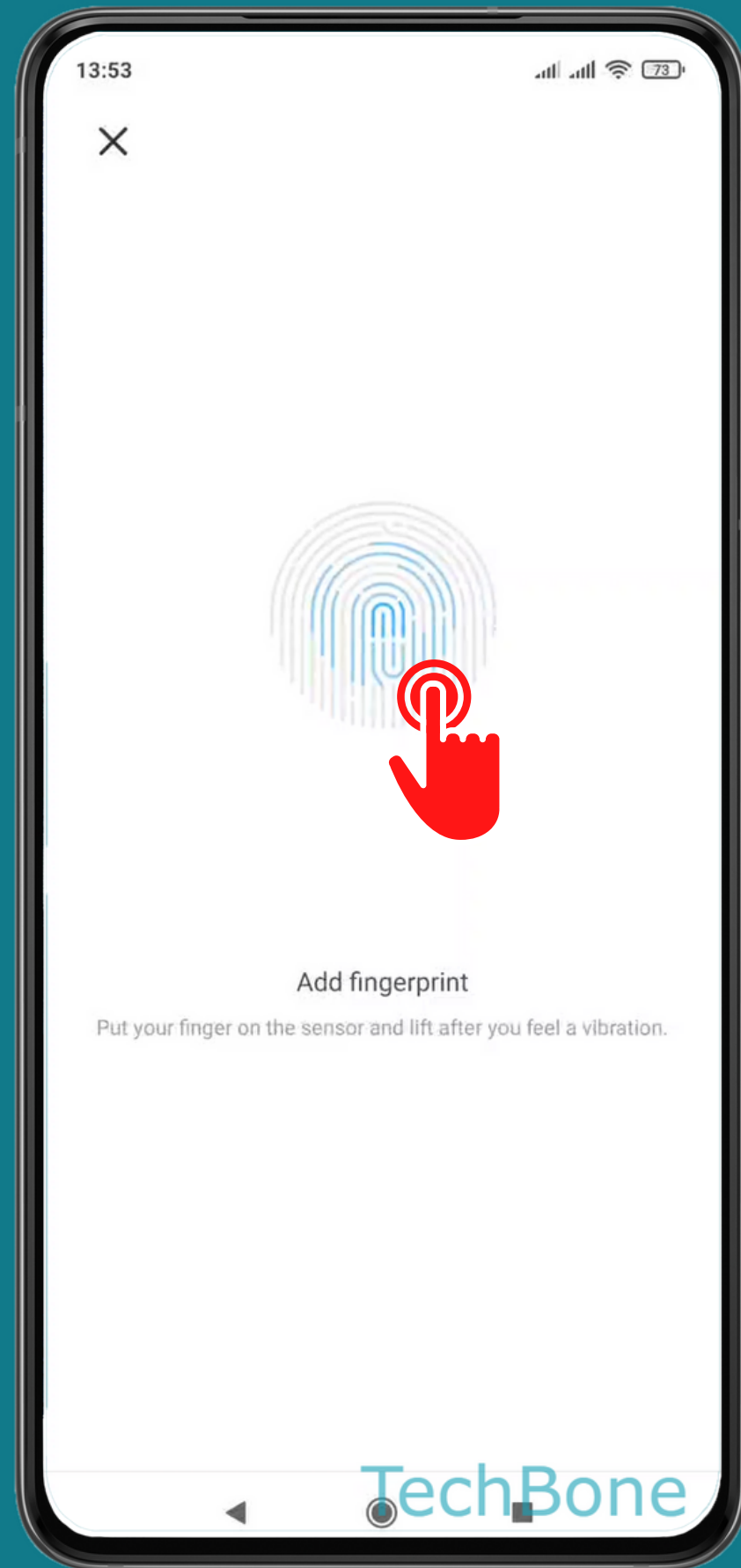

Place the **finger** on the **fingerprint sensor** and follow the instructions

Done!