

XIAOMI

Android 11 - MIUI 12

HOW TO TURN ON/OFF AUTOMATIC BACKUP



Tap on **Settings**

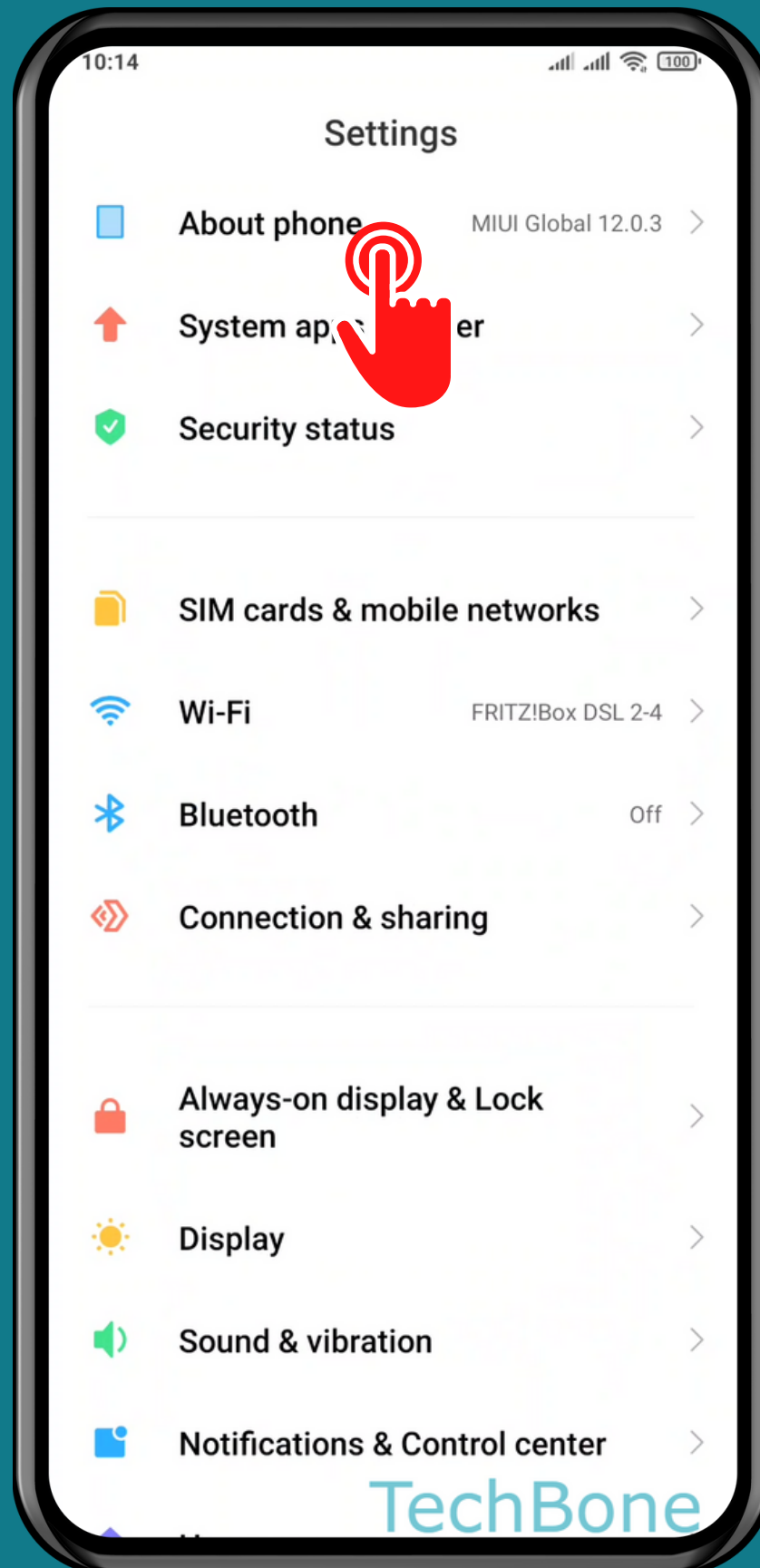

Tap on
About phone

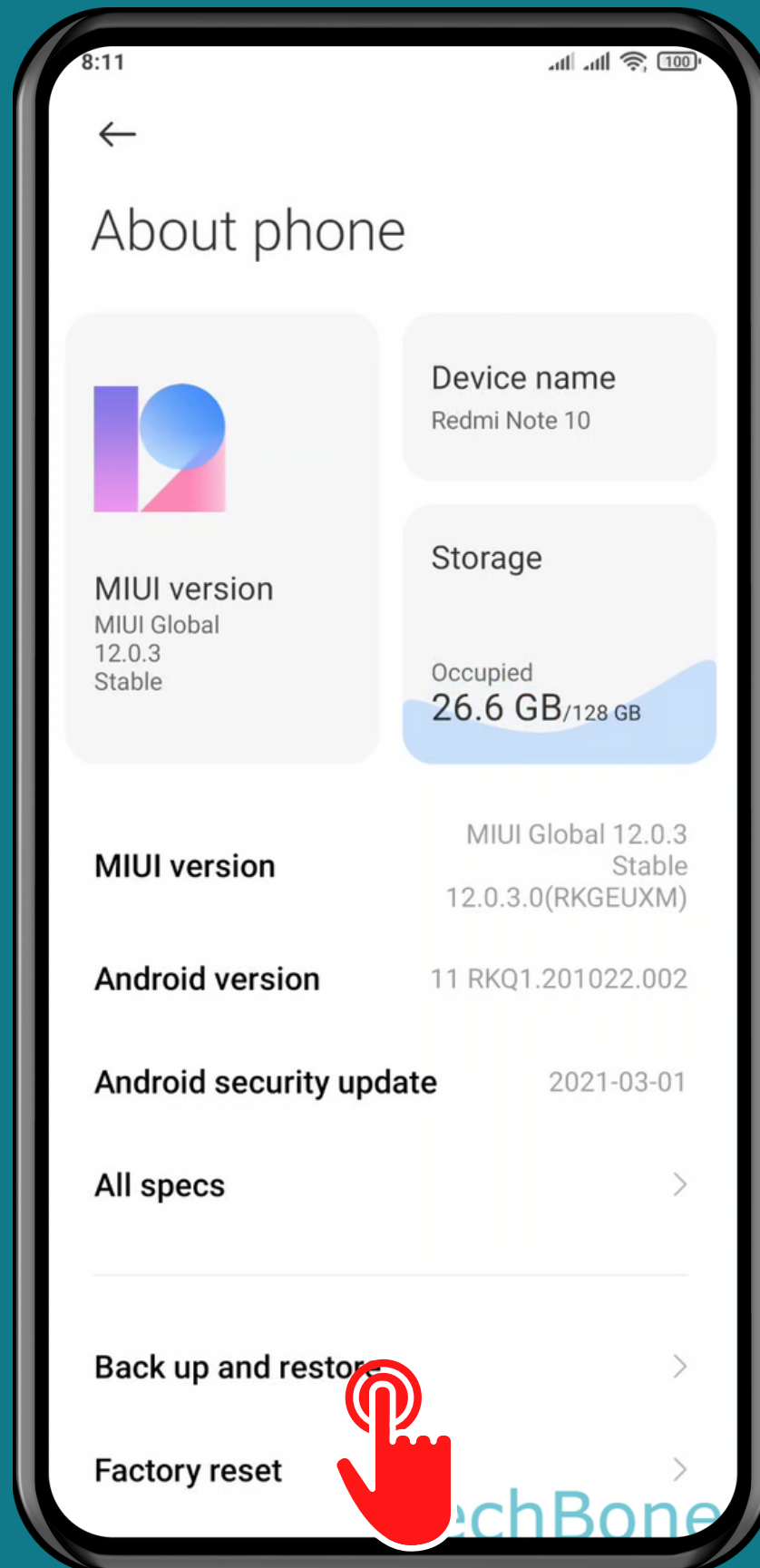

Tap on
Back up and restore

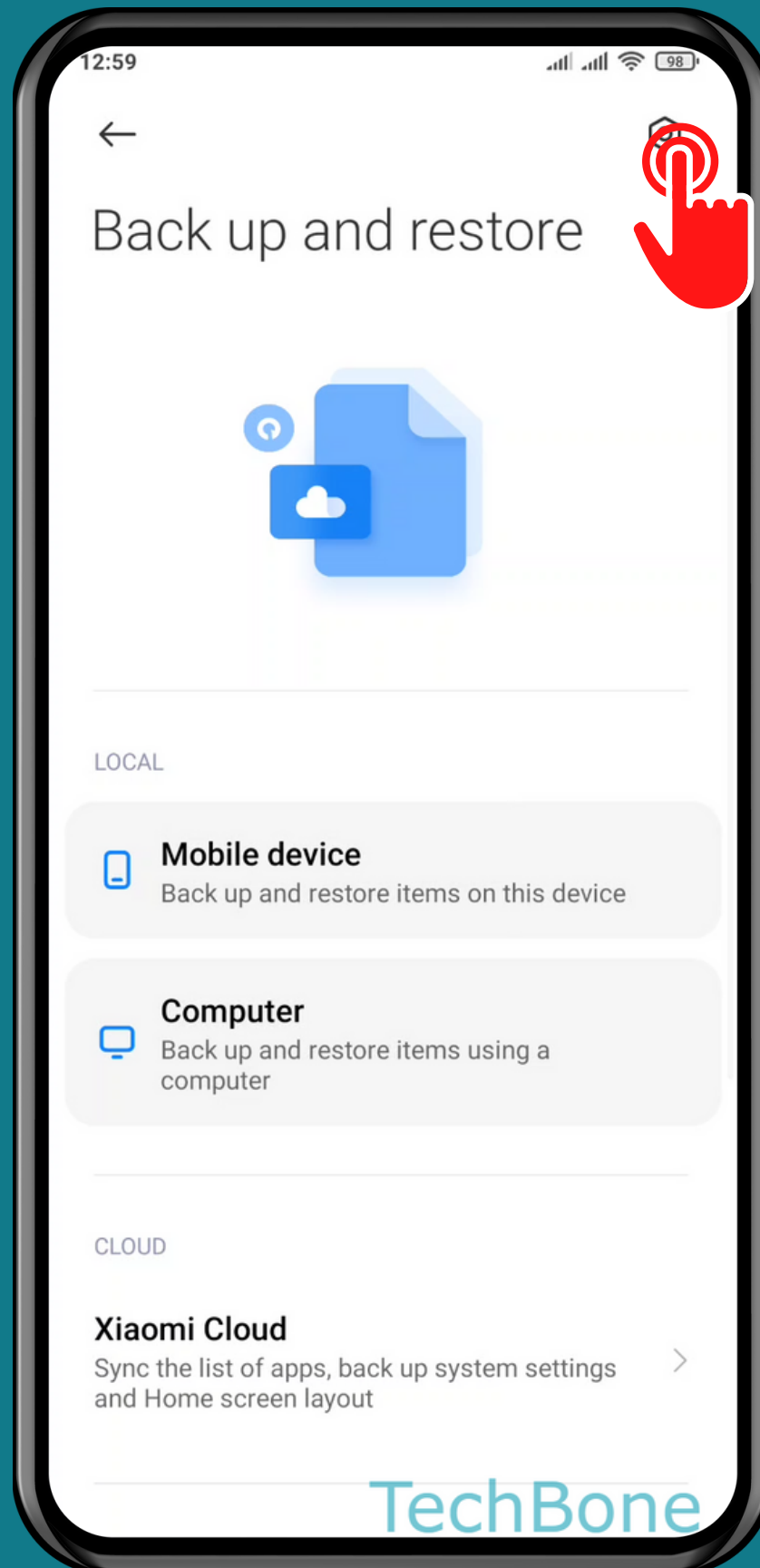

Tap on **Settings**

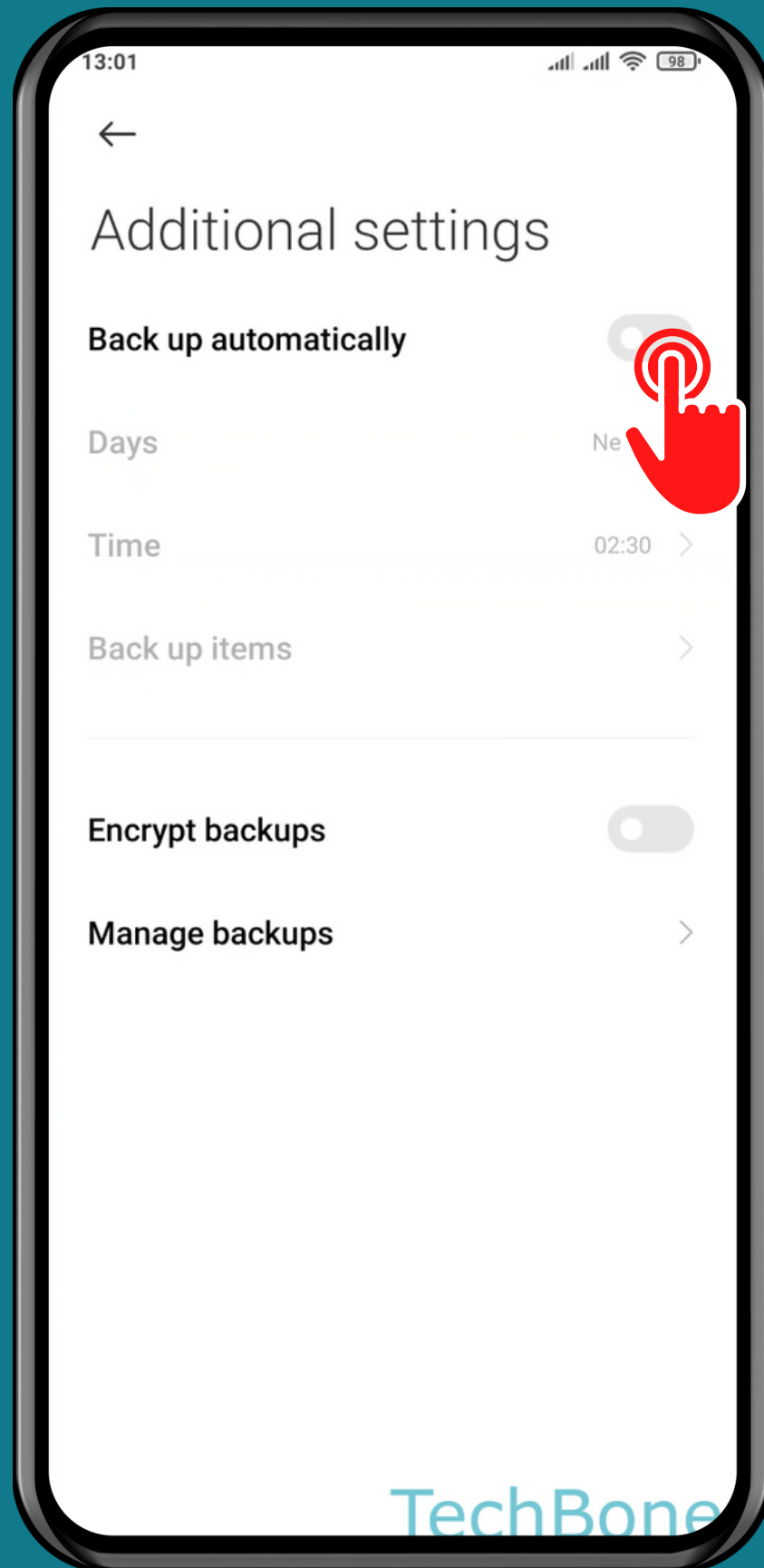

Turn On/Off

Back up automatically

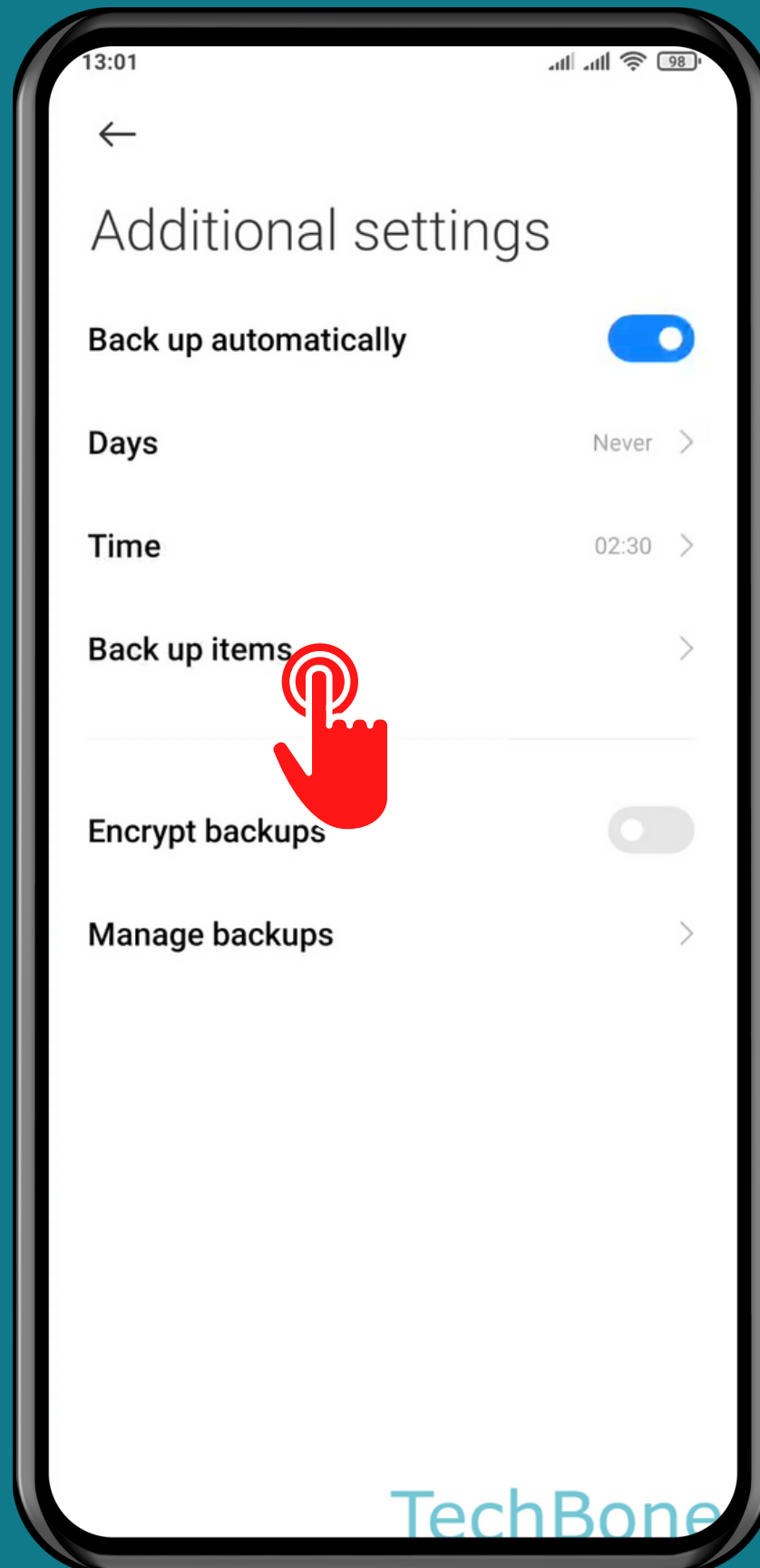

Set the **Days**, **Time**
and **Back up items**

Done!