

XIAOMI

Android 11 - MIUI 12

HOW TO CHANGE SIM PIN

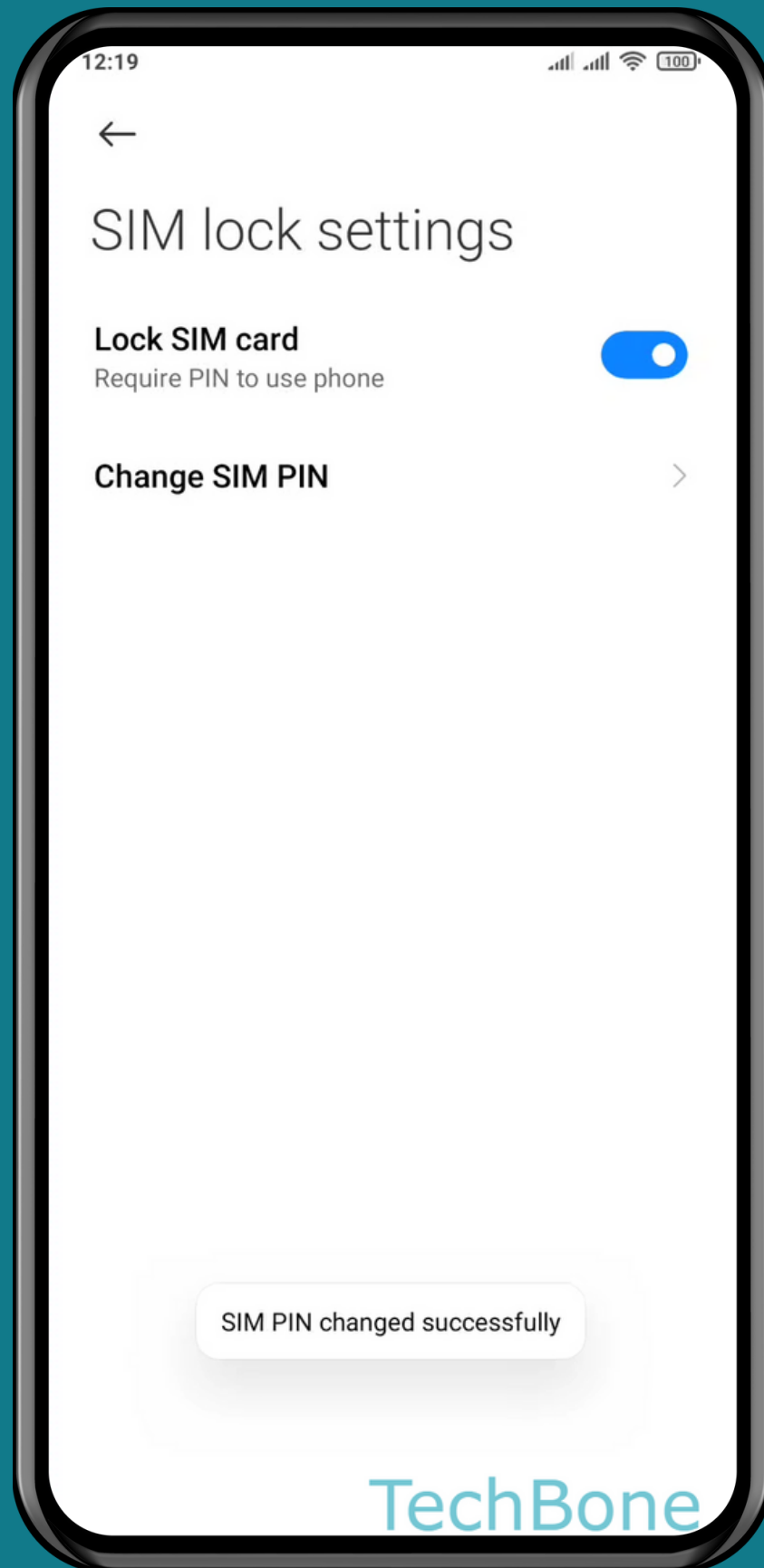



Tap on **Settings**

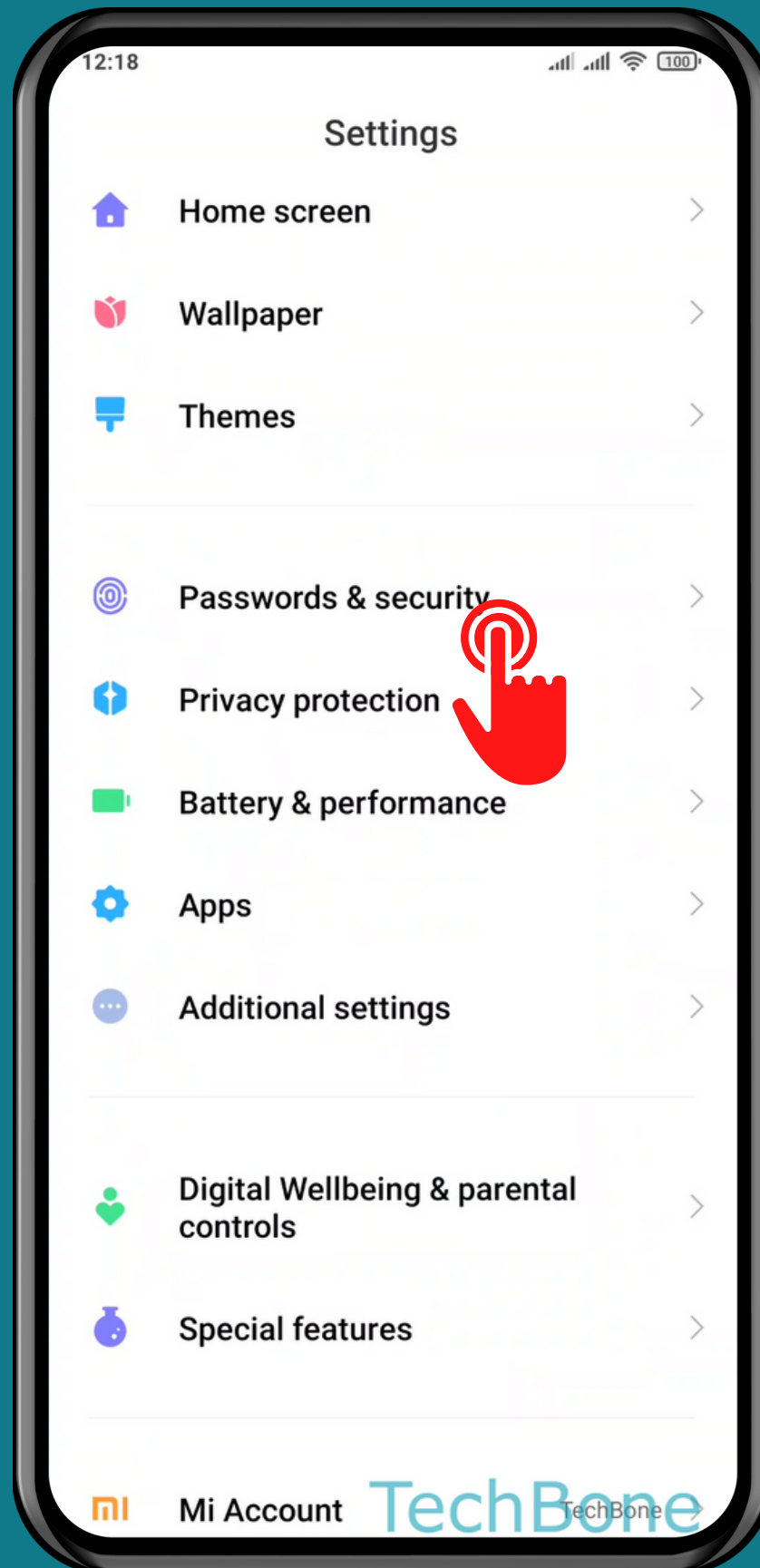

Tap on Passwords & security

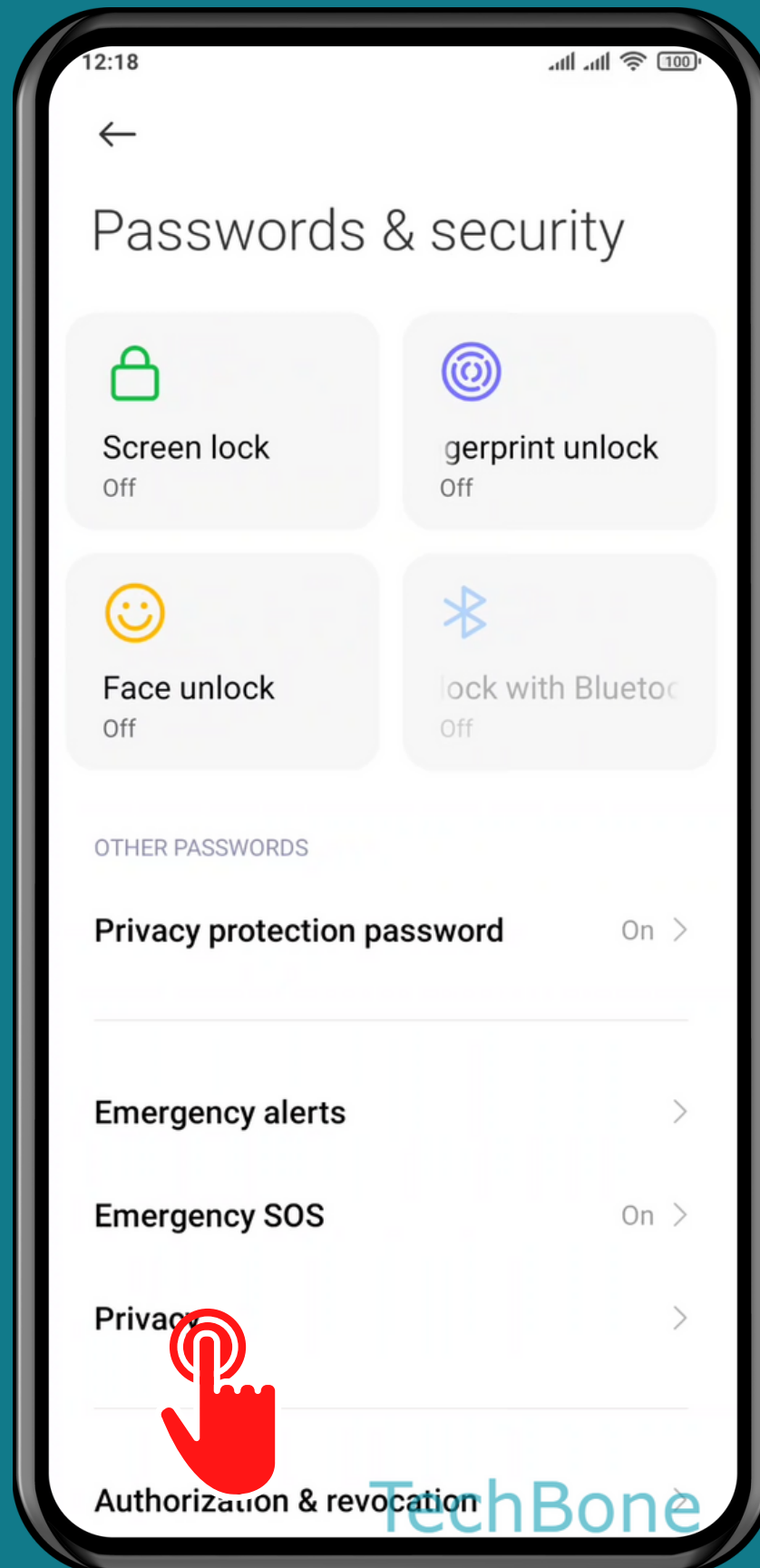

Tap on Privacy

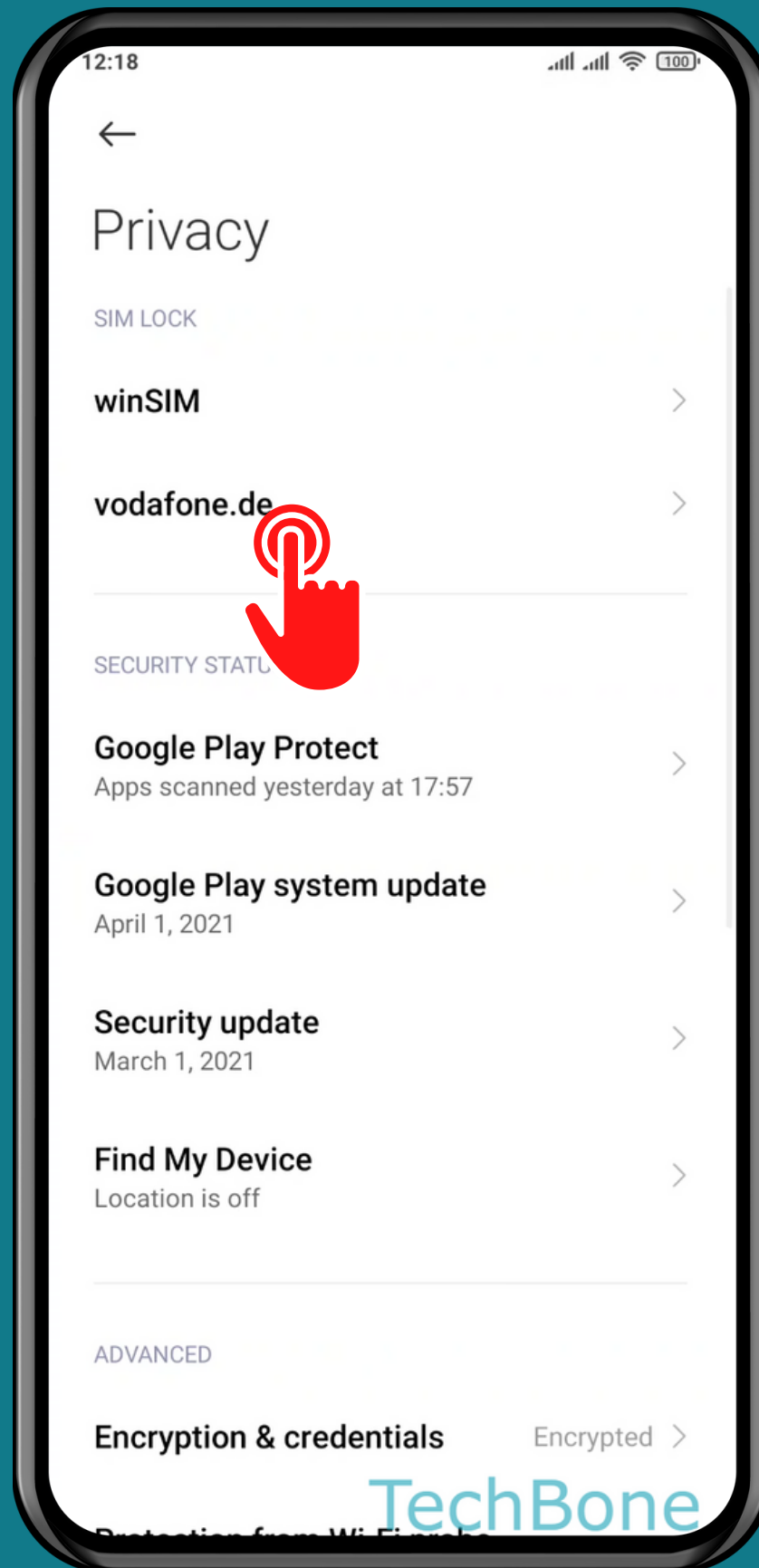

Choose a SIM card

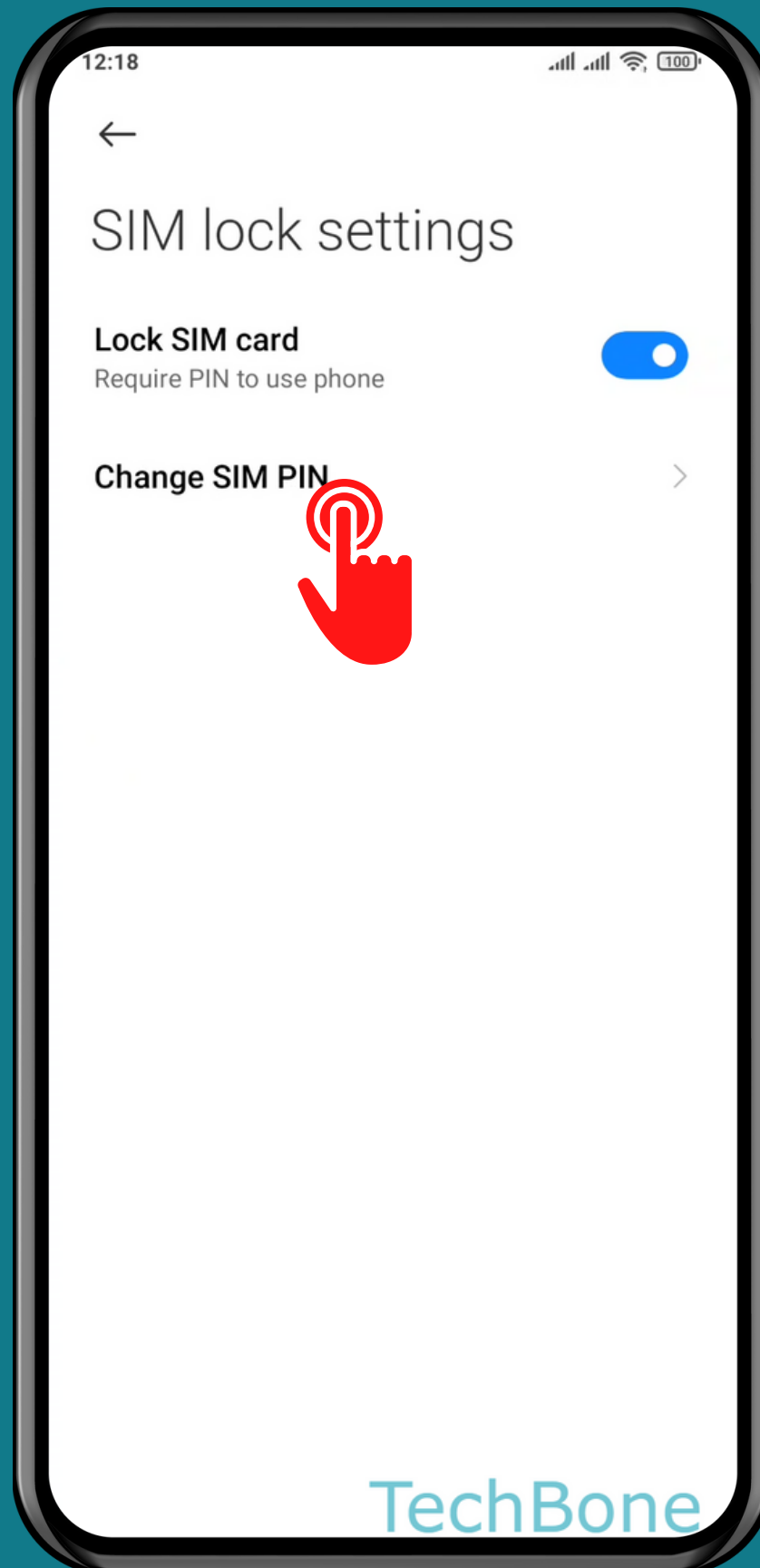

Tap on
Change SIM PIN

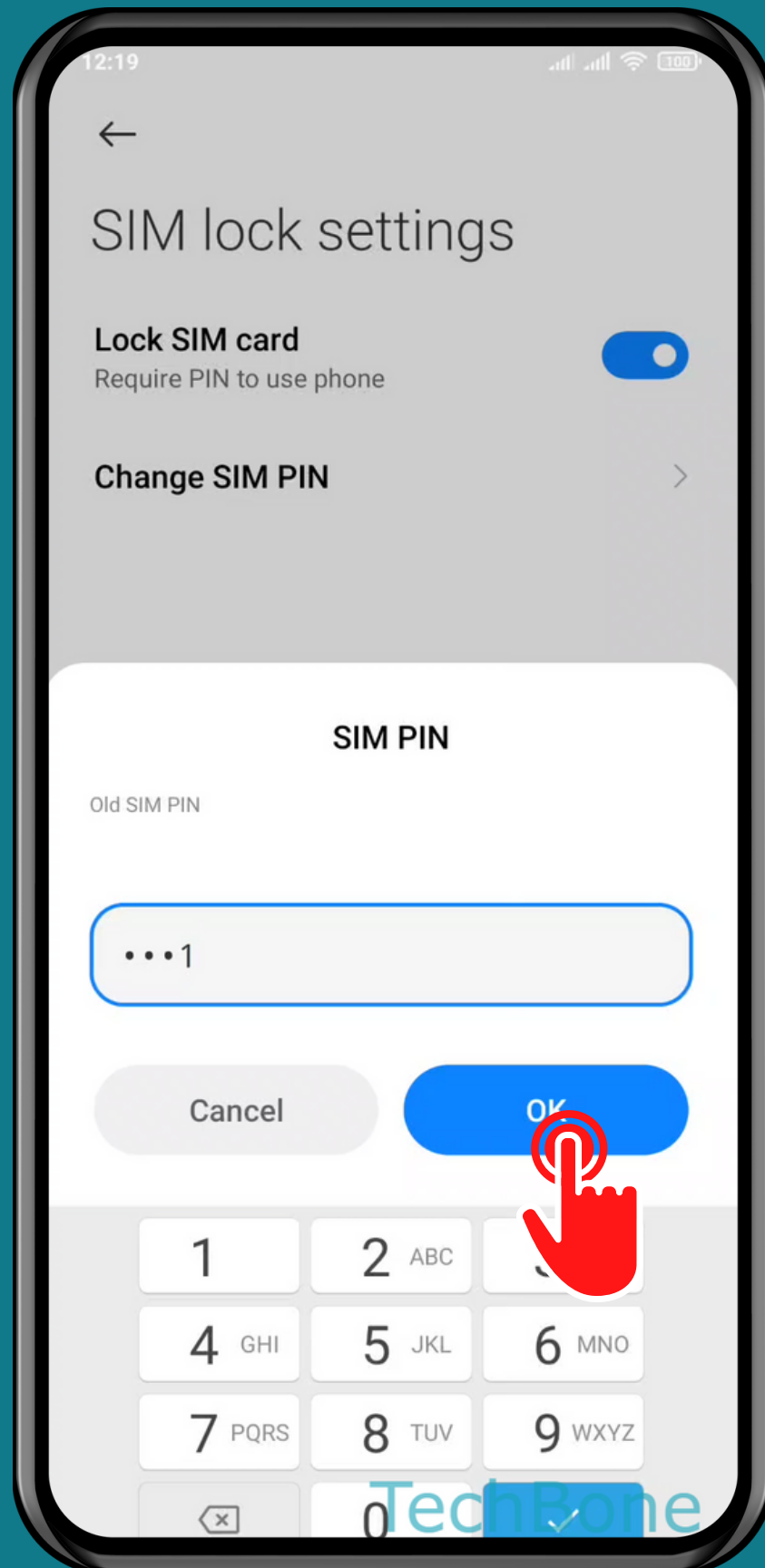

Enter the **current PIN**
and tap **OK**

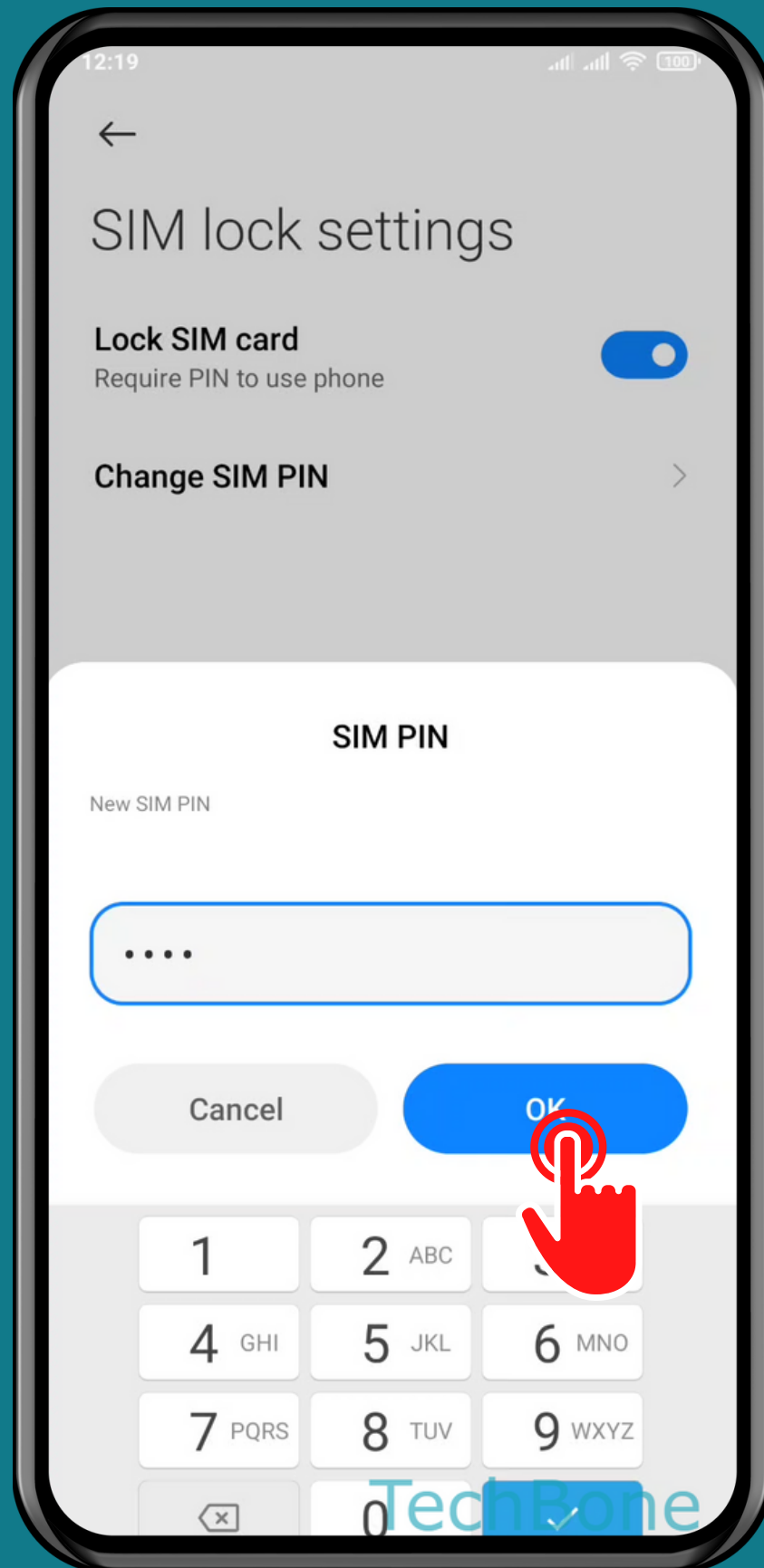

Enter the **new PIN**
and tap **OK**

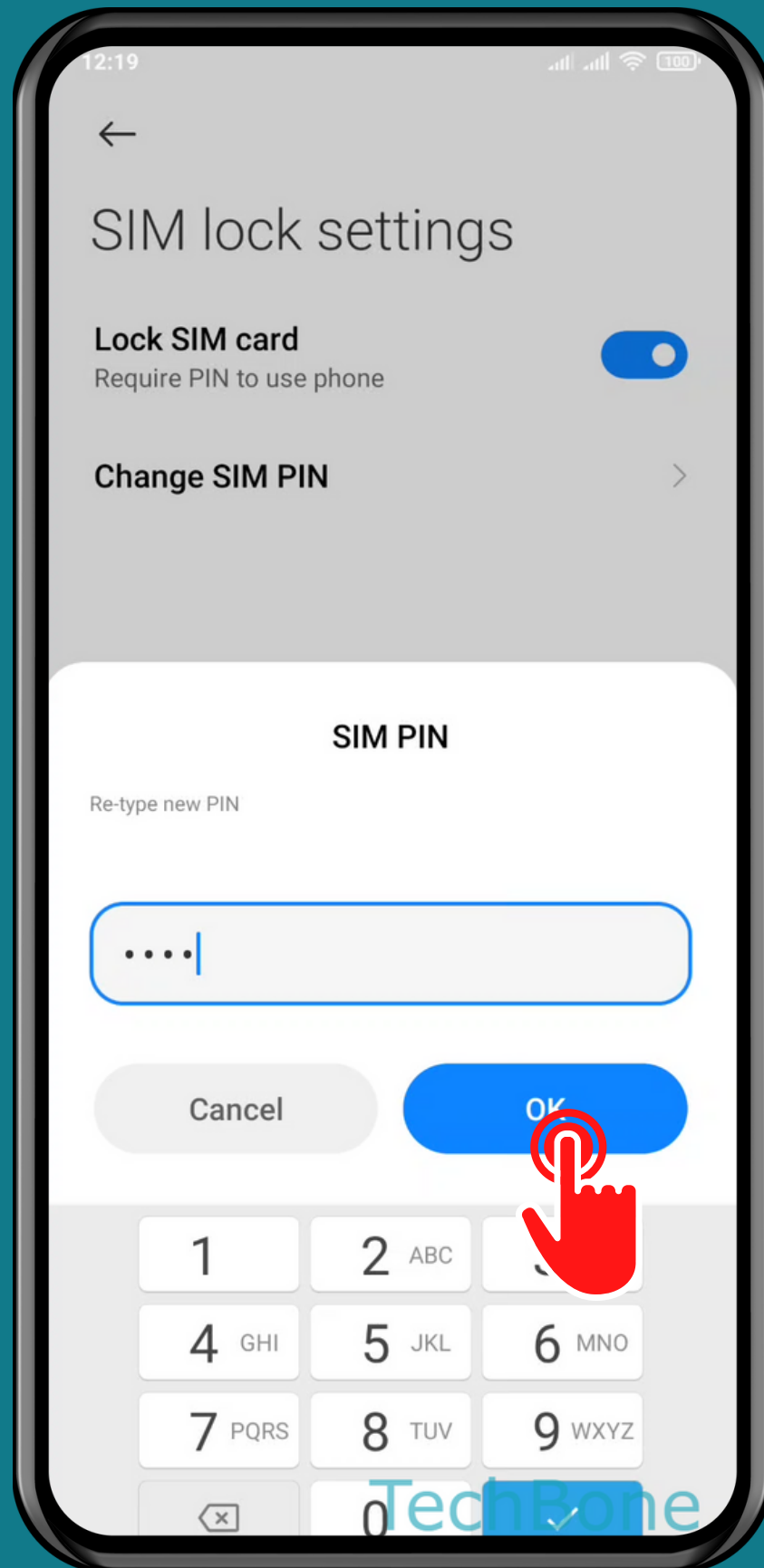

Enter the **new PIN**
again and tap **OK**

Done!