

XIAOMI

Android 11 - MIUI 12

HOW TO SET UP SWITCH ACCESS

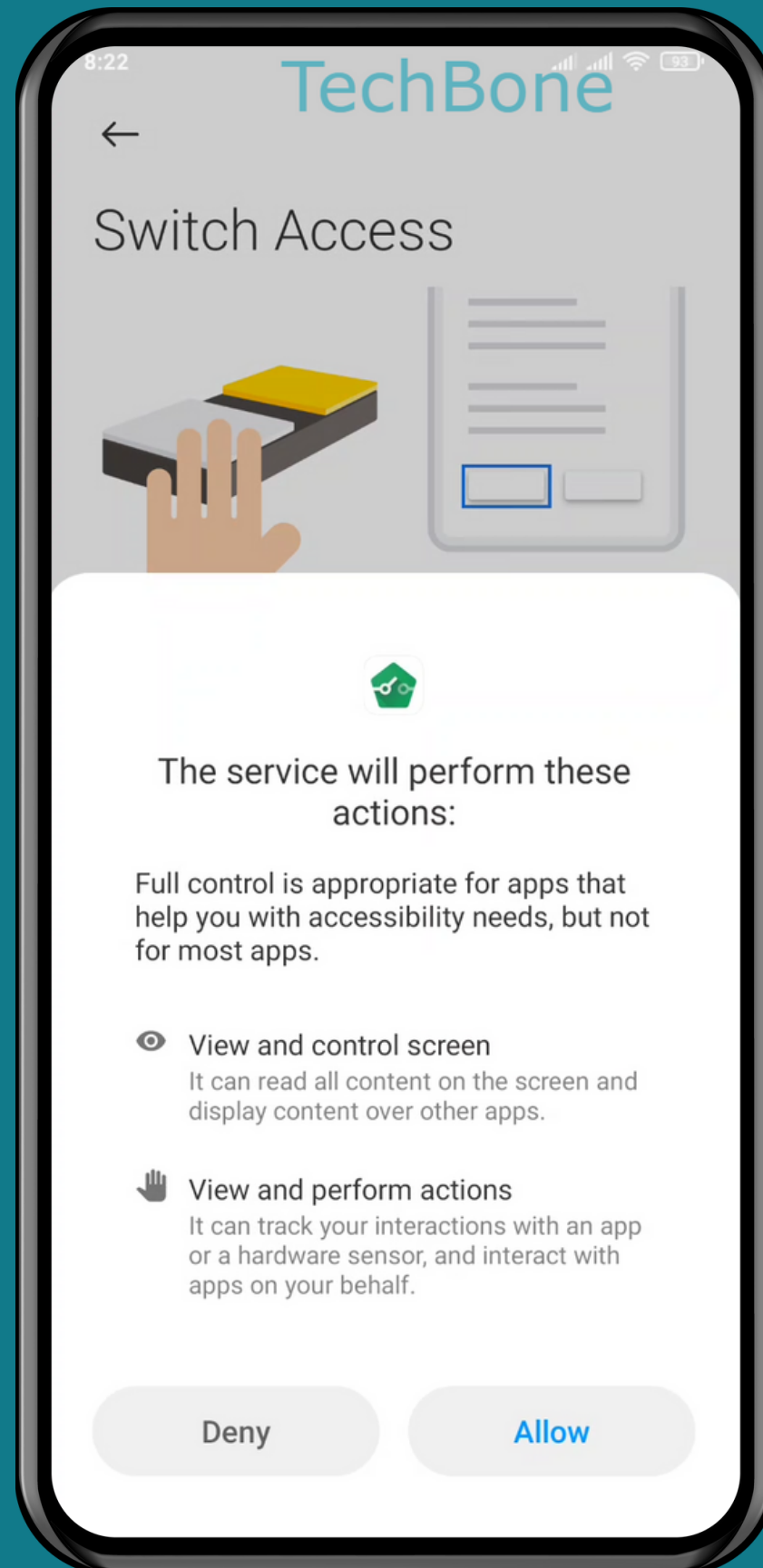



Tap on **Settings**



Tap on Additional settings

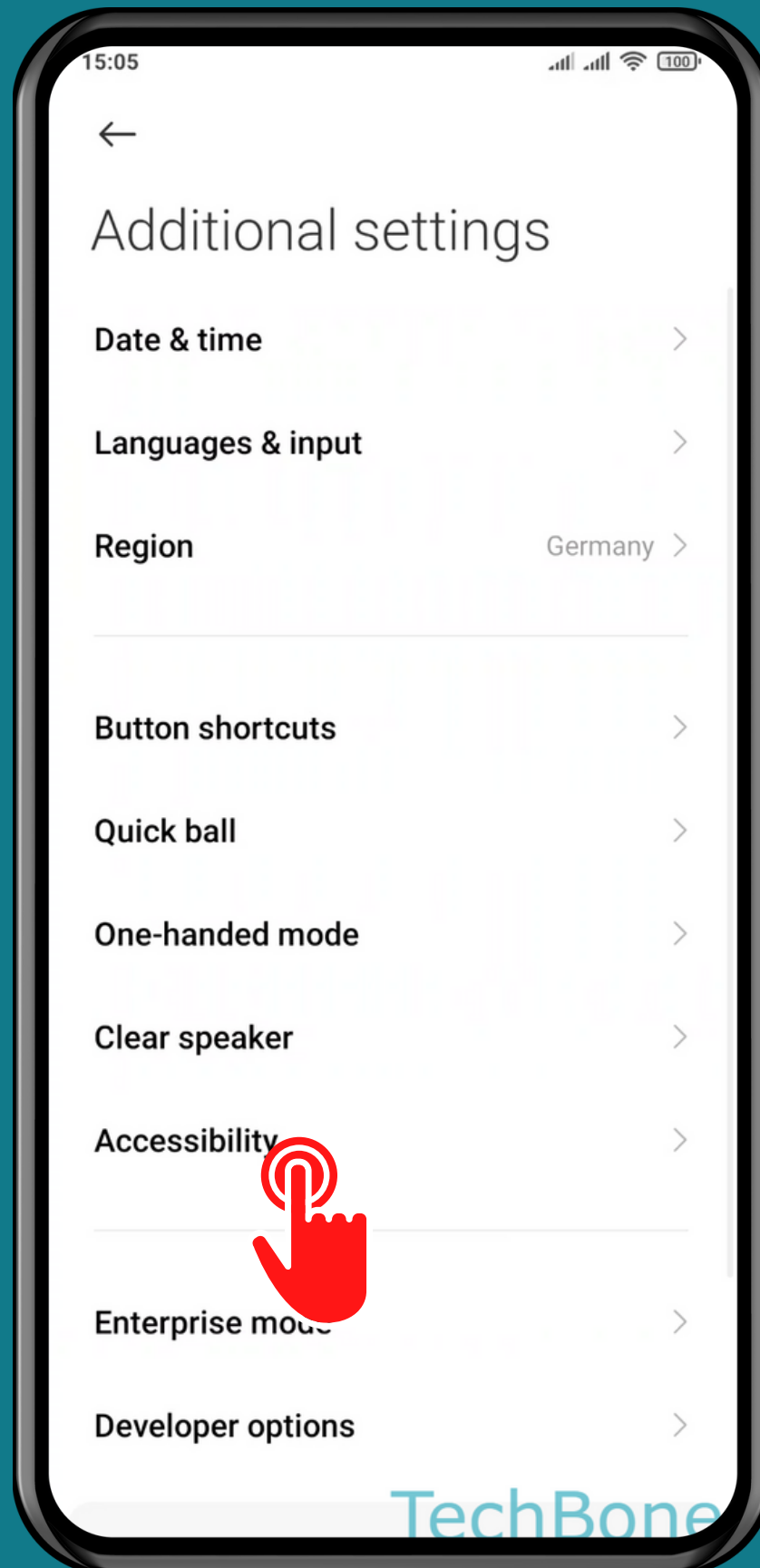

Tap on Accessibility

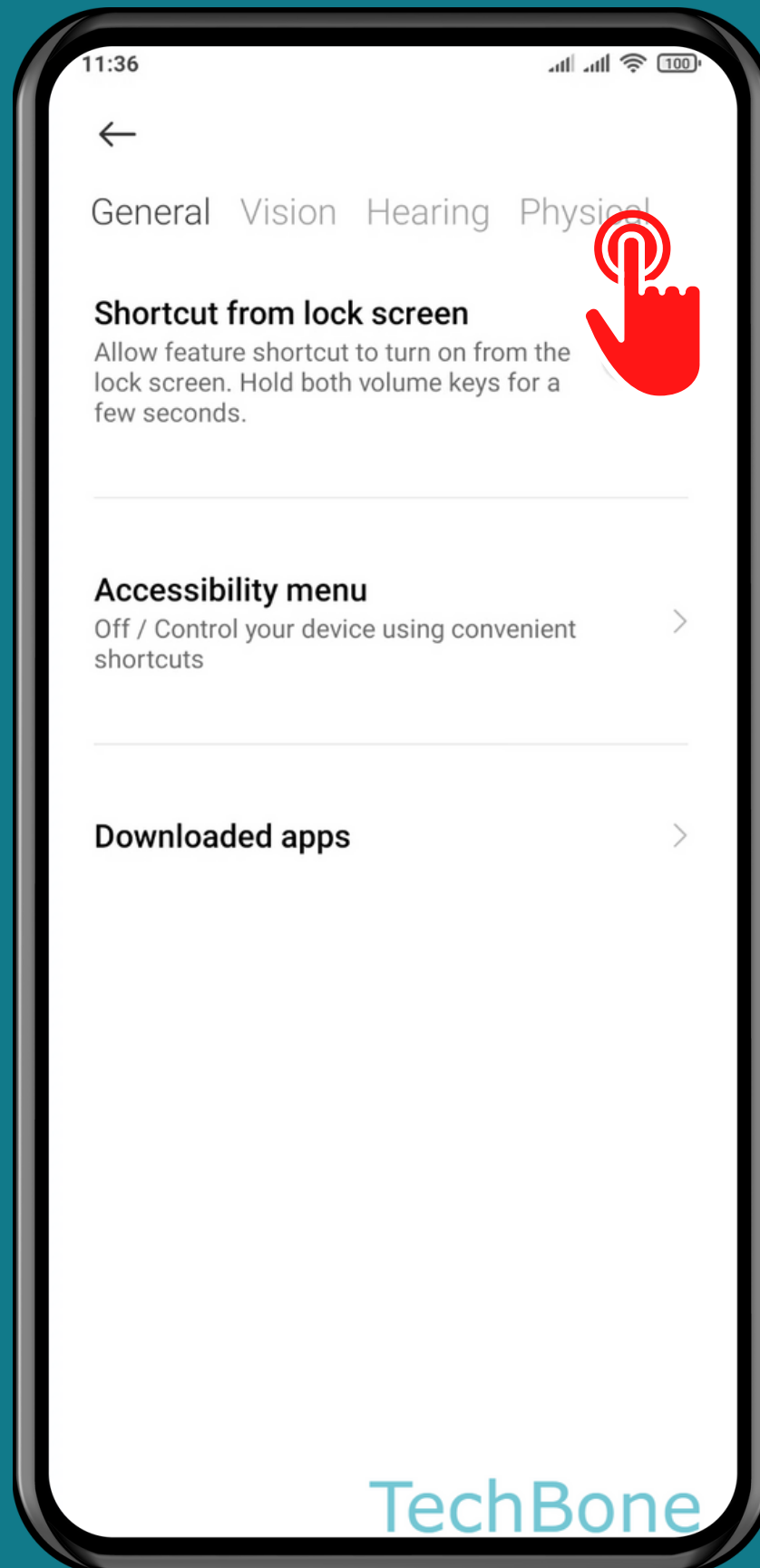

Tap on **Physical**

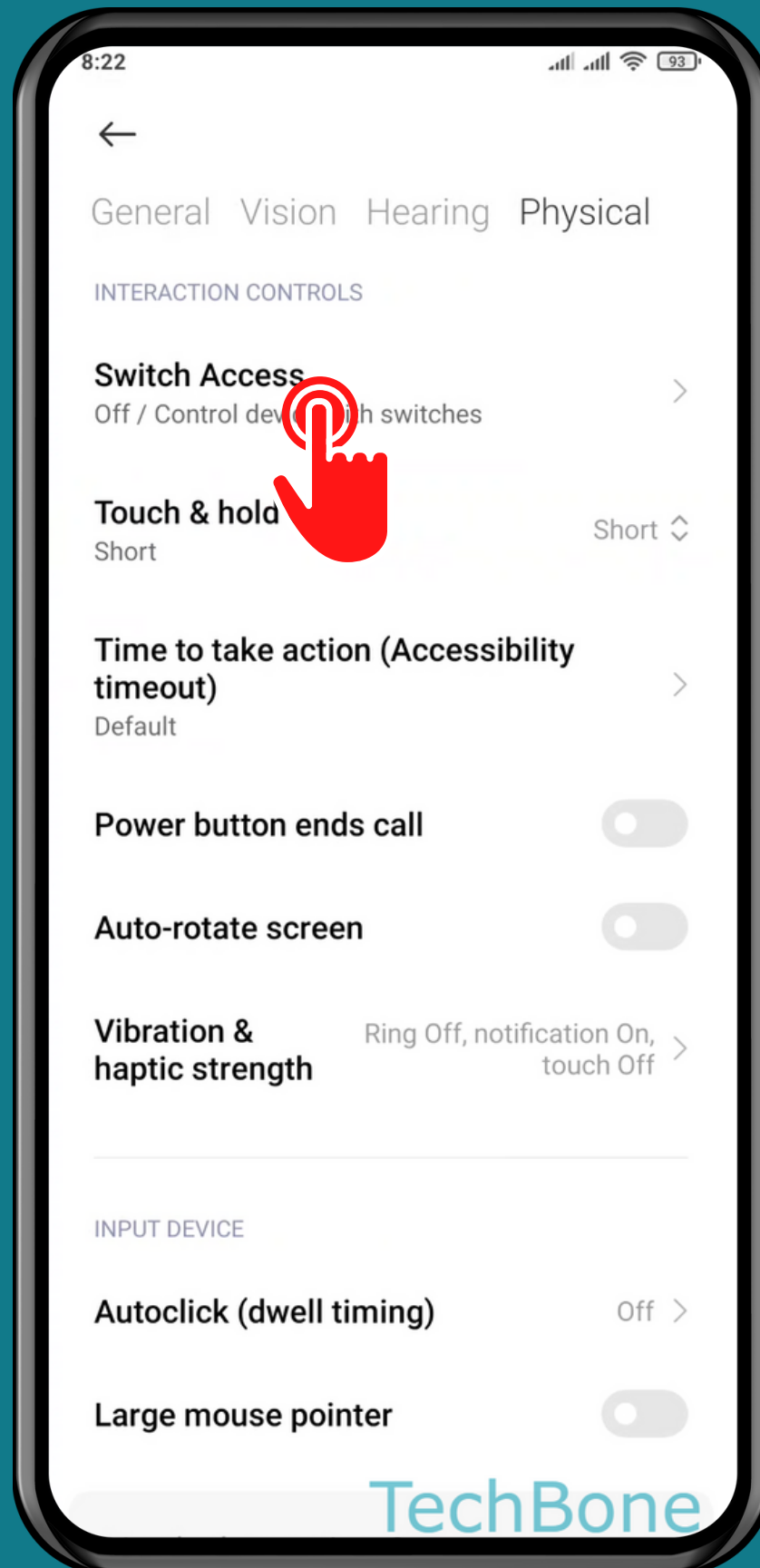

Tap on Switch Access

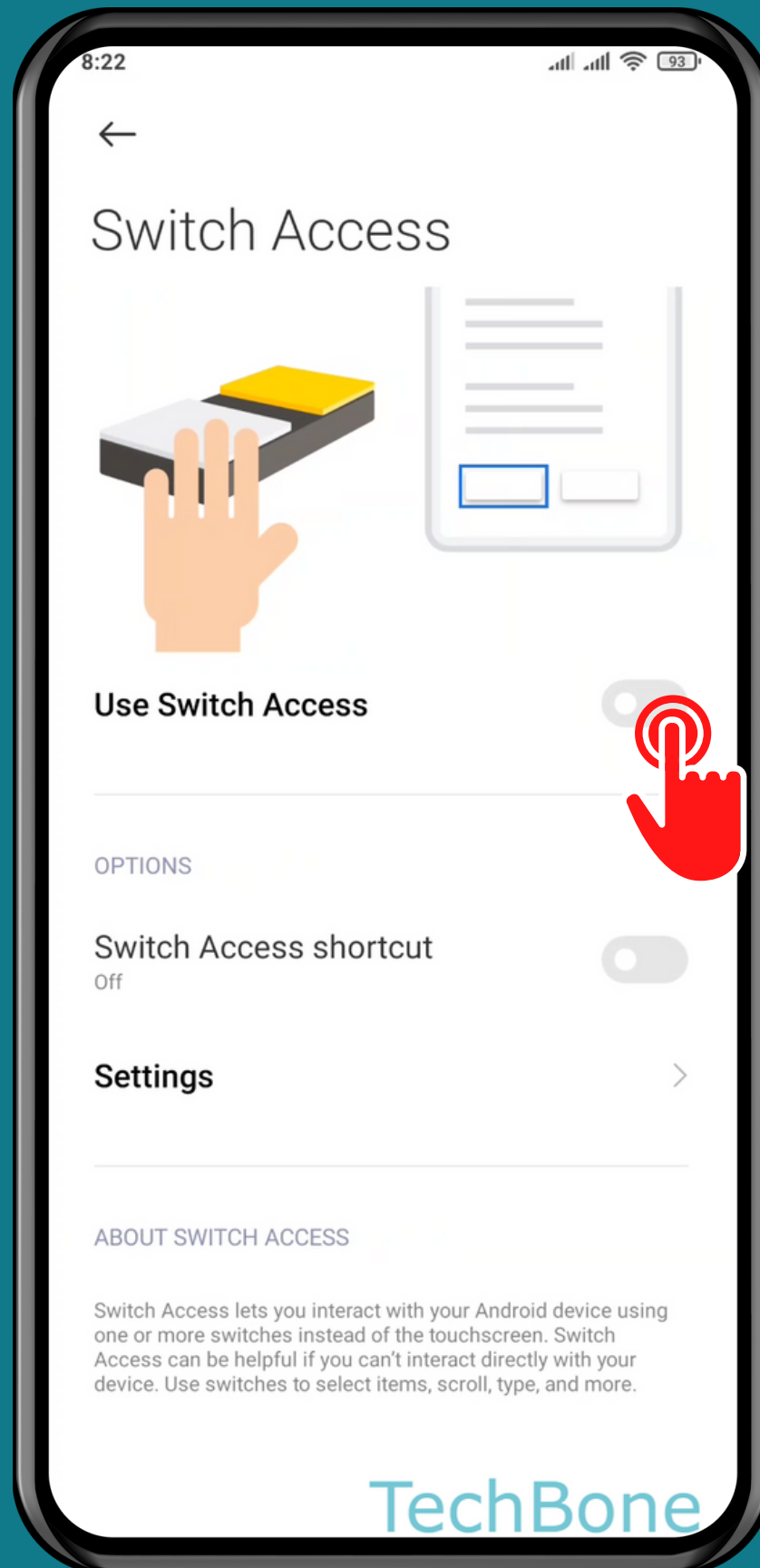

Turn On/Off Use Switch Access

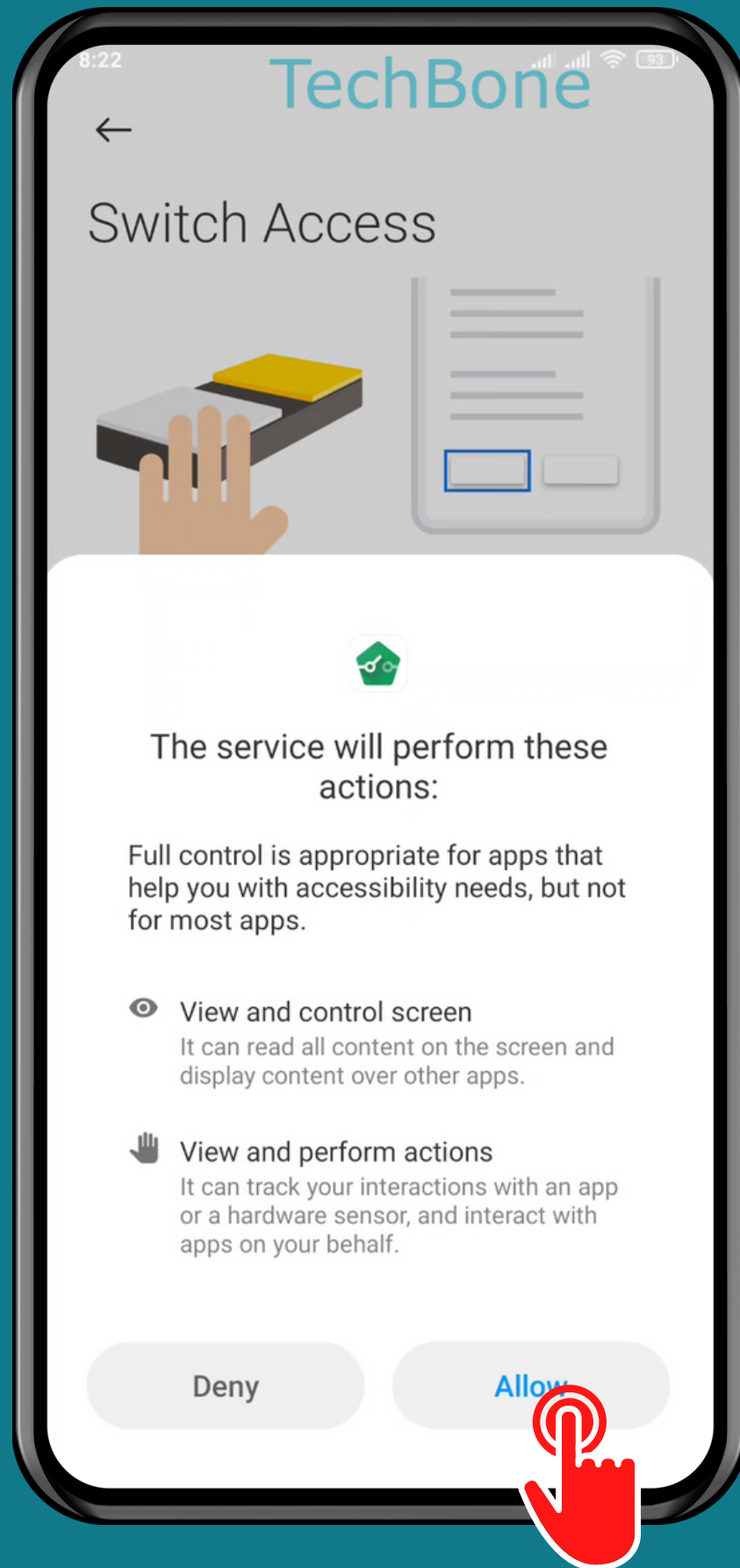

Tap on **Allow**

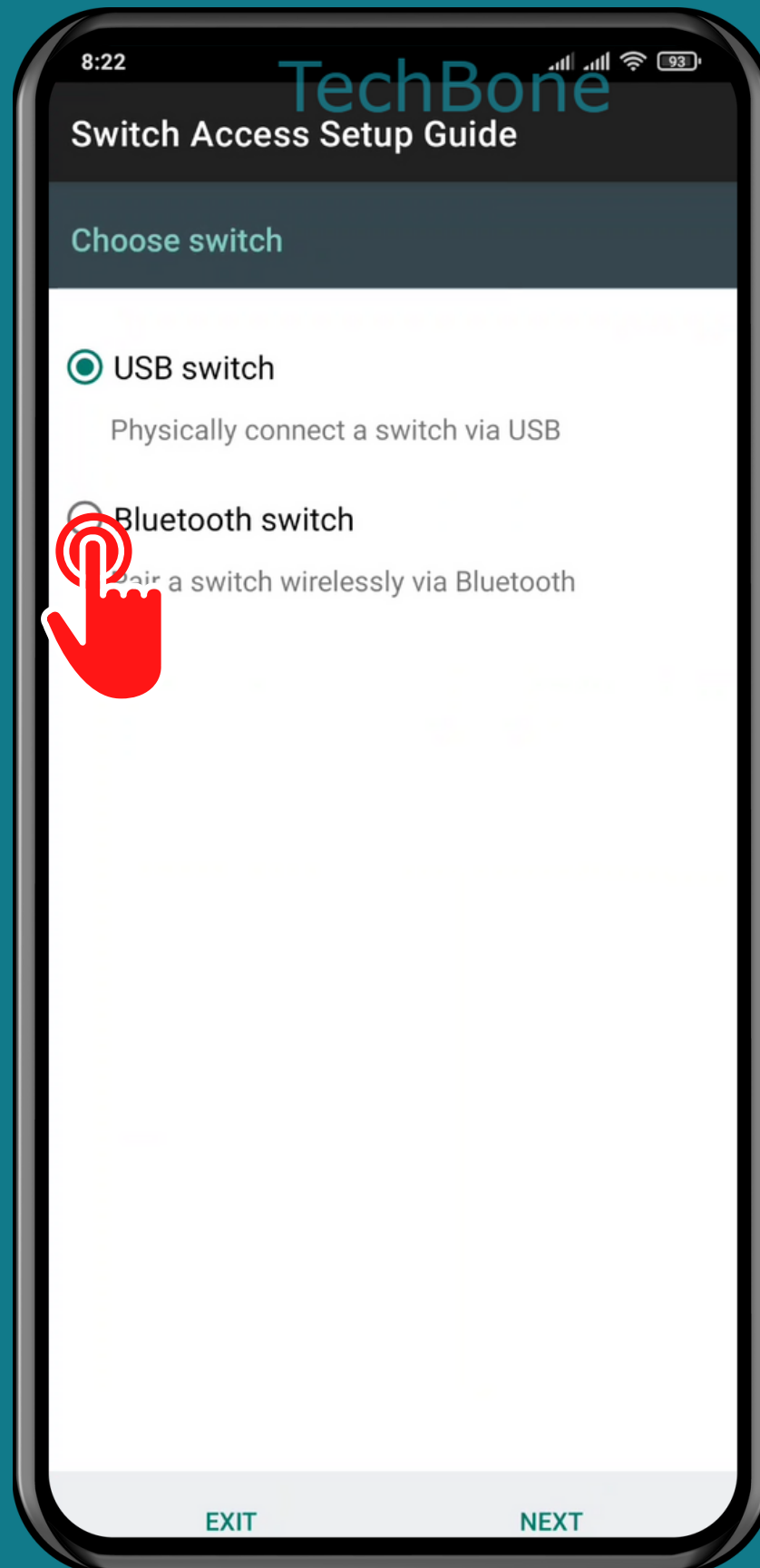

Choose
USB switch or
Bluetooth switch

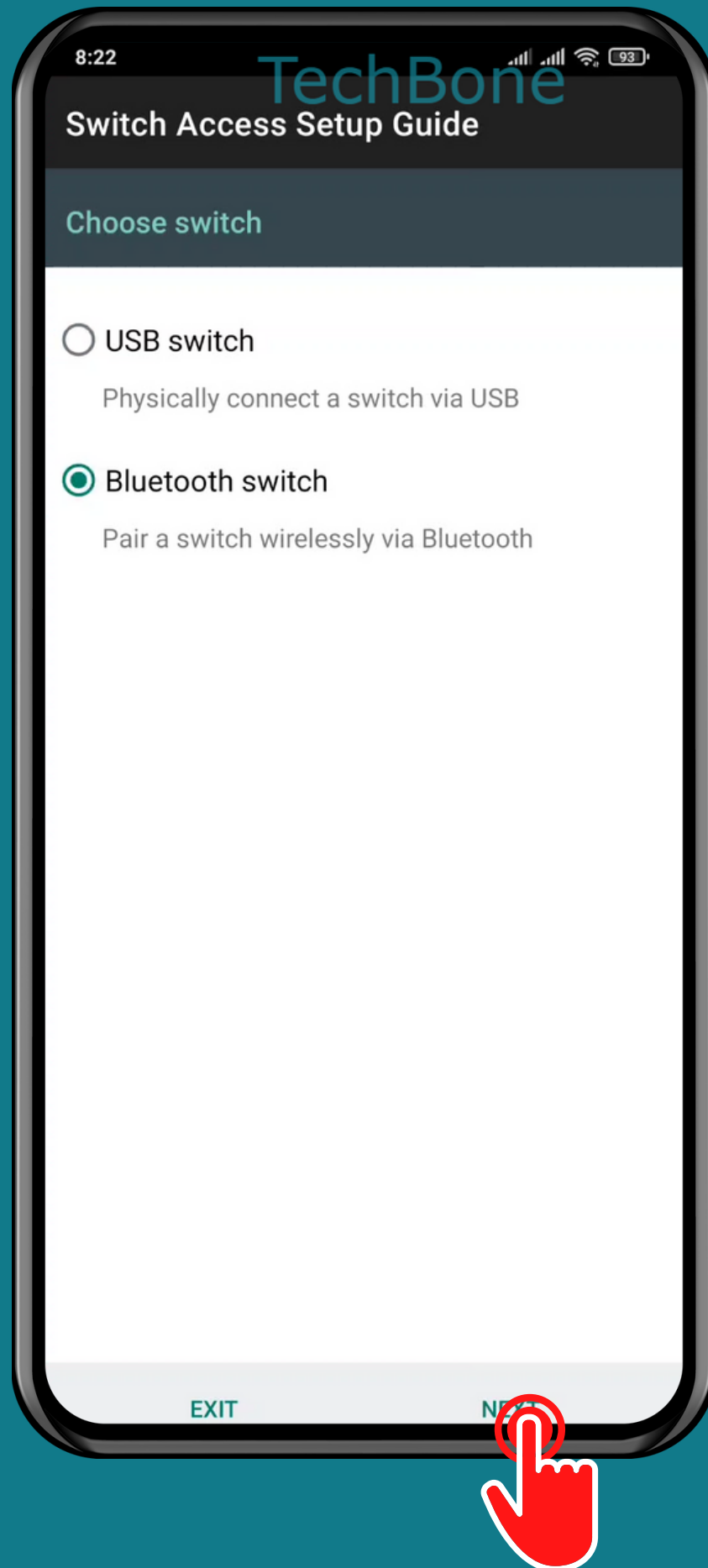

Tap on **Next** and follow the instructions on screen

Done!